

Nehbujin 29V6W 1PC

Nehbujin 29V 6W LED Power Supply Adapter Instruction Manual

Model: 29V6W 1PC

1. PRODUCT OVERVIEW

The Nehbujin 29V 6W LED Power Supply Adapter (Model: 29V6W 1PC) is a low voltage transformer designed to power various LED lighting devices, such as string lights and holiday decorations. This adapter is UL and ETL listed, ensuring compliance with safety standards. It features an IP44 waterproof rating, making it suitable for both indoor and outdoor use, though it is not fully submersible.



Image 1: The Nehbujin 29V 6W LED Power Supply Adapter, showing its compact design and electrical specifications label.

2. SAFETY INFORMATION AND IMPORTANT CONSIDERATIONS

- **Compatibility Check:** Before purchase and installation, carefully verify that the voltage, current, wattage, and connector type of this adapter match the requirements of your LED device. Incompatibility can lead to malfunction or damage.
- **Mode Compatibility:** This adapter provides a **steady-on mode only**. It is not compatible with LED lighting systems that require multiple modes (e.g., flashing, fading, or other dynamic light patterns). Ensure your lighting device is designed for steady-on operation.
- **Waterproof Rating:** The adapter has an IP44 waterproof rating, meaning it is protected against solid objects larger than 1mm and splashing water from any direction. It is **not completely waterproof** and should not be submerged in water.
- **Installation Height:** For outdoor use, the plug must be installed at a height of more than 1 foot (approximately 30 cm) above the ground surface to prevent water ingress and ensure safety.
- **Electrical Safety:** Always ensure the adapter is connected to a properly grounded outlet. Do not attempt to open or modify the adapter. Disconnect power before handling or troubleshooting.

3. PACKAGE CONTENTS

The package includes:

- 1 x Nehbujin 29V 6W LED Power Supply Adapter (Model: 29V6W 1PC)

4. SPECIFICATIONS

Input Voltage	100-120V AC, 50/60Hz, 0.25A
Output Voltage	29V DC, 0.2A (200mA)
Rated Power	6W
Waterproof Rating	IP44
Certifications	UL, ETL Listed
Model Number	29V6W 1PC
Dimensions (Approx.)	5.7 cm x 3.7 cm x 2.7 cm (2.24 in x 1.46 in x 1.06 in)



Image 2: Detailed dimensions of the Nehbujin 29V 6W LED Power Supply Adapter, including the plug and connector.

5. SETUP AND INSTALLATION

1. **Verify Compatibility:** Before connecting, re-confirm that the output specifications (voltage, current, wattage) and the connector type of this adapter are compatible with your LED lighting device.
2. **Connect the LED Device:** Align the female plug of the adapter with the male plug of your LED lighting device. Gently push them together until a secure connection is established.



Image 3: Illustration showing the connection process between the adapter's female plug and a matched male plug from an LED light string.

3. **Plug into Power Outlet:** Insert the adapter's two-prong plug into a standard 100-120V AC electrical outlet.
4. **Positioning (Outdoor Use):** If using outdoors, ensure the adapter is plugged into an outlet that is protected from direct heavy rain and that the adapter itself is positioned at least 1 foot (30 cm) above the ground.

6. OPERATION

Once properly connected and plugged into a power source, the LED lighting device will illuminate in a **steady-on mode**. This adapter does not support any other lighting modes (e.g., flashing, fading). If your lights do not turn on, refer to the Troubleshooting section.

7. TROUBLESHOOTING

Problem	Possible Cause / Solution
LED lights do not turn on.	<ul style="list-style-type: none">◦ Ensure the adapter is securely plugged into a working electrical outlet.◦ Verify the connection between the adapter and the LED device is firm.◦ Check if the LED device itself is functional.◦ Confirm the adapter's specifications (voltage, current, wattage) match the LED device's requirements.
LED lights are flickering or dim.	<ul style="list-style-type: none">◦ Check for loose connections at both the outlet and the LED device.◦ Ensure the power outlet is providing stable power.◦ The LED device might be drawing more power than the adapter can supply (check wattage).
LED lights are not displaying multiple modes.	<ul style="list-style-type: none">◦ This adapter is designed for steady-on mode only. It does not support multi-mode functionality. If your LED device requires multiple modes, this adapter is not compatible.

If troubleshooting steps do not resolve the issue, please contact customer support.

8. MAINTENANCE

- **Cleaning:** Disconnect the adapter from power before cleaning. Use a dry, soft cloth to wipe the surface. Do not use liquid cleaners or immerse in water.
- **Storage:** When not in use, store the adapter in a cool, dry place, away from direct sunlight and extreme temperatures.
- **Inspection:** Periodically inspect the adapter and its cables for any signs of damage, such as cracks, frayed wires, or discoloration. Discontinue use if damage is found.

9. CUSTOMER SUPPORT

For any questions, concerns, or issues regarding your Nehbujin 29V 6W LED Power Supply Adapter, please contact our customer support team. When contacting us, please provide the model number (29V6W 1PC) or the ASIN (B0CMXN9DY9) for quicker assistance.

We are committed to providing support for our low voltage transformers and will assist you promptly.

Related Documents - 29V6W 1PC



[LED Bluetooth Symphony Controller - User Guide and Features](#)

Comprehensive guide to the LED Bluetooth Symphony Controller, detailing product features, technical specifications, app control, and troubleshooting. Learn how to use the LED LAMP app for RGB color selection, music modes, and custom lighting effects.



Loosely assemble before tightening.
IF PURCHASED THE SOFA ONLINE AND HAVE ANY QUESTIONS
OR CONCERNS
PLEASE CONTACT US VIA EMAIL, TEXT OR PHONE

Comprehensive assembly instructions and user guide for the Latitude Run Deep Seat Sofa. Includes parts list, warnings, warranty, and maintenance information.



Loosely assembled below tightening.
IF YOU PURCHASED THE SOFA ONLINE AND HAVE ANY
QUESTIONS OR CONCERNS
PLEASE CONTACT US WITH EMAIL, TEXT OR PHONE:
EMAIL: servicedesk@nord.com
TEXT (SMS ONLY): +1 820-262-6688
PHONE: +1 877-560-6439

Lat accessories or parts sold will be insured after 30 days of the date of purchase.

Comprehensive assembly and care instructions for Grand Wingback outdoor furniture (sofa, 3-piece sets, chairs, tables) and the Outdoor Gas Fire Pit Table (Model: Z11-A01). Includes safety guides and troubleshooting.

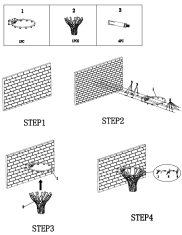

Learn how to easily assemble and install your basketball hoop with this concise guide. Includes parts list and clear, step-by-step instructions for mounting the rim and attaching the net.



Detailed installation guide for Spyder PRO-YD-FM99-1PC AM and CCFL headlights, designed for 1999-2004 Ford Mustang models. Includes tools required, step-by-step instructions, and important notes.



1PC Iron Bar Table

Comprehensive instruction manual for the 1PC Iron Bar Table by Winston Porter. Includes parts list, step-by-step assembly instructions, and essential care and maintenance guidelines for indoor and outdoor use.