

Arken Optics EP5 5-25X56 VPR-MIL

Arken Optics EP5 5-25X56 Rifle Scope Instruction Manual

Model: EP5 5-25X56 VPR-MIL

Brand: Arken Optics

1. INTRODUCTION

The Arken Optics EP5 5-25X56 Rifle Scope is a precision optical instrument designed for enhanced accuracy in hunting and shooting applications. This manual provides essential information for the proper setup, operation, and maintenance of your rifle scope to ensure optimal performance and longevity.

2. KEY FEATURES

- Versatile 5-25X56mm magnification range, suitable for various shooting scenarios.
- First Focal Plane (FFP) optic with Japanese ED glass for enhanced clarity and minimal dispersion.
- Fully multi-coated lenses ensuring superior light transmission.
- Equipped with Arken Zero Stop (AZS) for precise and repeatable elevation adjustments.
- Adjustable elevation and windage turrets with tactile and audible clicks (10 MIL/25 MOA per revolution).
- Christmas-tree style VPR reticle for accurate subtensions across the magnification range, aiding in target measurement and ranging.
- Fast focus eyepiece for quick reticle focusing.
- Single-piece 34mm tube constructed from aircraft-grade aluminum for strength and shockproof performance.
- O-ring sealed and nitrogen purged for waterproof and fogproof reliability.

3. PACKAGE CONTENTS

Upon unboxing, verify that all items are present:

- Arken Optics EP5 5-25X56 Rifle Scope
- Sunshade

- Bikini Lens Covers
- Instruction Manual



Image: The Arken Optics EP5 5-25X56 Rifle Scope as it appears when unboxed, showing the main scope unit.

4. PRODUCT OVERVIEW

Familiarize yourself with the main components of your Arken Optics EP5 rifle scope:

- **Objective Lens:** The front lens of the scope, gathering light.
- **Main Tube:** The central body of the scope (34mm diameter).
- **Elevation Turret:** Top turret for vertical adjustments.
- **Windage Turret:** Side turret for horizontal adjustments.
- **Parallax/Illumination Knob:** Side knob for parallax adjustment and reticle illumination control.
- **Magnification Ring:** Located near the eyepiece, used to adjust magnification.
- **Eyepiece/Diopter Adjustment:** Rear part of the scope, used to focus the reticle.



Image: Top-down view of the Arken Optics EP5 scope, highlighting the large, tactile elevation and windage turrets.



Image: Detailed view of the elevation and windage turrets, indicating their functions for vertical and horizontal adjustments.

5. SETUP AND MOUNTING

Proper mounting is crucial for accuracy. While mounting rings are not included, ensure you use high-quality 34mm rings appropriate for your rifle. Consult a qualified gunsmith if you are unsure about mounting procedures.

5.1. Diopter Adjustment (Reticle Focus)

1. Point the scope at a plain, bright background (like a clear sky or a blank wall).
2. Look through the scope and quickly glance away.

3. Immediately look back through the scope and adjust the diopter ring (eyepiece) until the reticle appears sharp and clear.
4. Repeat this process several times to ensure accurate focus. Once set, this adjustment typically does not need to be changed.



Image: Rear view of the scope, highlighting the eyepiece and diopter adjustment ring for reticle focus.

6. OPERATING THE SCOPE

6.1. Magnification Adjustment

Rotate the magnification ring to select your desired power setting (5x to 25x). Since this is a First Focal Plane (FFP) scope, the reticle will grow or shrink proportionally with the target as you adjust magnification, ensuring subtensions remain accurate at all power settings.

6.2. Parallax Adjustment

The parallax knob is located on the left side of the scope. Rotate it to match the estimated distance to your target. This eliminates parallax error, ensuring the reticle and target are on the same focal plane, providing a clear image and accurate aiming point.

6.3. Reticle Illumination

The parallax knob also controls the reticle illumination. Rotate the outer ring of the parallax knob to activate and adjust the brightness of the illuminated VPR reticle. There are 6 different illumination settings to suit various lighting conditions.



Image: Close-up of the parallax knob, illustrating the 6 different illumination settings for the reticle.

6.4. Elevation and Windage Turrets (with AZS Zero Stop)

The elevation (top) and windage (right) turrets allow for precise adjustments to your point of impact. Each click provides a clear, audible, and tactile response, indicating a 0.1 MRAD adjustment.

- **Elevation Turret:** Adjusts the vertical point of impact. Rotate clockwise to move the impact down, counter-clockwise to move it up.
- **Windage Turret:** Adjusts the horizontal point of impact. Rotate clockwise to move the impact right, counter-clockwise to move it left.
- **Arken Zero Stop (AZS):** This feature allows you to set a positive stop at your zero point. Once set, you can dial up for long-range shots and then quickly return to your established zero without looking, preventing you from dialing below your zero.



Image: Detailed view of the AZS Zero Stop mechanism on the elevation turret, showing the set screw and zero stop indicator.

6.5. VPR Reticle

The VPR reticle is a Christmas-tree style reticle designed for precise holdovers and windage corrections. Its subtensions are accurate across the entire magnification range due to the First Focal Plane design. This allows for quick and accurate ranging and compensation for bullet drop and wind drift.

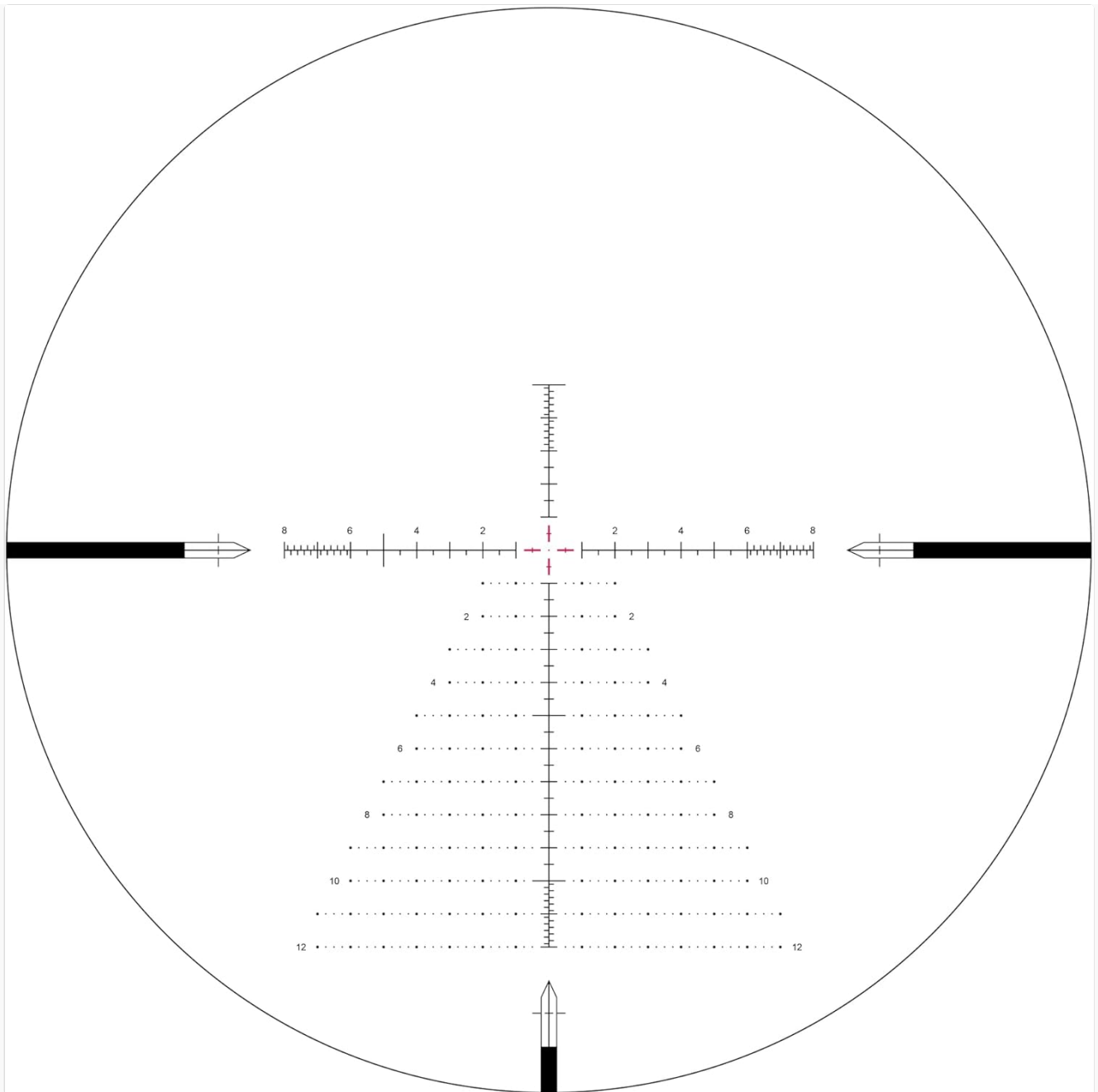

Image: A clear view of the VPR reticle as seen through the scope, showing the main crosshairs and subtension markings.

Field Of View	25.3 Feet
Material	Aluminum
Item Weight	39 Ounces
Product Dimensions	14.02"L x 2.6"W x 2.6"H
Color	Matte Black
Waterproof/Fogproof	Yes (O-ring sealed, nitrogen purged)
Zero Stop	Arken Zero Stop (AZS)

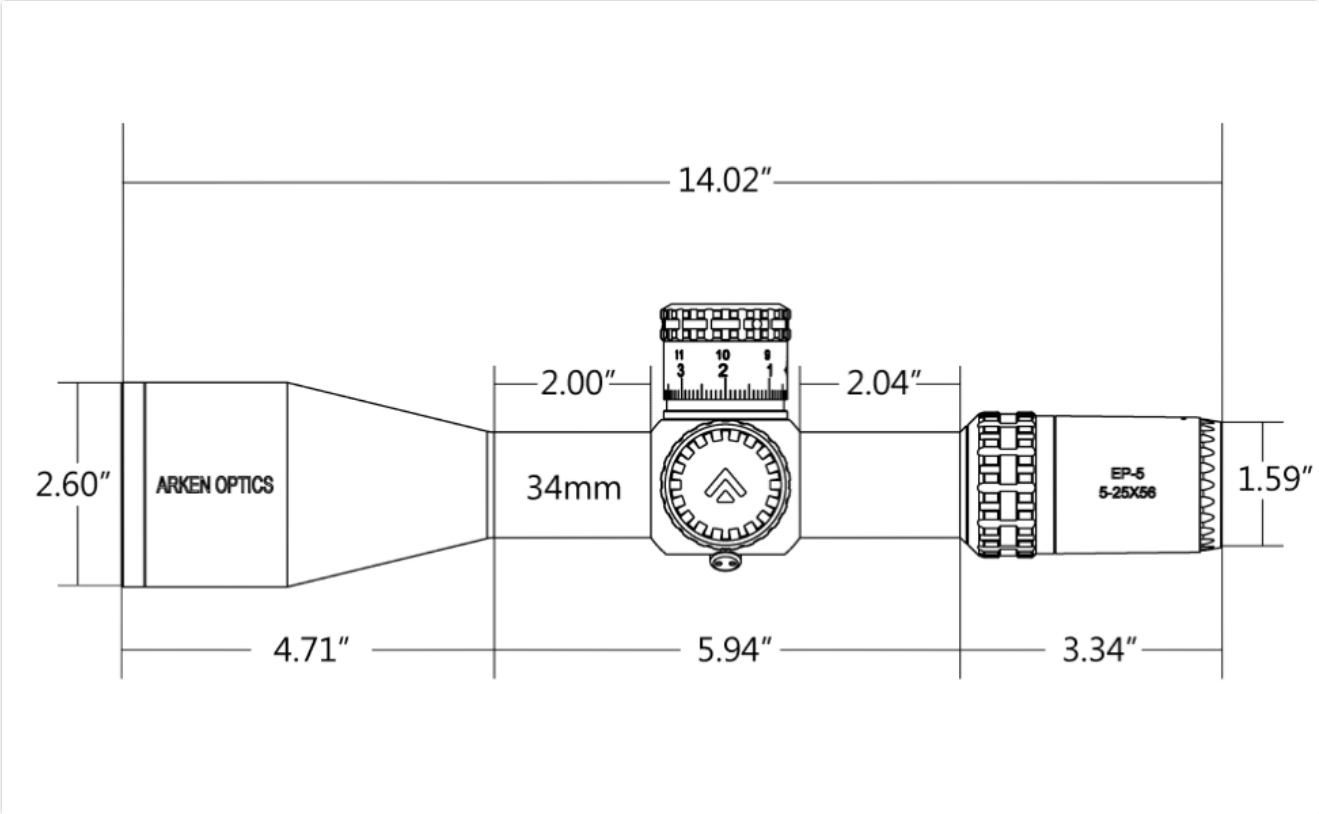

Image: Technical drawing showing the key dimensions of the Arken Optics EP5 Rifle Scope.

8. CARE AND MAINTENANCE

To ensure the longevity and performance of your Arken Optics EP5 rifle scope, follow these care and maintenance guidelines:

- **Cleaning Lenses:** Use a soft brush or compressed air to remove dust and debris. For smudges or fingerprints, use a lens cloth and a specialized lens cleaning solution. Avoid using harsh chemicals or abrasive materials.
- **Cleaning Body:** Wipe the scope body with a soft, damp cloth.
- **Storage:** Store the scope in a cool, dry place, away from direct sunlight and extreme temperatures. Use the provided lens covers to protect the objective and eyepiece lenses when not in use.
- **Avoid Disassembly:** Do not attempt to disassemble the scope. This will void the warranty and may cause irreparable damage.

9. TROUBLESHOOTING

If you encounter issues with your scope, consider the following common troubleshooting steps:

- **Blurred Reticle:** Adjust the diopter (eyepiece focus) as described in Section 5.1.
- **Blurred Image/Parallax Error:** Adjust the parallax knob to match the target distance.
- **Inaccurate Adjustments:** Ensure turrets are properly seated and not obstructed. Verify mounting stability.
- **No Reticle Illumination:** Check the battery (if applicable, though not explicitly mentioned for this model, it's standard for illuminated reticles) and ensure the illumination knob is correctly engaged.
- **Loss of Zero:** Check mounting rings and base for tightness. Ensure the rifle and scope are not subjected to excessive shock.

For persistent issues, contact Arken Optics customer support.



10. WARRANTY AND SUPPORT

Arken Optics stands behind the quality of its products. The EP5 5-25X56 Rifle Scope comes with **Lifetime Warranty**.

For warranty claims, technical assistance, or any other inquiries, please refer to the official Arken Optics website or contact their customer support directly. Keep your purchase receipt as proof of ownership.

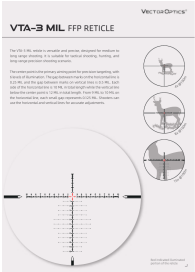
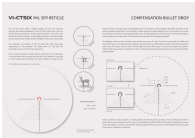
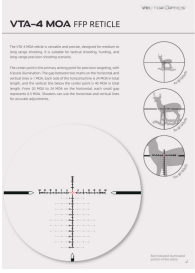

Image: A display of various Arken Optics scopes, emphasizing the brand's commitment to quality and lifetime warranty.

	<p>Arken Optics EPL-4 Owner's Manual: Precision Rifle Scope Guide</p> <p>A comprehensive guide to the Arken Optics EPL-4 rifle scope, covering specifications for 6-24x50 and 4-16x44 models, MIL/MOA subtension scales, and detailed instructions for reticle focus, parallax adjustment, variable power, and turret zero stop alignment.</p>
	<p>Arken Optics Zulus HD 5-20X LRF Digital Day/Night Scope User Manual</p> <p>Comprehensive user manual for the Arken Optics Zulus HD 5-20X LRF Digital Day/Night Scope, covering features, specifications, controls, and operation.</p>
	<p>Vector Optics VTA-3 MIL FFP Reticle Guide</p> <p>A comprehensive guide to the Vector Optics VTA-3 MIL First Focal Plane (FFP) reticle, detailing its features, usage for bullet drop compensation, and methods for measuring target height and length in various shooting scenarios.</p>
	<p>Vector Optics VI-CTSIX MIL SFP Reticle Guide and Ranging Instructions</p> <p>Detailed guide for the Vector Optics VI-CTSIX MIL SFP reticle, covering its features, bullet drop compensation, and methods for measuring target height and length using MILs for accurate ranging.</p>
	<p>Vector Optics VTA-4 MOA FFP Reticle Guide</p> <p>A comprehensive guide to the Vector Optics VTA-4 MOA First Focal Plane (FFP) reticle, detailing its features, applications in bullet drop compensation, and methods for estimating target range for precision shooting.</p>