

Luqeeq Luqeeq3quwgmr25b8621

Luqeeq 3-in-1 Smart Sweeping Robot Vacuum Cleaner

Model: Luqeeq3quwgmr25b8621

Brand: Luqeeq

1. SAFETY INFORMATION

Please read all safety instructions carefully before using this product and retain them for future reference. Failure to follow these instructions may result in electric shock, fire, or serious injury.

- This appliance is for indoor use only. Do not use outdoors or on wet surfaces.
- Do not allow children to operate the robot vacuum cleaner. Supervise children and pets when the appliance is in operation.
- Do not use the appliance to pick up large or sharp objects, liquids, or burning/smoking materials.
- Ensure the power cable is not damaged. If damaged, contact customer support for replacement.
- Do not immerse the appliance in water or other liquids.
- Turn off the power switch and unplug the appliance before cleaning or performing maintenance.
- Only use the provided charging cable and battery.

2. PRODUCT OVERVIEW

Key Features

- **3-in-1 Functionality:** Vacuums, sweeps, and mops for comprehensive cleaning.
- **Intelligent Navigation:** Equipped with smart anti-collision and anti-drop sensors for thorough cleaning without missing areas.
- **Extended Side Brushes:** Designed to reach deeper into corners and edges for efficient dust collection.
- **Low Noise Operation:** Operates at approximately 40dB, minimizing disturbance.
- **Versatile Application:** Suitable for various floor types including hard floors, tiles, soft carpets, and marble.

Product Components

The Luqeeq 3-in-1 Smart Sweeping Robot Vacuum Cleaner is designed for ease of use and effective cleaning. Below are some key components.



Image: Top view of the robot vacuum cleaner, highlighting the main power/auto button and the dustbin access panel.



Image: The robot vacuum cleaner actively cleaning a hard floor, demonstrating its compact form factor and the action of its side brushes.

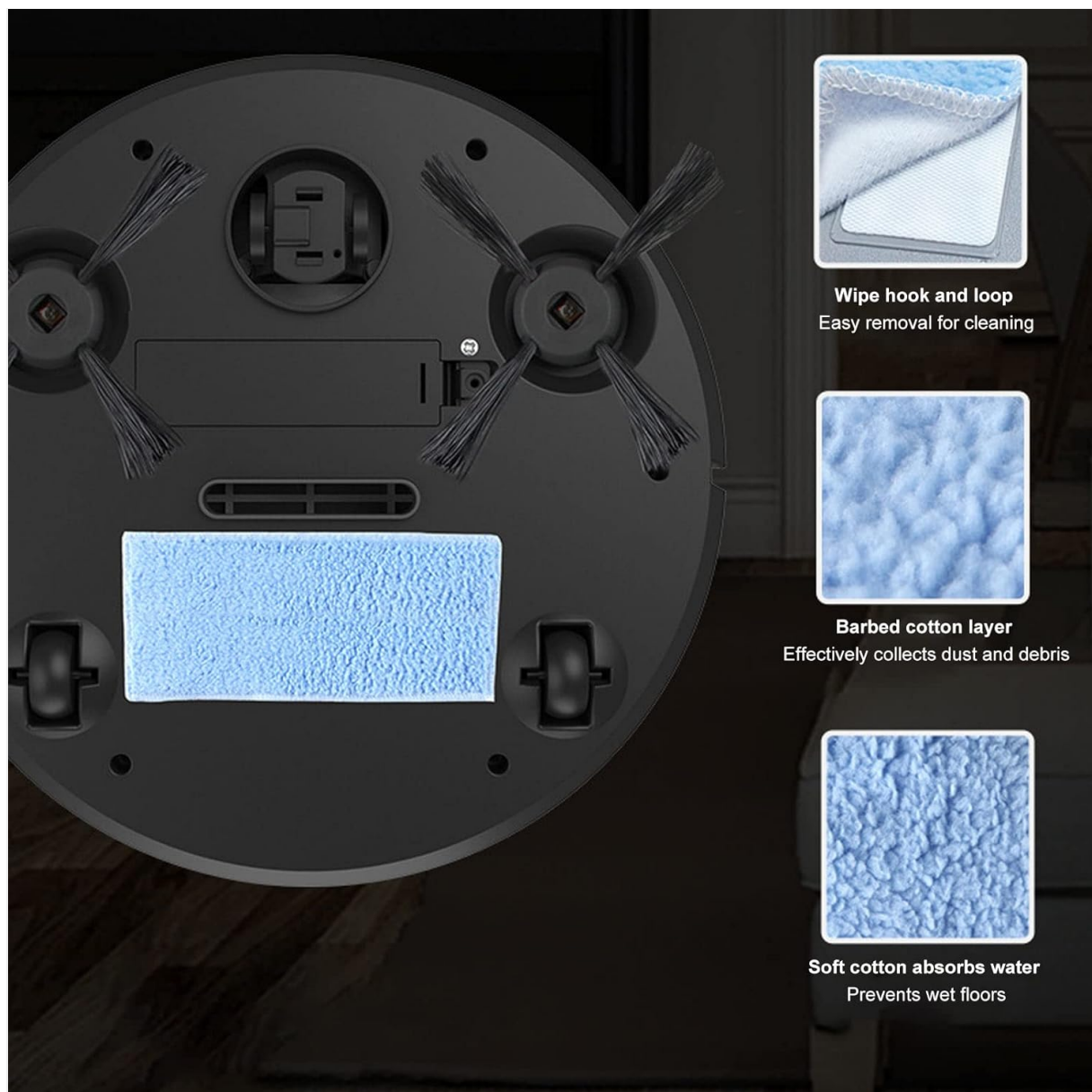

Image: The underside of the robot, illustrating the attachment points for the mop pad (hook and loop), the barbed cotton layer for dust collection, and the soft cotton layer for water absorption, along with the side brushes and wheels.

3. PACKAGE CONTENTS

Carefully unpack the box and ensure all items are present and in good condition. If any items are missing or damaged, please contact customer support.

- 1 x Sweeping Robot
- 1 x Cleaning Brush
- 2 x Hook and Loop Fasteners (for mop pad)
- 2 x Side Brushes
- 1 x Mop Wipe
- 1 x Power Cable (USB)



Image: A complete view of the product package contents, showing the main robot unit and all included accessories.



Image: A detailed view of the individual accessories provided with the robot vacuum cleaner.

4. SETUP

4.1 Charging the Robot

1. Before first use, fully charge the robot vacuum cleaner.
2. Connect the provided USB power cable to the charging port on the robot and to a suitable USB power adapter (not included).
3. The charging indicator light will illuminate. A full charge takes approximately 3.5 hours.
4. Once fully charged, the indicator light may change or turn off. Disconnect the charging cable.

4.2 Attaching Side Brushes

Gently press the side brushes onto their respective posts on the underside of the robot until they click into place.

4.3 Attaching the Mop Pad

Attach the mop wipe to the bottom of the robot using the hook and loop fasteners. Ensure it is securely fastened.

5. OPERATING INSTRUCTIONS

5.1 Starting the Robot

1. Ensure the robot is fully charged and all accessories (side brushes, mop pad) are correctly installed.
2. Place the robot on the floor in the area you wish to clean.
3. Press the 'AUTO' button located on the top of the robot to start the cleaning cycle. The robot will begin

vacuuming, sweeping, and mopping automatically.

5.2 Intelligent Navigation

The robot is equipped with intelligent sensors to detect obstacles and prevent falls. It will navigate around furniture and avoid dropping down stairs.



Image: The robot vacuum cleaner illustrating its intelligent anti-drop and anti-collision capabilities, showing how it senses edges and obstacles.

5.3 Stopping the Robot

To stop the robot during operation, press the 'AUTO' button again. The robot will pause its cleaning cycle.

5.4 Battery Life

A fully charged robot provides approximately 75 minutes of cleaning time.

6. MAINTENANCE

Regular maintenance ensures optimal performance and extends the lifespan of your robot vacuum cleaner. Always turn off the robot and disconnect it from power before cleaning.

6.1 Cleaning the Dust Bin

1. Open the dustbin cover on the top of the robot.
2. Remove the dust bin.
3. Empty the dust and debris into a trash can.
4. Rinse the dust bin with water if necessary, ensuring it is completely dry before reinserting.
5. Place the dust bin back into the robot and close the cover securely.

6.2 Cleaning Side Brushes

Periodically check the side brushes for tangled hair or debris. Carefully remove any obstructions. If brushes are worn, they can be replaced.

6.3 Cleaning the Mop Pad

After each mopping session, detach the mop wipe from the robot. Wash it with water and mild detergent, then allow it to air dry completely before reattaching or storing.

6.4 Cleaning Sensors and Wheels

Wipe the sensors and wheels on the underside of the robot with a dry cloth to remove any dust or debris that might affect navigation or movement.



Image: The underside of the robot, detailing the wheels, side brush attachment points, and the main suction area, which should be kept clean for optimal performance.

7. TROUBLESHOOTING

If you encounter any issues with your robot vacuum cleaner, please refer to the following troubleshooting guide:

Problem	Possible Cause	Solution
Robot does not start	Low battery; Power switch off	Charge the robot; Ensure the power switch is on.
Poor cleaning performance	Full dust bin; Dirty brushes/mop pad; Blocked suction inlet	Empty and clean the dust bin; Clean or replace brushes/mop pad; Clear any blockages from the suction inlet.
Robot gets stuck frequently	Obstacles in cleaning path; Dirty sensors	Clear the area of loose cables, rugs, or small objects; Clean the anti-drop and anti-collision sensors.
Unusual noise during operation	Debris caught in brushes or wheels	Turn off the robot and inspect brushes and wheels for any trapped debris. Remove carefully.

8. SPECIFICATIONS

Product specifications are subject to change without notice for product improvement.

- **Model:** Luqeeeg3quwgmr25b8621
- **Material:** ABS
- **Battery Voltage:** 3.7V
- **Battery Capacity:** 1200mAh Lithium Polymer
- **Noise Level:** Approximately 40dB
- **Charging Time:** Approximately 3.5 hours
- **Usage Time:** Approximately 75 minutes
- **Product Dimensions:** Approximately 21 x 5 cm (8.3 x 2.0 inches)
- **Weight:** Approximately 403g (14.2 oz)
- **Special Features:** Cordless, 3-in-1 (Vacuum, Sweep, Mop), Intelligent Anti-Collision/Anti-Drop
- **Recommended Surfaces:** Hard floors, Tiles, Soft Carpets, Marble



Image: Dimensions of the robot vacuum cleaner, showing its diameter and height.

9. WARRANTY AND SUPPORT

This product comes with a standard manufacturer's warranty. For detailed warranty information, please refer to the documentation provided at the time of purchase or contact your retailer.

If you have any questions, require technical assistance, or need to report an issue, please contact Luqeeq customer support through your purchase platform or the official Luqeeq website.