

ABUS Combiflex

ABUS Combiflex Cable Lock User Manual

MODEL: COMBIFLEX

Product Overview

The ABUS Combiflex Cable Lock is a versatile and portable security device designed to deter casual theft of your personal items. Its compact size and retractable steel cable make it ideal for securing various belongings in different environments. The lock operates with a customizable multi-digit numerical code, eliminating the need for keys.

Setup: Setting Your Combination

Your ABUS Combiflex Cable Lock comes with a factory preset combination, typically 0-0-0-0. To set your personal combination, follow these steps:

1. Ensure the lock is set to the factory default combination (0-0-0-0). The numbers should align with the guide line on the lock.
2. With the cable fully retracted, locate the small reset button. This is often the steel nub of the cable itself, which needs to be pushed firmly downwards into the device.
3. While holding the reset button down, rotate the number dials to your desired 4-digit combination.
4. Release the reset button. Your new combination is now set.
5. Test your new combination by scrambling the dials and then entering your new code. Press the cable release button to confirm it unlocks.



Security Tech Germany



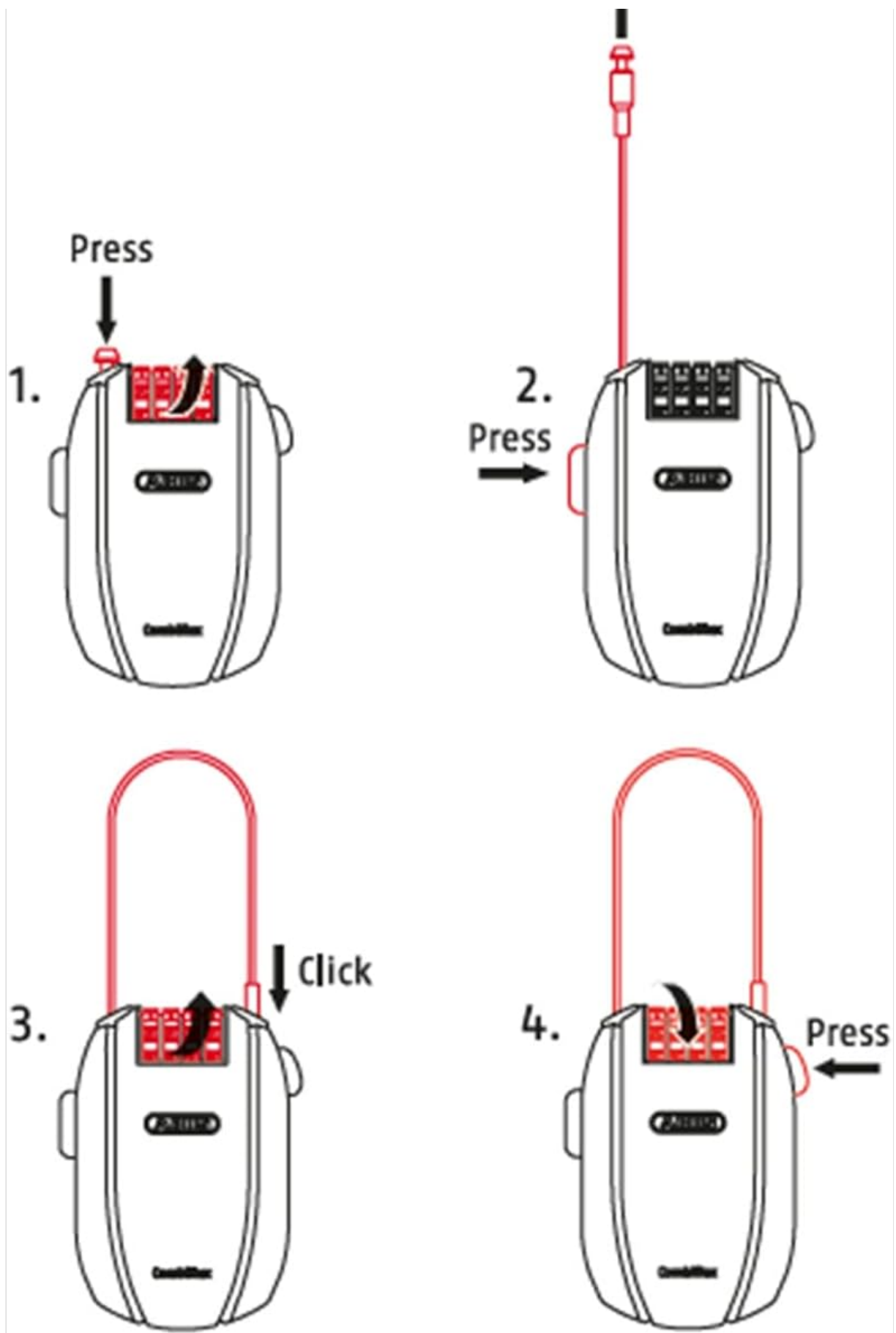

Figure 1: Visual guide for setting the lock combination.

Your browser does not support the video tag.

Video 1: Demonstrating how to set the combination on a similar cable lock.

To use your ABUS Combiflex Cable Lock for securing items:

1. Enter your personal 4-digit combination.
2. Press the cable release button (usually a larger button on the side) to extend the steel cable.
3. Loop the extended cable around the item(s) you wish to secure and a fixed, immovable object (e.g., a ski rack, a pole, a chair leg).
4. Insert the free end of the cable back into the designated opening on the lock body.
5. Once the cable is inserted and taut, scramble the number dials to a random sequence. This locks the cable in place.
6. To unlock, enter your correct combination and press the cable release button. The cable will retract or can be pulled out.



Figure 2: Securing a helmet with the Combiflex lock.



Figure 3: Using the Combiflex lock to secure a bicycle.



Figure 4: Securing luggage with the Combiflex lock.



Figure 5: Securing a motorcycle helmet with the Combiflex lock.

Your browser does not support the video tag.

Video 2: Demonstration of using a ski lock, applicable to the Combiflex.

Care and Maintenance

To ensure the longevity and proper function of your ABUS Combiflex Cable Lock, consider the following:

- Keep the lock mechanism clean and free from dirt, dust, or debris, especially after outdoor use in harsh conditions (e.g., snow, sand).
- Avoid using harsh chemicals or abrasive cleaners, which can damage the plastic and metal components. A damp cloth is usually sufficient for cleaning.
- Store the lock in a dry place when not in use to prevent corrosion of the steel cable and internal mechanisms.
- Periodically check the cable for any signs of wear or damage. If the cable is frayed or compromised, replace the lock.

Troubleshooting

- **Difficulty Setting Combination:** Ensure you are holding the reset button firmly throughout the entire

process of setting the new code. Releasing it prematurely can result in an incorrectly set or unknown combination.

- **Cable Not Retracting/Extending Smoothly:** Check for any physical obstructions or debris in the cable's path or within the lock mechanism. Ensure the combination is correctly entered before attempting to retract or extend the cable.
- **Lock Feels Loose or Insecure:** While designed as a deterrent against casual theft, ensure the cable is pulled taut around the secured items and fixed object to minimize slack.

Product Specifications

- **Brand:** ABUS
- **Model Name:** Combiflex
- **Lock Type:** Combination Lock
- **Special Feature:** Keyless functions, Retractable Cable
- **Cable Length:** 125 cm (approximately 4.1 feet)
- **Cable Thickness:** 3 mm
- **Material:** Plastic, Stainless Steel
- **Item Weight:** 128 Grams (approximately 4.5 ounces)
- **Color:** Black
- **Product Dimensions:** 3.94 x 5.91 x 7.87 inches

Warranty and Support

The ABUS Combiflex Cable Lock comes with a **2-Year Warranty**. For warranty claims, technical support, or any product-related inquiries, please contact ABUS customer service through their official website or the retailer where the product was purchased. Keep your proof of purchase for warranty validation.

For more information, visit the [ABUS Store on Amazon](#).