

NEWDERY ZHX-642CW

NEWDERY 10000mAh Battery Case User Manual

Model: ZHX-642CW

INTRODUCTION

This manual provides comprehensive instructions for the NEWDERY 10000mAh Battery Case, model ZHX-642CW. It covers installation, operation, maintenance, and troubleshooting to ensure optimal performance and longevity of your battery case. Please read this manual thoroughly before using the product.



Image: The NEWDERY 10000mAh Battery Case shown with an iPhone installed, highlighting its design and integrated wireless charging symbol.

COMPATIBILITY

This battery case is specifically designed for the following 6.1-inch iPhone models:

- iPhone 14 Pro
- iPhone 14
- iPhone 13 Pro
- iPhone 13

This case is **not** compatible with iPhone 14 Plus, iPhone 14 Pro Max, or iPhone 13 Pro Max (6.7-inch models).

For iPhone 14 Pro/14/13 Pro/13 6.1"

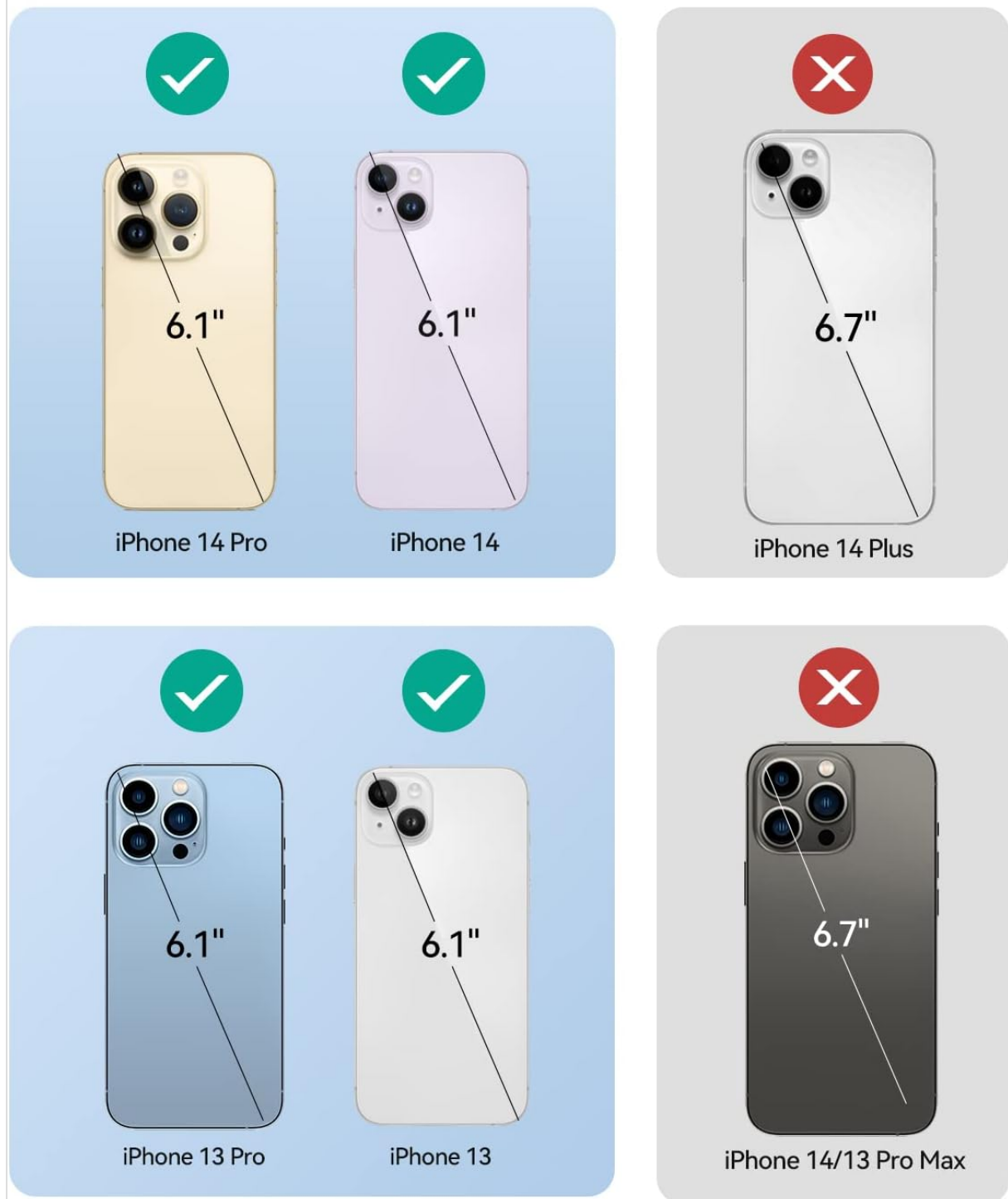

Image: A visual guide illustrating the compatible 6.1-inch iPhone models (iPhone 14 Pro, iPhone 14, iPhone 13 Pro, iPhone 13) and explicitly marking 6.7-inch models (iPhone 14 Plus, iPhone 14 Pro Max, iPhone 13 Pro Max) as incompatible.

PACKAGE CONTENTS

Upon opening the package, verify that all items are present:

- 1 x NEWDERY 10000mAh Battery Case (Model ZHX-642CW)
- 1 x User Manual

SETUP

Installing Your iPhone

1. Gently bend the soft rubber top of the battery case backward.
2. Slide your iPhone into the case, ensuring the charging port of the phone aligns correctly with the connector inside the case.
3. Push the iPhone firmly until it is fully seated and the rubber top snaps back into place.
4. To remove, gently bend the rubber top again and slide the iPhone out.



Image: A four-panel diagram illustrating the step-by-step process of installing an iPhone into the battery case by bending the top and sliding it in, and removing it by reversing the steps.

Initial Case Charging

Before first use, fully charge the battery case. Connect the case to a power source using a compatible charging cable (not included). The LED indicators will illuminate to show charging progress.

OPERATION

Charging Your iPhone

To begin charging your iPhone using the battery case:

1. Ensure your iPhone is securely installed in the case.
2. Press and hold the power button on the back of the battery case for approximately 3 seconds.
3. The LED indicators will light up, and your iPhone will begin charging.
4. To stop charging, press and hold the power button again for 3 seconds.

Wireless Charging

The battery case supports Qi wireless charging. You can charge both the battery case and your iPhone simultaneously by placing the case on a Qi-compatible wireless charging pad. The iPhone will prioritize charging first.

Qi Wireless Charging Supported



Image: An iPhone, enclosed in the NEWDERY battery case, positioned on a wireless charging pad, with a charging icon displayed on the phone screen.

Simultaneous Charging

You can charge the battery case and your iPhone simultaneously using a wired charging cable. Connect the cable to the case's charging port. The iPhone will receive power first, followed by the battery case.



Image: A split image demonstrating two charging methods: an iPhone in the battery case charging wirelessly on a pad, and another iPhone in the case charging via a wired connection to a wall adapter.

Data Sync and Audio

The battery case allows for data synchronization with a computer and supports wired headsets.

- **Data Sync:** Connect the battery case (with iPhone installed) to your computer using a data cable. You can transfer files without removing the case.
- **Wired Headset:** The case supports wired earphones, allowing you to listen to audio while your iPhone is in the case.



Image: An iPhone in the battery case connected via cable to a laptop, illustrating data synchronization.

Enjoy Music While Charging



Wired Earphones



Airpods

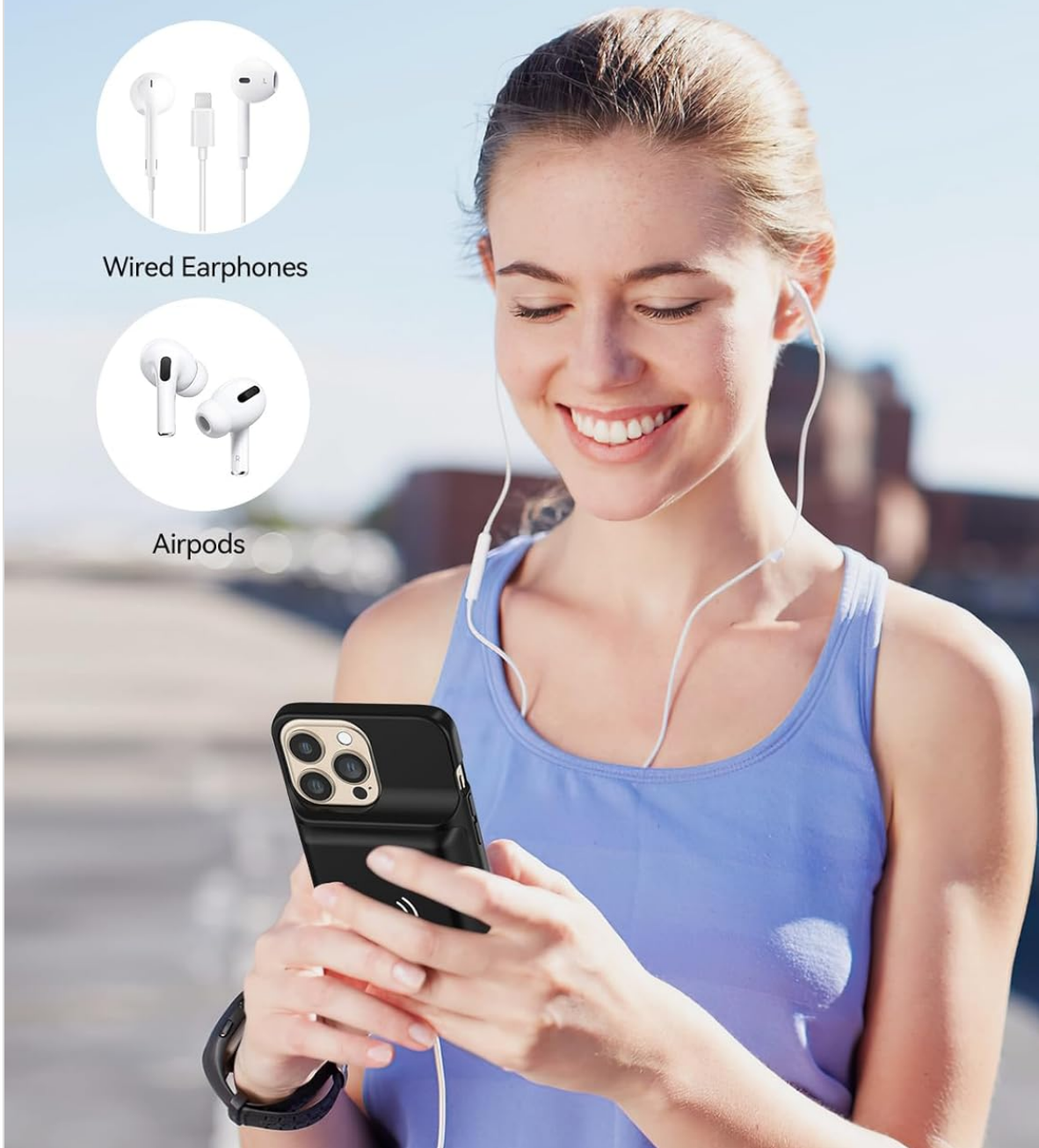

Image: A person listening to music with wired earphones while their iPhone is in the battery case, demonstrating audio compatibility.

Apple Pay

The Apple Pay function remains fully accessible and supported while your iPhone is installed in the battery case.

Power Indicators

The LED indicators on the back of the battery case display the remaining battery charge:

- **4 LEDs:** 75% - 100%
- **3 LEDs:** 50% - 75%

- **2 LEDs:** 25% - 50%
- **1 LED:** 0% - 25%

Press the power button once to check the current charge level.

Power Indicators

Press the switch for 3s to turn on/off



Image: A diagram showing the back of the battery case with its power button and four LED indicators, detailing what each number of lit LEDs signifies in terms of battery charge percentage.

MAINTENANCE

To ensure the longevity and proper function of your battery case:

- **Cleaning:** Wipe the case with a soft, dry cloth. Avoid using harsh chemicals or abrasive materials.
- **Storage:** Store the case in a cool, dry place away from direct sunlight and extreme temperatures.
- **Safety:** Do not disassemble, puncture, or expose the battery case to water or fire. Avoid dropping the case from significant heights.

TROUBLESHOOTING

If you encounter issues with your NEWDERY battery case, consider the following:

- **Case not charging/iPhone not charging:**
 - Ensure the charging cable and adapter are functioning correctly.
 - Verify the iPhone is properly seated in the case, and the connector is aligned.
 - Press and hold the power button for 3 seconds to activate charging.
 - Try a different charging cable or wireless charging pad.
- **"Liquid detected" error:**
 - This error can sometimes occur without actual liquid exposure. Try cleaning the iPhone's charging port and the case's connector with a dry, soft brush.
 - Ensure both the iPhone and case are completely dry.
- **Reduced battery life:**
 - Battery performance can degrade over time. Ensure the case is fully charged before use.
 - Environmental factors (extreme cold/heat) can affect battery efficiency.
- **Case feels hot during charging:**
 - It is normal for the case to warm up slightly during charging. If it becomes excessively hot, disconnect it immediately and contact support.

SPECIFICATIONS

Feature	Detail
Model Number	ZHX-642CW
Battery Capacity	10000mAh
Compatible Phone Models	iPhone 14 Pro, iPhone 14, iPhone 13 Pro, iPhone 13 (6.1-inch)
Product Dimensions	5.98 x 3.05 x 1.02 inches
Item Weight	7 ounces
Material	Polycarbonate, Rubber
Special Features	Qi Wireless Charging Support, Portable, Data Sync, Wired Headset Support, Apple Pay Support
Batteries Required	1 Lithium Ion battery (included)

Little Bulky But Powerful



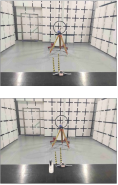



Image: A visual representation of the battery case's dimensions (length, width, thickness) and its weight, comparing its thickness to approximately three iPhone 14 Pro devices and its weight to one iPhone 14 Pro.

WARRANTY AND SUPPORT

NEWDERY provides a 1-year warranty for this product. If you experience any issues or require assistance, please contact NEWDERY customer support. Our team is available to provide professional and friendly support.

Related Documents - ZHX-642CW

	<p>NEWDERY MC01 Multi-Function Charger User Manual (XDL-MC01)</p> <p>Official user manual for the NEWDERY MC01 Multi-Function Charger (Model: XDL-MC01). Find product specifications, safety warnings, and FCC/ISED compliance information for this versatile charger.</p>
	<p>NEWDERY MC01 Multi-Function Charger User Manual (XDL-MC01)</p> <p>Official user manual for the NEWDERY MC01 Multi-Function Charger (Model: XDL-MC01). Find product specifications, safety warnings, and FCC/ISED compliance information for this versatile charger.</p>
	<p>ARSVITA Bluetooth Cassette Adapter User Guide</p> <p>Instructions and specifications for the ARSVITA Bluetooth Cassette Adapter (Model: ZHX-088), enabling wireless audio streaming to car cassette players.</p>
	<p>Wireless Power Bank ZHX-WPB04 Test Setup Photographs</p> <p>Detailed photographs of the test setup for the Shenzhen Zhenghaixin Technology Co., Ltd. Wireless Power Bank, Model ZHX-WPB04. Includes setups for radiated emission, conducted emission, and RF exposure testing.</p>
	<p>Mavulo ZHX-PB26 Power Bank Manual: Features, Usage, and Safety</p> <p>Comprehensive user manual for the Mavulo ZHX-PB26 Power Bank. Learn about its 12000mAh capacity, 15W wireless charging, 18W/20W wired charging, product parameters, usage instructions, and safety guidelines.</p>
	<p>RUXELY Magnetic Wireless Charger for Apple Watch Model ZHX-WA18A</p> <p>Discover the RUXELY Magnetic Wireless Charger for Apple Watch (Model ZHX-WA18A). This portable charging dock offers convenient magnetic attachment and fast charging for iWatch Series SE, 8, 7, 6, 5, 4, 3, 2, 1.</p>