

## Wasserstein Horizontal Adjustable Mount

# Wasserstein Horizontal Adjustable Mount for Google Nest Doorbell (Wired, 2nd Gen) - Instruction Manual

Model: Horizontal Adjustable Mount

## INTRODUCTION

This manual provides detailed instructions for the installation, operation, and maintenance of your Wasserstein Horizontal Adjustable Mount, specifically designed for the Google Nest Doorbell (Wired, 2nd Gen). This mount enhances your doorbell's viewing angles and is built for outdoor durability.





*The Wasserstein Horizontal Adjustable Mount shown with a Google Nest Doorbell (Wired, 2nd Gen) installed, demonstrating its compact design.*

## COMPATIBILITY

---

This mount is exclusively compatible with the Google Nest Doorbell (Wired, 2nd Gen). It is not designed for the Google Nest Doorbell (Battery Version) or the Google Nest Hello Doorbell.

# Compatability



Google Nest  
Doorbell  
(wired, 2nd gen)

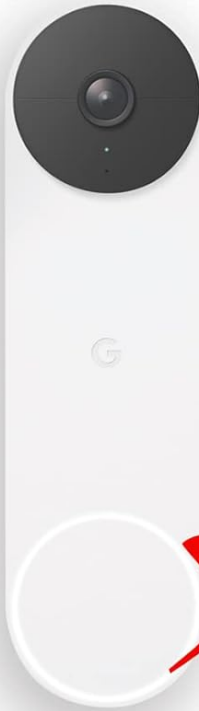

Google Nest  
Doorbell  
(battery)



Google Nest  
Hello Doorbell

*A visual guide confirming compatibility with the Google Nest Doorbell (Wired, 2nd Gen) and explicitly showing incompatibility with the battery version and Nest Hello Doorbell.*

## PACKAGE CONTENTS

Please refer to your product packaging for a complete list of included items. Typically, the package contains:

- Wasserstein Horizontal Adjustable Mount
- Mounting Screws and Wall Anchors
- Small Screwdriver (for angle adjustment)
- Instruction Manual

## SETUP AND INSTALLATION

The Wasserstein Horizontal Adjustable Mount is designed for hassle-free installation. Follow these steps to securely mount your Google Nest Doorbell (Wired, 2nd Gen):

1. **Prepare the Mounting Surface:** Ensure the surface where you intend to install the mount is clean and suitable for drilling.

2. **Mark Drilling Points:** Hold the mount against the wall at your desired installation height and mark the screw holes.
3. **Drill Pilot Holes:** Drill pilot holes at the marked points. Insert wall anchors if mounting into drywall or masonry.
4. **Attach the Mount:** Secure the Wasserstein mount to the wall using the provided screws.
5. **Attach Doorbell Base:** Connect the Google Nest Doorbell (Wired, 2nd Gen) base plate to the Wasserstein mount. The components are designed to fit smoothly.
6. **Secure Doorbell:** Mount your Google Nest Doorbell (Wired, 2nd Gen) onto its base plate, ensuring it clicks securely into place.

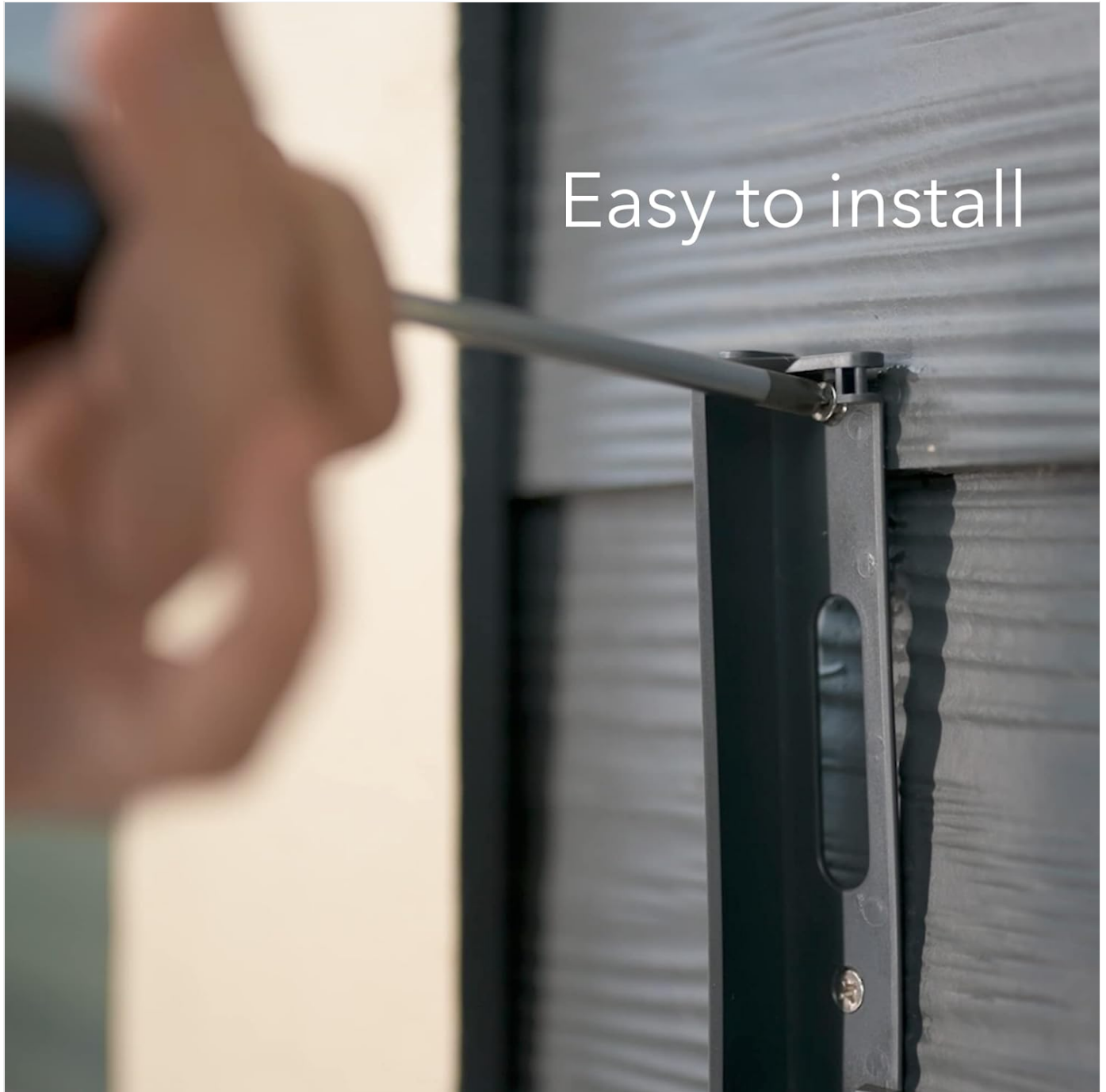

*The image depicts the straightforward installation process of the mount, requiring basic tools to secure it to the mounting surface.*

## OPERATING INSTRUCTIONS: ADJUSTING THE VIEWING ANGLE

The primary function of this mount is to provide an adjustable horizontal viewing angle for your doorbell. This allows you to optimize the camera's field of view to cover your desired area, such as your porch or pathway.

1. **Identify Adjustment Screws:** Locate the small adjustment screws on the side of the mount. A magnetic screwdriver is recommended due to their size.
2. **Loosen Screws:** Gently loosen the adjustment screws. Do not remove them completely.
3. **Adjust Angle:** Carefully pivot the doorbell and mount assembly to achieve your desired horizontal angle. The mount allows for adjustment between 35° and 55°.
4. **Tighten Screws:** Once the desired angle is set, securely tighten the adjustment screws to lock the mount in position.



*This image illustrates the horizontal adjustment capability of the mount, allowing for angles between 35 and 55 degrees to optimize the doorbell's field of view.*





*This image highlights how the adjustable mount enhances the doorbell's viewing angle, capturing a broader perspective of the entrance area and approaching individuals.*

## MAINTENANCE

The Wasserstein Horizontal Adjustable Mount is constructed from rugged materials designed to withstand various outdoor weather conditions, including wind and rain. Minimal maintenance is required:

- **Cleaning:** Periodically wipe the mount with a damp cloth to remove dust and dirt. Avoid abrasive cleaners.
- **Inspection:** Occasionally check that all screws are tight and the mount remains securely fastened to the wall.





*This image shows the mount and doorbell enduring outdoor conditions, emphasizing the product's durable, weatherproof construction suitable for various environments.*

## TROUBLESHOOTING

---

- **Mount feels loose:** Ensure all mounting screws securing the bracket to the wall are tightened. If the doorbell itself feels loose on the mount, ensure it is properly clicked into its base.
- **Difficulty adjusting angle:** Loosen the adjustment screws sufficiently before attempting to change the angle. Do not force the adjustment. If screws are too small, use a magnetic screwdriver.
- **Incorrect doorbell model:** Verify that your doorbell is the Google Nest Doorbell (Wired, 2nd Gen). This mount is not compatible with battery versions or Nest Hello. Refer to the compatibility section.

## SPECIFICATIONS

---





Product Dimensions	4.53 x 1.38 x 1.18 inches
Item Weight	1.76 ounces
Compatibility	Google Nest Doorbell (Wired, 2nd Gen)
Adjustable Angle	35° to 55° horizontal adjustment
Material	Rugged, weatherproof materials
Color	Black
Manufacturer	Wasserstein

## WARRANTY AND SUPPORT





For warranty information or technical support, please contact Wasserstein directly through their official website or the retailer where the product was purchased. Keep your proof of purchase for warranty claims. You can visit the official Wasserstein store for more products and support:[Wasserstein Store](#)



### Related Documents - Horizontal Adjustable Mount

<div><div>Wall Plate</div><div>USER MANUAL</div><div></div><div><div>W</div><div>WASSERSTEIN</div><div></div></div></div>	<div><a href="#">Wasserstein Wall Plate User Manual for Google Nest Doorbell (2nd Gen)</a></div> <div>This user manual provides installation instructions for the Wasserstein Wall Plate, designed to be compatible with the Google Nest Doorbell (Wired, 2nd Gen). It details the contents of the box, compatibility, and step-by-step installation procedures for both standard mounting and using the doorbell wedge. Learn how to securely mount your doorbell with this accessory.</div>
<div><div>Horizontal Adjustable Angle Mount For Google Nest Doorbell (battery)</div><div>USER MANUAL</div><div></div><div><div>W</div><div>WASSERSTEIN</div><div></div></div></div>	<div><a href="#">Wasserstein Horizontal Adjustable Angle Mount for Google Nest Doorbell (battery) - User Manual</a></div> <div>Detailed user manual for the Wasserstein Horizontal Adjustable Angle Mount, designed for the Google Nest Doorbell (battery). Learn how to install and adjust your doorbell's viewing angle for optimal security.</div>

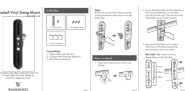

	<p><a href="#"><u>Wasserstein Solar Panel for Google Nest Doorbell (Battery) User Manual</u></a></p> <p>User manual for the Wasserstein Solar Panel, designed to continuously charge the Google Nest Doorbell (Battery). Includes installation instructions for various mounting options, product contents, and frequently asked questions about battery performance and optimization.</p>
	<p><a href="#"><u>Wasserstein Solar Charger for Nest Doorbell (battery) User Manual</u></a></p> <p>Comprehensive user manual for the Wasserstein Solar Charger designed for the Google Nest Doorbell (battery). Includes setup, installation, and troubleshooting guidance.</p>
	<p><a href="#"><u>Wasserstein Doorbell Vinyl Siding Mount: Installation Guide &amp; User Manual</u></a></p> <p>Detailed user manual and installation guide for the Wasserstein Doorbell Vinyl Siding Mount. Learn how to easily install the mount for Wyze Video Doorbell Pro, Google Nest Doorbell (Battery), and Blink Video Doorbell. Includes product specifications and support contact.</p>
	<p><a href="#"><u>Wasserstein 2-in-1 Gutter Mount User Manual for Google Nest Cam</u></a></p> <p>Comprehensive user manual for the Wasserstein 2-in-1 Gutter Mount, detailing installation, compatibility, and safety information for Google Nest Cam and Wasserstein Solar Panels.</p>