

[Manuals.plus](#) /

› [NEEWER](#) /

› NEEWER Teleprompter X14 Instruction Manual

## NEEWER X14

# NEEWER Teleprompter X14 Instruction Manual

Model: X14

## 1. PRODUCT OVERVIEW

---

The NEEWER X14 Teleprompter is a portable, foldable device designed to assist with video recording, live streaming, and presentations by displaying scripts clearly. It supports a wide range of devices including DSLR cameras, mirrorless cameras, camcorders, iPads, Android tablets, and smartphones.



Image: The NEEWER Teleprompter X14 shown with its remote control and a protective carrying case. The teleprompter is mounted on a tripod with a camera attached, and a tablet displaying text is positioned below the beam splitter glass.

## Package Contents:

- 1 x X14 Foldable Teleprompter
- 1 x RT-110 Remote Control
- 1 x Carrying Case
- 1 x Cleaning Cloth
- 1 x User Manual

## 2. SETUP INSTRUCTIONS

The NEEWER X14 Teleprompter features an integrated, foldable design that requires no assembly out of the box. Follow these steps for initial setup:

1. **Unpack:** Carefully remove the teleprompter from its carrying case. The unit is designed to be ready for use immediately.
2. **Mounting:** Attach the teleprompter to a video tripod, ball head tripod, or other compatible tripod using

the 1/4" or 3/8" threaded holes located on the bottom of the unit. Ensure the teleprompter is securely fastened.

3. **Unfold:** Gently unfold the teleprompter's hood and glass frame. The hinged glass frame can tilt up to 135° for optimal viewing angles.
4. **Secure Hood:** The hood features inner magnetic rods to keep it taut during use, preventing light leakage and ensuring clear reflection.

## No Assembly Needed

The integrated design makes X14 ready to use when taken out of the box and requires no assembly at all.



**1** Take it out of the box



**2** Mount it on a tripod



**3** Unfold the teleprompter

Image: A visual guide demonstrating the three simple steps for setting up the NEEWER X14 Teleprompter: taking it out of the box, mounting it on a tripod, and unfolding the teleprompter.

### Device Compatibility and Placement:

- **Camera:** Attach your DSLR camera, mirrorless camera, or camcorder to the teleprompter using the standard 1/4" mounting screw. Ensure the camera lens is positioned correctly to shoot through the beam splitter glass.
- **Tablet/Smartphone:** The expandable holder accommodates tablets and phones up to 8.7 inches (22.1 cm) wide. This includes devices like the 12.9" iPad Pro, 11" iPad Pro, iPad, iPad mini, and various Android tablets and smartphones. Place your device securely in the holder with the screen facing upwards towards the beam splitter.

**Note:** The teleprompter is not compatible with wide-angle lenses. The focal length of the camera lens needs to be more than 28mm to avoid vignetting.



## Wide Compatibility

Compatible with iPads Android tablets

Maximum Width: **8.7in/22.1cm**



Compatible with Samsung, Huawei



Compatible with iPad, iPad Air, iPad Pro 11", iPad (2021) 12.9"

NOTE: Only X14 Foldable Teleprompter is included.

Image: An illustration showing the wide compatibility of the NEEWER X14 Teleprompter with various tablets, including iPads and Android devices, highlighting the maximum width of 8.7 inches (22.1 cm).

### 3. OPERATING INSTRUCTIONS

#### Beam Splitter Glass:

The 14-inch high-definition clear beam splitter glass offers 75% light transmission, ensuring your camera captures clear footage while reflecting your script with high clarity. This allows for comfortable reading within a 10-foot (3-meter) range.

# High-definition Display

The crystal-clear beam splitter makes sure the text is easy to read.



Light Transmittance

UP  
TO **75%**

Image: A close-up view of the NEEWER X14 Teleprompter's beam splitter glass, emphasizing its high-definition display and up to 75% light transmittance for clear text readability.

## NEEWER Teleprompter App and RT-110 Remote Control:

The NEEWER Teleprompter App, available for free on major app stores, is compatible with iOS 11.0/Android 6.0 or later. It allows you to import, compose, edit, and monitor your scripts. The included RT-110 remote control pairs with the app via Bluetooth for convenient script management.

- **App Download:**
  - [Download for iOS](#)
  - [Download for Android](#)
- **Remote Pairing:** To pair the RT-110 remote, enable Bluetooth on your smartphone or tablet, then link the remote **within the NEEWER Teleprompter App**. Do not attempt to pair it directly through your device's Bluetooth settings.
- **Remote Functions:** The RT-110 remote allows you to:
  - Play/Pause script scrolling.
  - Adjust scrolling speed (speed up/slow down).
  - Change font size (zoom in/out).

- Page up/down (when paused).



## EASY TO OPERATE

Easily control the scrolling speed, play, pause, and turn pages with the remote

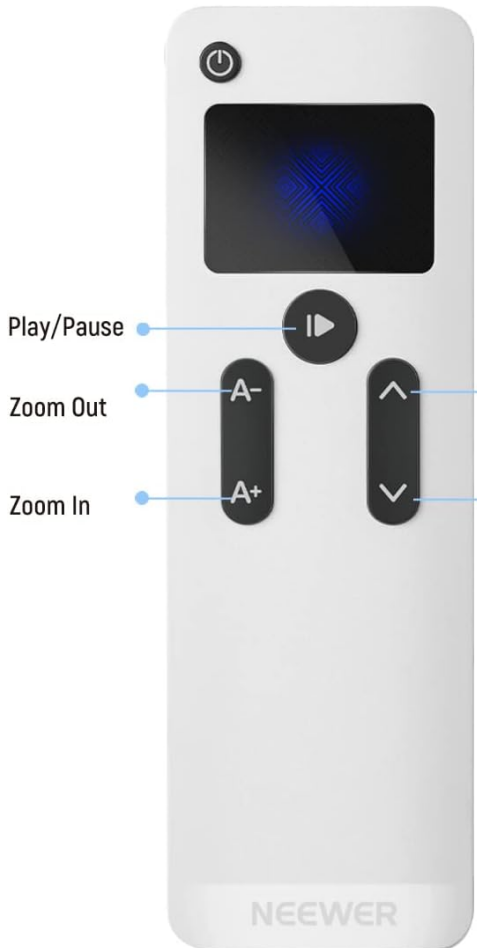

Play/Pause

Zoom Out

Zoom In

Fast Forward (Playing)  
Page Up (Paused)

Slow Down (Playing)  
Page Down (Paused)

### Note:

The remote control needs to be linked IN THE APP instead of linking it directly via bluetooth of your smartphone or tablet.



Play/Pause



Change  
Font Size



Adjust  
Scroll Speed



Page  
Up/Down

Image: An overview of the NEEWER Teleprompter App and RT-110 remote control, showing the app interface on a tablet and the remote with its various functions. QR codes for iOS and Android app downloads are also visible.

# Strong Magnetic Support

Inner magnetic rods keep the drawstring hood taut during use



Reinforced Metal Rods



Strong Magnetic Connection



Detachable Mechanism

Image: A detailed diagram of the RT-110 remote control, labeling buttons for Play/Pause, Zoom Out (Font Size -), Zoom In (Font Size +), Fast Forward (Playing) / Page Up (Paused), and Slow Down (Playing) / Page Down (Paused).

## Expandability:

The teleprompter features dual cold shoe mounts and 1/4" threads on both sides. This allows for the attachment of additional accessories such as microphones, LED lights, and other photographic equipment, enhancing your video production setup.



Image: A close-up view of the NEEWER X14 Teleprompter's side, highlighting the universal cold shoe mounts and 1/4" threaded holes for attaching accessories like microphones or LED lights.

## 4. MAINTENANCE

Proper maintenance ensures the longevity and optimal performance of your NEEWER Teleprompter X14.

- **Cleaning the Beam Splitter Glass:** Use the provided cleaning cloth or a soft, lint-free microfiber cloth specifically designed for optics. Apply a small amount of lens cleaning solution if necessary. Avoid harsh chemicals or abrasive materials that could scratch the glass.
- **General Cleaning:** Wipe down the teleprompter's body with a soft, dry cloth to remove dust and fingerprints.
- **Storage:** When not in use, store the teleprompter in its heavy-duty carrying case to protect it from dust, moisture, and physical damage. Ensure the unit is folded correctly before placing it in the case.
- **Battery Replacement (RT-110 Remote):** The RT-110 remote requires 2 AAA batteries. Replace them when the connection indicator light dims or the remote becomes unresponsive.





Image: A person carrying the NEEWER Teleprompter X14 in its heavy-duty, black carrying case with the NEEWER logo, illustrating its portability and protection.

## 5. TROUBLESHOOTING

---

If you encounter issues with your NEEWER Teleprompter X14, refer to the following common troubleshooting steps:

- **Text Not Clear/Reflected:**
  - Ensure the tablet/smartphone screen brightness is set to maximum.
  - Verify the beam splitter glass is clean and free of smudges.
  - Adjust the angle of the hinged glass frame for optimal reflection.
- **Remote Control Not Connecting/Responding:**
  - Check if the RT-110 remote has fresh AAA batteries.
  - Ensure Bluetooth is enabled on your tablet/smartphone.
  - Confirm the remote is paired **within the NEEWER Teleprompter App**, not directly through your device's Bluetooth settings.
  - If the remote becomes unresponsive during use, ensure it is not out of range or obstructed.
- **Camera Lens Vignetting:**
  - Ensure your camera lens has a focal length greater than 28mm. Wide-angle lenses are not compatible.
  - Adjust the camera's position to ensure it is centered and close enough to the beam splitter opening.
- **Stability Issues:**
  - Ensure the teleprompter is securely mounted to a stable tripod.
  - Verify all locking mechanisms on the tripod and teleprompter are tightened.

## 6. SPECIFICATIONS

Feature	Specification
Product Dimensions	11.81 x 10.39 x 5.04 inches
Item Weight	2.2 pounds
Model Number	X14
Beam Splitter Size	14 inches
Light Transmission	75%
Reading Range	Up to 10 feet (3 meters)
Glass Frame Tilt Angle	135°
Tablet/Phone Compatibility	Up to 8.7 inches (22.1 cm) wide
Camera Mounting	Standard 1/4" screw
Tripod Mounting	1/4" and 3/8" threads
Remote Control	RT-110 (Bluetooth)
Remote Batteries	2 x AAA batteries (required)
App Compatibility	iOS 11.0/Android 6.0 or later
Manufacturer	NEEWER

## 7. WARRANTY AND SUPPORT

NEEWER products are designed for reliability and performance. For specific warranty details, please refer to the documentation included with your purchase or visit the official NEEWER website.

### Customer Support:

If you have any questions, require technical assistance, or need to report an issue, please contact NEEWER customer support through their official channels:

- **Official Website:** [www.neewer.com](http://www.neewer.com)
- **Facebook:** [facebook.com/Neewer.Store](https://facebook.com/Neewer.Store)
- **TikTok:** [tiktok.com/@neewerofficial](https://tiktok.com/@neewerofficial)

Please retain your proof of purchase for warranty claims.