

## Huepar DT30

# Huepar DT30 2-in-1 Laser Tape Measure User Manual

Model: DT30

## 1. INTRODUCTION

---

This manual provides detailed instructions for the safe and effective use of your Huepar DT30 2-in-1 Laser Tape Measure. This device combines a laser distance meter with a traditional tape measure, offering versatility for various measurement tasks. Please read this manual thoroughly before operating the device.



Image 1.1: Huepar DT30 2-in-1 Laser Tape Measure and accessories.

## 2. SAFETY INFORMATION

**WARNING:** This product emits a Class II laser. Avoid direct eye exposure to the laser beam. Do not stare into the beam. Do not aim the laser at people or animals. Use caution when operating near reflective surfaces.

- Always operate the device in accordance with the instructions in this manual.
- Do not attempt to modify or disassemble the device.
- Keep the device out of reach of children.
- Ensure the device is clean and dry before use.
- Do not use the device in explosive atmospheres or near flammable materials.

## 3. PRODUCT OVERVIEW

Familiarize yourself with the components of your Huepar DT30 laser tape measure:



Image 3.1: Labeled components of the Huepar DT30.

1. LCD screen: Displays measurements, modes, and battery status.
2. Brake Lock: Secures the tape measure blade in position.
3. Ruler hook: End hook for tape measure.
4. Laser receiving port: Sensor for laser measurements.
5. Laser emission port: Emits the laser beam.
6. Digital display tape measure/laser mode button: Switches between digital tape and laser modes.
7. Function button: Cycles through measurement functions (Area, Volume, Pythagorean).
8. Measuring button: Activates laser measurement.
9. Measure reference/unit switch button: Changes measurement reference point and units.
10. Record button: Saves measurement data.
11. ON/OFF button: Powers the device on or off.
12. USB charging port: Type-C port for charging the internal battery.

## 4. SETUP

### 4.1 Charging the Battery

The Huepar DT30 is equipped with a built-in 380mAh Li-ion battery. Before first use, fully charge the device.

- Connect the provided Type-C USB cable to the charging port (12) on the device.
- Connect the other end of the USB cable to a compatible USB power source (e.g., phone charger, laptop, power bank).
- The battery indicator on the LCD screen will show charging status.
- A full charge typically takes approximately 3600 single measurements.

#### 4.2 Power On/Off

- To power on: Press the **ON/OFF button (11)**. The LCD screen will illuminate.
- To power off: Press and hold the **ON/OFF button (11)** for a few seconds. The device will also automatically shut down after 180 seconds of inactivity to conserve battery. The laser will automatically cut off after 30 seconds of inactivity.

## 5. OPERATING INSTRUCTIONS

---

### 5.1 Switching Measurement Modes (Laser / Tape)

The DT30 offers both laser and traditional tape measurement. Short press the **Digital display tape measure/laser mode button (6)** to switch between these two modes.



Image 5.1: Switching between digital tape and laser measurement modes.

### 5.2 Changing Units

Short press the **Measure reference/unit switch button (9)** to cycle through the available measurement units: meters (m), feet (ft), inches (in), and fractional inches (" ").

## 4 Units Change

Short press  to change distance unit among (m/ft/in/0'0")

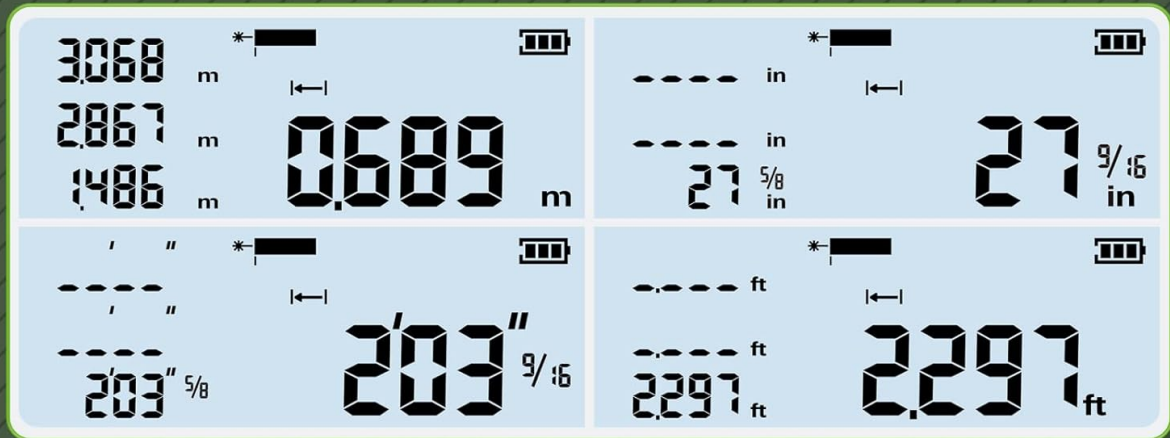

Image 5.2: Unit selection options on the DT30.

### 5.3 Adjusting Measuring Reference

The laser measurement can be taken from the front or the rear of the device. Long press the **Measure reference/unit switch button (9)** to toggle between the front and rear reference points. The LCD screen will indicate the selected reference.

## Adjusting Measuring Reference

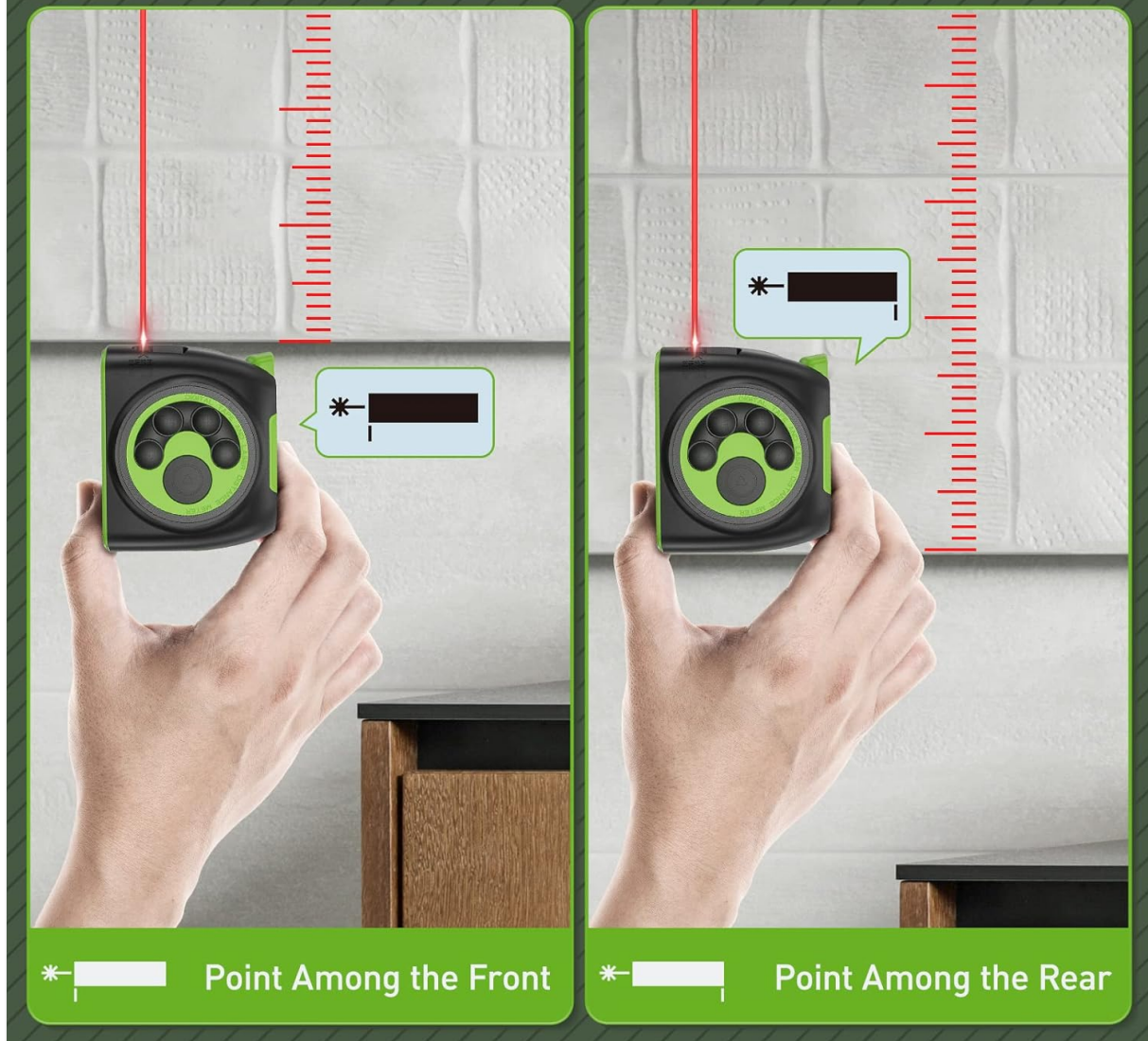

Image 5.3: Adjusting the measurement reference point.

### 5.4 Laser Measurement Modes

Press the **Function button (7)** to cycle through the following laser measurement modes:

- **Single Distance Measurement:** Press the **Measuring button (8)** once to activate the laser, then press again to take a single measurement.
- **Continuous Measurement:** Press the **Measuring button (8)** once to activate the laser. The distance will update in real-time as you move the device. Press again to stop.
- **Area Measurement:** Select Area mode. Take two perpendicular distance measurements (length and width). The device will automatically calculate and display the area.
- **Volume Measurement:** Select Volume mode. Take three perpendicular distance measurements (length, width, height). The device will automatically calculate and display the volume.
- **Pythagorean Measurement (2-point & 3-point):** Select the desired Pythagorean mode. Follow the on-screen prompts to take the required measurements for indirect height or distance calculations.

# Measurement & Calculation

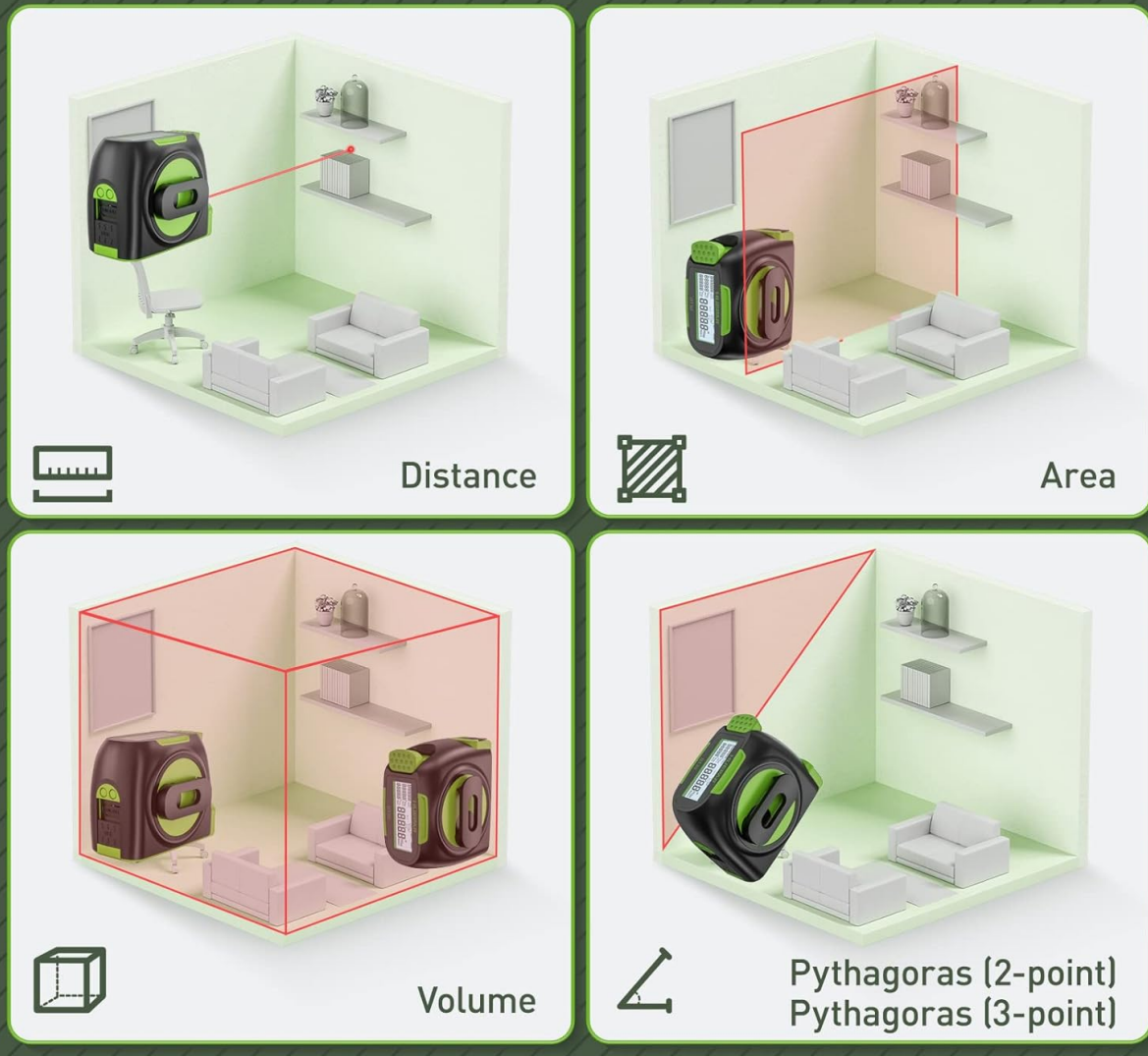

Image 5.4: Overview of measurement and calculation modes.

## 5.5 Tape Measure Usage

- Pull out the tape measure blade to the desired length.
- Use the **Brake Lock (2)** to secure the tape in place.
- The movable ruler hook (3) allows for accurate internal and external measurements. For internal measurements, the inner side of the hook is the zero point. For external measurements, the outer side of the hook is the zero point.

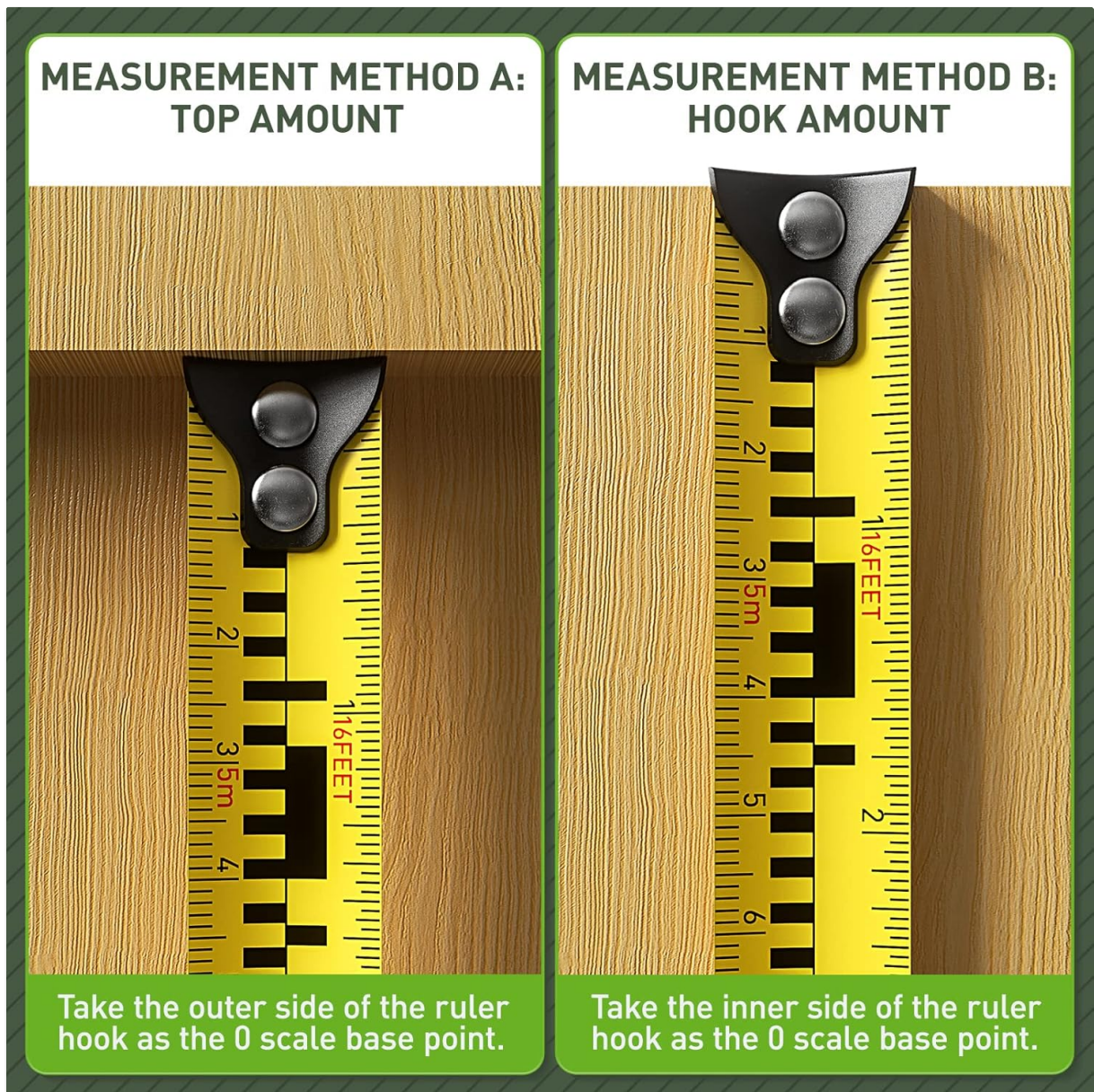

Image 5.5: Tape measurement methods using the ruler hook.

## 5.6 Data Storage

The device can store up to 50 groups of measurement data. Long press the **Record button (10)** to access the stored data. Short press to navigate through the records.



Image 5.6: Data storage function for reviewing past measurements.

## 6. MAINTENANCE

- **Cleaning:** Wipe the device with a soft, damp cloth. Do not use abrasive cleaners or solvents.
- **Storage:** Store the device in a cool, dry place away from direct sunlight and extreme temperatures.

- **Battery Care:** Recharge the battery regularly, even if the device is not in frequent use, to maintain battery health. Avoid fully discharging the battery for extended periods.

## 7. TROUBLESHOOTING

Problem	Possible Cause	Solution
Device does not turn on	Low battery; Device malfunction	Charge the battery; If problem persists, contact support.
Inaccurate laser measurements	Incorrect reference point; Obstruction in laser path; Environmental factors (e.g., strong light)	Verify reference point setting; Ensure clear laser path; Measure in suitable conditions.
Tape measure brake not holding	Mechanism wear or damage	Avoid forcing the tape; If damaged, contact support for repair or replacement.
LCD screen not visible	Low battery; Backlight off; Extreme temperatures	Charge battery; Backlight automatically turns off after 10s of inactivity, press any button to reactivate; Use within specified temperature range.
Data storage issues	Memory full; Device malfunction	Delete old data if memory is full; If problem persists, contact support.

## 8. SPECIFICATIONS

Feature	Specification
Model	DT30
Laser Class	Class 2, output power <1mW
Laser Wavelength	630~670nm
Laser Measuring Range	0.65~197Ft (0.2~60m)
Tape Measuring Range	16Ft (5m)
Measuring Accuracy	±1/16 inch (±2mm)
Power Source	Built-in 380mAh Li-ion Battery
Battery Life (single measurement)	Approx. 3600 times
Charging Port	TYPE-C
Max Data Storage	50 groups
Measuring Units	m/ft/in/" "
Automatic Laser Cut Off	30s
Automatic Shutdown	180s

Feature	Specification
Automatic Backlight Turn Off	10s
Dimensions	3.54 x 2.23 x 2.91 inches (90 x 56.8 x 74mm)
Weight	1.06 ounces (30 Grams)
Case Material	Acrylonitrile Butadiene Styrene (ABS)

## 9. WARRANTY AND SUPPORT

### 9.1 Warranty Information

Huepar offers a **2 or 3-year warranty** for free repair or replacement, depending on the specific product and region. Please refer to your purchase documentation for exact warranty terms.

### 9.2 Customer Support

For any issues, questions, or technical assistance, please contact the Huepar support team. You can expect a reply within 24 hours. Lifetime technical support is provided for this product.

- **Contact Information:** Refer to the contact details provided with your product packaging or visit the official Huepar website.



Image 9.1: Huepar After-sale Service Support overview.