

## NOKLEAD 5253T

# NOKLEAD Digital Indoor Thermometer Hygrometer

MODEL: 5253T

### Introduction

Thank you for choosing the NOKLEAD Digital Indoor Thermometer Hygrometer. This device provides accurate and real-time monitoring of indoor temperature and humidity, along with a clock display. Designed for ease of use, it helps you maintain a comfortable and healthy living environment. Please read this manual carefully before use to ensure proper operation and longevity of your device.

### Key Features

- **Fast Refresh & High Accuracy:** Updates readings every 10 seconds with temperature accuracy of  $\pm 1^{\circ}\text{C}$  (0-40 $^{\circ}\text{C}$ ) /  $\pm 2^{\circ}\text{C}$  (40-60 $^{\circ}\text{C}$ ) and humidity accuracy of  $\pm 3\%\text{RH}$ .
- **Air Comfort Indicator:** Displays DRY, COMFORT, or WET conditions at a glance.
- **3.34-inch LCD Display:** Clear, bold numbers for easy readability from various angles.
- **Multiple Mounting Options:** Includes desktop stand, magnetic attachment, and adhesive pad for wall mounting.
- **Long Battery Life:** Powered by 2 x CR2032 button cell batteries, lasting 8-12 months.
- **Time and Date Display:** Integrated clock function with 12h/24h selection.
- **Upgraded Calibration Function:** Allows for manual adjustment of temperature and humidity readings for optimal accuracy.



Figure 1: Overview of device features.

## What's in the Box

- NOKLEAD Digital Indoor Thermometer Hygrometer x 1
- CR2032 Button Cell Batteries x 2 (one installed, one spare)
- Adhesive Metal Pad x 1
- User Manual x 1

## Product Overview



Figure 2: Front display of the device.

The device features a large LCD screen displaying temperature (in °C or °F), relative humidity (%), a comfort level indicator (DRY, COMFORT, WET), current time, and date. On the back, you will find the battery compartment and control buttons for settings.



Figure 3: Rear view with battery compartment and buttons.

## Setup

### Battery Installation

1. Locate the battery compartment cover on the back of the device.
2. Remove the cover.
3. Insert two CR2032 button cell batteries, ensuring correct polarity (+/-). One battery is typically pre-installed.
4. Replace the battery compartment cover. The device will power on automatically.

### Placement Options

The NOKLEAD 5253T offers versatile placement options:

- **Desktop Stand:** Utilize the integrated foldable stand on the back to place the device on any flat surface, such as a desk, shelf, or counter.
- **Magnetic Attachment:** The device has a built-in magnet, allowing it to be securely attached to metallic surfaces like refrigerators.
- **Wall Mounting:** Use the provided adhesive metal pad to stick the device to a non-metallic wall surface.

## Widely-used in Daily Life



Bedroom



Greenhouse



Baby Room



Office



Classroom



Warehouse

Figure 4: Examples of device placement in different environments.



## Operation

### Power On/Off

The device automatically powers on once batteries are installed. There is no manual power on/off button.

### Temperature Unit Selection (°C/°F)

To switch between Celsius (°C) and Fahrenheit (°F), press the  $\pm$  button located on the back of the device.



Figure 5: Switching between °C and °F.

### Time Format Selection (12h/24h)

To switch between 12-hour and 24-hour time formats, press the  $\pm$  button located on the back of the device.



Figure 6: Switching between 12h and 24h time formats.

### Air Comfort Indicator

The device features a visual comfort indicator bar that quickly displays the current air conditions:

- **DRY:** Humidity below 30%
- **COMFORT:** Humidity between 30% and 69%
- **WET:** Humidity 70% or above

This indicator helps you determine if a humidifier or dehumidifier is needed to maintain optimal indoor air quality.



Figure 7: Air Comfort Indicator ranges.

## Calibration Function

If you suspect the readings are inaccurate due to placement or environmental factors, you can calibrate the sensor. The calibration allows for adjustments of up to  $\pm 5^{\circ}\text{C}/\pm 41^{\circ}\text{F}$  for temperature and  $\pm 10\%\text{RH}$  for humidity. Refer to the detailed instructions provided in the full user manual for the specific calibration procedure.

## Maintenance

### Cleaning

Wipe the device with a soft, dry cloth. Do not use abrasive cleaners or immerse the device in water.

### Battery Replacement

When the display becomes dim or the device stops functioning, replace the CR2032 batteries. Follow the battery installation steps outlined in the Setup section.

## Troubleshooting

- **No Display:** Ensure batteries are correctly installed with proper polarity. Replace batteries if they are depleted.
- **Inaccurate Readings:** Allow the device to stabilize for at least 30 minutes after initial setup or relocation. If discrepancies persist, utilize the calibration function as described in the Operation section.
- **Display Not Changing:** The device refreshes every 10 seconds. Ensure there are actual changes in temperature or humidity for the display to update.

## Specifications

Feature	Specification
Model Number	5253T
Temperature Range	14.2°F - 140°F (-9.9°C - 60°C)
Temperature Accuracy	±2°F (1°C)
Humidity Range	10% - 95% RH
Humidity Accuracy	±3% RH
Refresh Rate	Every 10 seconds
Display Size	3.34 inches
Power Source	2 x CR2032 Button Cell Batteries
Product Dimensions	2.76 x 2.76 x 0.55 inches (70mm x 70mm x 14mm)
Item Weight	2.12 ounces (60 grams)

## Warranty and Support

NOKLEAD products are designed for reliability and performance. If you encounter any issues or have questions regarding your NOKLEAD Digital Indoor Thermometer Hygrometer, please contact our customer support team. We are committed to providing the best possible solution for you.

For support, please refer to the contact information provided with your purchase or visit the official NOKLEAD website.

### Related Documents - 5253T

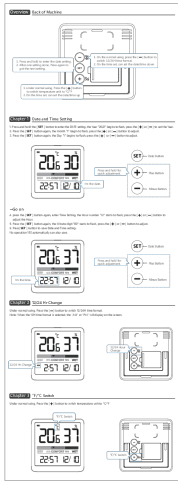

### [NOKLEAD 5253T Indoor Thermometer Hygrometer User Guide](#)

User guide for the NOKLEAD 5253T indoor thermometer and hygrometer, detailing setup, date/time setting, and unit switching for temperature and time formats.

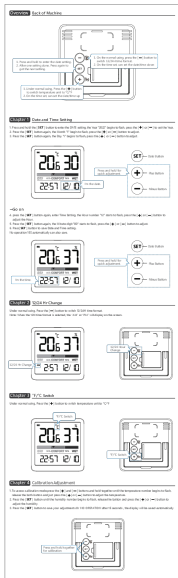

### [NOKLEAD Hygrometer Indoor Thermometer User Guide](#)

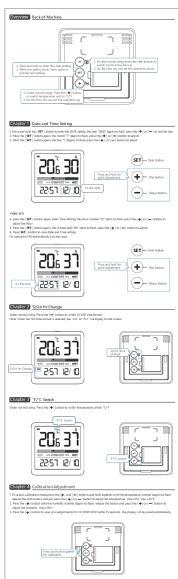

User guide for the NOKLEAD Hygrometer Indoor Thermometer. This document provides instructions on setting the date and time, switching between 12/24 hour formats, changing temperature units (°C/°F), and performing calibration adjustments for temperature and humidity.



### [Noklead 5253T Digital Thermohygrometer User Guide](#)

User guide for the Noklead 5253T digital thermohygrometer, covering date/time settings, temperature units (°C/°F), 12/24 hour format, and calibration adjustments. Provides instructions for operating and maintaining the device.

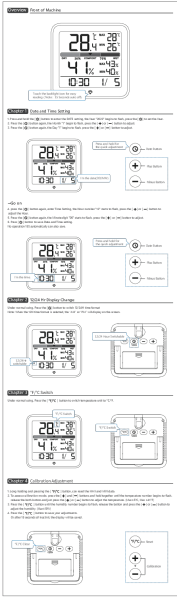
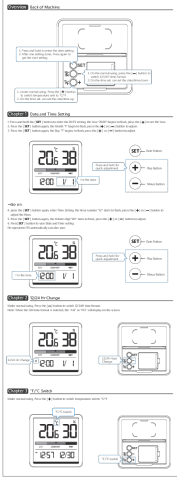

	<p><a href="#">NOKLEAD Digital Hygrometer Thermometer User Manual - Setup and Calibration Guide</a></p> <p>User guide for the NOKLEAD digital hygrometer thermometer, detailing setup, date/time setting, display format switching, temperature unit selection (°C/°F), and calibration procedures for accurate temperature and humidity readings.</p>
	<p><a href="#">NOKLEAD Digital Thermometer Hygrometer User Guide</a></p> <p>User guide for the NOKLEAD Digital Thermometer Hygrometer (models NK5253, 5253WG), detailing how to set the date, time, 12/24 hour format, and temperature units (°C/°F).</p>
	<p><a href="#">NOKLEAD Portable Digital Alarm Clock User Manual</a></p> <p>Comprehensive user manual for the NOKLEAD portable digital alarm clock, covering setup, features, functions, and safety instructions. Learn how to set the time, alarm, snooze, adjust brightness, and understand battery indicators.</p>