



[Manuals.plus](#) /

> [Gaoducash](#) /

> Gaoducash WiFi Door Window Sensor Alarm: User Manual for Model WIFI DOOR ALARM

## Gaoducash WIFI DOOR ALARM

# Gaoducash WiFi Door Window Sensor Alarm User Manual

Model: WIFI DOOR ALARM

[Overview](#)   [Package Contents](#)   [Specifications](#)   [Installation](#)   [Operation](#)   [Features](#)  
[Troubleshooting](#)   [Warranty & Support](#)

## 1. PRODUCT OVERVIEW

The Gaoducash WiFi Door Window Sensor Alarm provides real-time monitoring of doors and windows. When triggered, it activates a 120dB siren and sends instant notifications to your smartphone via the companion app. This system helps protect your property and ensures family safety. The device also supports timed arming and disarming, and can be shared with family members for collaborative home security management.

This sensor is designed for easy integration into smart home ecosystems and offers voice control compatibility with platforms like Alexa and Google Assistant.

## 2. PACKAGE CONTENTS

- 1x Gaoducash WiFi Window Sensor Alarm
- 2x AAA Batteries
- 1x Adhesive Sticker
- 1x User's Manual (this document)

## 3. TECHNICAL SPECIFICATIONS

<b>App</b>	Tuya Smart or Smart Life
<b>Sound Alarm</b>	120dB

<b>Battery</b>	LR03-1.5V/AAA*2 (Alkaline battery, included)
<b>Battery Life</b>	Approximately 6200 triggers
<b>Standby Current</b>	8uA
<b>Alarm Current</b>	70mA~120mA
<b>Wireless Type</b>	ONLY 2.4GHz WiFi network (does NOT support 5GHz WiFi)
<b>Wireless Standard</b>	IEEE 802.11b/g/n
<b>Working Temperature</b>	0°C~40°C (32°F~104°F)
<b>Material</b>	ABS
<b>Main Body Dimensions</b>	2.83 IN x 1.18 IN x 0.75 IN (7.19 cm x 3.00 cm x 1.91 cm)
<b>Small Body Dimensions</b>	1.79 IN x 0.61 IN x 0.55 IN (4.55 cm x 1.55 cm x 1.40 cm)
<b>Item Weight</b>	1.76 ounces (50 grams)
<b>Mounting Type</b>	Adhesive (Pre-paste)
<b>Control Method</b>	App
<b>Smart Home Compatibility</b>	Alexa, Google Assistant

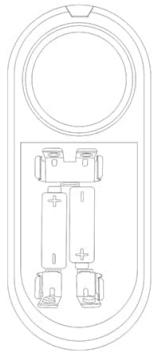

**Image:** Detailed dimensions of the main sensor unit and the magnetic contact piece.

## 4. INSTALLATION GUIDE

The Gaoducash WiFi Door Window Sensor Alarm is designed for easy, DIY installation without the need for wiring or screws. Follow these steps for proper setup:

1. **Insert Batteries:** Open the main sensor unit and insert the two AAA batteries provided. Ensure correct polarity.
2. **Prepare Adhesive:** Tear off the release paper from the back of the adhesive stickers. Apply one sticker to the back of the main sensor unit and another to the back of the smaller magnetic contact piece.
3. **Mount the Sensor:** Choose a clean, dry, and flat surface on your door or window frame. Position the main sensor unit and the magnetic contact piece on the same horizontal plane. The distance between the alignment marks (arrows) on both pieces should be approximately 1-2 cm when the door/window is closed. Press firmly to secure them.



1. Install 2 AAA batteries.

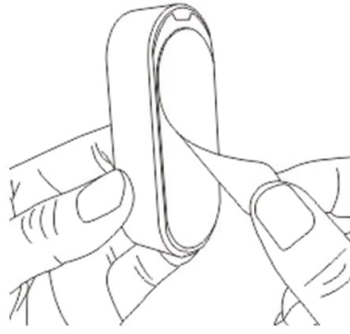

2. Tear off the double-sided tape.



3. Product fixed



**Image:** Visual guide demonstrating battery insertion, adhesive application, and proper sensor placement on a window frame.

## Connecting to the Mobile App

To connect your sensor to the mobile app, ensure your smartphone is connected to a 2.4GHz WiFi network. The sensor does not support 5GHz WiFi networks.

1. **Download App:** Download the "Tuya Smart" or "Smart Life" app from your smartphone's app store.
2. **Add Device:** Open the app, register or log in, and tap "Add Device" or the "+" icon. Select "Sensors" and then "Contact Sensor (Wi-Fi)".
3. **Reset Device:** Long press the setting button on the main sensor unit for approximately 6 seconds until the LED light starts flashing rapidly. Confirm this in the app.
4. **Connect to WiFi:** Enter your 2.4GHz WiFi network password in the app. The app will then search for and connect to the sensor.
5. **Completion:** Once successfully added, you can rename the device and begin monitoring.

Your browser does not support the video tag.

**Video:** This video demonstrates the process of connecting the Gaoducash WiFi Door Window Sensor Alarm to the mobile application, including device reset and WiFi pairing steps.

**Note on Network Failure:** If the magnetic distribution network fails, ensure there is a response when

pressing the sensor button. If not, remove and reinsert the battery. Also, verify that your current router supports and has the IEEE 802.11 b mode enabled in its settings to configure the network successfully.

## 5. OPERATING INSTRUCTIONS

### Real-time Monitoring and Alerts

Once installed and connected, the sensor will monitor the status of your door or window in real-time. When the door/window is opened or closed, the sensor will:

- Trigger a 120dB siren (if armed).
- Send an instant notification to your smartphone via the app.

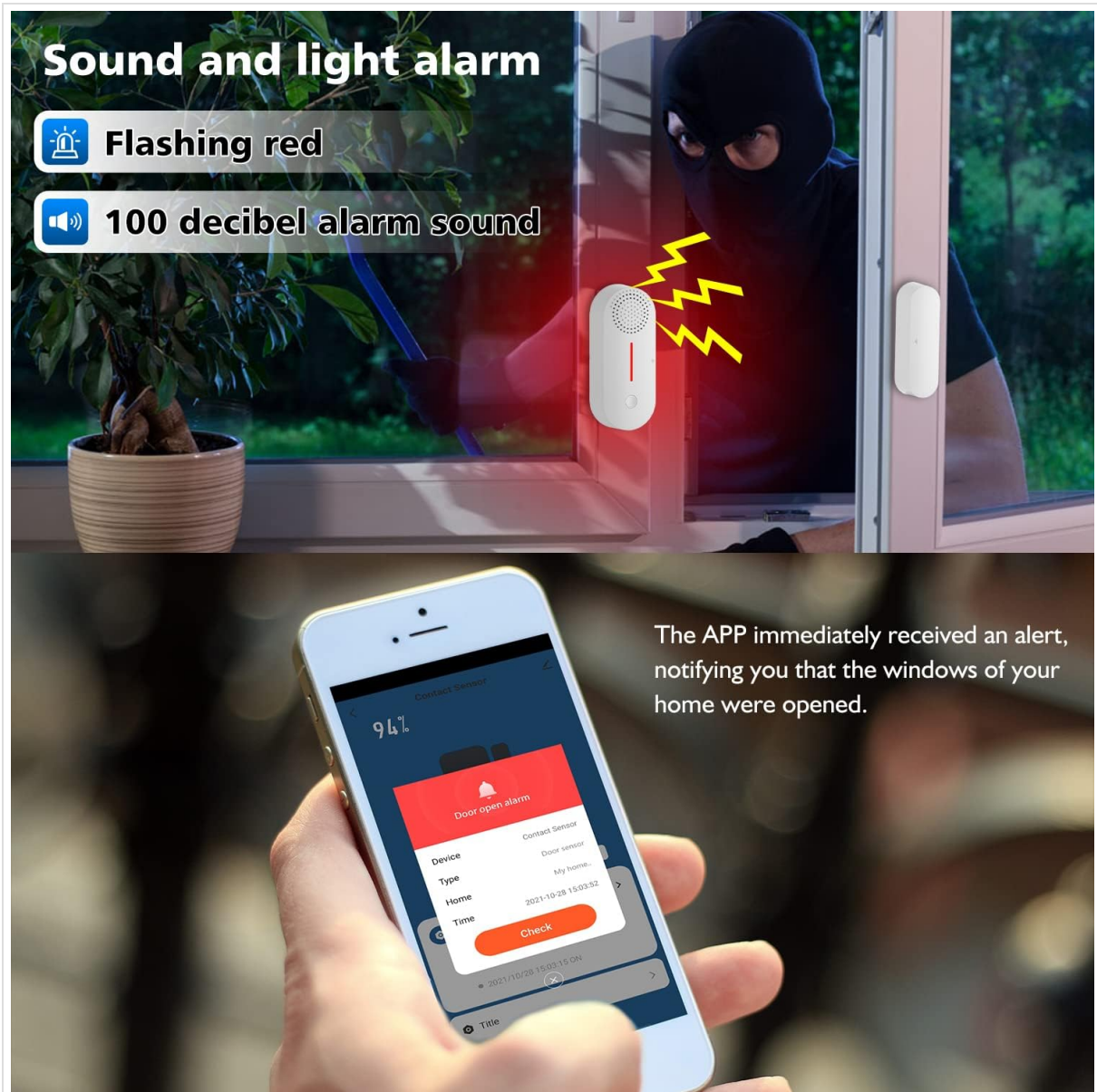

**Image:** Illustration of the sensor triggering an alarm with flashing red light and a loud sound, alongside a smartphone displaying an app alert for an opened window.

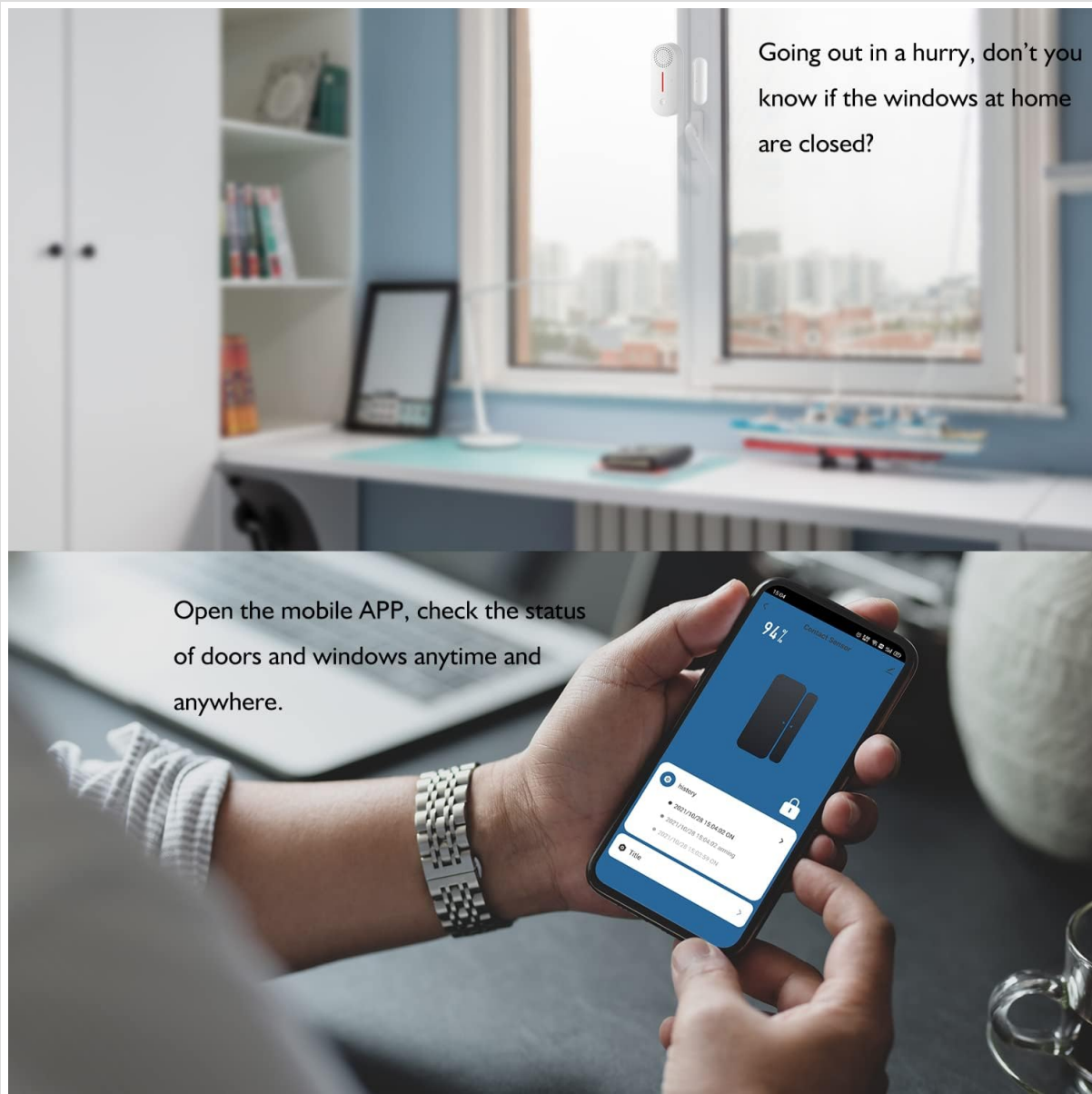

Going out in a hurry, don't you know if the windows at home are closed?

Open the mobile APP, check the status of doors and windows anytime and anywhere.

**Image:** A user checking the status of their doors and windows remotely using the mobile application on their smartphone.

## Arming and Disarming

The sensor supports both manual and timed arming/disarming:

- **Manual Control:** Use the mobile app to manually arm or disarm the sensor. When armed, the sensor will beep once ("Di"). When disarmed, it will beep twice ("Di, Di").
- **Timed Arming/Disarming:** Set schedules within the app for automatic arming and disarming at specific times or on certain days. For example, you can set it to arm automatically when you leave for work and disarm when you return.



**Image:** Visual representation of timed arming (e.g., 09:00 AM) and disarming (e.g., 06:00 PM) settings within the mobile app, showing the sensor's status changing accordingly.

## Voice Control

Integrate the Tuya Smart/Smart Life app with Amazon Alexa or Google Home for voice control. You can ask for the status of your door sensor, for example: "Alexa, is the front door closed?"

## Low Power Warning

The sensor will automatically send a notification to your app when the battery level is low, reminding you to replace the AAA batteries in a timely manner to ensure continuous protection.

## 6. KEY FEATURES

- **Wireless Operation:** No hub required, no subscription fees.
- **Dual Alarm Modes:** 120dB siren and instant smartphone notifications.
- **App Control:** Arming/disarming, delayed alarms, and alarm history search via Tuya Smart/Smart Life app.
- **Voice Assistant Compatibility:** Works with Alexa and Google Home for convenient voice commands.

- **Low Battery Alerts:** Receive notifications when batteries need replacement.
- **Smart Home Automation:** Link with other Tuya/Smart Life compatible devices to create automated routines (e.g., turn on lights when a door opens).
- **Easy Installation:** Simple adhesive mounting, no wiring or screws needed.
- **Versatile Use:** Suitable for home gates, windows, pet doors, refrigerators, and various rooms in homes or offices.

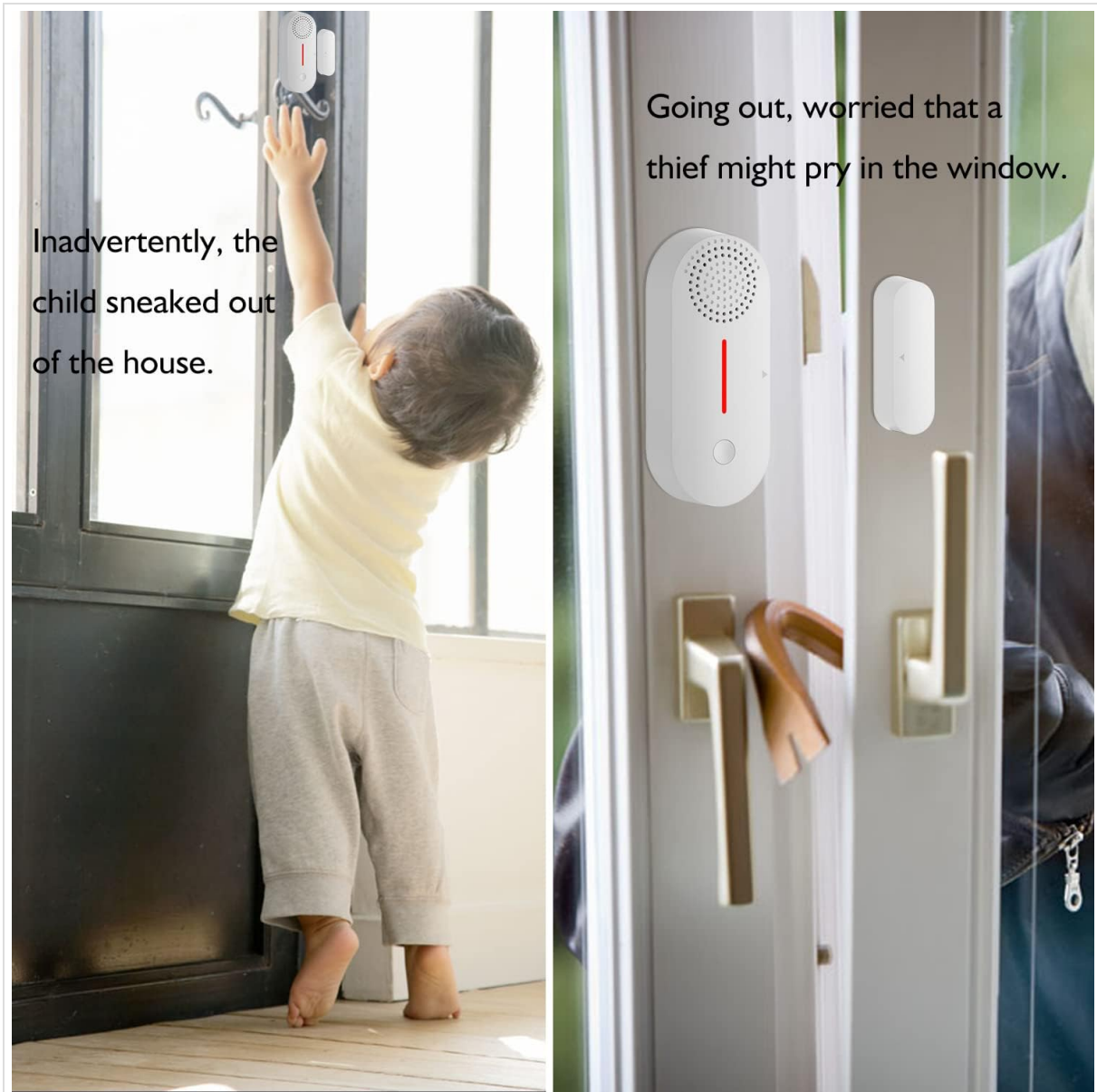

**Image:** Depicts the sensor's application in preventing a child from inadvertently leaving the house and deterring potential intruders from prying open a window.

## 7. TROUBLESHOOTING

- **Sensor Not Connecting to App:**
  - Ensure your phone is connected to a 2.4GHz WiFi network. The sensor does not support 5GHz WiFi.
  - Verify that the sensor's LED light is flashing rapidly during pairing mode. If not, long-press the setting button for 6 seconds to reset.
  - Check your router settings to ensure IEEE 802.11 b mode is enabled.
  - Confirm correct WiFi password entry in the app.

- Try restarting your router and the sensor.

- **No Alarm Sound or Notification:**

- Check if the sensor is armed in the app.
- Ensure the main sensor unit and magnetic piece are within 1-2 cm when the door/window is closed.
- Verify that app notifications are enabled on your smartphone and within the Tuya Smart/Smart Life app settings.
- Check battery level; replace if low.

- **False Alarms:**

- Ensure the sensor and magnet are securely mounted and do not shift.
- Verify the alignment distance (1-2 cm) when the door/window is closed.
- Check for any magnetic interference nearby.

- **Voice Control Not Working:**

- Ensure the Tuya Smart/Smart Life app is correctly linked to your Alexa or Google Home account.
- Check your internet connection.
- Try re-discovering devices in your Alexa/Google Home app.

## 8. WARRANTY AND SUPPORT

---

Gaoducash offers a **24-month warranty** on the WiFi Door Window Sensor Alarm. For technical support, warranty claims, or any inquiries, please contact Gaoducash customer service through the platform where you purchased the product or visit the official Gaoducash website for contact information.

For additional resources and product information, you may visit the [Gaoducash Store on Amazon](#).