

[Manuals.plus](#) /

› [EIGHTREE](#) /

› EIGHTREE HomeKit Smart Plug Instruction Manual (Model ET03-1)

EIGHTREE ET03-1

EIGHTREE HomeKit Smart Plug Instruction Manual

Model: ET03-1

1. INTRODUCTION

This manual provides detailed instructions for the setup, operation, and maintenance of your EIGHTREE HomeKit Smart Plug (Model ET03-1). Please read this manual thoroughly before using the product to ensure proper functionality and safety. This smart plug is designed to integrate seamlessly with Apple HomeKit for convenient control of your home appliances.

2. SAFETY INFORMATION

- For indoor use only. Do not expose to moisture or extreme temperatures.
- Ensure the smart plug is connected to a power outlet within its specified voltage and current ratings.
- Do not disassemble or modify the device.
- Avoid overloading the smart plug beyond its maximum wattage capacity. Refer to the Specifications section for details.
- Keep out of reach of children.

3. PACKAGE CONTENTS

Your package should contain the following items:

- EIGHTREE HomeKit Smart Plug(s) (quantity as purchased)
- Instruction Manual

4. PRODUCT OVERVIEW

The EIGHTREE HomeKit Smart Plug is a compact device designed to turn any standard wall outlet into a smart outlet. It features a power button and an indicator light for status feedback.

EIGHTREE Homekit Plugs



Easy Setup



Voice Control



Remote Control



Scenes and Automations



Device Sharing



Group Control



Image: EIGHTREE HomeKit Smart Plug in use, connected to a lamp.

Key Features:

- **Easy Setup:** Integrate with Apple Home App by scanning a QR code.
- **Voice Control:** Control connected devices using Siri.
- **Remote Control:** Manage devices from anywhere via the Home App (requires a home hub).
- **Scenes and Automations:** Create custom schedules and scenes for automated control.



**Simple Life
Easy Home**

Works with Apple HomeKit



Image: Overview of EIGHTREE HomeKit Smart Plug features.

5. SETUP INSTRUCTIONS

Follow these steps to set up your EIGHTREE HomeKit Smart Plug:

1. **Download the Apple Home App:** Ensure you have the Apple Home app installed on your iOS device.
2. **Plug In the Smart Plug:** Insert the EIGHTREE Smart Plug into a standard wall outlet.
3. **Add Accessory:** Open the Apple Home app. Tap the "+" icon or "Add Accessory" option.
4. **Scan QR Code:** Use your device's camera to scan the HomeKit QR code located on the smart plug or its packaging.
5. **Follow On-Screen Prompts:** The app will guide you through naming the accessory and assigning it to a room.

Important Note: The smart plug requires a **2.4GHz Wi-Fi network** for connection. It is not compatible with 5GHz Wi-Fi networks.

6. OPERATING INSTRUCTIONS

6.1 Manual Control

Press the physical button on the smart plug to manually turn the connected appliance on or off.

6.2 Voice Control with Siri

Once set up with Apple HomeKit, you can control your smart plug using Siri voice commands:

- Say, "Hey Siri, turn on [device name]."
- Say, "Hey Siri, turn off [device name]."
- Say, "Hey Siri, is [device name] on?"

Voice Control

Works with Apple HomeKit



"Hey Siri, turn on the Christmas lights."

"Okay"

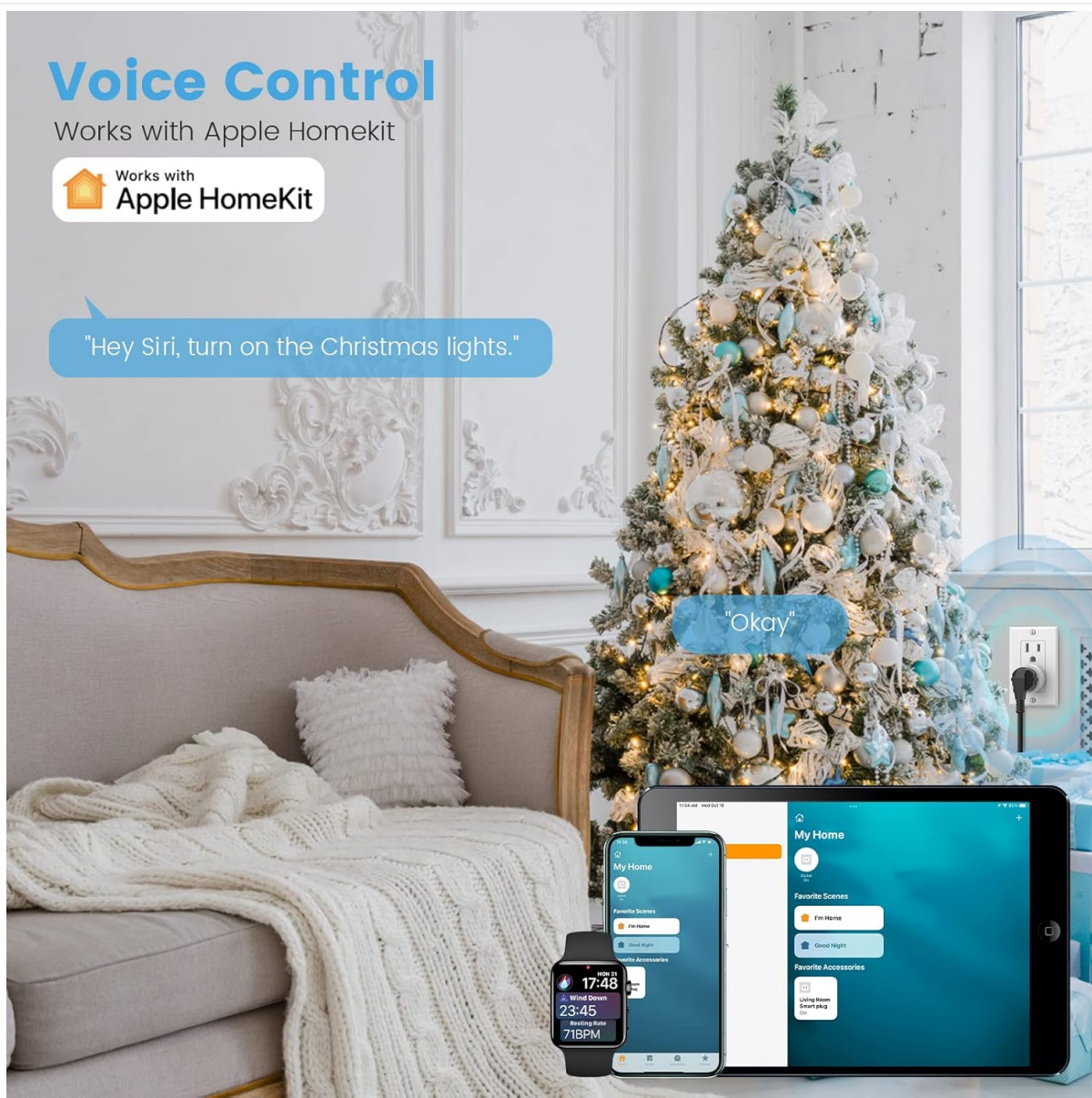


Image: Using Siri to control Christmas lights connected to the smart plug.

6.3 Remote Control

To control your smart plug when you are away from home, you need an Apple Home Hub (e.g., Apple TV, HomePod, or a dedicated iPad) set up in your home. The Home Hub must be powered on, connected to your home Wi-Fi network, and remain in your home.

Remote Control

To remotely control your HomeKit accessories you need to set up a home hub



Image: Remote control functionality via the Home app.

6.4 Scenes and Automations

Create custom scenes and time schedules within the Apple Home app to automate your devices:

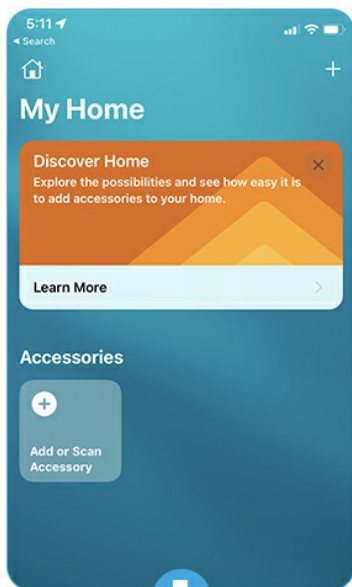
- **Scenes:** Group multiple accessories to respond to a single command (e.g., a "Good Morning" scene that turns on lights and a coffee maker).
- **Automations:** Set devices to turn on/off based on time of day, sunrise/sunset, or when you arrive/leave home.

Set Timers & Schedule

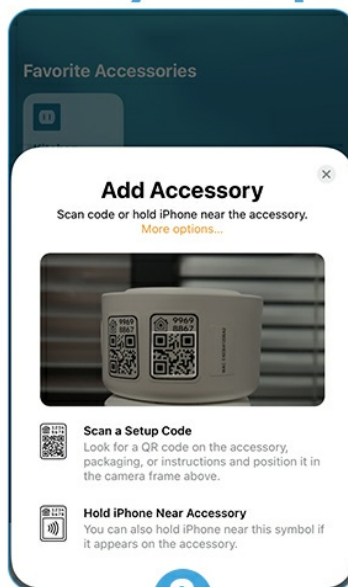


Image: Setting timers and schedules for smart devices.

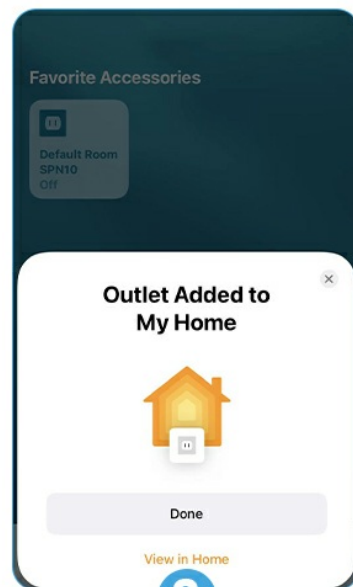
Easy Setup



1 Launch the Home APP



2 Scan the QR code on the plug



3 Added successfully

Image: Activating a 'sleep scene' using voice control.

6.5 Family Sharing

You can invite family members to control your HomeKit devices by adding their Apple IDs to the Home app. This allows multiple users to manage the smart plugs and other accessories.

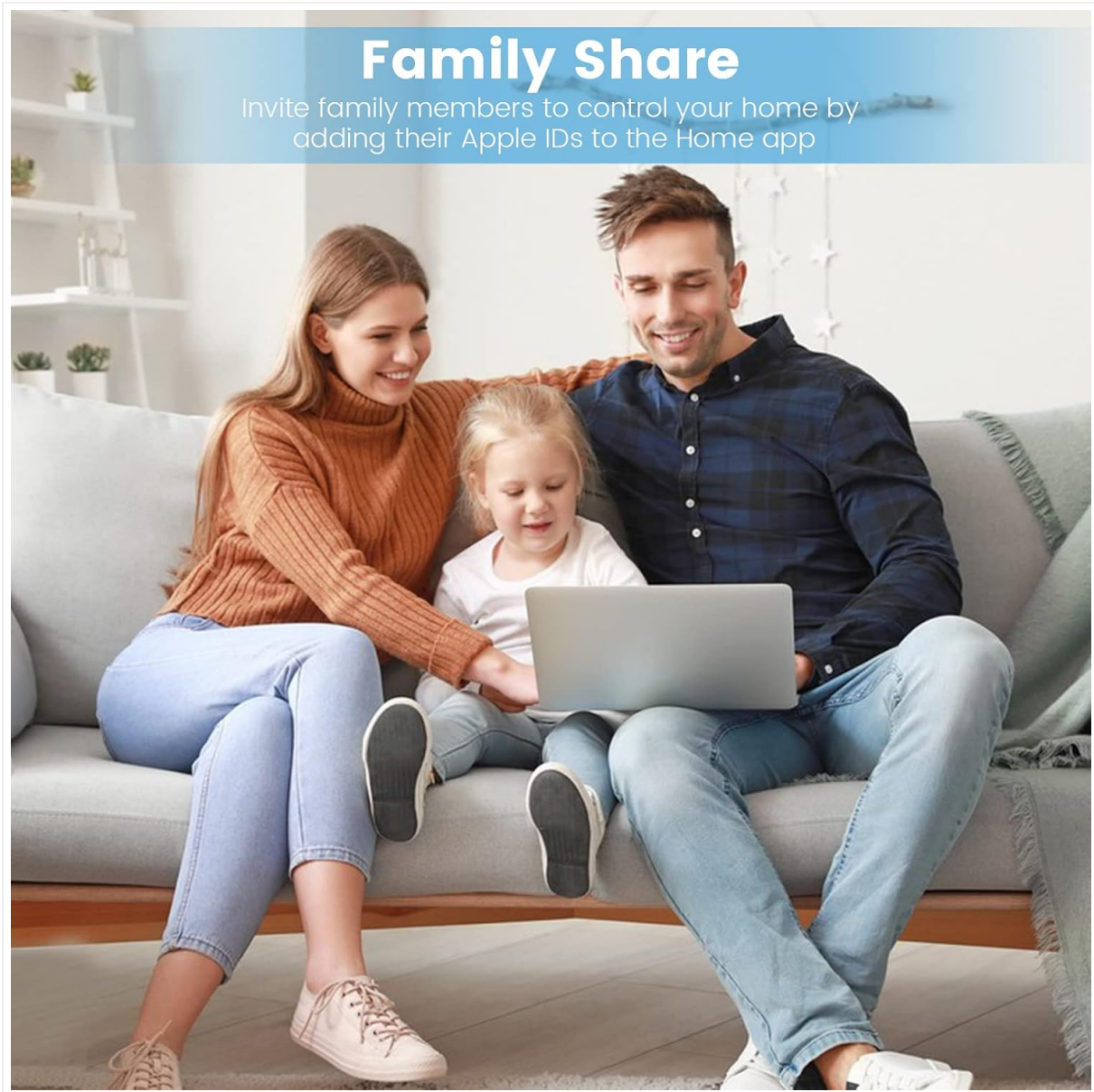


Image: Family sharing access to HomeKit devices.

7. MAINTENANCE

- **Cleaning:** Disconnect the smart plug from the power outlet before cleaning. Use a dry, soft cloth to wipe the surface. Do not use liquid cleaners or sprays.
- **Storage:** When not in use for extended periods, store the smart plug in a cool, dry place away from direct sunlight.

8. TROUBLESHOOTING

- **Device Not Connecting:**
 - Ensure your Wi-Fi network is 2.4GHz. The smart plug does not support 5GHz Wi-Fi.
 - Verify that your iOS device is connected to the same 2.4GHz Wi-Fi network during setup.

- Check if the smart plug is within range of your Wi-Fi router.
 - Try resetting the smart plug by unplugging it for 10 seconds and plugging it back in.
- **Remote Control Not Working:**
 - Confirm that you have an Apple Home Hub (Apple TV, HomePod, or dedicated iPad) set up and active in your home.
 - Ensure the Home Hub is powered on and connected to your home Wi-Fi network.
- **Siri Not Responding:**
 - Verify that Siri is enabled on your iOS device.
 - Ensure the smart plug is properly named and recognized in the Home app.

9. SPECIFICATIONS

Model	ET03-1
Brand	EIGHTREE
Operation Mode	ON-OFF
Current Rating	10 Amps
Operating Voltage	120 Volts
Wattage	1200 Watts
Connectivity Protocol	Wi-Fi (2.4GHz only)
Controller Type	Apple HomeKit, iOS
Control Method	Remote, Voice
Material	Acrylonitrile Butadiene Styrene
Item Dimensions (L x W x H)	1 x 1 x 1 inches
Mounting Type	Plug In Mount
International Protection Rating	IP44 (Note: Product is for indoor use)
Certification	FCC

10. WARRANTY

EIGHTREE provides a **2-year warranty** for this product from the date of purchase. This warranty covers manufacturing defects and malfunctions under normal use. It does not cover damage caused by misuse, accidents, unauthorized modifications, or external factors.



Image: EIGHTREE product certifications and warranty information.

11. CUSTOMER SUPPORT

If you encounter any issues or require further assistance, please contact EIGHTREE customer service directly via Amazon or email. Our team is available to provide support.

