



Manuals.plus /

- › **BORLTER CLAMP** /
- › BORLTER CLAMP TGX 3-in-1 USB Flash Drive User Manual

BORLTER CLAMP TGX

BORLTER CLAMP TGX 3-in-1 USB Flash Drive User Manual

Model: TGX | Capacity: 256GB

INTRODUCTION

This manual provides essential instructions for the proper use, setup, and maintenance of your BORLTER CLAMP TGX 3-in-1 USB Flash Drive. Please read this guide thoroughly before using the device to ensure optimal performance and data integrity.

PRODUCT OVERVIEW

The BORLTER CLAMP TGX is a versatile 3-in-1 flash drive designed for seamless data transfer and storage across various devices. It features a unique push-pull design that protects its three integrated connectors: USB-A 3.0, USB-C, and Micro-USB. This design allows for broad compatibility with Android phones, tablets, PCs, and Mac systems, supporting On-The-Go (OTG) functionality for mobile devices.

3 IN 1 Design

Three different interface devices can be used.



Type-c



USB 3.0



Micro

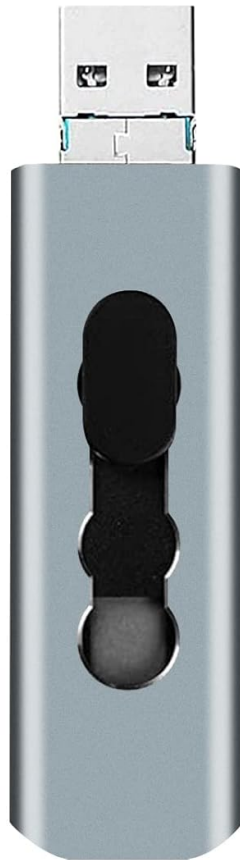
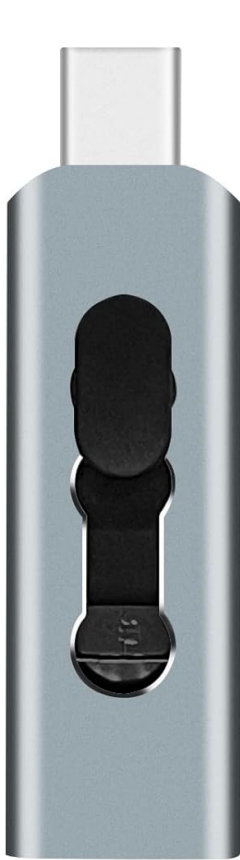

Image: The BORLTER CLAMP 3-in-1 Flash Drive illustrating its three distinct connectors: Type-C, USB 3.0, and Micro-USB.

Supports USB-OTG Function

No driver required for Windows 10/8/7/Vista/XP/MAC OS/Android

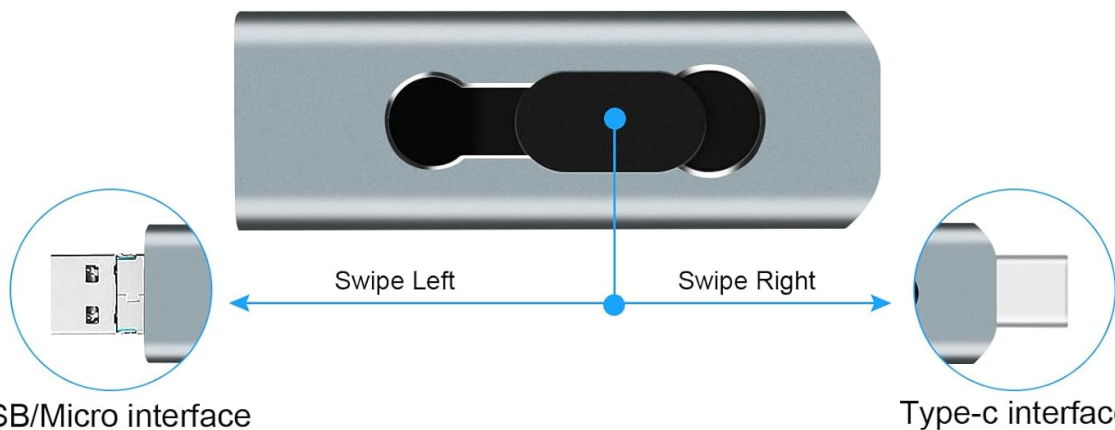

Image: The flash drive demonstrating its push-pull mechanism to reveal either the Micro-USB/USB-A or USB-C interface, highlighting its USB-OTG function for various devices.

The drive utilizes USB 3.0 technology for high-speed data transmission, significantly faster than USB 2.0, enabling quick transfer of large files. Its compact and lightweight design makes it portable and convenient for daily use.

SETUP

- 1. No Driver Installation Required:** The BORLTER CLAMP TGX flash drive is a plug-and-play device. No special drivers or software installation are needed for Windows (10/8/7/Vista/XP), Mac OS, or Android operating systems.
- 2. Connecting to a Device:**
 - **For USB-A (Standard USB) Ports:** Slide the flash drive's mechanism to expose the USB 3.0 connector. Insert it into an available USB-A port on your computer or compatible device.
 - **For USB-C Ports:** Slide the flash drive's mechanism to expose the USB-C connector. Insert it into an available USB-C port on your smartphone, tablet, or computer.
 - **For Micro-USB Ports:** Slide the flash drive's mechanism to expose the Micro-USB connector. Insert it into an available Micro-USB port on your Android smartphone or tablet. Ensure your mobile device supports USB OTG (On-The-Go) functionality.
- 3. Device Recognition:** Once connected, your device should automatically detect the flash drive. On computers, it will appear as a removable disk. On Android devices, you may receive a notification to open a file manager or access the drive directly.

OPERATING INSTRUCTIONS

Data Transfer

Transferring files to and from the flash drive is similar to using any standard external storage device.

1. On Computers (Windows/Mac):

- Open 'File Explorer' (Windows) or 'Finder' (Mac).
- Locate the flash drive under 'This PC' or 'Devices and Locations'.
- Drag and drop files or folders to copy them to or from the flash drive. Alternatively, use the 'Copy' and 'Paste' functions.

2. On Android Devices (with OTG support):

- Connect the flash drive to your phone's USB-C or Micro-USB port.
- Open your device's file manager application (e.g., 'Files', 'My Files', 'File Manager').
- Navigate to the flash drive, typically labeled as 'USB storage', 'OTG storage', or similar.
- You can now browse, copy, move, or delete files on the flash drive.

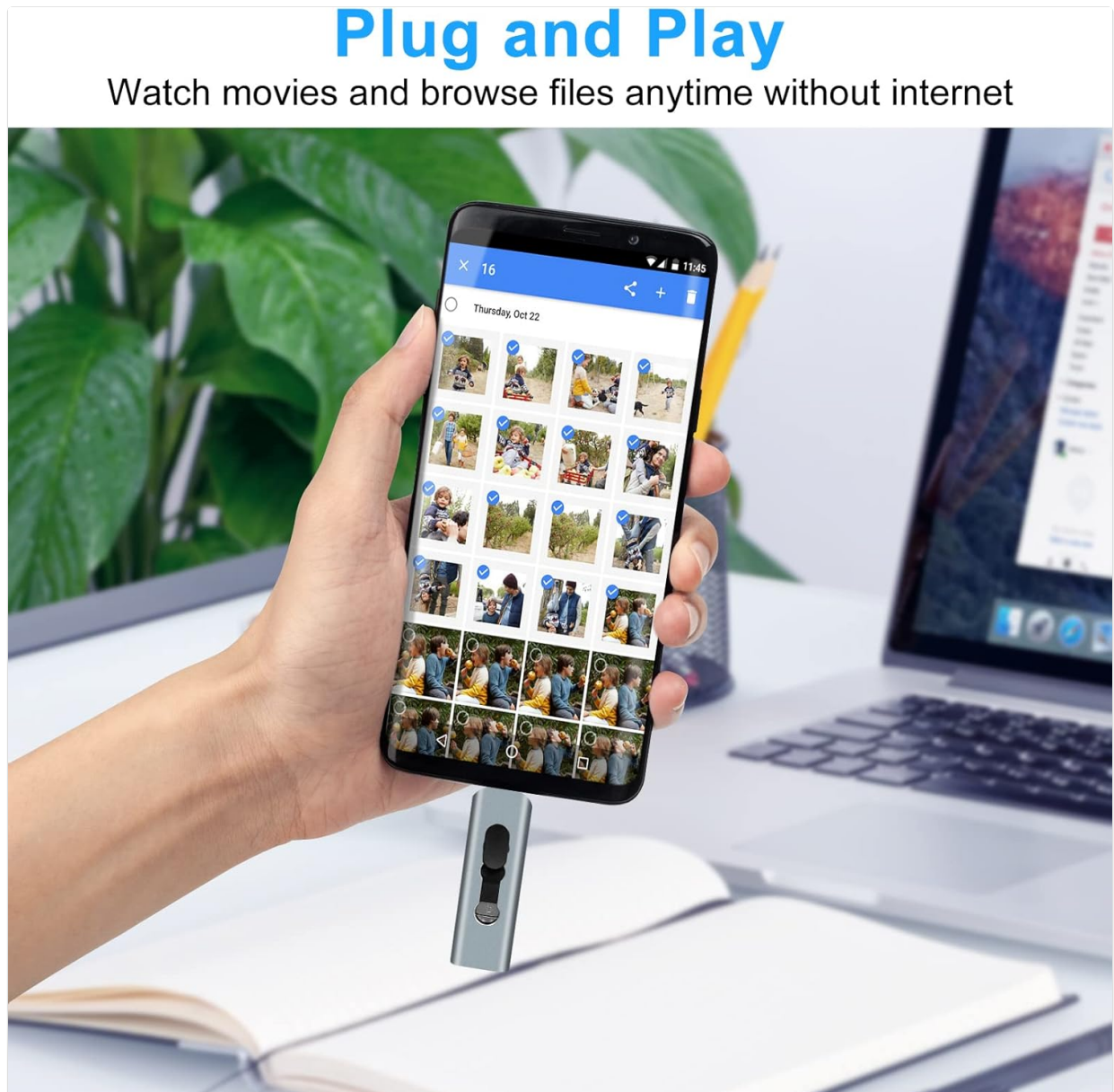

Image: An Android phone with the flash drive connected, showing a photo gallery, demonstrating plug-and-play access to media files.

Expanding Storage and Direct Saving

The flash drive can be used to expand your device's storage, allowing you to save photos, videos, and other large files directly to it, freeing up internal memory.



Available External USB Storage

Take photos and videos directly to flash drive,
No worries about the limited memory space on your mobile phone.

Image: An Android phone with the flash drive connected, displaying the camera application, indicating the ability to save photos and videos directly to external storage.

MAINTENANCE

- **Safe Removal:** Always safely eject the flash drive from your computer or mobile device before physically removing it. This prevents data corruption. On Windows, use the 'Safely Remove Hardware' icon in the taskbar. On Mac, drag the drive icon to the Trash or use the Eject button in Finder. On Android, unmount the USB storage via your device settings or notification panel.
- **Physical Care:** Keep the flash drive dry and away from extreme temperatures. Avoid dropping it or subjecting it to strong impacts. Use the push-pull mechanism gently to extend its lifespan and protect the connectors.
- **Cleaning:** If necessary, gently wipe the exterior of the flash drive with a soft, dry cloth. Do not use liquid cleaners or solvents.

TROUBLESHOOTING

Issue: Flash drive not recognized by device.

Solution:

- Ensure the flash drive is fully inserted into the port.
- Try a different USB port on your computer or another compatible device.
- For Android devices, verify that USB OTG functionality is enabled in your phone's settings (if applicable, some devices require manual activation).
- Restart your computer or mobile device and try again.
- Check if the drive appears in Disk Management (Windows) or Disk Utility (Mac) to see if it's detected but not assigned a drive letter or mounted.

Issue: Slow data transfer speeds.

Solution:

- Ensure you are connecting the flash drive to a USB 3.0 port on your computer (typically identified by a blue interior or SS symbol). USB 2.0 ports will result in slower speeds.
- Transferring many small files can be slower than transferring a single large file of the same total size.
- Close other applications that might be using system resources or performing background data transfers.

Issue: Cannot write files to the flash drive.

Solution:

- Check if the flash drive is full. Delete unnecessary files to free up space.
- Verify the file system of the flash drive. If it's formatted as FAT32, it has a 4GB per-file size limit. For larger files, consider reformatting to exFAT or NTFS (note: reformatting will erase all data).
- Ensure the drive is not set to read-only mode (though this is rare for flash drives).

Issue: Flash drive does not stay securely in the port.

Solution:

- Ensure the port on your device is clean and free of debris.
- Try connecting to a different port. If the issue persists across multiple ports, the flash drive's connector may be damaged.

SPECIFICATIONS

Feature	Detail
Model Name	TGX
Memory Storage Capacity	256 GB
Connectivity Technology	USB
Hardware Interface	USB 3.0 (compatible with USB 2.0 Micro B, USB Type A, USB Type C)
Read Speed	Up to 100 Megabytes Per Second
Special Feature	Compact, Lightweight, Push-Pull Design
Product Dimensions (LxWxH)	2.28 x 0.79 x 0.35 inches (5.8 x 2.0 x 0.9 cm)
Item Weight	0.352 ounces (10 grams)
Color	Silver Grey
Manufacturer	BORLTER CLAMP



Image: The BORLTER CLAMP 3-in-1 Flash Drive displayed with its dimensions, positioned alongside a laptop, smartphone, and camera for scale.

WARRANTY AND SUPPORT

For any product inquiries, technical assistance, or warranty claims, please contact BORLTER CLAMP customer support. Refer to the product packaging or the official BORLTER CLAMP website for the most current contact information.

You can also visit the BORLTER CLAMP Store on Amazon for additional product information and support resources.