

[Manuals.plus](#) /

> [datonten](#) /

> Datonten Replacement Garage Door Opener Remote for Genie & Overhead Door (ACSTG Type 1, 390MHz) - User Manual

## datonten ACSTG Type 1, 390MHz

# Datonten Replacement Garage Door Opener Remote User Manual

**Brand:** datonten | **Model:** Compatible with Genie & Overhead Door ACSTG Type 1, 390MHz

## INTRODUCTION

---



Image: Two black Datonten replacement garage door opener remotes, each with a single grey button and a red LED indicator, shown with their metallic visor clips.

This manual provides comprehensive instructions for the setup, operation, and maintenance of your Datonten Replacement Garage Door Opener Remote. Please read this manual carefully before use to ensure proper functionality and to maximize the lifespan of your device. This remote is designed for use with specific Genie and Overhead Door garage door openers.

## COMPATIBILITY

---

This remote is **ONLY** compatible with Intellicode Genie & Overhead Door garage door openers that operate at 390MHz and were manufactured since 1997. It is a direct replacement for the following Genie control remote types:

- ACSTG Type 1
- ACSTG Type 2
- ACSTG Type 3
- ACSGT Type 1, ACSGT Type 2, ACSGT Type 3
- ACSCTO Type 1, ACSCTO Type 2, ACSCTO Type 3
- GIC90-3, GICTD-1, GICT390-1, GIFT390-1, GIT390-4
- GIT-2, GIT-3, G2T-1, G2T-2, G2T-3, GL2T-BX, G1T-BX, GTR-3
- GIFTD-1, GICTD-1, GICTD-3, GITD-1, GITD-3, GIFT390-1, GIFTD-1, GIFTD-3
- TBSTG Type 1, TBSTG Type 2, TBSTG Type 3
- GMI3, GMIC-2, GIC90-1, GMIC90-3, GIC90-2, GMIC-3BL

**Important: This remote is NOT compatible with control remotes that use dip switches.**

# Garage Door Opener Remote

Compatible with Genie & Overhead Door  
Garage Openers [Only 390Mhz, Since 1995]  
Not Compatibility Dip Switch



**Quick & Easy Setup**



**Safe & Reliable**



**Wide Range**

Image: The Datonten remote shown in a residential setting, indicating its compatibility with Genie and Overhead Door garage openers operating at 390MHz since 1995. It highlights quick setup, safety, reliability, and wide range.

## PACKAGE CONTENTS

---

Each package includes the following items:

- 2 x Datonten Replacement Garage Door Opener Remotes
- 2 x 27A 12V Alkaline Batteries (pre-installed or included separately)
- 2 x Visor Clips
- 1 x User Manual (this document)

# Included with Purchase

Remote Control \* 2



Battery \* 2



Visor Clip \* 2

Image: A visual representation of the items included in your purchase: two remote controls, two 27A 12V alkaline batteries, and two visor clips.

## SETUP AND PROGRAMMING

The Datonten remote utilizes Intellicode technology for secure and easy push-button programming. No cutting into garage wiring or installation of an unsightly receiver is required.

### Programming Steps:

1. Ensure your garage door is closed before beginning the programming process.
2. Locate the "Learn Code" or "Program" button on your garage door opener motor head unit. This button is typically found near the antenna wire or the light bulb. Refer to your garage door opener's manual if you cannot locate it.
3. Press and release the "Learn Code" or "Program" button on your garage door opener. The LED indicator on the opener will usually light up or blink, indicating it is in programming mode.
4. Within 30 seconds, press and hold the desired button on your new Datonten remote for approximately 2 seconds, then release it.
5. Press the same button on your Datonten remote again for approximately 2 seconds, then release it.
6. The garage door opener's light may flash or click, or the door may move slightly, indicating successful programming.
7. Test the remote by pressing the programmed button. The garage door should operate.
8. If programming fails, refer to the Troubleshooting section or try programming a different button on the remote. Ensure you are close to the garage door opener during programming.



Image: A visual guide to programming the remote, showing the sequence of pressing the learn button on the opener and then the desired button on the remote twice.

## OPERATING INSTRUCTIONS

---

Once programmed, operating your Datonten remote is straightforward:

- **Opening/Closing the Door:** Press the programmed button on the remote once. The garage door will begin to open or close.
- **Stopping the Door:** Press the programmed button again while the door is in motion to stop it.
- **Range:** The remote operates effectively up to 150 feet from the garage door opener, providing convenient "no waiting" roll-in access. Optimal range is achieved with a clear line of sight to the opener.

# Convenient and Easy to Operate



Image: The remote's effective operating range of up to 150 feet is depicted, allowing users to open their garage door from a distance.

## MAINTENANCE

---

### Battery Replacement:

The remote uses a 27A 12V Alkaline battery. When the remote's LED indicator light dims or the remote's range decreases significantly, it's time to replace the battery.

1. Locate the battery compartment on the back of the remote.
2. Using a small screwdriver or coin, gently pry open the battery cover.
3. Remove the old 27A 12V battery.
4. Insert a new 27A 12V Alkaline battery, ensuring the positive (+) and negative (-) terminals are correctly aligned.
5. Snap the battery cover back into place.
6. Test the remote to ensure it functions correctly.

## Rugged and complete with accessories

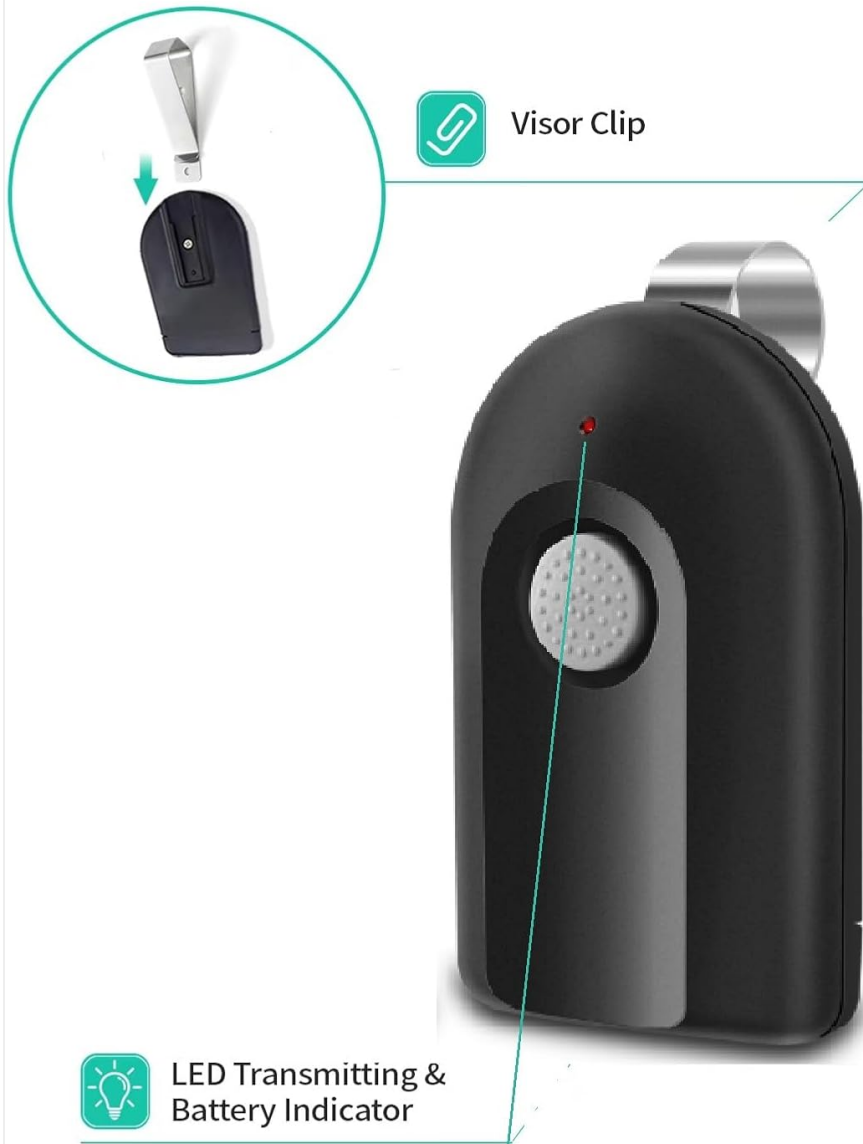

Image: A close-up view of the remote's interior, demonstrating the correct way to insert the 27A 12V alkaline battery into its compartment.

## TROUBLESHOOTING

---

If you encounter issues with your Datonten remote, try the following solutions:

- **Solution 1: Garage Door Closed**  
Your garage door must be fully closed before you start to program the remote. Programming may fail if the door is open.
- **Solution 2: Try Another Button**  
If one button doesn't program, try to program the remote using a different button on the remote.
- **Solution 3: Proximity to Opener**  
When programming the remote, ensure you are close to the garage door opener motor head unit.
- **Solution 4: Clear Opener Memory**  
If the garage door opener's memory is full, it may prevent new remotes from being programmed. Consult your garage door opener's manual for instructions on how to clear its memory, then attempt programming again.

# Troubleshooting



## Solution1 :

Your garage door must be closed before you start to program remote, otherwise programming maybe failed.



## Solution2 :

Try to program the remote using other button of the remote.



## Solution3 :

Please first get close to garage door opener when you program remote.



## Solution4 :

Maybe the memory of the opener is full, please clear it then program again.

Image: A graphic detailing four common troubleshooting solutions: ensuring the garage door is closed, trying a different remote button, programming close to the opener, and clearing the opener's memory.

## SPECIFICATIONS

<b>Brand</b>	datonten
<b>Model Compatibility</b>	Genie & Overhead Door Intellicode (ACSCTG Type 1, 2, 3, etc.)
<b>Frequency</b>	390 MHz
<b>Operating Range</b>	Up to 150 feet (approx. 45 meters)
<b>Power Source</b>	1 x 27A 12V Alkaline Battery (included)
<b>Dimensions (L x W x H)</b>	3.4 x 2 x 0.55 inches (approx. 8.6 x 5.1 x 1.4 cm)
<b>Item Weight</b>	3.17 ounces (approx. 90 grams)
<b>Color</b>	Black
<b>Special Features</b>	Lightweight, Easy Push-Button Programming

## WARRANTY AND SUPPORT

---

Specific warranty information for this product is not provided in the available documentation. For warranty details, technical support, or further assistance, please contact the manufacturer, Datonten, directly through their official channels or the retailer where the product was purchased.