

eppfun AK3046D

eppfun AK3046D Bluetooth Audio Transmitter User Manual

Model: AK3046D

1. INTRODUCTION

Thank you for choosing the eppfun AK3046D Bluetooth Audio Transmitter. This device is designed to provide high-quality wireless audio transmission from various sources to your Bluetooth-enabled headphones or speakers. Featuring advanced Bluetooth 5.2 technology and Qualcomm aptX-Adaptive codec support, it ensures stable, low-latency, and high-fidelity audio for an immersive listening experience.

2. PRODUCT OVERVIEW

2.1 Key Features

- **High-Resolution APTX-Adaptive HD:** Utilizes Qualcomm aptX-Adaptive low latency encoding for audio delay of approximately 60 milliseconds, ensuring synchronized audio and video.
- **Bluetooth 5.2 Technology:** Offers extended range and faster speeds compared to previous Bluetooth versions, providing a more stable wireless connection.
- **Multiple Input Methods:** Supports AUX 3.5mm, RCA, Digital Coaxial Audio (Coaxial), and Digital Optical (SPDIF Optical) inputs.
- **Wide Compatibility:** Compatible with various operating systems including PS4/5 OS, Windows, and Android OS.
- **Audio Decoding Support:** Supports aptX-Adaptive, aptX LL, aptX, aptX HD, and SBC codecs.

2.2 Package Contents

The package includes the eppfun AK3046D Bluetooth Audio Transmitter and various connection cables as shown below.

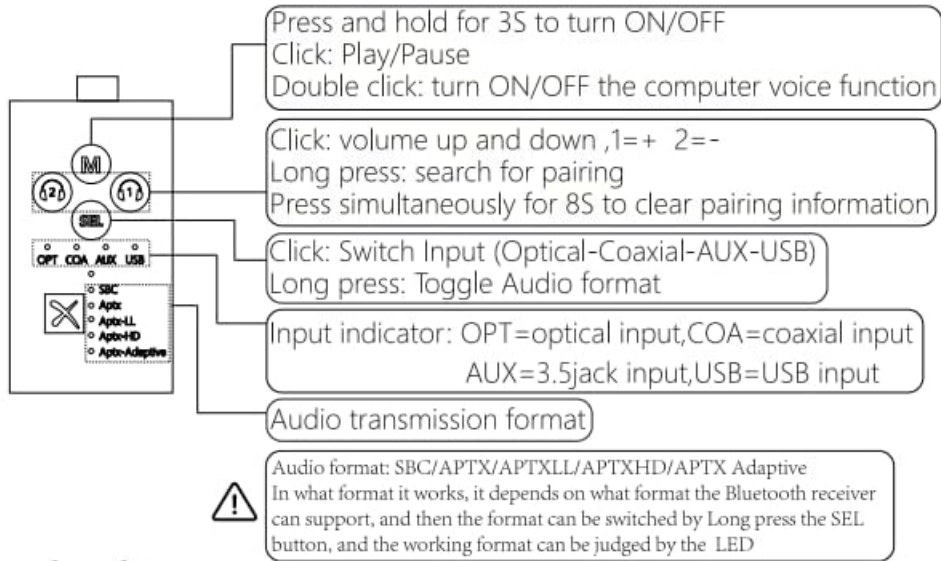

Figure 2.1: eppfun AK3046D Transmitter and accessories, including 3.5mm AUX, RCA, Fiber Optic, and Coaxial cables.

2.3 Device Layout and Controls

Familiarize yourself with the buttons, LED indicators, and input/output ports of the AK3046D transmitter.

① Button/LED function



② Interface function

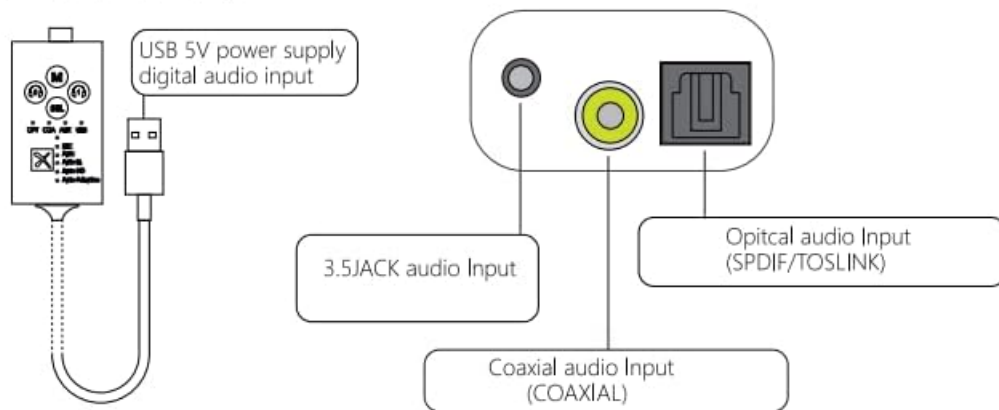
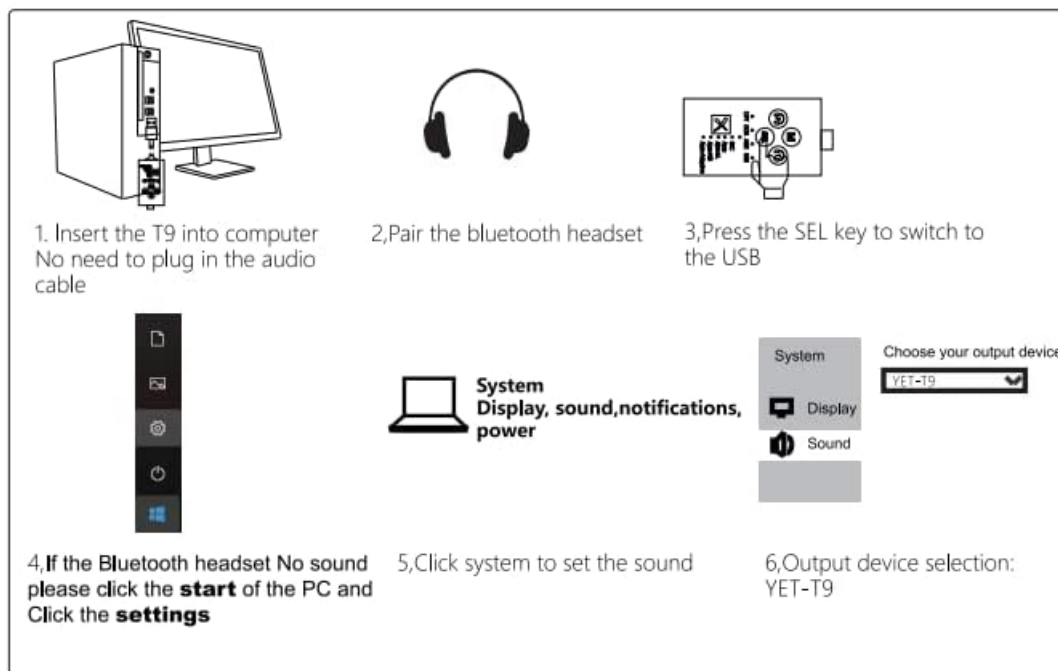

Figure 2.2: Button and LED functions. Includes Power/Play/Pause, Volume/Pairing, Mode (M), and Input Select (SEL) buttons, along with indicators for input type and audio codec.

⑤ T9 is used on the computer Play/pause, up/down music can be controlled through headphones when used on a computer



Notice:

1. T9 has a voice function. It is recommended to turn off this function when listening to music normally, otherwise it will affect the sound quality. Two ways:
A: double-click the MFB to turn ON/OFF the voice function
B: In the PC sound settings, "select input device" is not selected: YET-T9
2. In addition, if the PC has the listening function turned on, it will have a great impact on the sound quality, which will cause the T9 to not be used normally. If it is not necessary, the listening function must be turned off. Method: Right-click the small sound speaker in the lower right corner of the PC, select "Sounds" -- "recording", select "YET-T9" -- "Properties" -- "Listen", Remove the tick at "Listen to this device" -- "ok"

Figure 2.3: Audio input selection diagram, showing indicators for Optical, Coaxial, AUX, and USB inputs.

3. SETUP

3.1 Powering the Device

The AK3046D requires a 5V DC power supply. It can be powered via a USB port on your TV, computer, or a standard mobile phone charger.

3.2 Connecting to Audio Source

The transmitter supports multiple audio input types. Choose the appropriate cable and port based on your audio source (TV, computer, etc.).

③ Transmitter use

1, For use on TV, there are usually five ways for line installation, depending on the TV interface

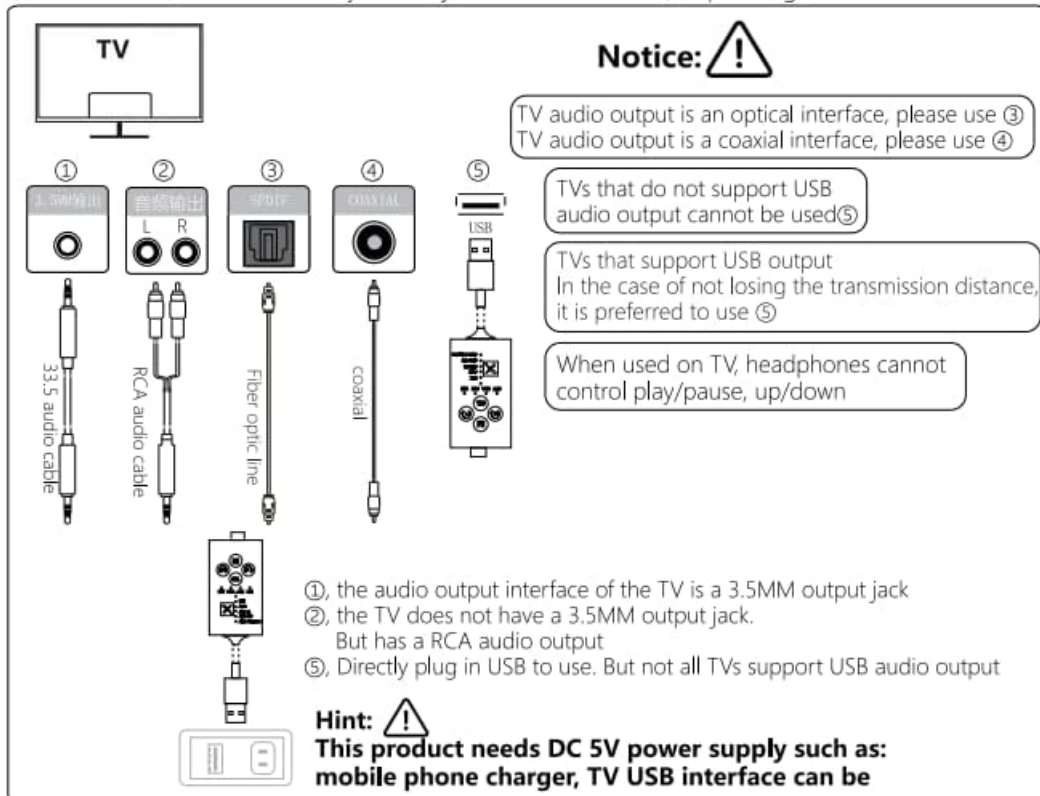

2, T9 transmitter initialization: clear all pairing information

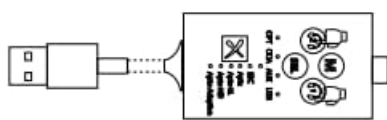

After power on, Press "1" "2" keys simultaneously until all LEDs light up again, release it to clear the pairing information
 This step is necessary because the pairing information is stored in the T9 during the production process test.

Figure 3.1: Connection examples for TV, including 3.5mm AUX, RCA, Fiber Optic, Coaxial, and USB audio output. Note: If your TV does not support USB audio output, power the transmitter via a separate USB source and connect audio via other methods.

3.3 Initializing (Clearing Pairing Information)

Before first use or if you encounter pairing issues, it is recommended to clear any previous pairing information.

1. Ensure the device is powered on.
2. Press and hold the "1" and "2" buttons simultaneously for 8 seconds until all LEDs light up again.
3. Release the buttons. The pairing information is now cleared.

3.4 Pairing with Bluetooth Headphones/Speakers

The AK3046D can pair with up to two Bluetooth audio devices simultaneously.

3, How to pair with a Bluetooth headset/Bluetooth speaker (the headset is an example)

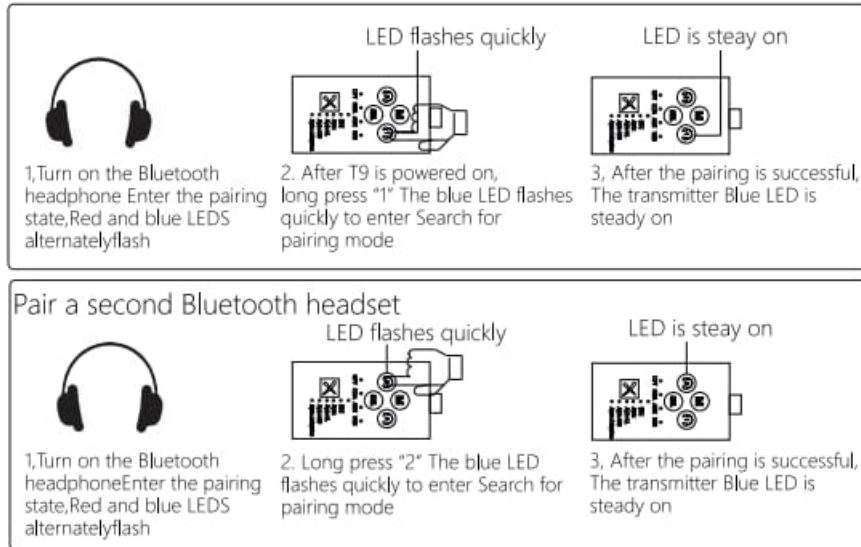

Remind: After T9 is paired with a Bluetooth device, the next time it is powered on, it will automatically enter the back connection by default, and try to pair the original paired device. If you need to pair a new device, you can long press "1" or "2" to forcibly enter the search pairing mode.

④ Audio input selection

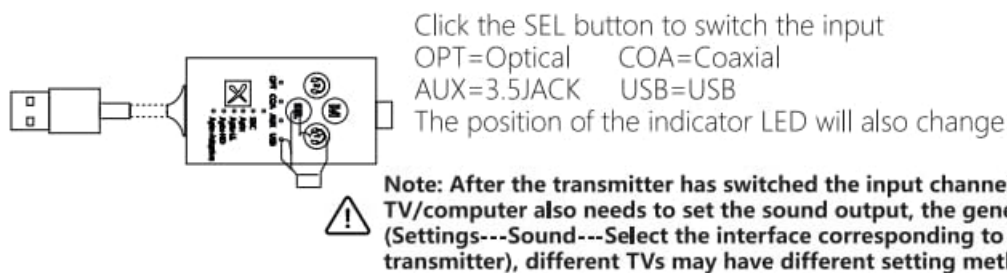

Figure 3.2: Pairing process for the first and second Bluetooth devices. LEDs flash quickly during search and stay steady when paired.

1. Put your Bluetooth headphones/speaker into pairing mode (refer to your device's manual). Red and blue LEDs on your headphones may flash alternately.
2. Turn on the AK3046D. The blue LED will flash quickly to enter search/pairing mode.
3. Once paired successfully, the blue LED on the transmitter will stay steady.
4. To pair a second device, long press the "2" button on the AK3046D. The blue LED will flash quickly again. Repeat step 1 and 3 for the second device.

Reminder: After the AK3046D is paired with a Bluetooth device, the next time it is powered on, it will automatically attempt to reconnect to the last paired device. If you need to pair a new device, long press the "1" or "2" button to manually enter search/pairing mode.

4. OPERATING INSTRUCTIONS

4.1 Basic Operations

- **Power ON/OFF:** Press and hold the 'M' button for 3 seconds.

- **Play/Pause:** Click the 'M' button.
- **Volume Control:** Click the '1' button for volume down, '2' button for volume up.
- **Search for Pairing:** Long press the '1' or '2' button.

4.2 Audio Input Selection

To switch between different audio input sources (Optical, Coaxial, AUX, USB), click the 'SEL' button. The corresponding indicator LED will change to show the active input.

4.3 Using with a Computer

The AK3046D can be used as a USB audio output device for your computer.



Figure 4.1: Steps for connecting and configuring the AK3046D with a computer for audio output.

1. Insert the AK3046D into a USB port on your computer. No additional audio cable is needed for USB input.
2. Pair your Bluetooth headset with the AK3046D.
3. Press the 'SEL' button on the AK3046D to switch the input to USB.
4. On your computer, navigate to Sound Settings.

5. Select "YET-T9" (or similar device name) as your output device.

Notice: The AK3046D has a voice function. It is recommended to turn off this function when listening to music normally, as it may impact sound quality. To turn off the voice function: double-click the 'M' button. If using with a PC, ensure "select input device" is not selected for YET-T9 in PC sound settings. If the voice function is enabled on PC, it can significantly impact sound quality. To disable it, right-click the speaker icon in the lower right corner of the PC, select "Sounds" -> "Recording" tab, select "YET-T9" -> "Properties" -> "Listen" tab, and uncheck "Listen to this device".

4.4 Automatic Reconnection

The AK3046D features a memory function that allows it to automatically reconnect to the last paired device when powered on, simplifying subsequent uses.



Figure 4.2: The transmitter automatically reconnects to previously paired devices.

5. MAINTENANCE

To ensure the longevity and optimal performance of your eppfun AK3046D transmitter, follow these simple maintenance guidelines:

- **Cleaning:** Use a soft, dry cloth to clean the device. Avoid using abrasive cleaners, solvents, or strong chemicals, as they may damage the surface or internal components.
- **Storage:** Store the device in a cool, dry place away from direct sunlight, extreme temperatures, and high humidity.
- **Handling:** Handle the device with care. Avoid dropping it or subjecting it to strong impacts, which could cause internal damage.
- **Connections:** When connecting or disconnecting cables, always grasp the plug, not the cable itself, to prevent damage to the connectors or ports.

6. TROUBLESHOOTING

If you encounter issues with your eppfun AK3046D transmitter, please refer to the following common problems and solutions:

6.1 No Sound or Poor Sound Quality

- **Check Connections:** Ensure all audio cables (AUX, RCA, Coaxial, Optical) are securely connected to both the transmitter and the audio source.
- **Correct Input Selected:** Press the 'SEL' button to cycle through inputs and ensure the correct input source is selected on the transmitter (e.g., OPT for optical, AUX for 3.5mm).
- **Audio Output Settings:** If connecting to a TV or computer, verify that the audio output settings on your source device are correctly configured to send audio through the chosen port. For USB audio from TV, ensure your TV supports USB audio output; otherwise, use another input method and power the transmitter separately.
- **Codec Compatibility:** Ensure your Bluetooth headphones/speakers support the same audio codec (e.g., aptX-Adaptive, aptX LL, aptX HD) as the transmitter for optimal quality. If the sound is tinny or distorted, especially with digital inputs, try setting your source device's audio output to 48kHz instead of 44.1kHz.
- **Voice Function Interference:** If using with a computer, ensure the voice function is turned off as described in Section 4.3 to prevent sound quality degradation.
- **Buzzing Sound (AUX Input):** A low-frequency buzzing sound on AUX input might be due to power supply noise. Try adjusting the gain on your audio interface (if applicable) and lowering the volume on the Bluetooth Transmitter slightly.

6.2 Unstable Bluetooth Connection or Interference

- **Environmental Interference:** Bluetooth signals can be affected by Wi-Fi routers, microwave ovens, cordless phones, and other Bluetooth devices nearby. Try moving the transmitter and your receiving device away from these sources of interference.
- **Distance:** Ensure the transmitter and your Bluetooth headphones/speakers are within the effective operating range.
- **Clear Pairing Information:** If connection issues persist, try clearing the pairing information on the transmitter (Section 3.3) and re-pairing your devices.

6.3 Device Not Recognized by Windows PC (for Transmission TO PC)

- **Transmitter Functionality:** This device is primarily a Bluetooth **transmitter**, meaning it sends audio

FROM a source (TV, console, media player) TO Bluetooth headphones/speakers. It is generally not designed to transmit audio FROM a source device (like an Oculus Quest or non-BT phone) TO a Windows PC as a Bluetooth receiver. Windows PCs typically require specific Bluetooth receiver hardware/software to accept incoming audio streams.

7. SPECIFICATIONS

Feature	Specification
Model Number	AK3046D
Bluetooth Version	5.2
Bluetooth Chipset	Qualcomm QCC3040
Supported Audio Codecs	aptX-Adaptive, aptX LL, aptX, aptX HD, SBC
Input Interfaces	3.5mm AUX, RCA, Coaxial, SPDIF Optical, USB
Compatible Devices	TV, Smartphone, Computer (PS4/5 OS, Windows, Android OS)
Product Dimensions (L x W x H)	6.9 x 3 x 2 cm
Weight	100 grams
Color	Black
Input Voltage	5V DC (via USB)

7.1 aptX Codec Specifications Comparison

aptX Different Specifications





Parameter	 Qualcomm aptX [™] Adaptive	 Qualcomm aptX [™] HD	 Qualcomm aptX [™] Low Latency	 Qualcomm aptX [™]
Word Depth	24-bit	24-bit	16-bit	16-bit
Bit Rate	adjustable from 276-420 kbps	570kbps	352kbps	348kbps@48kHz sampling frequency 325kbps@41.1kHz sampling frequency
Variable Bit Rate	Yes	No	No	No
THD+N@1kHz	-100dB @ 420kbps -90db @ 276kbps	-90dB	-85dB	-85dB
SNR@1kHz	130dB @ 276kbps 135dB @ 420kbps	129dB	93dB	93dB
Frequency response over Bluetooth	20HZ-22.7KHZ	20HZ-22.7KHZ	20HZ-22.7KHZ	20HZ-22.7KHZ

Figure 7.1: Detailed comparison of Qualcomm aptX codecs, including Word Depth, Bit Rate, THD+N@1kHz, SNR@1kHz, and Frequency Response.

8. WARRANTY AND SUPPORT

eppfun products are manufactured to the highest quality standards. This product is covered by a limited warranty from the date of purchase. Please refer to the warranty card included in your product packaging for specific terms and conditions.

For technical support, troubleshooting assistance, or warranty claims, please contact eppfun customer service through the retailer where you purchased the product or visit the official eppfun website for contact information.

Please retain your proof of purchase for warranty purposes.

