

## Anyeast AT003

# Anyeast AT003 Barcode Scanner User Manual

Model: AT003

## 1. INTRODUCTION

---

Thank you for choosing the Anyeast AT003 Barcode Scanner. This device is designed for reliable and efficient scanning of various barcode types, including 1D, 2D, and QR codes. Its plug-and-play design ensures easy setup and immediate use across multiple operating systems.



Figure 1: Anyeast AT003 Barcode Scanner with its adjustable stand.

### Package Contents:

- Anyeast AT003 Barcode Scanner
- USB Cable
- Adjustable Stand Components
- User Manual

# Package Included



Figure 2: Contents included in the product package.

## 2. SETUP

### 2.1 Connecting the Scanner (Plug and Play)

The Anyeas AT003 Barcode Scanner is designed for plug-and-play operation, requiring no driver or software installation. Simply connect the scanner to your computer using the provided USB cable.

1. Connect the USB cable from the scanner to an available USB port on your computer (desktop, laptop, or POS system).
2. The scanner will be automatically recognized by your operating system (Windows XP/7/8/10, Mac OS, Linux, Android).
3. Once connected, the scanner is ready for immediate use.



Figure 3: The scanner connects easily to various systems without additional software.



Figure 4: The scanner is compatible with desktop computers, laptops, and POS systems.

## 2.2 Assembling the Adjustable Stand

The adjustable stand allows for hands-free scanning and can be configured for optimal scanning angles.

1. Insert and twist the flexible pole into the base to tighten it.

2. Install the scanner holder shell onto the top of the flexible pole.
3. Secure the stand head with the provided screws using a screwdriver.
4. Adjust the angle of the stand and insert the barcode scanner into the holder.

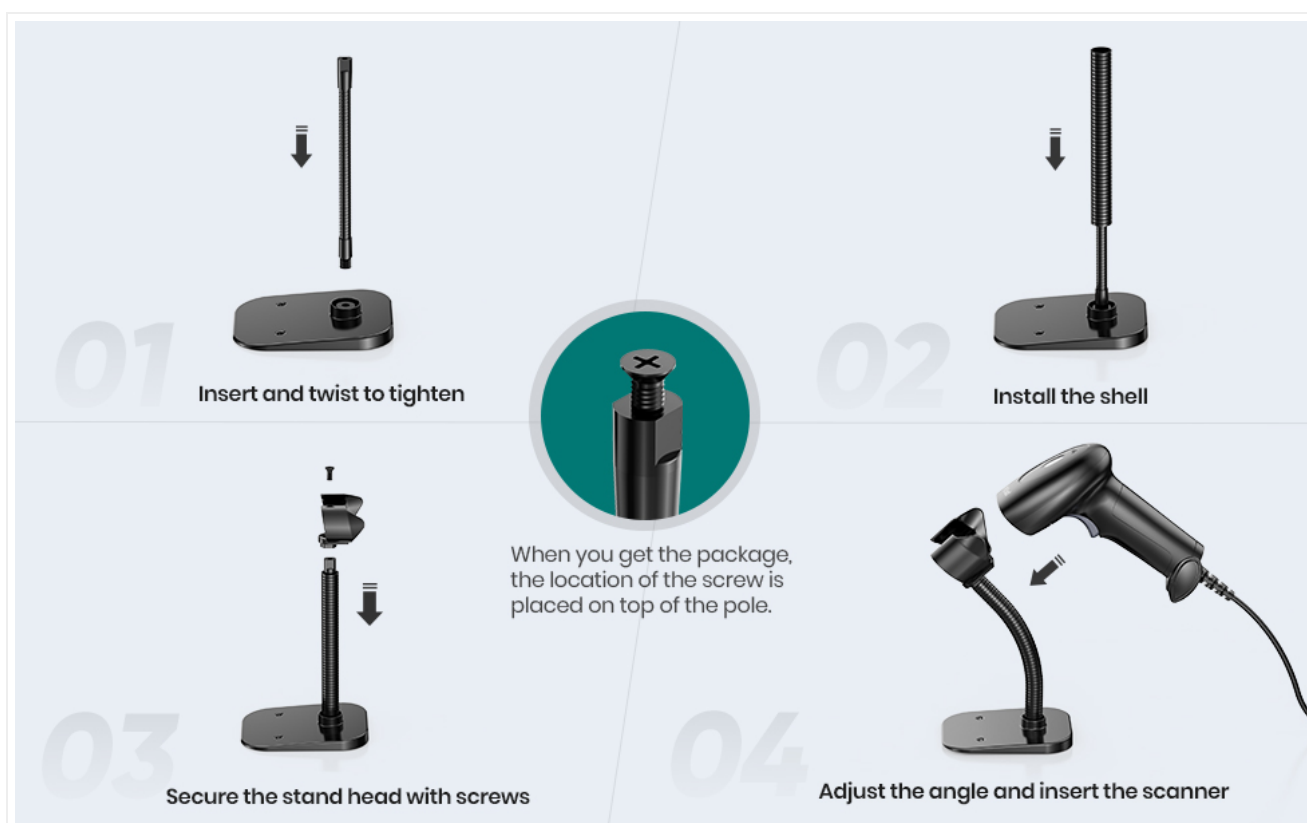

Figure 5: Step-by-step guide for assembling the scanner stand.



# Adjustable Stand

Switch handheld and handsfree quickly.



Figure 6: The adjustable stand allows for quick switching between handheld and hands-free scanning.

## 2.3 Stand Adjustment Video

For a visual guide on adjusting the stand and placing the scanner, please refer to the video below:

Your browser does not support the video tag.

Video 1: Demonstrates how to adjust the scanning angle of the stand and properly place the scanner.

## 3. OPERATING THE SCANNER

### 3.1 Decoding Capabilities

The Anyeast AT003 features an advanced CMOS sensor for strong decoding ability, accurately reading barcodes from various surfaces including labels, paper, and digital screens.

- **1D Barcodes:** UPC/EAN, Code39, Interleaved 2 of 5, Code93, Code 128, Codabar, etc.
- **2D Barcodes:** QR, Datamatrix, PDF417, Aztec, etc.

# Superior Scanning Performance

Decode 1D, QR, 2D Barcode  
on Paper & Screen



Figure 7: The scanner decodes various barcode types from paper and screen. Example QR code: 1234567890.



Figure 8: The scanner supports scanning barcodes directly from digital screens.

## 3.2 Scanning Modes

The scanner offers three distinct scanning modes to suit different operational needs:

- **Key Trigger Scanning:** Press the trigger button to initiate a scan.
- **Auto-Sensing Scanning:** The scanner automatically detects a barcode in its field of view and scans it without requiring a trigger press. This is ideal for hands-free operation with the stand.
- **Continuous Scanning:** The scanner continuously emits a scan beam, allowing for rapid scanning of multiple items.

## 3 Types of Scanning Modes



Auto-sensing  
Scanning Mode

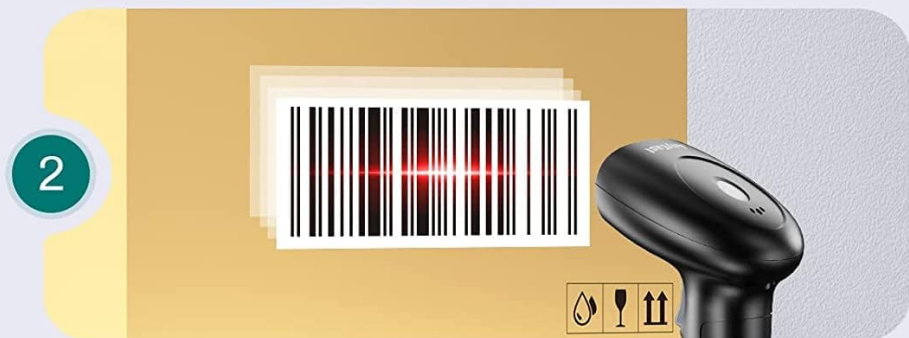

2

Continuous  
Scanning Mode



3



Key Trigger Mode

Figure 9: Illustration of the three available scanning modes. Example barcode: 0012346841636.

## Auto-Induction Scanning and Handsfree

With auto-Induction, continuous scan function and stand, easily realize handsfree scanning.





Figure 10: Hands-free scanning is easily achieved with auto-induction and the stand.

### 3.3 Custom Functions

The Anyeast AT003 barcode scanner supports various custom settings to tailor its output to your specific needs:

- Adding/hiding prefixes or suffixes to scanned data.
- Hiding characters from the front or back of scanned data.
- Adding keyboard keys (e.g., TAB, CR/Enter) to the scanning operation.
- Changing the case of scanned characters (capital/lower case).
- Enabling or disabling specific barcode types.

Refer to the detailed programming barcodes in the full user manual (PDF) for specific instructions on configuring these functions.



Figure 11: The scanner supports custom settings like adding prefixes/suffixes. Example barcode: 3123456789019.

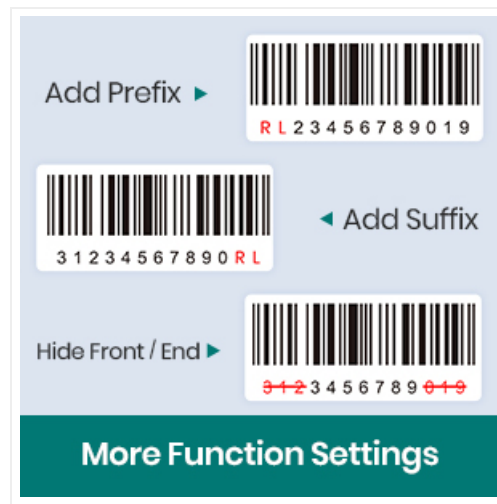

Figure 12: Options for modifying barcode output, including adding/hiding characters.

## 4. MAINTENANCE

---

The Anyeast AT003 Barcode Scanner is built with durability in mind, featuring anti-shock silicone to protect against impacts.

- **Cleaning:** Use a soft, dry cloth to clean the scanner's exterior. For the scanning window, use a lens cleaning cloth and solution if necessary, avoiding abrasive materials.
- **Storage:** Store the scanner in a cool, dry place away from direct sunlight and extreme temperatures.
- **Handling:** While durable, avoid dropping the scanner from excessive heights. The anti-shock silicone provides protection for drops up to 1.2 meters.

# Anti-Shock Silicone



Figure 13: The scanner features anti-shock silicone for enhanced durability against drops.

## 5. TROUBLESHOOTING

If you encounter any issues with your Anyeast AT003 Barcode Scanner, please refer to the following common troubleshooting tips:

- **Scanner not responding:** Ensure the USB cable is securely connected to both the scanner and the computer. Try connecting to a different USB port.
- **No data output:** Verify that the scanner is properly recognized by your computer's operating system. Check if the application you are using is in a text input field.
- **Unable to scan certain barcodes:** Ensure the barcode is clean, undamaged, and within the scanner's reading range. Check the scanner's configuration to ensure the specific barcode type is enabled. Refer to the full user manual for programming barcodes to enable/disable types.
- **Incorrect data output:** Review the custom function settings (prefix/suffix, character hiding) in the full user manual to ensure they are configured as desired.

For more detailed troubleshooting or advanced configurations, please consult the comprehensive [User Manual \(PDF\)](#) or contact Anyeast customer support.

## 6. SPECIFICATIONS

Feature	Specification
Model Number	AT003
Product Dimensions	7 x 4.5 x 3.3 inches (Scanner only); 7.08"D x 4.13"W x 10.2"H (with stand)
Item Weight	14.1 ounces
Connectivity Technology	USB Cable
Power Source	Corded Electric
Compatible Devices	Desktop, Laptop, POS
Decoding Capability	1D (UPC/EAN, Code39, etc.), 2D (QR, Datamatrix, PDF417, Aztec, etc.)

## 7. WARRANTY AND SUPPORT

### 7.1 Warranty Information

Anyeast offers a **2-Year Warranty** for the AT003 Barcode Scanner, covering manufacturing defects and malfunctions under normal use. Additionally, a **30-Day Money-Back Guarantee** is provided from the date of purchase.

Please retain your proof of purchase for warranty claims.

### 7.2 Customer Support



For technical assistance, warranty claims, or any inquiries regarding your Anyeast AT003 Barcode Scanner, please contact Anyeast customer support through the official channels provided at the time of purchase or visit the [Anyeast Store on Amazon](#).

© 2025 Anyeast. All rights reserved.

### Related Documents - AT003

<div>AT003WB</div> <div>AnyEast</div> <div>2D Barcode Scanner</div> <div>User Manual</div>	<div><a href="#">AnyEast AT003WB 2D Barcode Scanner User Manual</a></div> <div>User manual for the AnyEast AT003WB 2D Barcode Scanner, detailing setup, configuration, connection modes, scan modes, data editing, technical specifications, and troubleshooting.</div>
--	---



<div>AT003</div> <div>AnyEast 2D Barcode Scanner</div> <div>User Manual</div>	<div><a href="#">AnyEast AT003 2D Barcode Scanner User Manual</a></div> <div>Comprehensive user manual for the Anyeast AT003 2D Barcode Scanner, covering setup, configuration, scan modes, data editing, and symbologies. Learn how to use your Anyeast scanner effectively.</div>
<div>AT007</div> <div>AnyEast Android Barcode Scanner</div> <div>A black handheld Android barcode scanner with a large screen displaying a blue interface with the number '10' and various icons. The AnyEast logo is visible at the bottom of the device.</div> <div>User Manual</div>	<div><a href="#">AnyEast AT007 Android Barcode Scanner User Manual</a></div> <div>Comprehensive user manual for the AnyEast AT007 Android Barcode Scanner, covering features, installation, phone functions, APPCenter diagnostic tools, Keyboard Emulator settings, and frequently asked questions.</div>
<div>AT006</div> <div>AnyEast 2D Barcode Scanner</div> <div>A black and teal handheld industrial wireless barcode scanner with a trigger button and a small display screen. The AnyEast logo is visible on the side.</div> <div>User Manual</div>	<div><a href="#">AnyEast AT006 2D Barcode Scanner User Manual</a></div> <div>User manual for the Anyeast AT006 2D Barcode Scanner. This guide details setup, operation, and features of the industrial wireless barcode scanner, including USB, 2.4G Wireless, and Bluetooth connectivity, scan modes, data editing, and technical specifications.</div>