

[Manuals.plus](#) /

› [Honeywell Home](#) /

› Honeywell Home RENEWRTH5160D Non-Programmable Thermostat User Manual

Honeywell Home RENEWRTH5160D/U

Honeywell Home RTH5160 Non-Programmable Thermostat

Model: RENEWRTH5160D/U

1. PRODUCT OVERVIEW

The Honeywell Home RTH5160 Non-Programmable Digital Thermostat provides straightforward temperature control for your home. It features a clear, backlit display that simultaneously shows the current room temperature and your set temperature. Designed for simplicity, it offers single-degree control and essential functions. Key features include automatic changeover between heating and cooling modes, memory retention during power outages, and a low battery reminder alert.

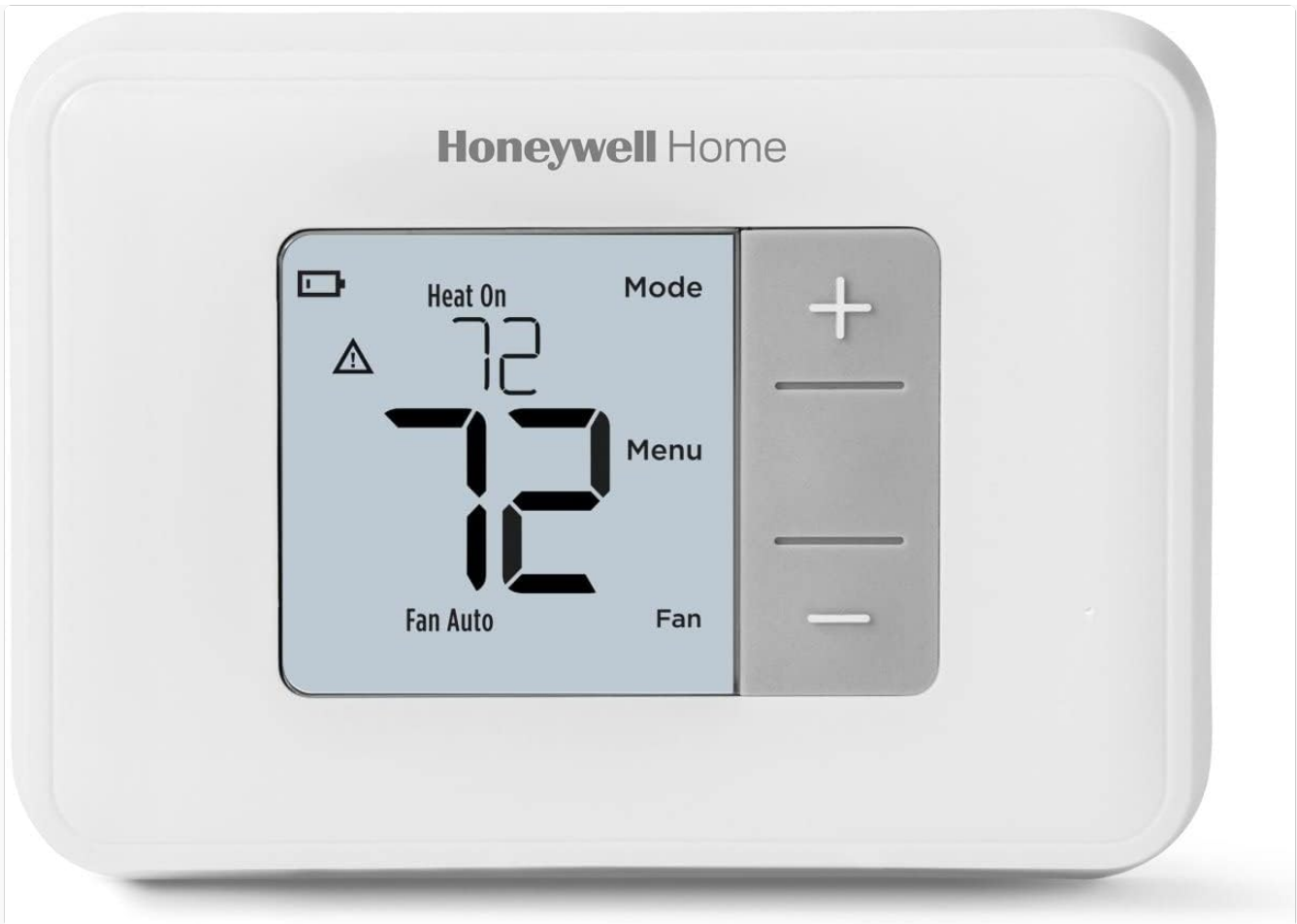

Front view of the Honeywell Home RTH5160 Non-Programmable Thermostat, showing the digital display and control buttons.

Key Features:

- **Single-Degree Control:** Simple operation with precise temperature adjustments.
- **Precise Temperature Control:** Maintains temperature within +/- 1°F of the set point.
- **Digital Backlit LCD Display:** Clear display showing current room temperature and set point simultaneously.
- **Auto Changeover:** Automatically switches between heating and cooling modes as needed.
- **Memory Storage:** Retains settings and program in case of a power outage.
- **Low Battery Alert:** Provides a reminder when batteries need replacement.
- **Easy Installation:** Utilizes the UWP mounting system for quick setup.

2. INSTALLATION GUIDE

This section provides instructions for installing your Honeywell Home RTH5160 thermostat. It is designed for compatibility with most common heating and cooling systems. Please ensure power to your HVAC system is turned off at the circuit breaker before beginning installation.

2.1 System Compatibility

The RTH5160 thermostat is compatible with a wide range of HVAC systems. Refer to the compatibility chart below to ensure your system is supported.



Compatibility chart for the RTH5160 thermostat, detailing supported heating and cooling systems.

- **Compatible with:** Forced air (gas, oil or electric), hot water and steam systems, and heat pumps with electric backup.
- **Not Compatible with:** Electric baseboard heat (120-240V), mini-split systems, convectors, or radiant ceiling heat.

2.2 Mounting the Thermostat

The thermostat uses a Universal Wiring Plate (UWP) mounting system for easy installation.

1. Turn off power to your heating/cooling system at the circuit breaker.
2. Remove your old thermostat from the wall. Take a picture of the wiring for reference.
3. Mount the UWP to the wall using the included mounting hardware. Ensure it is level.
4. Connect the wires from your wall to the appropriate terminals on the UWP. Refer to your old thermostat's wiring or the quick install guide for specific connections.
5. Once wiring is complete, align the RTH5160 thermostat with the UWP and snap it into place.

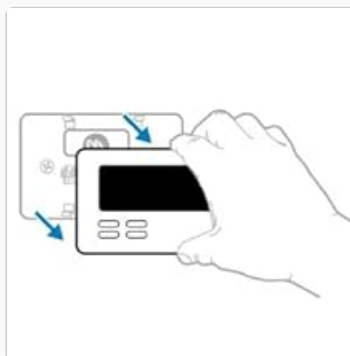



Illustration showing how to snap the thermostat onto the UWP mounting plate.

2.3 Battery Installation

The RTH5160 thermostat requires 2 AA batteries (not included) for operation. The battery compartment is located on the back of the thermostat unit.

1. If the thermostat is already mounted, gently pull it off the UWP to access the back.
2. Insert two fresh AA alkaline batteries into the battery compartment, observing the polarity (+/-) markings.
3. Snap the thermostat back onto the UWP.

RTH5160 Thermostat System Compatibility



Heating

Compatible:

- Heating Only
- Single Stage
- Multistage
- Furnace/Forced Air
- Heat Pump w/o Auxiliary Heat
- Heat Pump with Auxiliary Heat
- Hot Water, Steam or Gravity Radiant Heat
- 750 Millivolt
- Gas Fireplaces (24V)

Cooling

Compatible:

- Cooling Only
- Single Stage
- Multistage

Not Compatible:

- Mini Split Systems

Electric Heat

Not Compatible:

- Electric Baseboard Heat (120-240 Volts)
- Convector
- Radiant Ceiling Heat

Rear view of the thermostat, highlighting the battery compartment for two AA batteries.

Once batteries are installed and power is restored, the thermostat display should light up.

3. OPERATING INSTRUCTIONS

Operating your RTH5160 thermostat is simple and intuitive.

3.1 Display Overview

The backlit LCD display shows important information at a glance:

- **Current Temperature:** The large number in the center.
- **Set Temperature:** The smaller number above the current temperature.
- **System Mode:** Indicates Heat On, Cool On, or Off.
- **Fan Status:** Shows Fan Auto or Fan On.
- **Battery Indicator:** An icon indicating battery level.

3.2 Adjusting Temperature

Use the + and - buttons on the right side of the thermostat to adjust the desired set temperature. Each press will change the temperature by one degree Fahrenheit.

3.3 Selecting System Mode

Press the **Mode** button to cycle through the available system modes:

- **Heat:** The system will operate to maintain your set heating temperature.
- **Cool:** The system will operate to maintain your set cooling temperature.
- **Off:** The heating and cooling system is turned off.
- **Auto:** (If supported by your system) The thermostat will automatically switch between heating and cooling to maintain your desired temperature range.

3.4 Fan Settings

Press the **Fan** button to cycle through the fan settings:

- **Auto:** The fan runs only when the heating or cooling system is actively operating. This is the most common and energy-efficient setting.
- **On:** The fan runs continuously, regardless of whether the heating or cooling system is active.

4. MAINTENANCE

Regular maintenance ensures optimal performance and longevity of your thermostat.

4.1 Battery Replacement

When the low battery indicator appears on the display, replace the two AA batteries promptly. Refer to Section 2.3 for battery installation instructions. It is recommended to replace batteries annually, even if the indicator has not appeared, to prevent unexpected power loss.

4.2 Cleaning

To clean the thermostat, gently wipe the exterior with a soft, damp cloth. Do not use abrasive cleaners, solvents, or chemical sprays, as these can damage the display or casing.

5. TROUBLESHOOTING

If you encounter issues with your thermostat, try the following troubleshooting steps. For more detailed assistance, refer to the official user manual PDF linked in the Support section.

| Problem | Possible Cause | Solution |
|--|--|---|
| Display is blank | No power; dead batteries. | Check circuit breaker. Replace AA batteries. |
| System not responding (heating/cooling not turning on) | Incorrect mode selected; wiring issue; system lockout. | Ensure correct mode (Heat/Cool) is selected. Verify wiring connections. Wait 5 minutes for system lockout to reset. |
| Temperature reading seems inaccurate | Thermostat exposed to direct sunlight or drafts. | Relocate thermostat if possible, or shield it from direct environmental influences. |
| Fan runs continuously | Fan setting is 'On'. | Press the 'Fan' button to change the setting to 'Auto'. |

6. SPECIFICATIONS

Detailed technical specifications for the Honeywell Home RTH5160 Non-Programmable Thermostat.

| Specification | Detail |
|--------------------------|--|
| Brand | Honeywell Home |
| Model Name | Honeywell Home Non-Programmable Thermostat - Refurbished |
| Product Dimensions | 1.08"D x 5.36"W x 3.86"H |
| Controller Type | Hand Control |
| Special Features | Auto Changeover, Daylight Savings Time Ready, Filter Indicator, Low Battery Indicator, Temperature Display |
| Color | White |
| Specific Uses | Air Conditioner, Furnace, Heat Pump |
| Temperature Control Type | Heating and Cooling |
| Connectivity Technology | Non-Connected |
| Included Components | Installation Guide, RENEWRTH5160D Non-Programmable Thermostat, UWP Mounting Hardware |
| Power Source | Battery Powered (2 AA batteries, not included) |
| Item Weight | 0.45 Pounds (7.2 ounces) |
| Voltage | 120 Volts, 240 Volts (System Compatibility) |
| Material | Plastic |
| Display Type | LCD |
| Screen Size | 2 Inches |
| Control Method | Button Control, Touch |
| Mounting Type | Wall Mount |
| Backlight | Yes |

7. WARRANTY AND SUPPORT

7.1 Warranty Information

This product comes with a **1-year limited warranty**. Please retain your proof of purchase for warranty claims.

7.2 Additional Support

For further details, advanced settings, or comprehensive troubleshooting, please refer to the official user manual:

[Download Official User Manual
\(PDF\)](#)

© 2024 Honeywell Home. All rights reserved.