

## SMONET SMUS-ZNS-FAM02-SIL

# SMONET Keyless Entry Fingerprint Door Lock (Model SMUS-ZNS-FAM02-SIL) User Manual

Your guide to installation, setup, and operation.

## 1. INTRODUCTION

---

This manual provides detailed instructions for the installation, setup, and operation of your SMONET Keyless Entry Fingerprint Door Lock, Model SMUS-ZNS-FAM02-SIL. This smart deadbolt offers multiple access methods, enhancing convenience and security for your home or property.



Image 1.1: SMONET Smart Deadbolt, showing the lock unit, two IC fobs, and the accompanying smartphone application interface.

## 2. PRODUCT OVERVIEW

The SMONET Smart Deadbolt provides an 8-in-1 keyless entry solution, integrating various access methods for enhanced security and convenience. Key features include:

- **Multiple Access Methods:** Unlock using Passcode, Smartphone App (Bluetooth), Fingerprint, IC Fob, or traditional Physical Key.
- **Smart Home Integration:** Compatible with Alexa & Google Home (requires a separate gateway).
- **User Capacity:** Supports up to 300 customized passcodes and 1000 IC fobs (two included).
- **Fingerprint Recognition:** Fast and accurate fingerprint recognition in approximately 0.5 seconds.

- **Automatic Locking:** Features an automatic locking function for added security.
- **Durable Construction:** Solid alloy body with a built-in backlight for visibility.
- **Battery Life:** Powered by 4 AA batteries, providing approximately 10,000 openings (around 12 months).
- **Security Lockout:** Automatically locks for 5 minutes after 5 incorrect password attempts.

## Multi-Way Unlock



Fingerprint



IC Card



Key



PIN Code



Bluetooth



Image 2.1: Visual representation of the multi-way unlock options available with the SMONET Smart Deadbolt.

### 3. SPECIFICATIONS

---

Brand	SMONET
Model Name	SMUS-ZNS-FAM02-SIL
Lock Type	Fingerprint, Bluetooth
Special Features	Bluetooth lock, Fingerprint Smart Lock, Digital Lock, Smartphone Unlock, Touchscreen
Material	Alloy ABS
Finish Type	Painted
Color	Satin Chrome
Item Dimensions (L x W x H)	6.54 x 2.56 x 1.57 inches
Item Weight	2.27 pounds
Power Source	4 AA Batteries (not included)
Connectivity Protocol	Bluetooth
Controller Type	Amazon Alexa (with gateway), App

## 4. INSTALLATION

---

### 4.1. Pre-Installation Checks

Before beginning installation, ensure your door meets the following specifications. The door handle is not included with the smart deadbolt.

- **Door Thickness:** Typically 1-1/2" to 1-9/10" (38mm-48mm).
- **Hole Diameter:** 2-1/8" (54mm).
- **Backset:** 2-3/8" or 2-3/4" (60mm-70mm).
- **Minimum Distance:** 3-7/8" (100mm) between the deadbolt and the door handle.
- Ensure your door has a latch hole and is not chiseled for a mortise/integrated lock.

# Check Your Door Size Before Purchase



Image 4.1: Door measurement guide and compatibility checks for the SMONET Smart Deadbolt.

## 4.2. Installation Steps

Installation typically requires only a Phillips screwdriver and can be completed within 20 minutes. Refer to the detailed installation guide provided in the product packaging for specific steps and diagrams. Ensure correct installation for left-handed and right-handed doors as methods may differ.

## Easy to Install

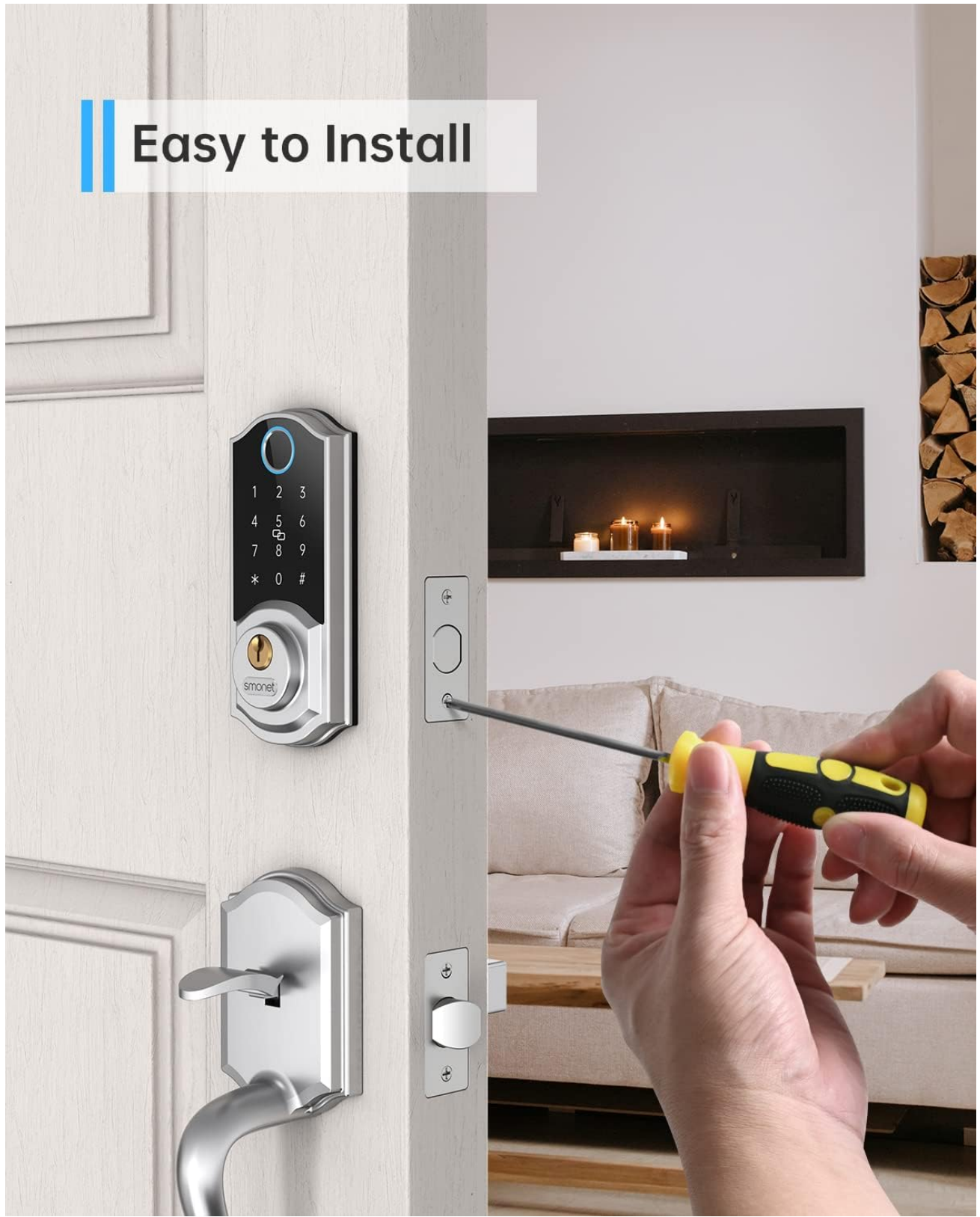

Image 4.2: Illustrative image of the installation process using a screwdriver.

## 5. SETUP

### 5.1. App Download and Pairing

1. Download the designated smartphone application from your device's app store.
2. Create an account and log in.
3. Follow the in-app instructions to pair your smart deadbolt via Bluetooth.



## 5.2. Adding Fingerprints

The lock can store multiple fingerprints for quick access. For optimal accuracy, register your fingerprint multiple times, ensuring all edges of your finger are scanned.

1. Access the fingerprint management section within the smartphone app or directly on the lock's keypad (refer to the full manual for keypad-specific instructions).
2. Place your finger on the fingerprint sensor, lifting and repositioning it as prompted until registration is complete.



Image 5.1: Demonstrating fingerprint unlock functionality.

## 5.3. Setting Passcodes

You can create up to 300 unique passcodes for family members or guests. Temporary passcodes can also be generated for limited access.

1. Navigate to the passcode management section in the smartphone app.
2. Follow the prompts to create new passcodes, specifying their validity period if desired.

## **5.4. Adding IC Fobs**

The lock supports up to 1000 IC fobs. Two fobs are typically included with your purchase.

1. In the app, select the option to add new IC fobs.
2. Present the fob to the designated area on the lock as instructed by the app.

## **5.5. Voice Control Setup (Optional)**

To enable voice control with Amazon Alexa or Google Home, a separate Wi-Fi gateway hub is required. This hub bridges the smart lock to your home network.

1. Install and set up the Wi-Fi gateway hub according to its instructions.
2. Link the SMONET smart lock to the gateway via the smartphone app.
3. Enable the SMONET skill/action in your Alexa or Google Home app and follow the pairing process.





Image 5.2: Voice control functionality with Amazon Alexa and Google Assistant, requiring a separate gateway hub.

## 6. OPERATING INSTRUCTIONS

### 6.1. Unlocking the Door

- **Fingerprint:** Place your registered finger on the sensor. The lock will unlock in approximately 0.5 seconds.
- **Passcode:** Enter your valid passcode on the keypad, then press the '#' key.
- **Smartphone App:** Open the app, ensure Bluetooth is enabled, and tap the unlock icon.
- **IC Fob:** Present the registered IC fob to the designated area on the lock.

- **Physical Key:** Insert the physical key into the keyhole and turn to unlock.
- **Voice Command (with Gateway):** Use voice commands like "Alexa, unlock the front door" after setting up voice control.



Image 6.1: Overview of various unlocking methods including app, physical key, and PIN code.

## 6.2. Locking the Door

- **Automatic Locking:** The lock will automatically engage after a set period (configurable in the app) once the door is closed.
- **One-Touch Locking:** Press the '#' key on the keypad to manually lock the door.

- **Smartphone App:** Open the app and tap the lock icon.
- **Voice Command (with Gateway):** Use voice commands like "Alexa, lock the front door" after setting up voice control.

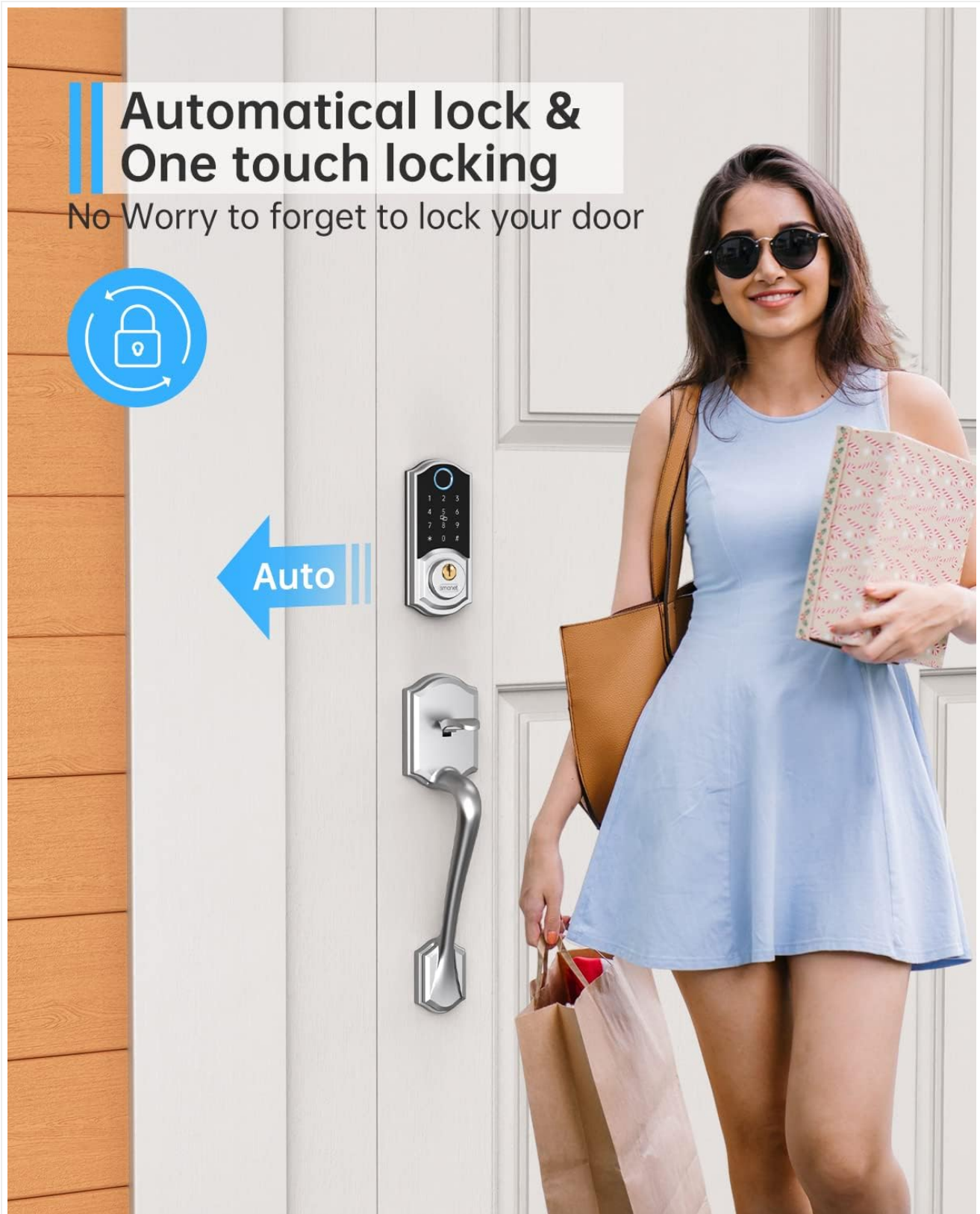

Image 6.2: The automatic locking feature ensures the door is secured after closing.

## 7. MAINTENANCE

- **Battery Replacement:** Replace all four AA batteries when the low battery indicator appears or when the lock's performance diminishes. Do not mix old and new batteries.
- **Cleaning:** Wipe the keypad and fingerprint sensor with a soft, dry cloth. Avoid abrasive cleaners or solvents that could

damage the finish or electronic components.

- **Environmental Protection:** If the lock is exposed to direct rainfall, consider installing a smart lock cover to prevent potential water damage.

## 8. TROUBLESHOOTING

- **Lock Not Responding:** Check battery levels. If batteries are low, replace them. Ensure the lock is properly installed and all connections are secure.
- **Incorrect Password Lockout:** If an incorrect password is entered 5 times consecutively, the lock will automatically disable for 5 minutes. Wait for the lockout period to expire before attempting again.
- **Fingerprint Not Recognized:** Ensure your finger is clean and dry. Try re-registering your fingerprint, covering all edges during the process.
- **App Connectivity Issues:** Ensure Bluetooth is enabled on your smartphone and you are within range of the lock. Restart the app or your phone if necessary.
- **Physical Key Not Working:** Ensure the key is fully inserted and turned correctly. If the lock is jammed, do not force the key.

For further assistance, please contact SMONET Customer Service.



## 9. WARRANTY AND SUPPORT

SMONET provides professional technical support and a 1-year warranty for the smart lock from the date of purchase, along with lifetime free technical support.



- **Email Support:** [Smonetserviceus@hotmail.com](mailto:Smonetserviceus@hotmail.com)
- **Toll-Free Phone:** (866) 626-5918

Please have your model number (SMUS-ZNS-FAM02-SIL) and purchase information ready when contacting support.

### Related Documents - SMUS-ZNS-FAM02-SIL

 <p>Smart Lock Manual Electronic Keypad Deadbolt Lock</p> <p>Version: SMUS-GS002</p>	<p><a href="#">SMONET SMUS-GS002 Smart Lock Manual: Installation &amp; Operation Guide</a></p> <p>Comprehensive user manual for the SMONET SMUS-GS002 Electronic Keypad Deadbolt Smart Lock. Includes installation steps, operation instructions, app pairing, and troubleshooting.</p>
 <p>Smart Lock Manual Electronic Keypad Deadbolt Lock</p>	<p><a href="#">SMONET Smart Lock Manual: Electronic Keypad Deadbolt Installation and Operation Guide</a></p> <p>Comprehensive guide for the SMONET Smart Lock, an electronic keypad deadbolt lock. Learn how to install, set up the app, operate, and troubleshoot your keyless entry smart lock.</p>

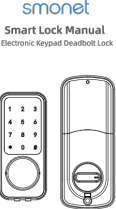

 <p>The cover of the SMONET AM01 Smart Lock Manual features the brand logo at the top, followed by the title 'Smart Lock Manual' and the subtitle 'Electronic Keypad Deadbolt Lock'. It displays two views of the lock: a front view with a numeric keypad and a side view showing the deadbolt mechanism. The model number 'AM01' is printed at the bottom.</p>	<p><a href="#">SMONET AM01 Smart Lock Manual: Keyless Entry Electronic Deadbolt Installation &amp; Operation</a></p> <p>Comprehensive user manual for the SMONET AM01 Smart Lock. Learn how to install, operate, and connect this electronic keypad deadbolt lock via Bluetooth and the TTLock app. Features include keyless entry, remote control, and Alexa integration.</p>
 <p>The cover of the Smonet Smart Lock Manual shows the brand logo and the title 'Smart Lock Manual' with the subtitle 'Electronic Keypad Deadbolt Lock'. It includes images of the lock's keypad and side profile. The model number 'AM01' is visible at the bottom.</p>	<p><a href="#">Smonet Smart Lock Manual: Electronic Keypad Deadbolt Lock</a></p> <p>Comprehensive manual for the Smonet Electronic Keypad Deadbolt Smart Lock, covering product specifications, package contents, performance features, detailed installation instructions, smart app integration (TTLock, Alexa), watch compatibility, and operation guidelines including passcode management, unlocking methods, battery status, and troubleshooting.</p>
 <p>The cover of the SMONET M6-BF Smart Lock User Manual features the brand logo, the title 'SMART LOCK', the model 'Model M6-BF', and the subtitle 'User Manual'. It shows a side view of the lock with a keypad. A note at the bottom says 'Read and Save the Instructions'.</p>	<p><a href="#">SMONET M6-BF Smart Lock User Manual: Installation, Features, and App Guide</a></p> <p>Comprehensive user manual for the SMONET M6-BF Smart Lock. Learn how to install, set up, use the Smart Life app, integrate with Alexa and Google Home, and troubleshoot common issues.</p>
 <p>The cover of the Smonet Wireless Security Camera System User Manual features the brand logo, the slogan 'Your Safety is Our Priority', and an image of the camera system. It includes the title 'USER MANUAL' and 'WIRELESS SECURITY CAMERA SYSTEM'. A note at the bottom says 'Please Read User Manual Carefully Before Installation'. Contact information for customer support is also provided.</p>	<p><a href="#">Smonet Wireless Security Camera System User Manual</a></p> <p>User manual for the Smonet Wireless Security Camera System, covering installation, setup, recording, playback, and troubleshooting.</p>