

ELECOM WRC-X3000GS2

ELECOM Wi-Fi 6 Wireless LAN Router WRC-X3000GS2-B User Manual

MODEL: WRC-X3000GS2-B

Brand: ELECOM

1. INTRODUCTION

Thank you for purchasing the ELECOM Wi-Fi 6 Wireless LAN Router WRC-X3000GS2-B. This router is designed to provide stable and high-speed internet connectivity for your home or office, supporting the latest Wi-Fi 6 (11ax) standard. It is ideal for environments with multiple connected devices, such as telework setups, online learning, and 4K video streaming.

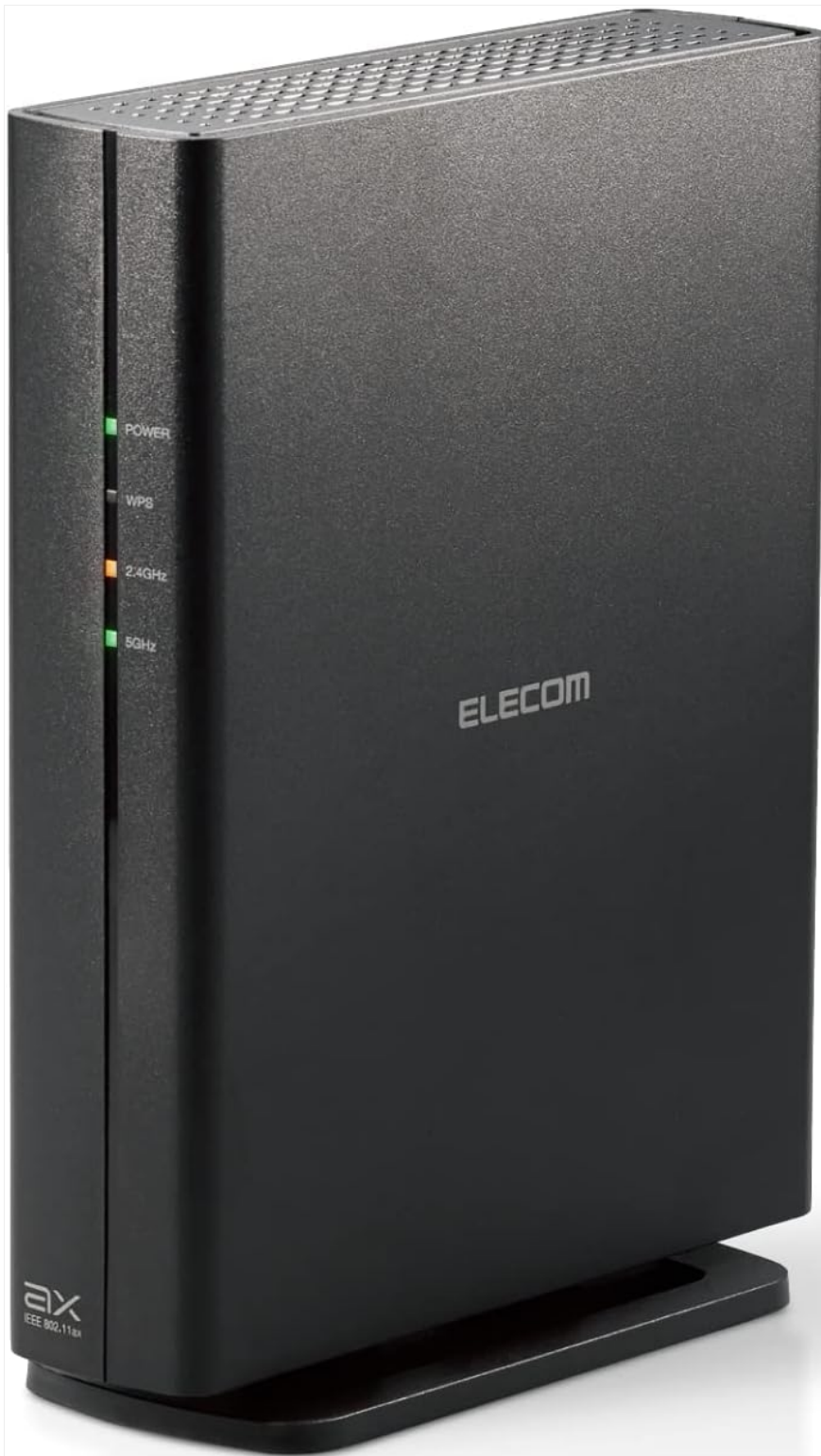

Image: ELECOM Wi-Fi 6 Wireless LAN Router WRC-X3000GS2-B, a sleek black router designed for modern homes.

2. KEY FEATURES

- **Wi-Fi 6 (11ax) Support:** Ensures stable and high-speed communication, perfect for multiple simultaneous connections in telework and online learning environments.
- **OFDMA & 1024QAM:** Enhances efficiency for multiple device connections and increases data transmission capacity.

- **TWT (Target Wake Time):** Extends smartphone battery life by optimizing communication schedules.
- **IPv6 IPoE Compatibility:** Supports next-generation internet connection methods, reducing line congestion for smoother communication. Easy setup by simply connecting a LAN cable to the internet port.
- **4K TV Support:** The 5GHz band offers up to 2402Mbps (theoretical value) and is resistant to radio interference, while the 2.4GHz band provides up to 574Mbps (theoretical value) for general use, ensuring comfortable 4K video streaming.
- **Security Wi-Fi (Communication Isolation):** Reduces the risk of virus infection and information theft between connected devices.
- **Rakuraku Migration Function:** Simplifies router replacement by automatically copying SSID and encryption keys from your old router with a press of the WPS button.
- **Internal Antennas:** Provides a sleek, unobtrusive design while maintaining strong communication performance.
- **Band Steering:** Automatically selects and connects devices to the more optimal frequency band (5GHz or 2.4GHz) for improved performance.
- **Beamforming Z:** Concentrates radio waves towards compatible devices (e.g., iPhone, Android) for stable connections even at a distance.
- **Friend Wi-Fi (Guest SSID):** Allows you to provide Wi-Fi access to guests securely, isolating them from your main network (2.4GHz band only).
- **Child Net Timer 3:** Helps manage children's internet usage by setting time limits.
- **WPA3 Personal Security:** Supports the latest and strongest security standard for enhanced network protection.
- **Automatic Firmware Updates:** Ensures your router always has the latest features, bug fixes, and security measures.
- **Router/AP Mode Switching:** Easily switch between Router mode and AP (Access Point) mode using a slide switch.
- **Flexible Installation:** Supports both vertical placement and wall mounting to fit various home environments.

テレワークもオンライン学習も高速安定通信 Wi-Fi 6対応ギガビットルーター

Wi-Fi 5ルーターからの買い替えで
快適な通信を実感

セキュリティ-Wi-Fi
安心インターネット



テレワーク
オンライン学習
推奨商品

Image: A family using laptops and tablets, illustrating the router's capability to support telework and online learning with stable Wi-Fi 6 connectivity.

通信を分けてテレワークで使う端末をしっかりと守る

セキュリティーWi-Fi機能

お仕事で

プライベートで



Image: Diagram explaining the Security Wi-Fi feature, which isolates work devices from personal devices to prevent cross-infection and data theft.

／テレワークやオンライン授業にオススメ／

同時接続に強い! OFDMA搭載

OFDMAなし

1通信で1つずつに届く

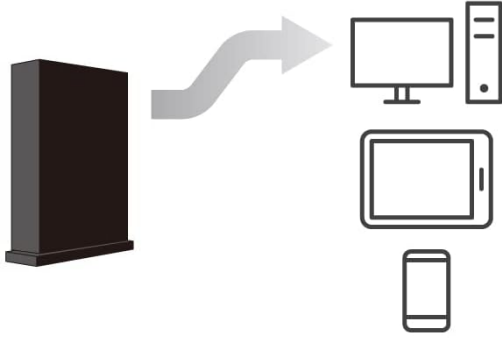

OFDMAあり

1通信で複数へ同時に届く

※接続機器側も同機能に対応している必要があります。

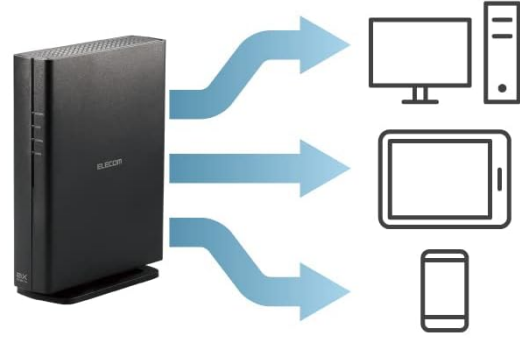

**OFDMA機能があれば
1通信で複数へ同時に届く!**



Image: Diagram illustrating OFDMA technology, showing how the router efficiently handles multiple devices simultaneously, improving network performance.

ネットが速くなる 日本の主要なIPv6サービスに対応

従来方式 (PPPoE)

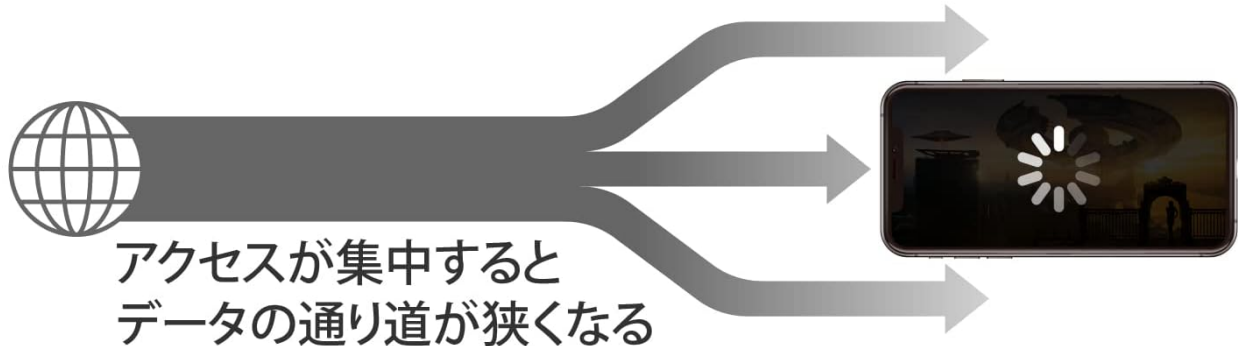

次世代方式 IPv6 (IPoE)



※ イメージ図

Image: Diagram comparing traditional PPPoE internet connection with IPv6 IPoE, highlighting how IPv6 IPoE provides a wider data path for faster, less congested internet access.

3. PACKAGE CONTENTS

Please ensure all the following items are included in your package:

- Router Unit (WRC-X3000GS2-B) x 1
- Stand x 1
- Dedicated AC Adapter x 1
- LAN Cable (approx. 0.5m) x 1
- Various Manuals x 2
- Easy Setup Sheet (Initial Value) x 1
- Wall Mount Anchors x 2
- Wall Mount Screws x 2

4. SETUP GUIDE

Follow these steps for initial setup of your ELECOM Wi-Fi 6 Router:

1. **Unpack and Connect:** Place the router in your desired location. Connect the dedicated AC adapter to the router and plug it into a power outlet. Connect the provided LAN cable from your modem to the router's WAN port.
2. **Physical Installation:** The router supports both vertical placement using the included stand and wall mounting. For wall mounting, use the provided anchors and screws. Ensure the router is installed vertically for optimal performance.
3. **Initial Configuration (for IPv6 IPoE):** If your internet service provider supports IPv6 IPoE, the router is designed for easy setup. Simply connect the LAN cable from your modem to the router's internet port, and it should automatically configure itself.
4. **Connecting Devices:** Locate the Wi-Fi network name (SSID) and password on the label of your router or the easy setup sheet. Connect your Wi-Fi enabled devices (smartphones, tablets, PCs, gaming consoles) to this network.
5. **Rakuraku Migration (for Router Replacement):** If you are replacing an old router, press the WPS button on your old router and then on the new ELECOM router. The new router will automatically copy the SSID and encryption key from the old router, allowing your existing devices to connect without re-entering credentials.

縦置きや壁掛け設置もできる シンプル&コンパクトボディ



※ 壁掛けの際も縦方向で設置してください。

Image: The ELECOM Wi-Fi 6 router shown in both vertical desktop placement and wall-mounted configurations, demonstrating flexible installation options.

5. OPERATING INSTRUCTIONS

- **WPS Function:** Press the WPS button on the router to easily connect WPS-compatible devices without manually entering the password.
- **Guest Wi-Fi (Friend Wi-Fi):** To enable a separate Wi-Fi network for guests, access the router's web interface. This feature is available on the 2.4GHz band and isolates guest devices from your main network for security.
- **Child Net Timer 3:** Configure internet access schedules for specific devices through the router's web interface to manage screen time for children.
- **Mode Switching:** Use the slide switch on the router to change between Router mode (default) and AP (Access Point) mode, depending on your network requirements.

6. MAINTENANCE

- **Automatic Firmware Updates:** The router is designed to automatically update its firmware to ensure optimal performance, security, and access to new features. Ensure the router is connected to the internet for these updates.
- **Cleaning:** Use a soft, dry cloth to clean the router. Do not use liquid cleaners or abrasive materials.
- **Placement:** Avoid placing the router in direct sunlight, near heat sources, or in areas with high humidity.

7. TROUBLESHOOTING

If you encounter issues with your router, try the following:

- **No Internet Connection:** Check all cable connections (modem to router, router to power). Restart your modem and router. Verify your internet service provider's status.
- **Slow Wi-Fi Speed:** Ensure your devices are Wi-Fi 6 compatible for optimal performance. Try moving closer to the router. Check for interference from other electronic devices. Utilize the Band Steering feature if available.
- **Cannot Connect to Wi-Fi:** Double-check the Wi-Fi network name (SSID) and password. Try using the WPS function. Restart the router and your device.
- **Forgotten Password:** Refer to the label on the router or the easy setup sheet for the default password. If changed and forgotten, you may need to reset the router to factory settings (this will erase all custom configurations).

If problems persist, please contact ELECOM customer support.

設定できない場合は返品・返金対応

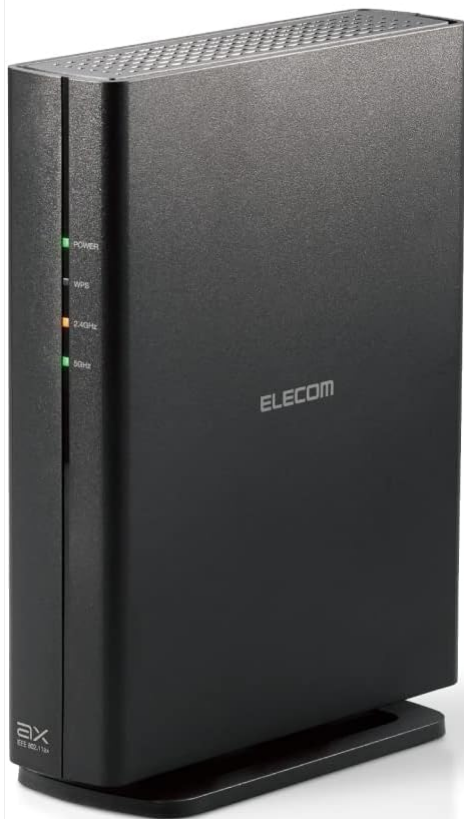

Image: A shield graphic indicating return and refund support if the product cannot be set up or connected, emphasizing customer assurance.

8. SPECIFICATIONS

Feature	Specification
Brand	ELECOM
Model Name	WRC-X3000GS2
Wireless Standard	IEEE 802.11ax, 802.11ac, 802.11n, 802.11g, 802.11b, 802.11a

Data Transfer Rate (Theoretical)	5GHz: Max 2402Mbps (11ax) 2.4GHz: Max 574Mbps (11ax)
Frequency Band Class	Dual-Band (2.4GHz, 5GHz)
Wired Standards	IEEE 802.3ab (1000BASE-T), IEEE 802.3u (100BASE-TX), IEEE 802.3 (10BASE-T)
Wired Connectors	WAN: RJ-45 x 1 port LAN: RJ-45 x 4 ports (All ports Auto MDI/MDI-X, Auto-Negotiation compatible)
Wired Transfer Rate	WAN/LAN: 1000Mbps, 100Mbps, 10Mbps
Security Protocol	WPA3 Personal (AES), WPA2 Personal (AES), WPA Personal (TKIP)
Compatible OS	Windows 11/10, macOS Monterey 12/Big Sur 11/Catalina 10.15/Mojave 10.14/High Sierra 10.13/Sierra 10.12/OS X El Capitan 10.11/Yosemite 10.10, iOS 15/14/13/12/11, iPadOS 15/14/13, Android 12/11/10/9/8
Compatible Devices	Android, NINTENDO SWITCH(TM), PlayStation(R) 3/4/5, iPad, iPhone, various wireless LAN devices
Antenna Type	Internal Antenna (2.4GHz: 2 transmit/receive, 5GHz: 2 transmit/receive)
Power Input	AC100V±10% 50/60Hz
Power Consumption	11.5W (Max)
Dimensions (WxDxH)	Approx. 38.8mm x 142.5mm x 178.2mm (excluding protrusions and stand)
Weight	Approx. 365g (main unit only)
Operating Environment	Temperature: 0°C~40°C, Humidity: 10%~85% (non-condensing)
Certifications	VCCI Class B, TELEC, JATE, PSE

9. PRODUCT VIDEOS

ELECOM Wi-Fi Router Comparison and Performance

Video: This video demonstrates the performance of different ELECOM Wi-Fi routers in various home environments (one-room apartment, 3LDK, detached house). It compares Wi-Fi 5 and Wi-Fi 6 routers, showing how router selection based on house size can significantly impact connection speed and stability. The video highlights the importance of choosing the right router for optimal Wi-Fi experience.

ELECOM Wi-Fi 6 Router Overview (WRC-X1800GS-B)

Video: An overview of an ELECOM Wi-Fi 6 router, model WRC-X1800GS-B. While not the exact model, it provides general information about Wi-Fi 6 features and benefits applicable to the WRC-X3000GS2-B, such as stable high-speed connectivity for multiple devices.

10. WARRANTY AND SUPPORT

This product comes with a **1-year manufacturer's warranty** from the date of purchase. Please retain your proof of purchase for warranty claims.

ELECOM Customer Support

Phone: 0570-084-465

FAX: 0570-050-012

Operating Hours: 10:00 - 19:00 (Year-round)

For further assistance, please visit the [ELECOM Brand Store on Amazon](#).