

## Aflybtol BL069

# Aflybtol Drywall Texture Sprayer User Manual

Model: **BL069** | Brand: **Aflybtol**

## 1. INTRODUCTION

This manual provides detailed instructions for the safe and effective use of your Aflybtol Drywall Texture Sprayer. Designed for ease of use and durability, this air-powered texture gun is ideal for various texturizing applications on walls and furniture.

### Key Features:

- **Good Atomization Effect:** High-precision nozzles ensure even spray and a good atomization effect for consistent texture patterns.
- **User-Friendly Design:** Lightweight (approximately 2.68 pounds) and simple controls (trigger, flow valve, air valve) make it suitable for beginners.
- **Easy to Clean:** Designed for easy assembly and disassembly to facilitate thorough cleaning and prevent clogging.
- **Durable Construction:** Features an aluminum alloy gun body and a transparent plastic hopper for wear and corrosion resistance, allowing visibility of remaining paint.
- **Versatile Applications:** Includes three different nozzle sizes (4.0mm, 6.0mm, 8.0mm) for spraying various textures such as knockdown, orange peel, popcorn, and stucco.

## 2. IMPORTANT SAFETY INFORMATION

Please read and understand all safety warnings and instructions before operating this product. Failure to follow these instructions may result in serious injury or property damage. Keep this manual for future reference.

- **Always use protective eyewear and gloves** when operating the air-powered pump sprayer to prevent injury

from pressurized liquids or debris.

- Ensure adequate ventilation in your work area to avoid inhaling fumes from paint or texture materials.
- Never point the sprayer at people or animals.
- Disconnect the air supply before cleaning, performing maintenance, or changing nozzles.
- Keep children and unauthorized persons away from the operating area.
- Use only materials recommended for air texture sprayers.

### **3. PRODUCT COMPONENTS**

Your Aflybtol Drywall Texture Sprayer package includes the following items:

- Hopper texture sprayer gun (Red, Aluminum Alloy body)
- 1.5 Gallon Plastic Hopper
- Three Nozzles: 4.0mm, 6.0mm, 8.0mm
- Hose clamp
- Air quick connector
- Spare O-rings

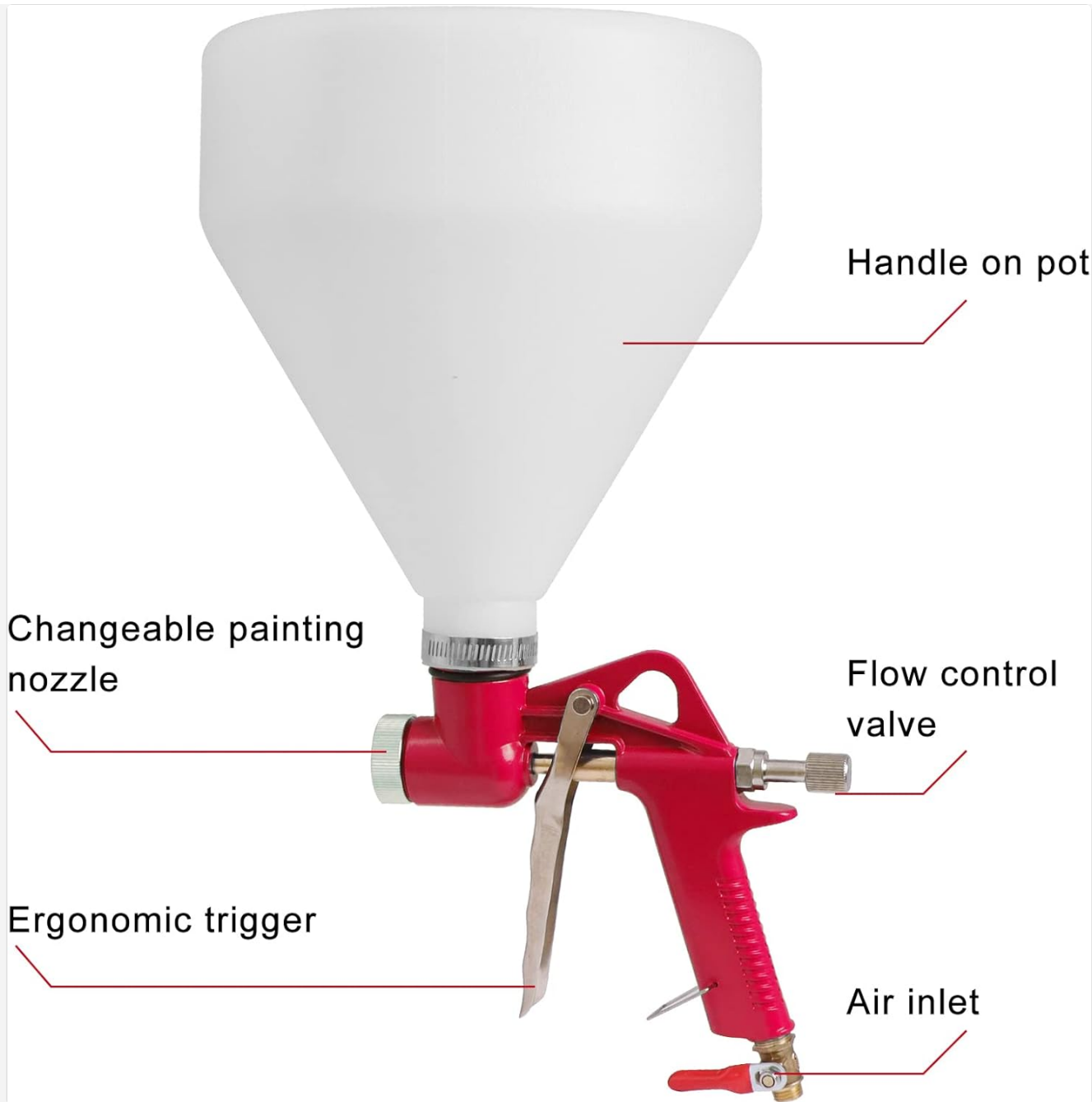

**Figure 3.1:** Labeled diagram of the texture sprayer, highlighting the handle on the pot, changeable painting nozzle, flow control valve, ergonomic trigger, and air inlet.



**Figure 3.2:** The complete texture sprayer kit, including the red gun, white hopper, three different sized nozzles, a hose clamp, and an air quick connector.

## 4. SETUP AND ASSEMBLY

Follow these steps to assemble your drywall texture sprayer before use.

1. **Select Nozzle:** Choose the appropriate nozzle (4.0mm, 6.0mm, or 8.0mm) for your desired texture and place it into the nozzle cap.
2. **Prepare Gun:** Press the trigger of the spray gun completely to the end. Ensure the flow control valve is turned fully to the left (counter-clockwise).
3. **Attach Nozzle:** Screw the nozzle cap with the selected nozzle onto the front of the spray gun.

4. **Connect Hopper:** Install the spray gun to the bottom of the 1.5-gallon hopper. Ensure the O-ring is fully covered and properly seated to prevent leaks.
5. **Secure Connection:** Tighten the hose clamp around the connection point between the gun and the hopper to secure them firmly.
6. **Connect Air Supply:** Attach your air compressor hose to the air inlet on the bottom of the spray gun using the provided air quick connector.

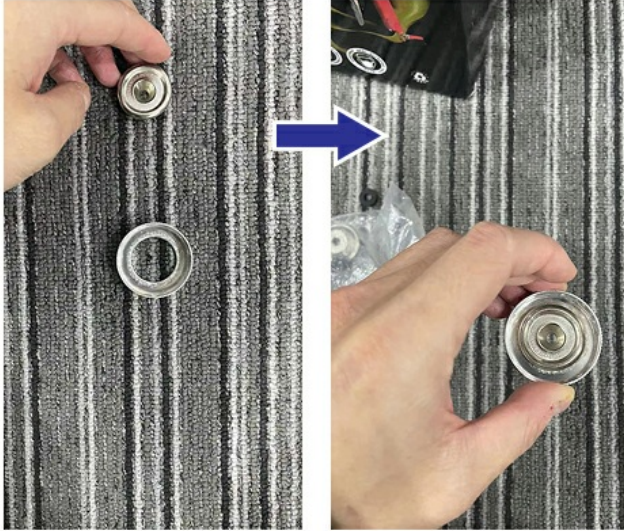

**Step 1:**  
Select the appropriate nozzle , place the nozzle in the cap

**Step 2:**  
press the ① trigger to the end, and let ② be at the far left, as shown in the picture below on the right

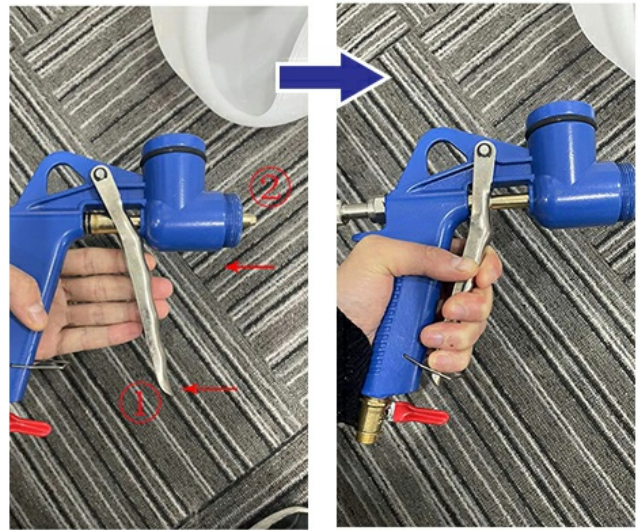
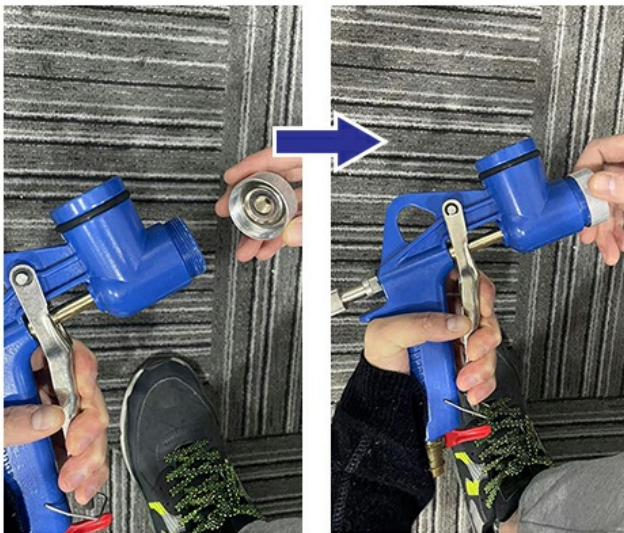

Figure 4.1: Visual instructions for Step 1 (nozzle selection) and Step 2 (trigger and flow valve positioning).



**Step 3:**  
Serew the nozzle onto the gun

**Step 4:**  
Install the gun to the hopper ,the O-ring needs to be fully covered , then tighten the clamp



**Figure 4.2:** Visual instructions for Step 3 (screwing on the nozzle) and Step 4 (installing the gun to the hopper and tightening the clamp).

## 5. OPERATING INSTRUCTIONS

### 5.1. Preparing Material

- Ensure your texture material (e.g., drywall mud, paint) is properly mixed and thinned according to the manufacturer's recommendations for spraying.
- Pour the prepared material into the 1.5-gallon hopper. Do not overfill.

### 5.2. Connecting Air Compressor

- Connect your air compressor to the sprayer's air inlet.
- Set the air compressor pressure. For optimal texture spraying, approximately 50 PSI is recommended. Adjust as needed for desired pattern and material consistency.

### 5.3. Spraying Techniques

- **Nozzle Selection:** Use the 4.0mm nozzle for finer textures, 6.0mm for medium, and 8.0mm for coarser textures like popcorn or heavy knockdown.
- **Flow Control Valve:** Adjust the flow control valve (located near the trigger) to regulate the amount of material being sprayed. Turn clockwise for more material, counter-clockwise for less.
- **Air Valve:** The air valve (at the bottom of the handle) controls the air flow. Adjust it to achieve the desired atomization and spray pattern.
- **Test Spray:** Always perform a test spray on a scrap piece of material or an inconspicuous area to fine-tune settings before applying to your main surface.
- **Application:** Hold the sprayer at a consistent distance from the surface and move it in even, overlapping passes.



Figure 5.1: The texture sprayer actively dispersing material, demonstrating the atomization effect.

## 5.4. Achievable Textures

This sprayer is suitable for creating various popular drywall textures:

- **Orange Peel:** A subtle, bumpy texture resembling the skin of an orange.
- **Knockdown:** A texture where wet material is sprayed and then lightly flattened with a knockdown knife.
- **Popcorn (Acoustic):** A heavier, more pronounced texture often used on ceilings.
- **Stucco:** A rough, durable finish.

# Applicable scenarios

Widely used It can be used in various fields such as automobiles, industry, decoration and furniture.



Figure 5.2: Visual examples of various textures, including orange peel, knockdown, and stucco, achievable with this sprayer.

## 6. MAINTENANCE AND CLEANING

Proper cleaning after each use is crucial to maintain the sprayer's performance and extend its lifespan. Residual paint or texture material can harden and cause clogging.

1. **Disconnect Air:** Always disconnect the air supply from the sprayer before cleaning.
2. **Empty Hopper:** Empty any remaining material from the hopper.
3. **Disassemble:** Disassemble the hopper, gun, and nozzle components.
4. **Rinse Components:** Rinse all components thoroughly with water if using water-based materials, or with an appropriate cleaning agent/solvent if using oil-based materials.
5. **Clean Nozzles:** Pay special attention to cleaning the nozzles and the internal passages of the gun to ensure no material remains. Use a small brush if necessary.
6. **Reassemble:** Once all parts are clean and dry, reassemble the sprayer. Store in a clean, dry place.

## 7. TROUBLESHOOTING GUIDE

This section addresses common issues you might encounter with your texture sprayer.

Problem	Possible Cause	Solution
No spray or weak spray	Clogged nozzle; Insufficient air pressure; Material too thick; Air inlet blocked	Clean nozzle; Increase air pressure (to ~50 PSI); Thin material; Check air hose connection
Inconsistent spray pattern	Uneven material consistency; Incorrect air pressure; Partially clogged nozzle	Ensure material is well-mixed; Adjust air pressure; Clean nozzle thoroughly
Material leaking from connections	Loose connections; Damaged O-rings; Improperly seated hopper	Tighten all connections (especially the hose clamp); Inspect and replace O-rings if damaged; Ensure hopper is correctly seated on the gun
Air but no material flow	Material too thick; Flow control valve closed; Suction tube blocked	Thin material; Open flow control valve; Clear any blockages in the suction tube

## 8. SPECIFICATIONS

Feature	Detail
Brand	Aflybtol
Model Name	BL069
Tank Volume	1.5 Gallons
Color	Red
Material	Aluminum Alloy (Gun Body), Plastic (Hopper)
Product Dimensions	7.87"W x 9.06"H
Item Weight	2.49 pounds
Power Source	Air-powered
Maximum Pressure	50 PSI (Recommended)
Included Components	Hopper texture sprayer, three nozzles (4.0mm, 6.0mm, 8.0mm), paint texture tool kit

# Product size



Figure 8.1: Diagram showing the approximate dimensions of the texture sprayer (23cm height, 20cm width).

## 9. WARRANTY INFORMATION

Aflybltol products are manufactured to high-quality standards. For specific warranty details, including coverage and duration, please refer to the product packaging or contact Aflybltol customer support. Keep your proof of purchase for any warranty claims.

## 10. CUSTOMER SUPPORT

If you have any questions, require assistance, or need to report an issue with your Aflybltol Drywall Texture Sprayer, please contact our customer support team. Refer to the contact information provided on the product packaging or the official Aflybltol website for the most up-to-date support channels.



---

© 2023 Aflybtol. All rights reserved.