

[Manuals.plus](#) /

> [Deeyaple](#) /

> Deeyaple F-8816 Digital LED Alarm Clock Instruction Manual

## Deeyaple F-8816

# Deeyaple F-8816 Digital LED Alarm Clock

## INSTRUCTION MANUAL

### Introduction

---

Thank you for choosing the Deeyaple F-8816 Digital LED Alarm Clock. This manual provides detailed instructions to help you set up, operate, and maintain your new alarm clock. Please read this manual thoroughly before use and retain it for future reference.



Image: Front view of the Deeyaple F-8816 Digital LED Alarm Clock, displaying the time and day of the week.

## Product Features

- Adjustable Brightness: 3 levels (Low, Medium, Bright) or display off.
- Dual Alarms: Set two independent alarms.
- Snooze Function: Provides a 5-minute snooze period.
- Alarm Days Setting: Customize alarms for specific days (e.g., weekdays, weekends).
- 12/24H Time Display: Switch between 12-hour and 24-hour formats.
- Week Display: Shows the current day of the week.
- Power Options: Corded electric (USB cable included) or battery operated (3x AAA batteries, not included).

# Multifunction Meet Various Needs



12/24H



Dual Alarm



LED Display



Week Display



Adjustable  
Brightness



5 Minute  
Snooze



Alarm Date  
Setting



Corded Electric



Battery Memory



Image: Overview of the clock's multifunction capabilities, including 12/24H, Dual Alarm, LED Display, Week Display, Adjustable Brightness, 5 Minute Snooze, Alarm Date Setting, Corded Electric, and Battery Memory.

## Setup

### 1. Powering the Clock

The Deeyaple F-8816 can be powered in two ways:

- **Corded Electric:** Connect the included USB cable to the DC 5V port on the back of the clock and plug it into a USB power adapter (not included). This mode allows the LED display to remain continuously on.
- **Battery Operated:** Insert 3 AAA batteries (not included) into the battery compartment on the back. In battery mode, the LED display will turn off after approximately 8 seconds to conserve power. Press any button to temporarily illuminate the display.

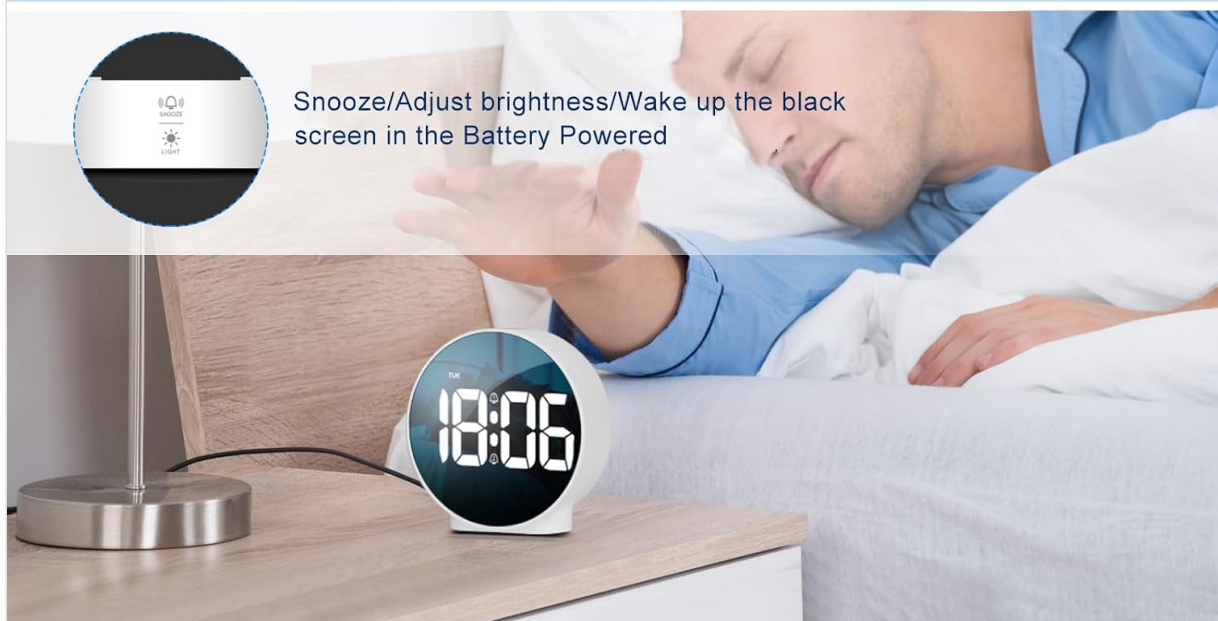
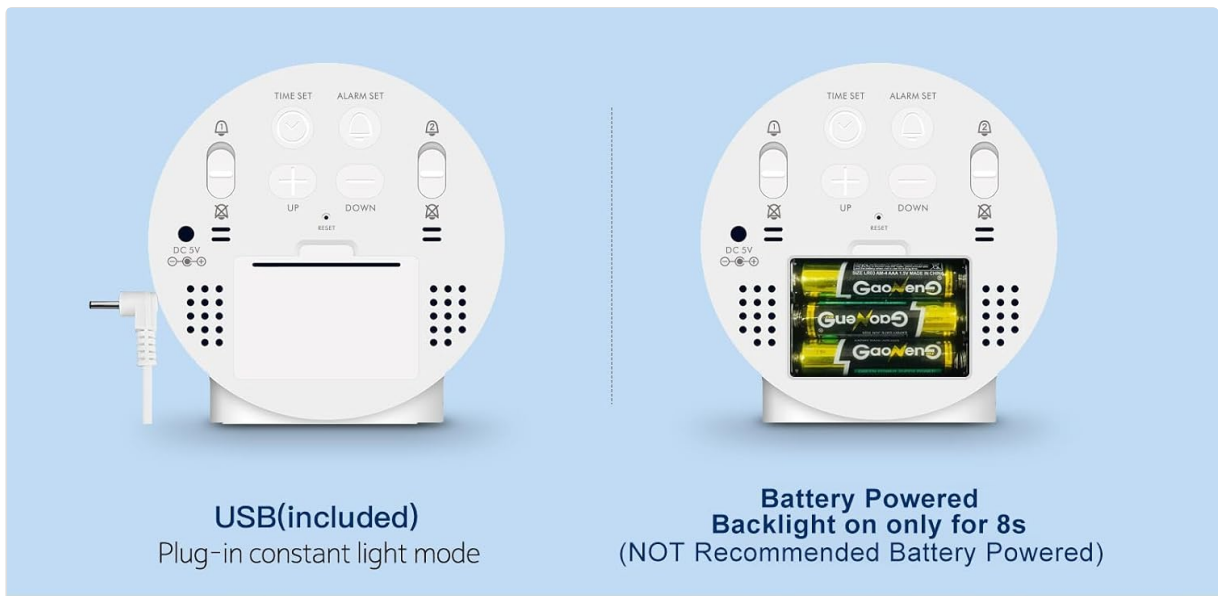

Image: Illustration showing the USB power connection for constant light mode and the battery compartment for power-saving mode.

## 2. Initial Time Setting

Locate the buttons on the back of the clock. Refer to the diagram below for button identification.



- ① TIME SET
- ② ALARM SET
- ③ UP    ⑦ DOWN
- ④ ALARM 1 ON/OFF
- ⑤ ALARM 2 ON/OFF
- ⑥ DC 5V    ⑧ RESET



Image: Detailed view of the clock's rear panel, indicating buttons for Time Set, Alarm Set, Up, Down, Alarm 1 On/Off, Alarm 2 On/Off, DC 5V port, and Reset.

1. Press and hold the **TIME SET** button. The hour digits will begin to flash.
2. Use the **UP** or **DOWN** buttons to adjust the hour.
3. Press **TIME SET** again to confirm the hour and move to minute adjustment.
4. Use the **UP** or **DOWN** buttons to adjust the minutes.
5. Press **TIME SET** a third time to confirm the minutes and exit time setting mode.

## Operating Instructions

### 1. 12/24 Hour Format Selection

While in normal time display mode, press the **UP** button to toggle between 12-hour (with AM/PM indicator) and 24-hour formats.

# 12/24H Time Display

Week And Time Display On The Same Screen



Image: The clock displaying time in 12-hour format (1:48 PM) and 24-hour format (13:48).

## 2. Setting Alarms

The clock features two independent alarms (Alarm 1 and Alarm 2).

1. Press and hold the **ALARM SET** button. The hour digits for Alarm 1 will flash.
2. Use the **UP** or **DOWN** buttons to set the desired alarm hour.
3. Press **ALARM SET** again to confirm the hour and move to minute adjustment.
4. Use the **UP** or **DOWN** buttons to set the desired alarm minutes.
5. Press **ALARM SET** again to confirm minutes and proceed to alarm day settings.
6. Use the **UP** or **DOWN** buttons to select the alarm days:
  - **1-1**: Single day alarm
  - **1-5**: Monday to Friday
  - **1-6**: Monday to Saturday
  - **1-7**: Monday to Sunday
  - **6-7**: Saturday to Sunday
7. Press **ALARM SET** to confirm the alarm day setting.
8. Repeat steps 1-7 for Alarm 2 if desired.



Image: The clock displaying alarm settings with options for 1-1 Day Alarm, 1-5 Monday to Friday, 1-6 Monday to Saturday, 1-7 Monday to Sunday, and 6-7 Saturday to Sunday.

### 3. Activating/Deactivating Alarms

To turn Alarm 1 or Alarm 2 on or off, use the dedicated **ALARM 1 ON/OFF** or **ALARM 2 ON/OFF** buttons on the back of the clock. An alarm icon will appear on the display when an alarm is active.

### 4. Snooze Function

When an alarm sounds, press the large **SNOOZE/LIGHT** button on the top of the clock. The alarm will pause for 5 minutes and then sound again. To turn off the alarm completely, press any other button on the back of the clock.

## 4 Levels Brightness Adjustment



Image: The clock showing different brightness levels and an illustration of pressing the snooze button for a 5-minute snooze.

### 5. Adjusting Brightness

Press the **SNOOZE/LIGHT** button on the top of the clock (when not in alarm mode) to cycle through the 3 brightness levels (Low, Medium, Bright) or turn the display off. This allows you to customize the display visibility to your preference.

### 6. Week Display

The current day of the week is displayed on the upper left corner of the screen, providing a quick reference without needing to switch modes.

10cm/3.94inch



Image: The clock showing the day of the week (MON) and time (13:48) on the same screen.

## Maintenance

---

### Cleaning

To clean the clock, gently wipe the surface with a soft, dry cloth. Do not use abrasive cleaners, solvents, or chemical sprays, as these may damage the finish or internal components. Ensure the clock is unplugged or batteries are removed before cleaning.

### Battery Replacement

If using battery power, replace all three AAA batteries when the display becomes dim or unresponsive. Ensure correct polarity when inserting new batteries.

### Troubleshooting

---

- **Display is off in battery mode:** This is normal behavior to conserve power. Press any button to

temporarily illuminate the display. For a continuously lit display, use corded electric power.

- **Clock not turning on:** Ensure the USB cable is securely connected to a working power adapter and outlet, or that fresh AAA batteries are correctly inserted.
- **Alarm not sounding:** Verify that the alarm is activated (alarm icon visible on display) and that the alarm time is correctly set. Check the alarm day settings.
- **Incorrect time/date:** Perform a reset by inserting a thin object (like a paperclip) into the **RESET** hole on the back of the clock, then re-set the time and alarms.

## Specifications

<b>Brand</b>	Deeyaple
<b>Model Number</b>	F-8816
<b>Colour</b>	White
<b>Product Dimensions</b>	10.16 x 3.81 x 10.16 cm
<b>Item Weight</b>	163 g
<b>Display Type</b>	Digital
<b>Special Features</b>	Large Display, Dual Alarms, Dimming, Silent Operation

## Warranty and Support

For warranty information or technical support, please refer to the product packaging or contact Deeyaple customer service through their official website or the retailer where the product was purchased. Keep your purchase receipt as proof of purchase.