

[Manuals.plus](#) /

› [SOLRIG](#) /

› SOLRIG 30x80 5-Lite Tempered Frosted Glass Sliding Pocket Door Panel Instruction Manual

## SOLRIG 30x80 5 Lites Pocket Door Panel

# SOLRIG 30x80 5-Lite Tempered Frosted Glass Sliding Pocket Door Panel

Instruction Manual

## 1. INTRODUCTION

---

Thank you for choosing the SOLRIG 30x80 5-Lite Tempered Frosted Glass Sliding Pocket Door Panel. This manual provides essential information for the safe and correct assembly, installation, operation, and maintenance of your new pocket door. Please read these instructions thoroughly before beginning installation and retain them for future reference.

## 2. PRODUCT OVERVIEW

---

The SOLRIG sliding pocket door panel is designed to offer a modern aesthetic and maximize space in your home. It features five lites of tempered frosted glass, providing privacy while allowing light to pass through. This door panel is suitable for various interior applications, including bathrooms, bedrooms, studies, kitchens, and closets.



Image: SOLRIG sliding pocket door in a living room, highlighting its space-saving design and frosted glass.



Image: Illustration of the space-saving benefit of a sliding pocket door.

The door panel is constructed from high-quality MDF (Medium-Density Fiberboard), known for its stability, resistance to warping, and smooth finish. The tempered frosted glass is durable and easy to clean.



Image: Key features of the door panel, including MDF construction, water resistance, tempered frosted glass, and load-bearing stability.

### 3. SAFETY INFORMATION

- Always wear appropriate personal protective equipment (PPE) such as safety glasses and gloves during assembly and installation.
- Ensure the installation area is clear of obstructions and well-lit.
- The door panel is heavy (approximately 77 lbs). Use proper lifting techniques or seek assistance to prevent injury.
- Verify that the wall structure can support the weight of the door and any associated hardware.
- Keep children and pets away from the work area during installation.
- Do not modify the door panel or glass in any way that is not explicitly described in this manual.

### 4. PACKAGE CONTENTS

The SOLRIG 30x80 5-Lite Tempered Frosted Glass Sliding Pocket Door Panel package includes:

- 1x White Door Slab (unassembled)
- 5x Frosted Opaque Tempered Glass Panels
- Assembly hardware (screws, connectors)

**Note:** This package does **not** include a full hardware kit for the pocket door system (e.g., track, rollers, guides, door handle). These components must be purchased separately. The door panel does not come with pre-drilled holes for hardware such as handles or pulls.

## 5. SPECIFICATIONS

<b>Brand</b>	SOLRIG
<b>Model</b>	30" x 80" 5 Lites Pocket Door Panel
<b>Dimensions (Door Panel)</b>	1.37" (thickness) x 30" (width) x 80" (height)
<b>Material</b>	Engineered Wood (MDF), Tempered Frosted Glass
<b>Item Weight</b>	Approximately 77 Pounds
<b>Assembly Required</b>	Yes

# Single Pocket Door Panel

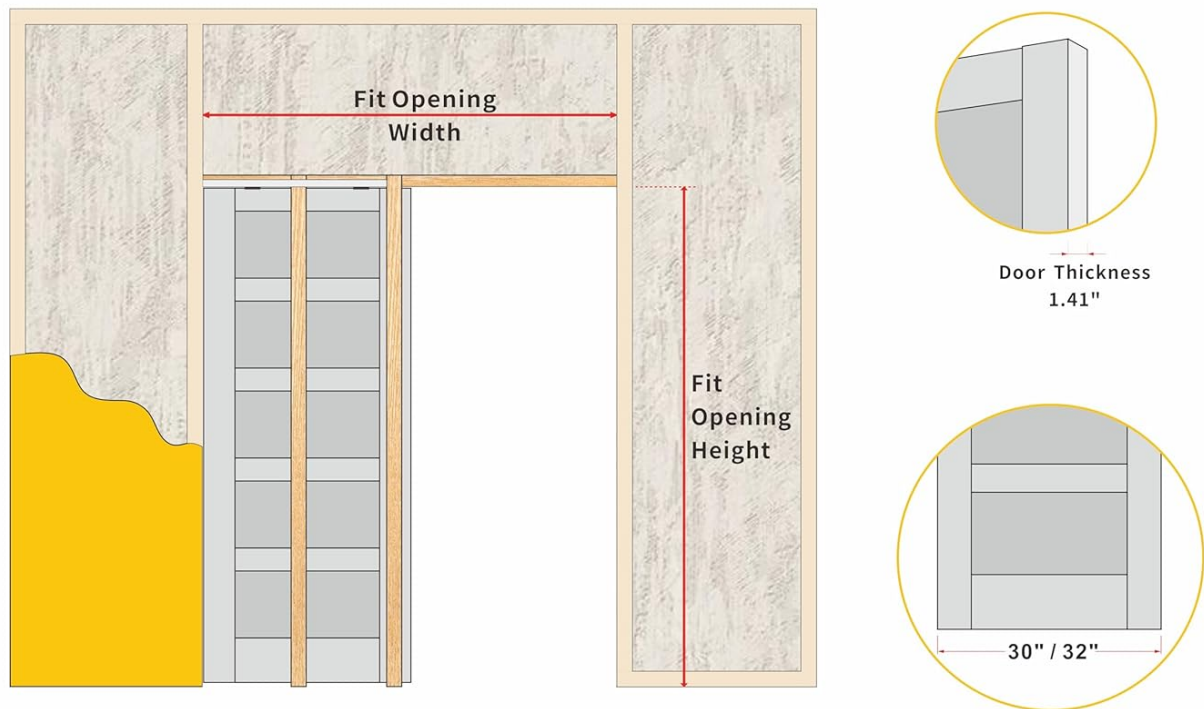

## OVERALL DIMENSIONS

Door Size	Fit Opening Width	Fit Opening Height	Stud Walls
30" x 80"	60 3/8"	82 3/4"	2" x 4"
32" x 80"	64 3/8"	82 3/4"	

**Note:** Please measure the rough opening of your door accurately before purchasing to ensure a proper fit.

Image: Dimensional diagram for pocket door installation, including required rough opening sizes.

**Important:** Please measure your rough opening accurately before purchasing and installing any hardware to ensure a proper fit. Refer to the diagram above for recommended opening dimensions based on door size.

## 6. SETUP AND INSTALLATION

This section outlines the general steps for installing a pocket door. Note that this product is a door panel only; a separate pocket door hardware kit (track, rollers, guides, etc.) is required and must be installed according to its manufacturer's instructions. The door panel itself requires assembly before installation into the pocket door frame.

### 6.1. Door Panel Assembly

Assemble the door slab and glass panels using the provided hardware. Ensure all connections are secure. Pay close attention to the orientation of the glass panels (frosted side) as desired.

### 6.2. Pocket Door Frame Installation (General Steps - Requires separate hardware kit)

The following steps are a general guide for installing a pocket door frame. Always refer to the specific instructions provided with your chosen pocket door hardware kit.

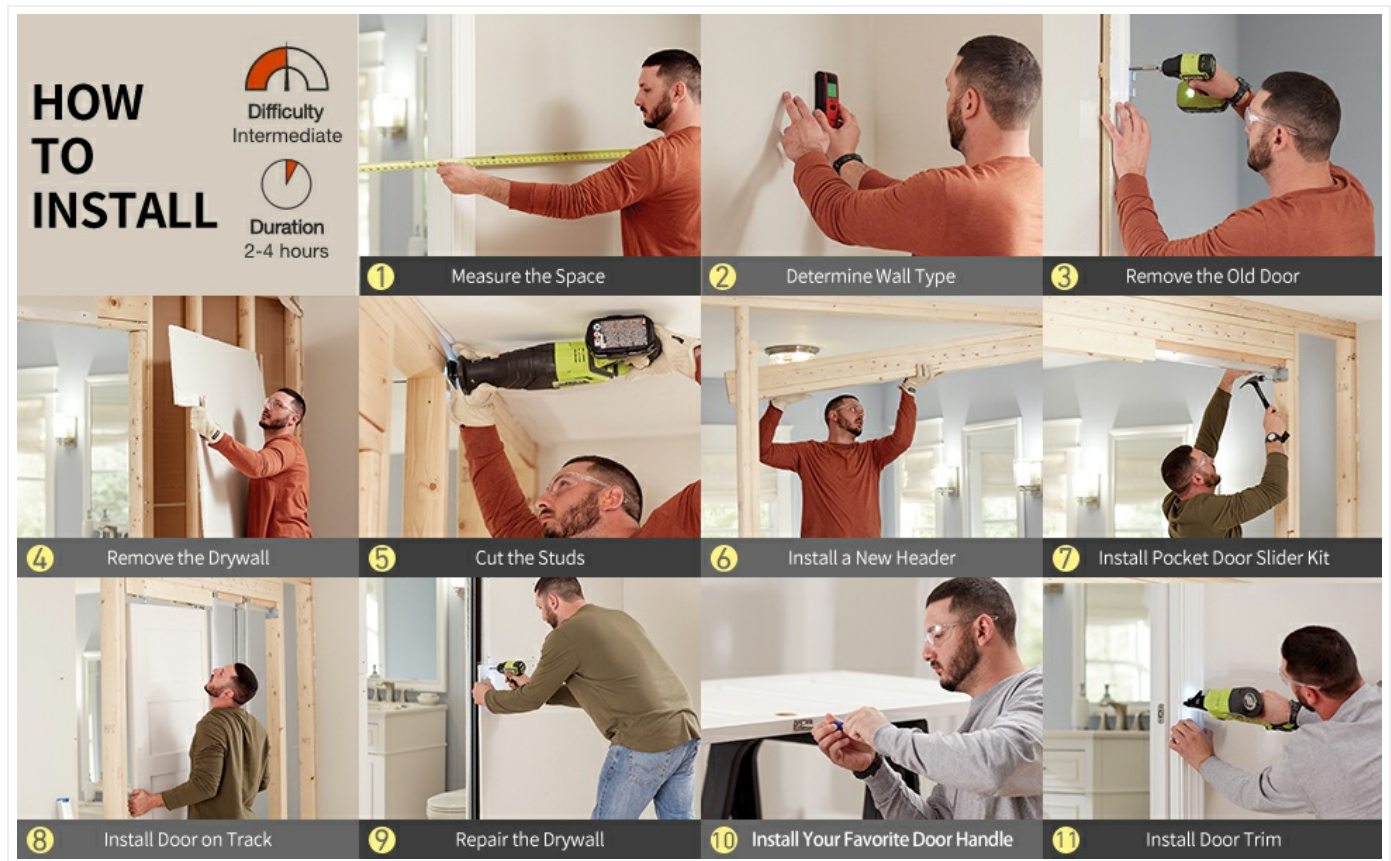

Image: Visual guide for pocket door installation process.

1. **Measure the Space:** Accurately measure the rough opening where the pocket door will be installed. Ensure it matches the requirements for your door panel and hardware kit.
2. **Determine Wall Type:** Identify if the wall is load-bearing or non-load-bearing. This affects how you modify the wall structure.
3. **Remove the Old Door (if applicable):** Carefully remove any existing door, frame, and trim.
4. **Remove the Drywall:** Cut and remove the drywall from the area where the pocket door frame will be installed.
5. **Cut the Studs:** Cut existing wall studs to accommodate the pocket door frame. Reinforce the opening as necessary.
6. **Install a New Header:** Install a new header above the door opening to support the wall structure.
7. **Install Pocket Door Slider Kit:** Assemble and install the pocket door frame and track system according to the hardware kit manufacturer's instructions. Ensure the track is level and securely fastened.
8. **Install Door on Track:** Hang the assembled SOLRIG door panel onto the installed track system. Adjust rollers for smooth operation.
9. **Repair the Drywall:** Install new drywall to cover the pocket door frame, ensuring it is flush with the existing wall.
10. **Install Your Favorite Door Handle:** Once the drywall is repaired and finished, install your chosen pocket door handle or pull. Note that the SOLRIG door panel does not come with pre-drilled holes for hardware.
11. **Install Door Trim:** Finish the installation by adding door trim around the opening and pocket.

For detailed instructions on installing the pocket door hardware kit, please consult the manual provided by the hardware manufacturer.

## 7. OPERATION

The SOLRIG sliding pocket door operates by gliding smoothly along an overhead track, disappearing into a wall cavity

when opened. To open, gently pull the door panel from its closed position until it fully retracts into the wall. To close, pull the door panel out of the wall cavity until it meets the door jamb. Ensure the door moves freely without excessive force or binding.

If a door handle or pull is installed, use it to guide the door. If no handle is installed, use the edge of the door panel to slide it. Be mindful of fingers and hands when operating the door to avoid pinching.

## 8. MAINTENANCE

---

Regular maintenance will ensure the longevity and smooth operation of your SOLRIG pocket door panel.

- **Cleaning the Door Panel:**
  - For the MDF door slab, wipe with a soft, damp cloth. Avoid abrasive cleaners or harsh chemicals that could damage the finish.
  - For the tempered frosted glass, use a standard glass cleaner and a soft, lint-free cloth.
  - Promptly clean any spills or moisture to prevent damage to the MDF material.
- **Track and Hardware:**
  - Periodically inspect the pocket door track and rollers (part of your separate hardware kit) for debris or wear. Clean the track as needed to ensure smooth gliding.
  - Lubricate moving parts of the hardware kit according to the hardware manufacturer's recommendations.
  - Check all screws and fasteners for tightness and re-tighten if necessary.
- **Glass Inspection:** Regularly inspect the glass panels for any signs of damage or cracks. Tempered glass is designed to break into small, blunt pieces for safety, but any damage should be addressed immediately.

## 9. TROUBLESHOOTING

---

If you encounter issues with your SOLRIG pocket door panel, consider the following common solutions:

Problem	Possible Cause / Solution
Door sticks or is difficult to slide.	<ul style="list-style-type: none"><li>• <b>Debris in track:</b> Clean the overhead track thoroughly.</li><li>• <b>Rollers need lubrication:</b> Apply a silicone-based lubricant to the rollers (refer to hardware kit manual).</li><li>• <b>Misaligned track:</b> Check if the track is level and properly secured. Adjust as needed.</li><li>• <b>Door guides catching:</b> Ensure the bottom door guides are correctly positioned and not obstructed. Some reviewers noted issues with horizontal slats catching on guides; ensure proper clearance during installation.</li></ul>
Door does not close completely or leaves a gap.	<ul style="list-style-type: none"><li>• <b>Door stop adjustment:</b> Adjust the door stops on the track to allow full closure.</li><li>• <b>Obstruction in pocket:</b> Check for any objects or debris inside the wall pocket.</li></ul>

Visible screw holes after assembly.	This is a known characteristic of the panel assembly. The manufacturer provides stickers to cover these holes. For a more integrated finish, consider using wood filler and paint matching the door color.
Difficulty pulling door out of pocket without a handle.	The door panel does not come with pre-installed handles. It is recommended to install a pocket door pull or handle during the installation process, ideally before finishing the wall, to ensure easy access and operation.

## 10. WARRANTY AND SUPPORT

---

SOLRIG is committed to providing excellent customer service. If you encounter any issues, including product damage or missing parts, please contact our support team immediately. We are dedicated to assisting you and ensuring your satisfaction.

For support, please visit the SOLRIG store on Amazon or use the contact seller option through your order details. Provide your order number and a detailed description of the issue for prompt assistance.



Image: Guide on how to contact customer support via Amazon.

While specific warranty details are not provided in this manual, SOLRIG stands behind its products and will work to resolve any manufacturing defects or issues related to product quality.

