

POWERTEC 70304

POWERTEC 70304 2-1/2" Dust Collection Fittings Network Instruction Manual

Model: 70304

INTRODUCTION

This manual provides detailed instructions for the assembly, operation, and maintenance of your POWERTEC 70304 2-1/2" Dust Collection Fittings Network. This comprehensive set of fittings is designed to create an efficient dust collection system in your workshop, connecting various tools to a central dust collector.

INCLUDED COMPONENTS

The POWERTEC 70304 kit includes the following components:

- **5 x** 2-1/2" Dust Collection Blast Gates
- **1 x** 4-to-2-1/2" Tapered Reducer
- **4 x** 3ft Clear PVC Dust Collection Pipes (2-1/2" diameter)
- **4 x** 2-1/2" Y-Fittings
- **1 x** 2-1/2" 90-Degree Elbow Connector
- **10 x** U Bracket Clamp Hangers
- **20 x** Screw Pans
- **20 x** Wall Plugs

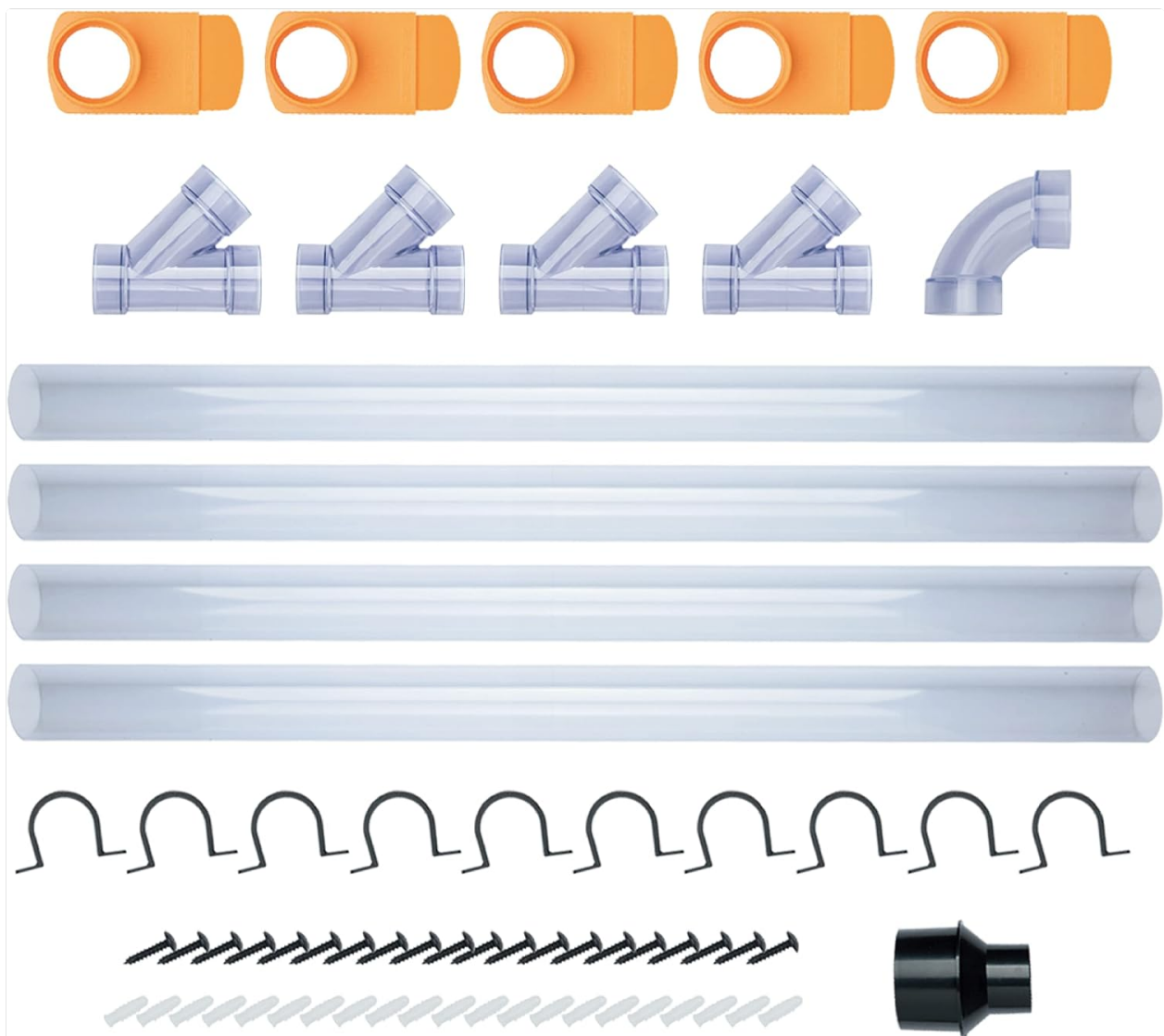

Figure 1: Overview of all components included in the kit.

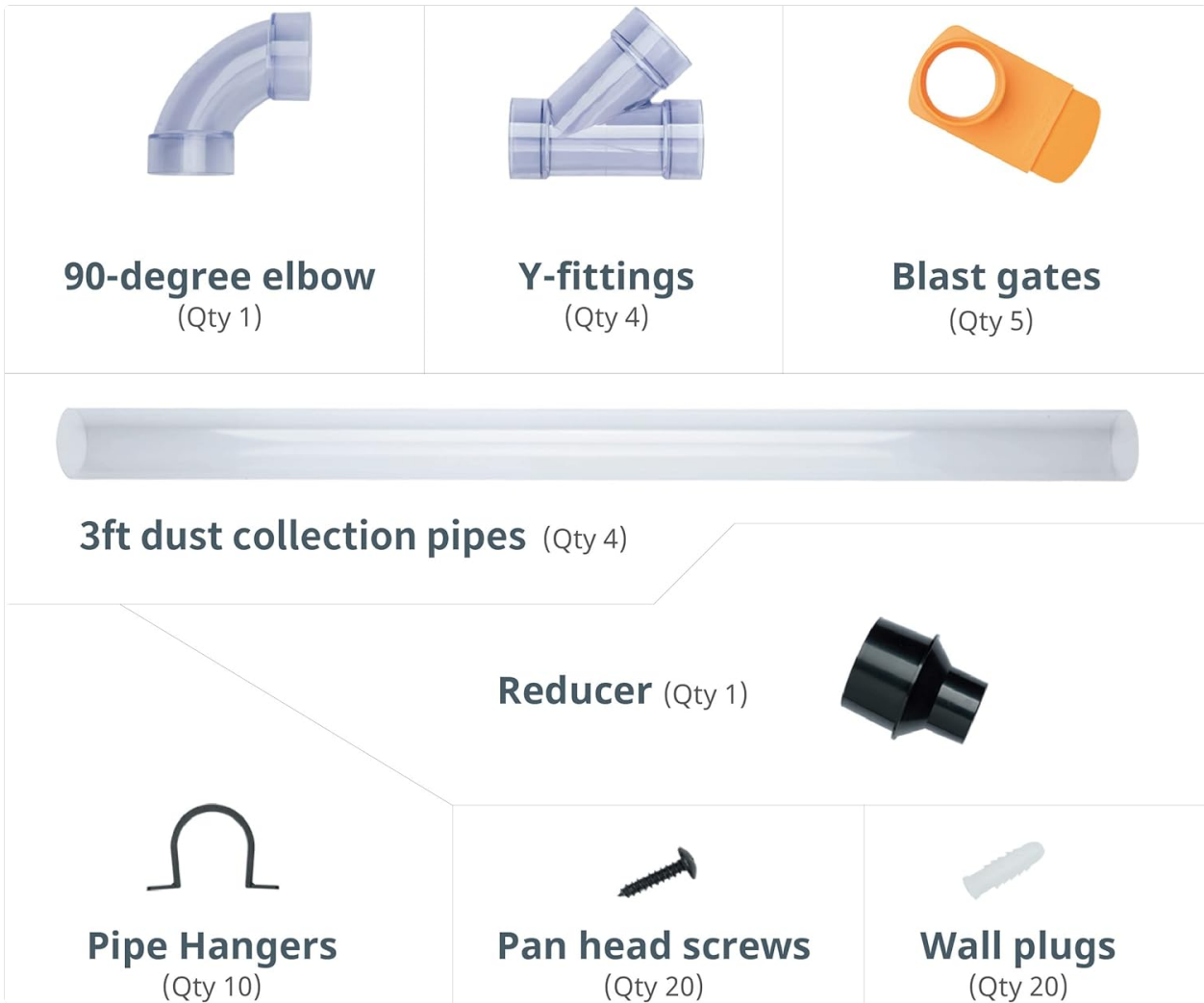

Figure 2: Detailed view and labeling of each component.

SETUP AND ASSEMBLY

The components of this dust collection network are designed for a snug friction fit, eliminating the need for additional couplers. Plan your workshop layout before assembly to optimize dust extraction efficiency.

Assembly Steps:

- 1. Plan Your Layout:** Determine the optimal path for your dust collection pipes, considering the location of your dust collector and various woodworking machines.
- 2. Connect Pipes and Fittings:** The clear PVC pipes fit directly into the Y-fittings and 90-degree elbow. Apply firm, even pressure to ensure a secure connection. Pipes can be cut to custom lengths if required for your specific setup.
- 3. Install Blast Gates:** Attach the blast gates to the Y-fittings or directly to the main pipe run where you intend to connect individual machines. Ensure the "OUT" side of the blast gate points towards the dust collector to prevent clogs.

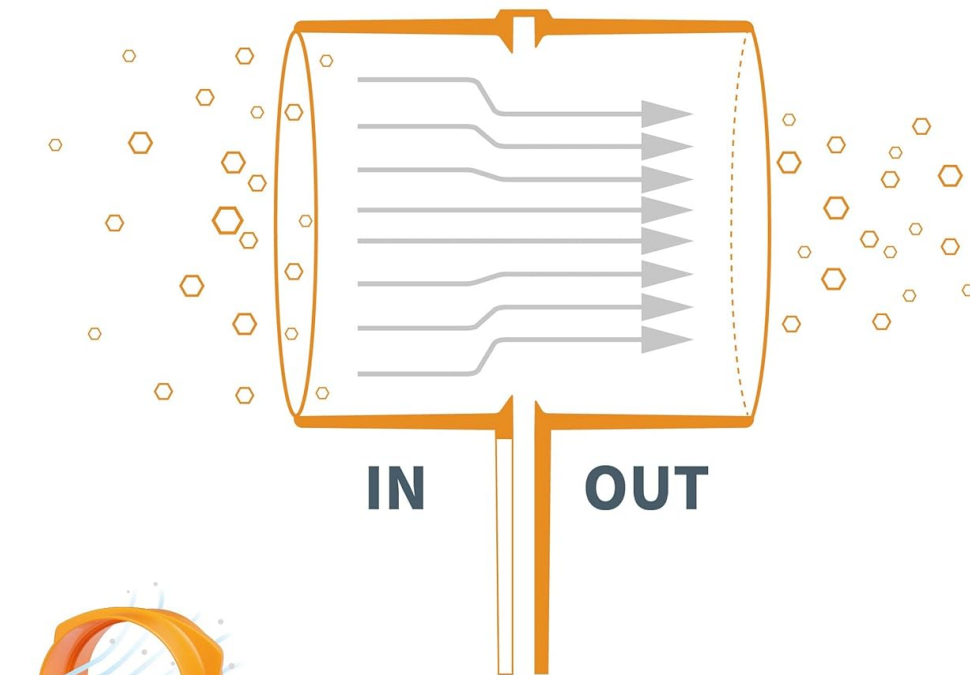
SIDE VIEW

Shaped airflow prevents dust particles accumulating in the gate track

Figure 3: Blast gate internal airflow diagram.

- 4. Mounting the System:** Use the U bracket clamp hangers, screw pans, and wall plugs to secure the dust collection network to your workshop walls or workbench. The hangers are designed to fit over the Y-fittings for optimal support.

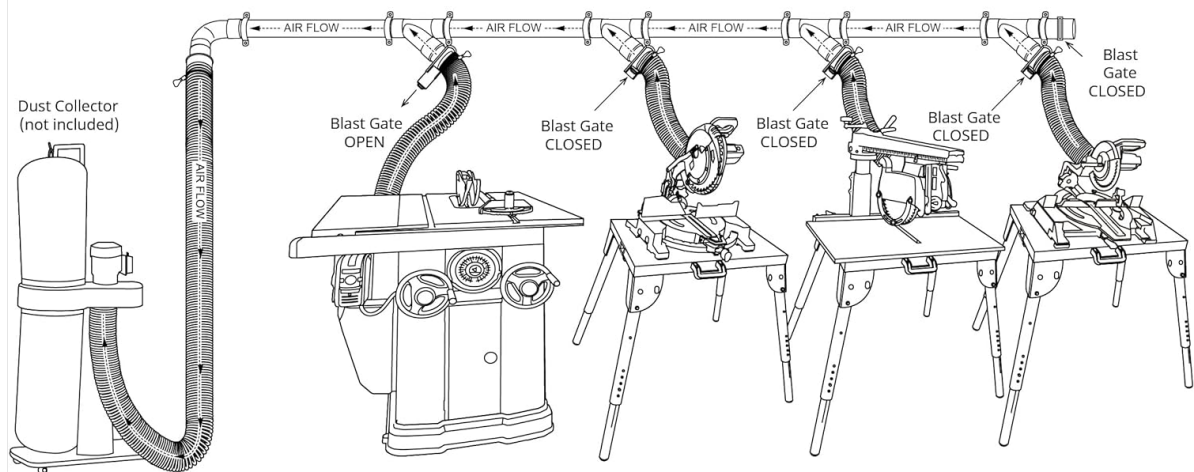

Figure 4: Example of a dust collection system layout.



Figure 5: Y-fitting and flexible hose connection.

5. **Connect to Dust Collector:** Use the 4-to-2-1/2" tapered reducer to connect your main dust collection line to a larger dust collector hose if needed.



Figure 6: Detailed view of a Y-fitting connection.

Assembly Video Guide:

Your browser does not support the video tag.

Video 1: A visual guide demonstrating how to build the ultimate workshop dust collector set-up using the POWERTEC 70304 kit. This video shows the assembly process and connection of various components.

OPERATING INSTRUCTIONS

Once your dust collection network is assembled and connected to a dust collector, operation is straightforward:

1. **Activate Dust Collector:** Turn on your primary dust collector unit.
2. **Open Relevant Blast Gate:** For the machine you intend to use, open its corresponding blast gate. Ensure all other blast gates are closed to maximize suction at the active machine.
3. **Begin Work:** Operate your woodworking machine as usual. The dust collection system will draw away debris.

4. **Close Blast Gate:** Once finished with a machine, close its blast gate before opening another one or turning off the dust collector.

The clear plastic components allow for visual monitoring of airflow and potential blockages.

MAINTENANCE

Regular maintenance ensures optimal performance and longevity of your dust collection network:

- **Check for Blockages:** Periodically inspect the clear pipes and fittings for any accumulation of dust, wood chips, or other debris. Clear any blockages promptly to maintain airflow.
- **Clean Components:** If necessary, disconnect sections and clean the interior of pipes and fittings with a brush or compressed air.
- **Inspect Connections:** Ensure all friction-fit connections remain snug. If any connection loosens over time, re-seat it firmly.
- **Check Hangers:** Verify that all U bracket clamp hangers are securely fastened and providing adequate support to the system.

TROUBLESHOOTING

Common issues and their solutions:

Problem	Possible Cause	Solution
Reduced Suction	<ul style="list-style-type: none">◦ Open blast gates at inactive machines.◦ Blockage in pipes or fittings.◦ Dust collector bag/filter full.◦ Loose connections.	<ul style="list-style-type: none">◦ Ensure only the active machine's blast gate is open.◦ Inspect clear pipes for visible blockages and clear them.◦ Empty dust collector bag or clean/replace filter.◦ Check and tighten all connections.
Fittings difficult to connect	Tight friction fit.	Apply firm, even pressure. A slight twisting motion may help. Ensure components are aligned correctly.
System not stable	Insufficient mounting or improper hanger placement.	Ensure all U bracket clamp hangers are used and securely fastened, especially around Y-fittings.

SPECIFICATIONS

- **Model Number:** 70304
- **Size:** 2-1/2 Inch (pipe and fitting diameter)
- **Material:** High-quality, industrial strength plastic (clear for pipes and Y-fittings, orange for blast gates, black for reducer)
- **Item Dimensions (L x W x H):** 41.31 x 9.88 x 6.31 inches (packaged)
- **Item Weight:** Approximately 1 pound (packaged)
- **Number of Pieces:** 65 (total components in kit)
- **Manufacturer:** POWERTEC
- **Country of Origin:** Taiwan

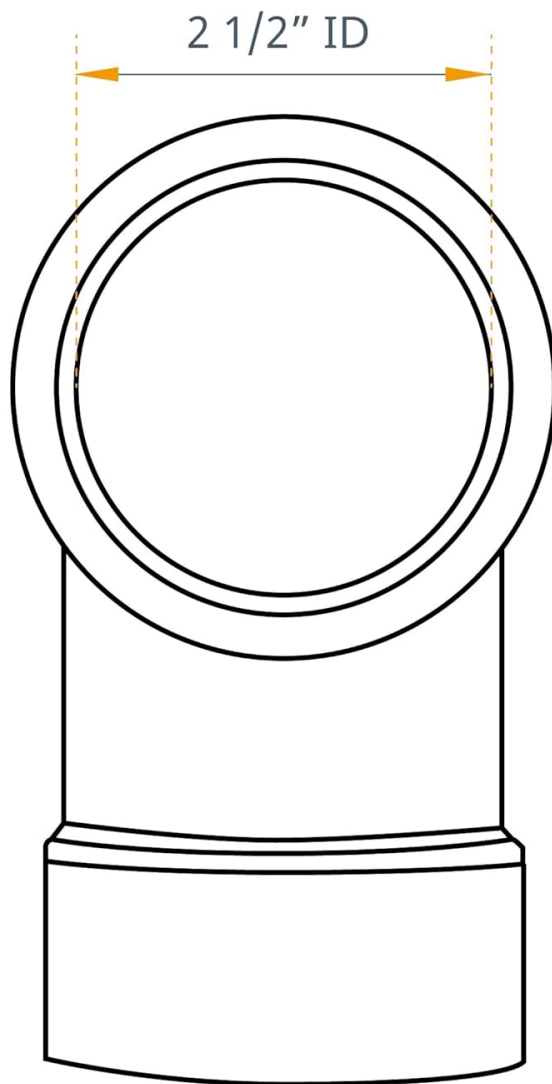

Figure 7: 2-1/2" ID measurement for fittings.

WARRANTY AND SUPPORT

Specific warranty information for the POWERTEC 70304 Dust Collection Fittings Network is not provided in this document. Please refer to the manufacturer's official website or contact POWERTEC customer support for detailed warranty terms and conditions, as well as any additional product support.

For further assistance, you may also refer to the official User Manual (PDF) available online [POWERTEC 70304 User Manual PDF](#)

	<p>POWERTEC MT4000 Miter Saw Stand Owner's Manual</p> <p>Comprehensive owner's manual for the POWERTEC MT4000 Miter Saw Stand, covering safety, assembly, operation, maintenance, and warranty information.</p>
	<p>Powertec PT3200i 3000W Digital Inverter Generator Operating Instructions</p> <p>Operating instructions for the Powertec PT3200i 3000W Digital Inverter Generator, covering safety, features, operation, maintenance, and troubleshooting.</p>
	<p>POWERTEC PTi4500 4500W Digital Inverter Generator: Operating Instructions</p> <p>Comprehensive operating instructions and safety guide for the POWERTEC PTi4500 4500W Digital Inverter Generator, covering specifications, intended use, safety precautions, maintenance, troubleshooting, and warranty information.</p>
	<p>Powertec Workbench Levergym WB-LS14 Assembly Manual - Step-by-Step Guide</p> <p>Comprehensive assembly manual for the Powertec Workbench Levergym WB-LS14. Includes parts list, detailed step-by-step instructions, safety precautions, and maintenance tips.</p>
	<p>POWERTEC PT3300Ei 3300W Digital Inverter Generator Operating Instructions</p> <p>Comprehensive operating instructions for the POWERTEC PT3300Ei 3300W Digital Inverter Generator. Learn about safety rules, assembly, operation, maintenance, troubleshooting, and specifications.</p>

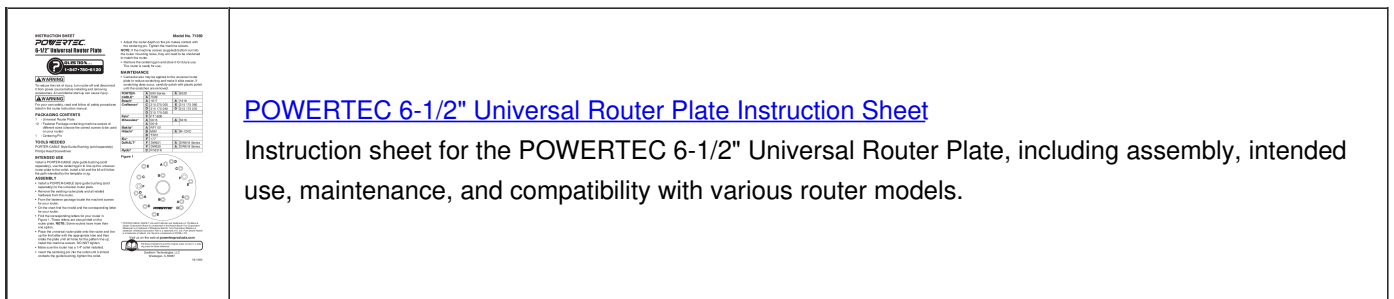

Documents - POWERTEC – 70304

[\[pdf\]](#) Catalog



POWERTEC 6 in x 36 Long Clear Pipe Rigid Plastic Tubing for Dust Collection Hose and Fittings 70274

The Home Depotc55c1bfe 5ad2 448c 93ff 8cdaca435308images thdstatic catalog Images c5 c55c1bfe 8cdaca435308 |||

DUST MANAGEMENT 2023 PRODUCT CATALOG Watch Video Universal Dust Coupler Secure 4 Flex Hose to Smal ... rs, and accessories, to suit your specific requirements and promote better air quality and safety. **70304** 2-1/2 Dust Collection Fittings Network 70320 2-1/2 Y Fitting, Clear PVC 70321 2-1/2 90 De...

lang:en score:19 filesize: 12.28 M page_count: 29 document date: 2023-12-29



[\[pdf\]](#) User Manual Owner's Manual Instructions Label

View file POWERTEC Dust Collection Fittings Network 2 1 Inch w Reducer Blast Gates Pipes 90 Degree Elbow Connector Y fittings Mounting Brackets 70304 store yh2g6i mybigcommerce content |||

INSTRUCTION SHEET 2-1/2 Dust Collection Network QUESTION... 18477806120

Visit us on the web at www. ... attempt to operate tool until it is completely assembled according to the instructions. Model No. **70304** WARNING Metal shavings or dust can set sawdust on fire. Collect wood materials only. Do not co...

lang:en score:18 filesize: 395.45 K page_count: 2 document date: 2021-09-17



[POWERTEC Dust Management 2023 Product Catalog](#)

Comprehensive catalog of POWERTEC dust collection systems, air filtration, blast gates, fittings, hoses, and clamps for workshops. Features product details, SKUs, and specifications.

lang:en score:17 filesize: 12.32 M page_count: 29 document date: 2025-07-09



[\[pdf\]](#) Catalog

DUST MANAGEMENT 2023DustManagement powertecproducts content |||

DUST MANAGEMENT 2023 PRODUCT CATALOG Watch Video Universal Dust Coupler Secure 4 Flex Hose to Smal ... rs, and accessories, to suit your specific requirements and promote better air quality and safety. **70304** 2-1/2 Dust Collection Fittings Network 70320 2-1/2 Y Fitting, Clear PVC 70321 2-1/2 90 De...

lang:en score:15 filesize: 12.28 M page_count: 29 document date: 2023-12-29