

[Manuals.plus](#) /

> [JYX](#) /

> JYX Wireless Microphone System User Manual

## JYX JYX-U30

# JYX Wireless Microphone System User Manual

Model: JYX-U30

## INTRODUCTION

Thank you for choosing the JYX Wireless Microphone System. This dual UHF cordless microphone system is designed to provide clear, stable audio transmission for various applications, including karaoke, meetings, weddings, and speeches. Please read this manual carefully to ensure proper operation and maintenance of your device.

## SAFETY INFORMATION

- Do not expose the device to rain or moisture.
- Avoid extreme temperatures and direct sunlight.
- Do not disassemble the unit. Refer all servicing to qualified personnel.
- Keep away from strong magnetic fields.
- Use only the specified charging accessories.

## PACKAGE CONTENTS



The JYX Wireless Microphone System package includes:

- 2 x JYX UHF Wireless Microphones (one grey, one red)
- 1 x Rechargeable Receiver (6.35mm jack)
- 2 x Anti-roll Rings (orange)
- 1 x 3.5mm Adapter
- 1 x USB Charging Cable
- User Manual (this document)

*Image description: A complete set of the JYX Wireless Microphone System, showing two handheld microphones (one grey, one red), a compact black receiver with a 6.35mm jack, two orange anti-roll rings, and a 3.5mm adapter.*

## SETUP GUIDE

### 1. Charging the Receiver and Microphones



Before first use, ensure both the microphones and the receiver are fully charged.

- The receiver requires approximately 3-5 hours for a full charge, providing 8-10 hours of operation.
- Connect the USB charging cable to the charging port on the receiver and a suitable USB power adapter.
- To charge the microphones, unscrew the bottom part of the microphone to reveal the battery compartment. Connect the charging cable directly to the microphone's charging port.
- A charging indicator light will typically show charging status and turn off or change color when fully charged.

*Image description: Two JYX wireless microphones (red and grey) and the receiver are shown on a wooden table, with charging cables connected to a wall outlet, illustrating the charging process.*

## 2. Connecting the Receiver

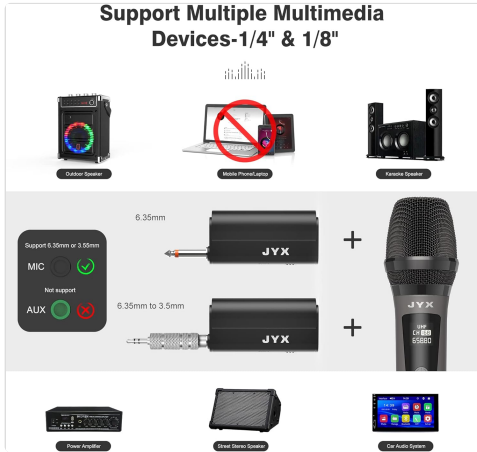

The receiver features a 6.35mm (1/4 inch) jack for connection to compatible audio devices.

- Insert the receiver directly into the microphone input (MIC IN) of your karaoke machine, amplifier, mixer, or powered speaker.
- If your device has a 3.5mm (1/8 inch) microphone input, use the included 3.5mm adapter.
- Ensure the host device's volume is set to a low level before connecting to avoid sudden loud noises.

*Image description: An illustration demonstrating the compatibility of the JYX Wireless Microphone System with various multimedia devices such as karaoke machines, powered speakers, mixers, street stereo speakers, car audio systems, and power amplifiers, highlighting the use of 6.35mm and 3.5mm adapters.*

## OPERATING INSTRUCTIONS

### 1. Powering On and Auto Pairing



- Turn on the receiver by pressing its power button. A light indicator will confirm it is on.
- Turn on each microphone by pressing its power button. The microphones will automatically pair with the receiver.
- The display on the microphone will show the channel and battery status once paired.

*Image description: A two-step illustration showing the auto-pairing process: Step 1 depicts a hand holding a microphone and another hand holding the receiver, with a green checkmark and dotted lines indicating successful pairing. Step 2 shows the receiver plugged into a karaoke machine, labeled "Plug and Play."*

### 2. Microphone Usage



- Hold the microphone approximately 2-6 inches from your mouth for optimal sound pickup.
- The microphone features a unidirectional polar pattern with 180° pickup for high-quality sound, effectively capturing audio from the front while minimizing background noise.
- Adjust the volume on your connected audio device (karaoke machine, amplifier, etc.) to achieve the desired sound level. The microphones themselves do not have volume controls.
- The system offers a stable signal with an operating range of up to 100 feet (line of sight).

*Image description: An illustration demonstrating the 180° sound pickup pattern of the JYX microphone, with arrows indicating sound reception from various angles around the microphone head, emphasizing high-quality sound and noise reduction.*

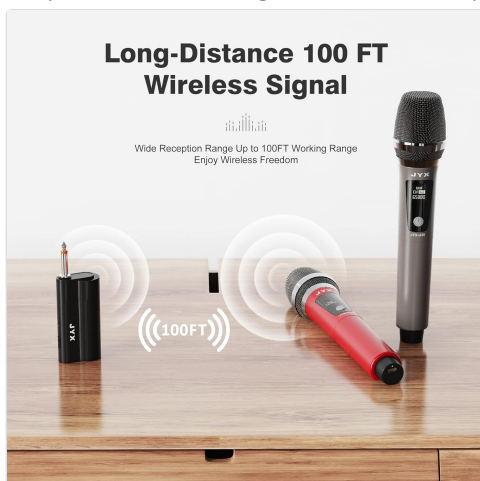

- Maintain a clear line of sight between the microphones and the receiver for best performance. Obstacles can reduce the effective range.
- Avoid placing the receiver near strong electromagnetic interference sources.

*Image description: An illustration showing a JYX microphone and receiver on a wooden surface, with concentric circles and "100FT" text indicating the long-distance wireless signal range of 100 feet.*

## MAINTENANCE

- **Cleaning:** Use a soft, dry cloth to clean the microphones and receiver. Do not use abrasive cleaners or solvents.
- **Storage:** When not in use for extended periods, store the system in a cool, dry place, away from direct sunlight and extreme temperatures.
- **Battery Care:** For optimal battery life, fully charge the devices before long-term storage and recharge them every 3-6 months.
- **Anti-roll Rings:** Place the included orange anti-roll rings on the microphones to prevent them from rolling off surfaces and to provide minor impact protection.

## TROUBLESHOOTING

Problem	Possible Cause	Solution
No sound from microphone.	<ul style="list-style-type: none"><li>◦ Microphone or receiver not powered on.</li><li>◦ Microphone not paired with receiver.</li><li>◦ Receiver not properly connected to audio device.</li><li>◦ Audio device volume too low or muted.</li><li>◦ Microphone battery low.</li></ul>	<ul style="list-style-type: none"><li>◦ Ensure both microphone and receiver are turned on.</li><li>◦ Re-pair by turning both off and on again.</li><li>◦ Check receiver connection to the audio device's MIC input.</li><li>◦ Increase volume on the audio device.</li><li>◦ Charge the microphone battery.</li></ul>
Sound is intermittent or distorted.	<ul style="list-style-type: none"><li>◦ Interference from other wireless devices.</li><li>◦ Microphone too far from receiver.</li><li>◦ Obstacles between microphone and receiver.</li><li>◦ Low battery on microphone or receiver.</li></ul>	<ul style="list-style-type: none"><li>◦ Move away from other wireless devices (Wi-Fi routers, other UHF devices).</li><li>◦ Reduce distance between microphone and receiver.</li><li>◦ Ensure clear line of sight.</li><li>◦ Charge batteries.</li></ul>
Receiver not charging.	<ul style="list-style-type: none"><li>◦ Faulty charging cable or adapter.</li><li>◦ Charging port obstruction.</li></ul>	<ul style="list-style-type: none"><li>◦ Try a different USB charging cable and power adapter.</li><li>◦ Check charging port for debris.</li></ul>

## SPECIFICATIONS

Feature	Detail
Model Number	JYX-U30
Connectivity Technology	UHF
Operating Range	Up to 100 feet (line of sight)
Microphone Form Factor	Handheld
Polar Pattern	Unidirectional
Frequency Response	16 KHz
Signal-to-Noise Ratio	70 dB
Audio Sensitivity	95 dB
Power Source	Battery Powered

Feature	Detail
Battery Type	Lithium Metal (included)
Receiver Charging Time	Approx. 3-5 hours
Receiver Operating Time	Approx. 8-10 hours
Connector Type	6.35 mm Jack (with 3.5mm adapter)
Compatible Devices	Speaker, Karaoke Machine, Amplifier, Mixer
Item Weight	1.41 pounds (total package)
Package Dimensions	10.55 x 4.45 x 2.95 inches
UPC	797439631607

## WARRANTY AND SUPPORT

For warranty information and technical support, please refer to the official JYX website or contact their customer service directly. Keep your purchase receipt as proof of purchase for any warranty claims.

You can also find additional resources and a PDF version of the user manual at: [JYX Wireless Microphone User Manual \(PDF\)](#)

