

## Altec Lansing IMW1500-SJR

# Altec Lansing HydraShock Bluetooth Speaker

Model: IMW1500-SJR

### INTRODUCTION

The Altec Lansing HydraShock Bluetooth Speaker is designed to deliver powerful, room-filling audio with exceptional durability. Featuring an EverythingProof design, it is waterproof, snowproof, dirtproof, and floats, making it ideal for various environments. This manual provides essential information for setting up, operating, maintaining, and troubleshooting your speaker to ensure optimal performance.



Figure 1: Altec Lansing HydraShock Speaker with wireless charging capability.

## PACKAGE CONTENTS

Please ensure all items are present in the package:

- Altec Lansing HydraShock Bluetooth Speaker
- USB-C Charging Cable
- Built-in Strap

## KEY FEATURES

The HydraShock speaker is equipped with advanced features for a superior audio experience and robust performance:

### Audio Performance

- **Deep and Powerful Sound:** Utilizes 4 drivers (2-inch), a 2.5-inch woofer, and a passive radiator for rich, clear audio with strong bass.
- **Stereo Audio Output:** Delivers a stereo sound experience.

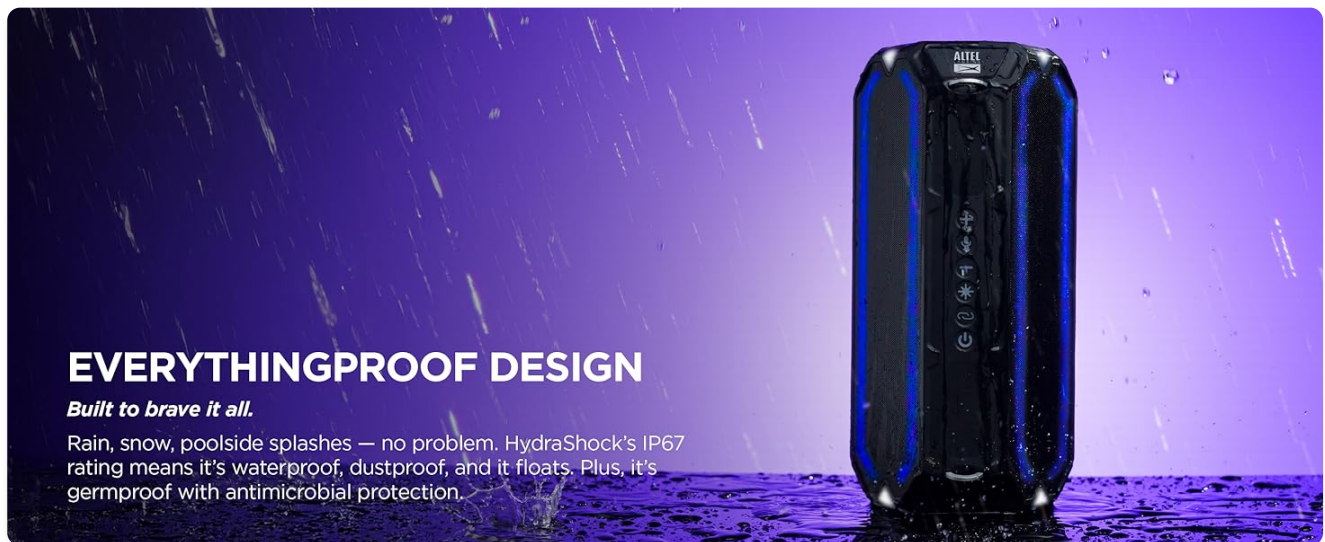

Figure 2: Internal components and key specifications of the HydraShock speaker.

## Durability and Design

- **EverythingProof Design:** IP67 rated, making it waterproof, snowproof, and dirtproof. It also floats, ensuring it's suitable for various outdoor activities.
- **Portable:** Features a built-in strap and compact size for easy transport.





Figure 3: The HydraShock speaker's ability to float, demonstrating its waterproof design.

## Connectivity and Power

- **Bluetooth Connectivity:** Compatible with Android and iOS smartphones, laptops, PCs, tablets, and other Bluetooth-enabled devices.
- **Extended Playtime:** Provides up to 20 hours of audio playback on a single charge.
- **Quick and Safe Charging:** Equipped with a USB-C charging port for efficient speaker charging.
- **Wireless Phone Charger:** Features a Qi-enabled wireless charging pad on top to charge compatible smartphones.
- **Bluetooth Range:** Operates effectively up to 100 feet from the connected device.



Figure 4: Wireless and wired charging capabilities of the speaker.

## Lighting

- **LED Light Modes:** Features 11 distinct LED light modes that can pulse and beat to the rhythm of your music.



Figure 5: The speaker's dynamic LED light show.

## SETUP GUIDE

### Charging the Speaker

1. Connect the provided USB-C charging cable to the speaker's USB-C port.
2. Plug the other end of the cable into a compatible USB power adapter (not included) or a computer's USB port.
3. Allow the speaker to fully charge before first use. The charging indicator light will show charging status.

### Bluetooth Pairing

1. Power on the HydraShock speaker by pressing and holding the power button until the indicator light illuminates.
2. The speaker will automatically enter Bluetooth pairing mode, indicated by a flashing blue light.
3. On your smartphone or Bluetooth-enabled device, navigate to the Bluetooth settings.
4. Select "Altec Lansing HydraShock" from the list of available devices.
5. Once connected, the indicator light will turn solid blue, and you will hear an audible confirmation.

### Wireless Phone Charging

To charge your Qi-enabled smartphone wirelessly:

1. Ensure the HydraShock speaker is powered on.
2. Place your Qi-enabled smartphone directly on the designated wireless charging pad located on the top surface of the speaker.
3. The phone should begin charging automatically. Adjust placement if charging does not initiate.

## OPERATING INSTRUCTIONS

Power On/Off

- **Power On:** Press and hold the power button (U) for approximately 3 seconds.
- **Power Off:** Press and hold the power button (U) for approximately 3 seconds.

Volume Control

- **Increase Volume:** Press the '+' button.
- **Decrease Volume:** Press the '-' button.

Controlling LED Light Modes

- Press the light mode button (\*) to cycle through the 11 available LED light modes.
- Some modes will react to the music playback.

True Wireless Pairing (TWS)

To pair two HydraShock speakers for a true wireless stereo experience:

1. Ensure both HydraShock speakers are powered on and not connected to any Bluetooth device.
2. On one speaker, press and hold the Bluetooth pairing button (↻) for a few seconds until you hear a pairing tone.
3. Repeat the process on the second speaker.
4. The speakers will automatically connect to each other. Once connected, they will function as a stereo pair.
5. Connect your device to one of the paired speakers via Bluetooth as described in the Bluetooth Pairing section.

Your browser does not support the video tag.

Video 1: Official overview of the Altec Lansing HydraShock Waterproof Bluetooth Speaker, highlighting its features and durability.

MAINTENANCE AND CARE

Proper care will extend the life of your HydraShock speaker:

- **Cleaning:** Use a soft, damp cloth to clean the speaker's exterior. Avoid harsh chemicals or abrasive cleaners.
- **Water Exposure:** While waterproof, ensure the charging port cover is securely closed before exposing the speaker to water. After exposure to saltwater or chlorinated water, rinse the speaker with fresh water and allow it to air dry completely before charging.
- **Storage:** Store the speaker in a cool, dry place away from direct sunlight and extreme temperatures.

TROUBLESHOOTING

Problem	Possible Solution
Speaker does not power on.	Ensure the speaker is fully charged. Press and hold the power button for 3-5 seconds.

Problem	Possible Solution
Cannot pair via Bluetooth.	Ensure the speaker is in pairing mode (flashing blue light). Turn off and on your device's Bluetooth. Forget the speaker from your device's Bluetooth list and try pairing again. Ensure no other devices are connected to the speaker.
No sound or low volume.	Increase volume on both the speaker and your connected device. Ensure the speaker is properly paired. Check if the audio source is playing.
Wireless charging not working.	Ensure the speaker is powered on. Reposition your phone on the charging pad. Remove any thick phone cases. Verify your phone supports Qi wireless charging.
LED lights not functioning.	Press the light mode button to activate or change modes.

### SPECIFICATIONS

Feature	Detail
Model Name	HydraShock
Model Number	IMW1500-SJR
Speaker Type	Portable Bluetooth Speaker
Audio Drivers	4 x 2-inch drivers, 1 x 2.5-inch woofer, Passive Radiator
Connectivity	Bluetooth, USB
Wireless Charging	Qi-enabled
Battery Life	Up to 20 hours
Water Resistance	IP67 (Waterproof, Snowproof, Dirtproof, Floats)
Bluetooth Range	100 feet
LED Light Modes	11 modes
Dimensions	16.54 x 8.54 x 7.56 inches (Package)
Weight	7.74 pounds
Material	Plastic or Rubber

## WARRANTY AND SUPPORT

The Altec Lansing HydraShock Bluetooth Speaker comes with a limited warranty. For detailed warranty information, product support, or service inquiries, please refer to the official Altec Lansing website or contact their customer service directly.

**Online Support:** Visit [www.alteclansing.com](http://www.alteclansing.com) for FAQs, product registration, and support resources.

© 2024 Altec Lansing. All rights reserved.

### Related Documents - IMW1500-SJR

	<p><a href="#">Altec Lansing HydraShock IMW1500 Wireless Speaker Quick Start Guide</a></p> <p>A quick start guide for the Altec Lansing HydraShock IMW1500 Everythingproof Wireless Speaker, covering setup, features, and troubleshooting.</p>
--	---





### [Altec Lansing HydraShock IMW1500 Everythingproof Wireless Speaker Quick Start Guide](#)

Get started with your Altec Lansing HydraShock IMW1500 Everythingproof Wireless Speaker. This quick start guide provides essential information on setup, Bluetooth pairing, speaker controls, True Wireless Stereo (TWS) functionality, and customizable light modes.



### [Altec Lansing TOUGHBOXX Rugged Wireless Speaker IMT1030 Quick Start Guide and Manual](#)

Comprehensive guide for the Altec Lansing TOUGHBOXX Rugged Wireless Speaker (IMT1030), covering setup, features, Bluetooth pairing, TWS/Party Sync, FM radio, charging, safety, specifications, and warranty information.



### [Altec Lansing ATP3 Computer Speaker System User Guide and Setup](#)

Comprehensive user guide for the Altec Lansing ATP3 computer speaker system, covering specifications, setup instructions, safety precautions, and control usage.

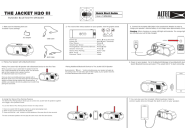

### [Altec Lansing Jacket H2O III Rugged Bluetooth Speaker Quick Start Guide and Warranty](#)

Quick start guide and warranty information for the Altec Lansing Jacket H2O III rugged Bluetooth speaker. Learn about setup, pairing, features like waterproofing and stereo pairing, and understand the one-year limited warranty terms.



### [Altec Lansing Boom Jacket II Rugged Bluetooth Speaker Quick Start Guide](#)

Quick start guide for the Altec Lansing Boom Jacket II rugged Bluetooth speaker, covering setup, pairing, features, charging, warranty, and support information.

