

Formuler Z10

Formuler Z10 Android 10 4K Streaming Media Player User Manual

Model: Z10

1. INTRODUCTION

This manual provides detailed instructions for the setup, operation, and maintenance of your Formuler Z10 Android 10 4K Streaming Media Player. Please read this manual thoroughly before using the device to ensure proper functionality and to maximize your user experience. The Formuler Z10 is designed to deliver high-quality 4K streaming content with its Android 10 operating system, 2GB RAM, and 8GB ROM.

2. WHAT'S INCLUDED

Carefully unpack your Formuler Z10 package and ensure all items listed below are present:

- Formuler Z10 Streaming Media Player
- IR Remote Control
- HDMI Cable
- Power Cable
- Extra 7 Colours Wireless Keyboard
- Extra Magnetic Car Mount



Figure 2.1: Overview of the Formuler Z10 package contents, including the main unit, remote, wireless keyboard, and magnetic car mount.

3. PRODUCT OVERVIEW

3.1. Formuler Z10 Device



Figure 3.1: Front view of the Formuler Z10 streaming media player, showcasing its compact design.

3.2. Ports and Connections

The Formuler Z10 features various ports for connectivity. Familiarize yourself with these ports before setup.



Figure 3.2: Rear panel of the Formuler Z10, illustrating the power input (12V/1A), USB 3.0 port, LAN port, HDMI output, and Reset button.

- **Power Input (12V/1A):** Connect the provided power adapter here.
- **USB 3.0:** For connecting external storage devices or peripherals.
- **LAN:** For wired internet connection via Ethernet cable.
- **HDMI:** Connect to your TV or display for video and audio output.
- **Reset:** Small button for factory reset (use with caution).

4. SETUP

Follow these steps to set up your Formuler Z10 streaming media player:

1. **Connect to TV:** Connect one end of the HDMI cable to the HDMI port on the Formuler Z10 and the other end to an available HDMI input on your television.
2. **Connect to Power:** Plug the power adapter into the Power Input port on the Formuler Z10, then plug the adapter into a wall outlet.
3. **Connect to Network (Optional):** For a wired internet connection, connect an Ethernet cable from your router to the LAN port on the Formuler Z10. For wireless connection, you will configure Wi-Fi during the initial setup process.
4. **Power On:** Turn on your television and select the correct HDMI input source. The Formuler Z10 should automatically power on and display the boot-up screen.
5. **Initial Setup Wizard:** Follow the on-screen instructions to complete the initial setup, including language selection, network configuration (if using Wi-Fi), and Google account login.

5. OPERATING INSTRUCTIONS

5.1. IR Remote Control

The included IR Remote Control allows you to navigate the Formuler Z10 interface and control playback. Ensure the remote has batteries installed and is pointed towards the device.



Powered by
androidtv

FORMULER

IR1

Premium Learning IR Remote With TV Control

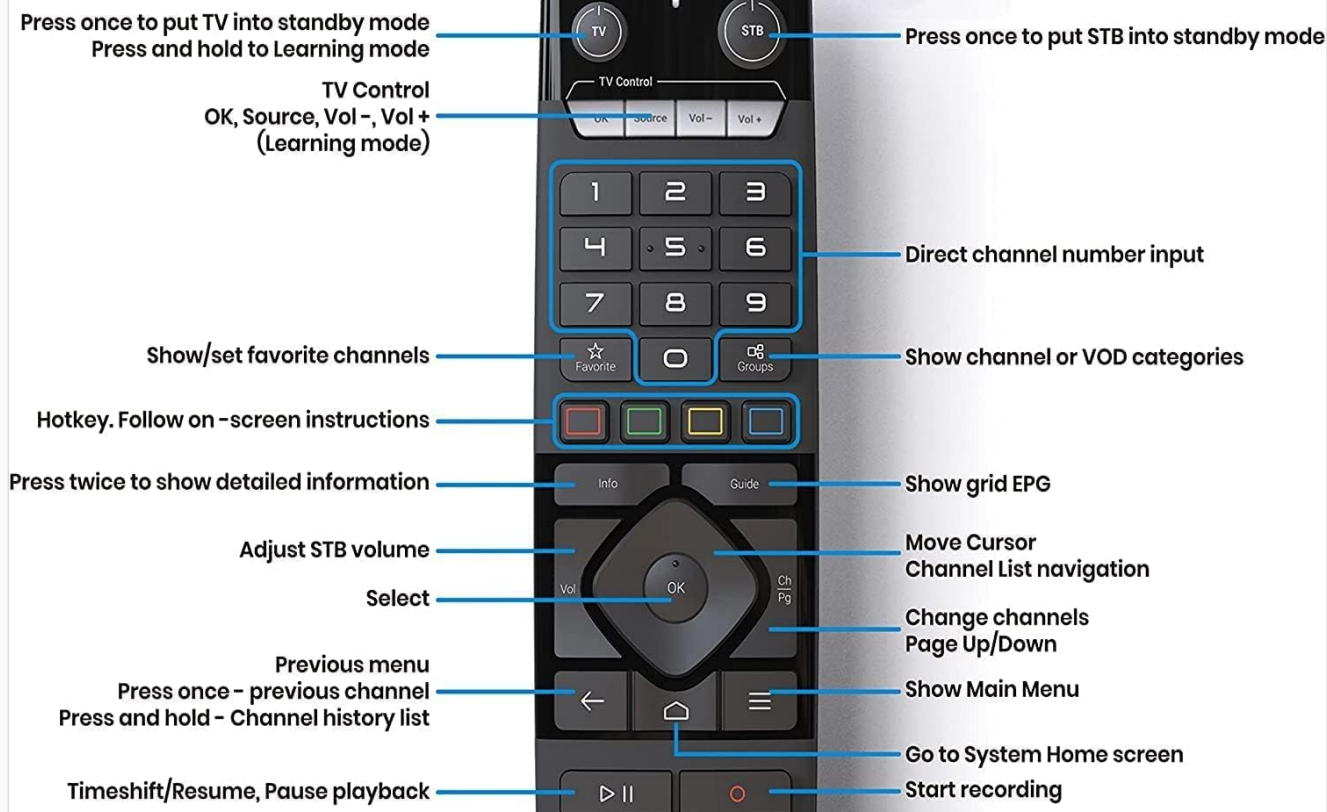

Figure 5.1: Formuler IR1 Premium Learning Remote Control with key functions. This remote can be programmed to control your TV.

- **Power (TV/STB):** Press once to put TV/STB into standby mode. Press and hold for Learning mode (TV control).
- **TV Control (OK, Source, Vol-, Vol+):** Controls basic TV functions after learning.
- **Number Pad (0-9):** Direct channel number input.
- **Favorite / Groups:** Show/set favorite channels; show channel or VOD categories.
- **Color Buttons (Red, Green, Yellow, Blue):** Hotkey functions, follow on-screen instructions.
- **Info:** Press twice to show detailed information.
- **Guide:** Show grid EPG (Electronic Program Guide).
- **Navigation Pad (Up, Down, Left, Right, OK):** Move cursor, channel list navigation, select items.
- **Vol +/-:** Adjust STB volume.
- **CH +/-:** Change channels, Page Up/Down.
- **Back (Left Arrow):** Previous menu.
- **Menu (Three Lines):** Show Main Menu.
- **Home (House Icon):** Go to System Home screen.
- **Play/Pause, Stop, Rewind, Fast Forward:** Media playback controls.
- **Record (Red Dot):** Start recording.

5.2. Wireless Keyboard

The included 7-color wireless keyboard enhances text input and navigation. It connects via a USB dongle.



Extra 7 Colours Wireless Keyboard

Figure 5.2: The 7-color wireless mini keyboard, including its USB receiver and packaging.

1. **Connect Dongle:** Insert the USB dongle from the keyboard package into the USB 3.0 port on the Formuler Z10.
2. **Power On Keyboard:** Turn on the wireless keyboard using its power switch (usually located on the side or back).
3. **Usage:** The keyboard should automatically connect. Use it for typing, navigating with the touchpad, and accessing various functions. Refer to the keyboard's specific manual for advanced features like changing backlight colors.

5.3. Magnetic Car Mount

The magnetic car mount is an accessory for securing devices in a vehicle. It is not directly related to the operation of the Formuler Z10 but is included in the package.



Extra Magnetic Phone Car Mount

Figure 5.3: The magnetic car mount, designed for securing compatible devices in a vehicle.

To use the magnetic car mount, attach it to a suitable surface in your car (e.g., an air vent). Ensure your device has a metal plate or is in a case with a metal plate for magnetic attachment. Follow the instructions provided with the car mount for safe and secure installation.

6. MAINTENANCE

Proper maintenance ensures the longevity and optimal performance of your Formuler Z10:

- **Cleaning:** Use a soft, dry cloth to clean the device. Avoid liquid cleaners or abrasive materials.
- **Ventilation:** Ensure the device is placed in a well-ventilated area to prevent overheating. Do not block ventilation openings.
- **Software Updates:** Regularly check for and install system updates to ensure you have the latest features and security patches. These can usually be found in the device's settings menu.
- **Storage:** When not in use for extended periods, store the device in a cool, dry place away from direct sunlight.

7. TROUBLESHOOTING

If you encounter issues with your Formuler Z10, refer to the following common problems and solutions:

- **No Power:**
 - Ensure the power cable is securely connected to the device and the power outlet.
 - Verify the power outlet is functional.
- **No Picture/Signal on TV:**
 - Check that the HDMI cable is securely connected to both the Formuler Z10 and the TV.
 - Ensure your TV is set to the correct HDMI input source.
 - Try a different HDMI cable or TV port.
- **Remote Control Not Responding:**
 - Replace the batteries in the remote control.
 - Ensure there are no obstructions between the remote and the device's IR receiver.
- **No Internet Connection:**
 - **Wired:** Check the Ethernet cable connection to both the device and the router. Verify your router is working.
 - **Wireless:** Go to Settings > Network > Wi-Fi and ensure Wi-Fi is enabled and connected to the correct network. Re-enter the Wi-Fi password if necessary.
 - Restart your router and the Formuler Z10.

• **Device Freezes or Slows Down:**

- Restart the device by unplugging and replugging the power cable.
- Close unused applications running in the background.
- Consider performing a factory reset if issues persist (this will erase all data and settings).

8. SPECIFICATIONS

Key technical specifications for the Formuler Z10:

Feature	Specification
Output Resolution	4K (3840 x 2160)
RAM	2GB DDR @2400MHz
Storage	8GB eMMC
Operating System	Android 10
Wireless Connectivity	Dual-Band 2x2 AC Wireless (5G)
Bluetooth	5.0
Ethernet	100M
Dimensions (L x W x T)	94mm x 94mm x 16mm (approx. 3.7 x 3.7 x 0.63 inches)
Color	Black
Ports	1x Power Input, 1x USB 3.0, 1x HDMI, 1x LAN

9. WARRANTY AND SUPPORT

For warranty information and technical support, please refer to the documentation provided with your purchase or visit the official Formuler website. Keep your proof of purchase for warranty claims.

