



[Manuals.plus](#) /

› [Shuisen](#) /

› Sand Filter Replacement Parts Compatible with Intex Krystal Clear Sand Filter Pump for Above Ground Pools, Pool Filter Pump Gaskets Replacement for Intex 25013 O Rings, 1 Pack(12 Pieces)

Shuisen Intex 25013

Product Instruction Manual

Sand Filter Replacement Parts for Intex Krystal Clear Sand Filter Pumps

1. PRODUCT OVERVIEW

This manual provides essential information for the installation, maintenance, and troubleshooting of your Shuisen Sand Filter Replacement Parts. These parts are designed to restore the optimal performance of your Intex Krystal Clear Sand Filter Pump system.



Image 1.1: Complete set of Shuisen replacement O-rings and air release valve.

The replacement parts are manufactured from durable, premium materials to ensure longevity and consistent performance, helping to maintain a safe and operational pool filtering system.

2. COMPATIBILITY

These replacement O-rings and the air release valve are specifically designed for compatibility with Intex Krystal Clear Sand Filter Pump systems for above-ground pools. They serve as direct replacements for Intex part number 25013.

Compatible sand filter pump models include, but are not limited to:

- 26641EG, 26643EG, 26645EG, 26647EG, 26651EG
- 26675EG, 26679EG
- 28601EG, 28603EG, 28633EG, 28635EG, 28637EG
- 28643EG, 28645EG, 28647EG, 28651EG
- 28673EG, 28675EG, 28679EG

Compatible with most Intex Sand Filter Pump Systems



Image 2.1: Examples of Intex Sand Filter Pump Systems compatible with these replacement parts.

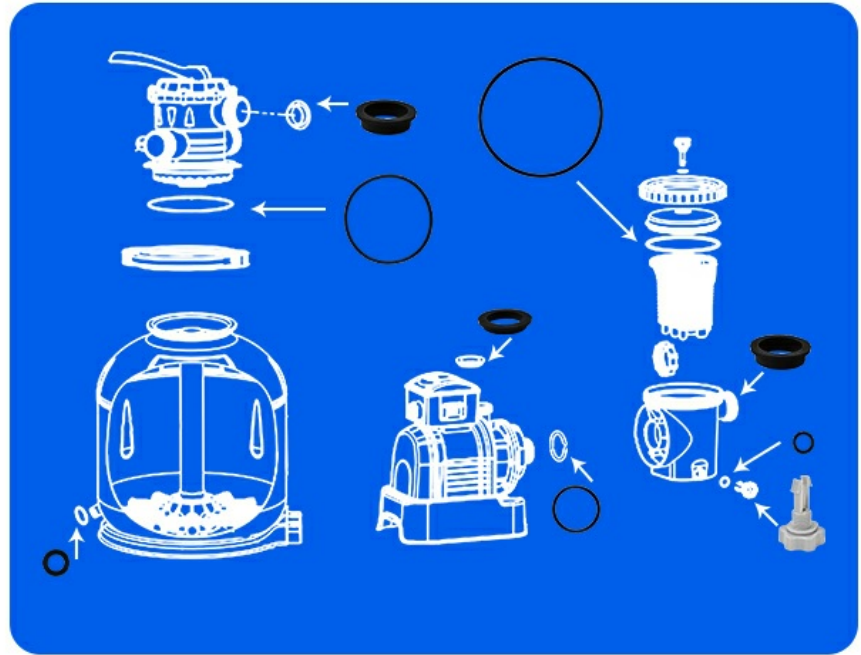

Compatibility

The pool filter pump part compatible with Intex Sand Filter Pump Systems.
The sand filter o ring parts repair set replacement for Intex part number 25013

Image 2.2: Component diagrams illustrating where various O-rings are installed within the pump system.

3. PACKAGE CONTENTS

This repair set includes a total of 12 pieces, comprising one air release valve and 11 different O-ring replacement parts. The specific components and their Intex part numbers are listed below:

- 1 x Air Release Valve (Part #10460)
- 1 x Tank O-ring (Part #11379)
- 1 x Drain Valve O-ring (Part #10264)
- 1 x Drain Valve O-ring (Part #11385)
- 4 x Large L-shaped O-rings (Part #11228)
- 1 x Small L-shaped O-ring (Part #11412)
- 1 x Tank O-ring for 12-inch sand filter pumps and combo (Part #11824)
- 1 x Tank O-ring for 14/16-inch sand filter pumps and combo (Part #11232)
- 1 x Drain Valve O-ring (Part #11457)

Product size:

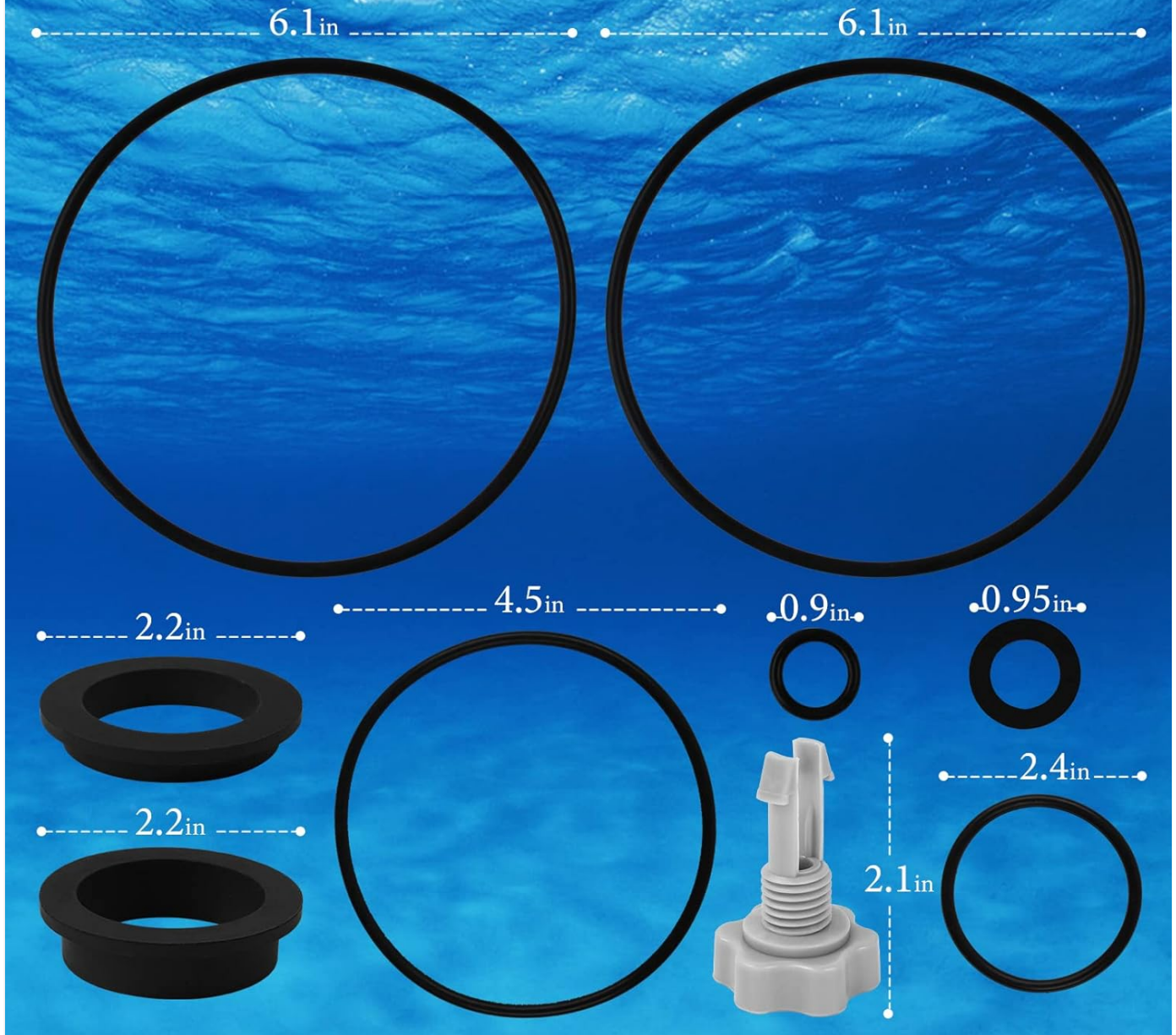

Image 3.1: Product size overview, showing dimensions of various O-rings and the air release valve.

Includes a vent valve (10406)

**1×10460: Diameter: 6.1 cm / 2.4 inches
Height: 5.5 cm / 2.2 inches**



Image 3.2: Detailed view of the air release valve (Part #10460).

Includes two L-shaped O-rings:

1×11412

Diameter:
5.5cm / 2.2 inches

Height:
1 cm / 0.4 inches

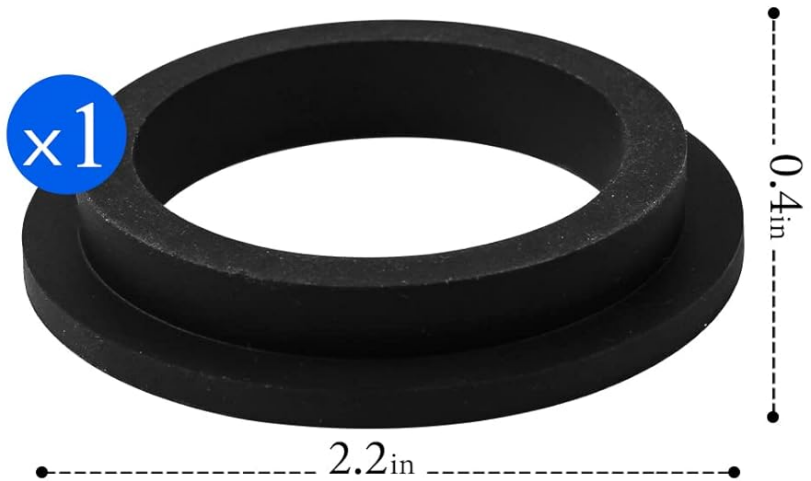

4×11228

Diameter:
5.5cm / 2.2 inches
Height:
1.5 cm / 0.56 inches



Image 3.3: Detailed view of the L-shaped O-rings (Parts #11412 and #11228).

4. INSTALLATION AND SETUP

Replacing worn or damaged O-rings and the air release valve is crucial for maintaining the efficiency and preventing leaks in your sand filter pump system. Follow these general steps for installation:

1. **Safety First:** Always disconnect the sand filter pump from its power source before beginning any maintenance or installation.
2. **Drain the System:** Ensure the pump and filter tank are drained of water.
3. **Identify Worn Parts:** Locate the O-rings and air release valve that require replacement. Refer to your specific Intex sand filter pump manual for detailed diagrams of component locations.
4. **Remove Old Parts:** Carefully remove the old, damaged, or brittle O-rings and the air release valve.
5. **Clean Surfaces:** Clean the grooves and surfaces where the new O-rings will be seated to ensure a proper seal.
6. **Install New Parts:** Gently install the new Shuisen replacement O-rings and the air release valve into their respective positions. Ensure they are seated correctly and not twisted or pinched.
7. **Reassemble:** Reassemble the pump components according to your pump's manual.
8. **Test for Leaks:** Once reassembled, reconnect the pump to power and observe for any leaks during operation.

Proper installation of these replacement parts will help return your filtering system to peak performance, preventing water loss and maintaining optimal filtration.

5. MAINTENANCE

Regular inspection and timely replacement of O-rings are key to the longevity and efficient operation of your sand filter pump. The Shuisen replacement parts are made from high-quality materials designed for durability.

- **Periodic Inspection:** Routinely check all visible O-rings for signs of wear, cracking, drying, or deformation.
- **Lubrication:** Apply a thin layer of silicone-based lubricant (pool-safe) to O-rings during installation or reassembly to prolong their life and improve sealing.
- **Storage:** If disassembling the pump for off-season storage, clean and dry all O-rings before storing them in a cool, dry place away from direct sunlight.

Made from Heavy Duty Premium Materials for Durability and Performance.

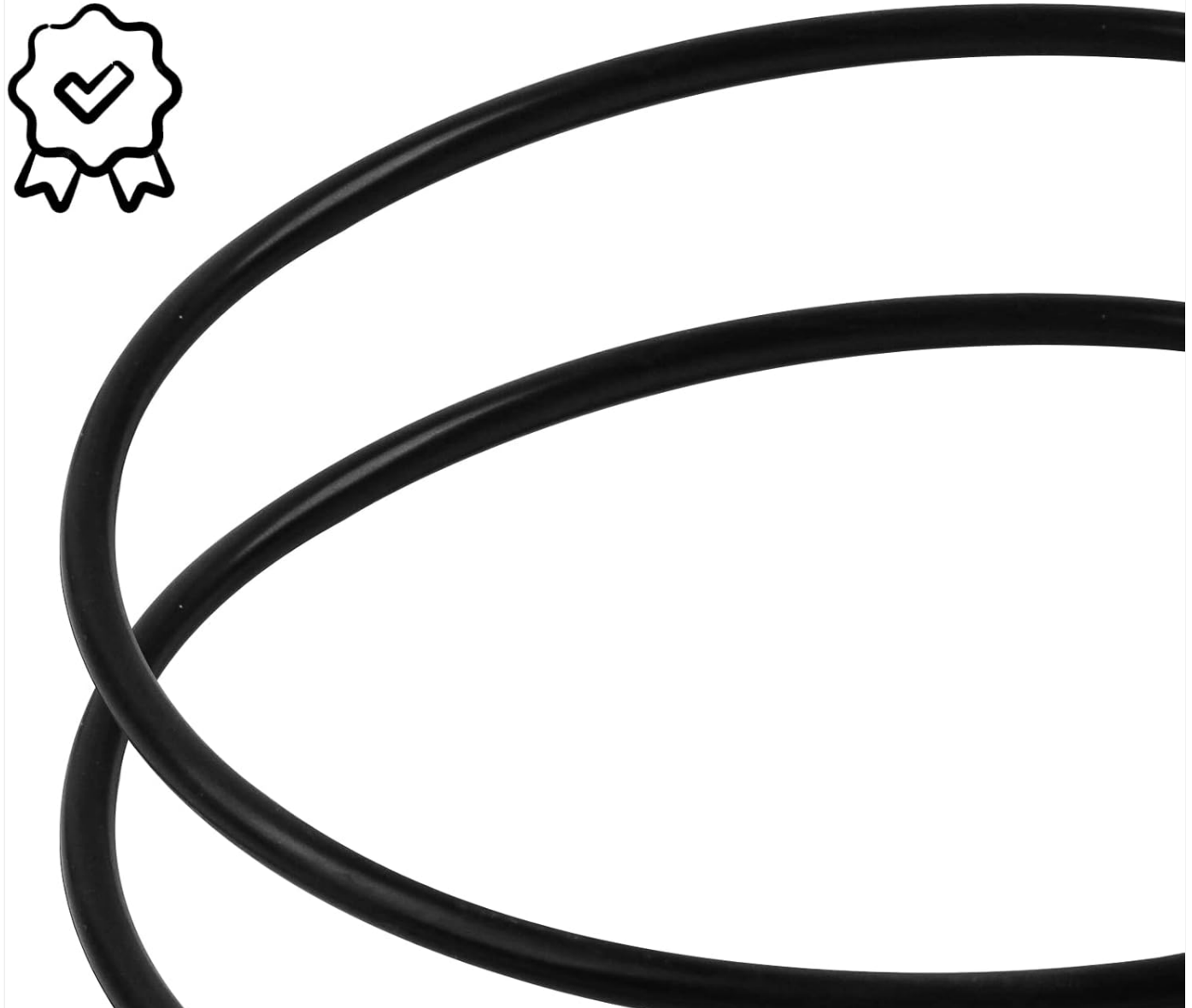

Image 5.1: High-quality material of the replacement O-rings, designed for durability.

**Replacing O-rings can return
your filtering system back to
peak performance.**



Image 5.2: A properly functioning filter system ensures a clean and enjoyable pool environment.

6. TROUBLESHOOTING

If you encounter issues after replacing the O-rings or air release valve, consider the following common troubleshooting steps:

- **Leaks:**

- Ensure all O-rings are correctly seated in their grooves and are not twisted or pinched.
- Verify that all connections are tightened securely.
- Inspect the O-rings for any damage that might have occurred during installation.

- **Air in System:**

- Confirm the air release valve is properly installed and functioning.
- Check all connections for air leaks, especially on the suction side of the pump.

- **Reduced Flow:**

- While O-rings primarily affect sealing, ensure no debris is obstructing the pump or filter pathways.

For persistent issues, refer to your Intex sand filter pump's original manual or contact customer support.

7. SPECIFICATIONS

Attribute	Detail
Product Type	Sand Filter Pump Gaskets and Air Release Valve Replacement Kit
Compatibility	Intex Krystal Clear Sand Filter Pump Systems (Replaces Intex Part #25013)
Package Contents	1 Air Release Valve (10460), 1 Tank O-ring (11379), 1 Drain Valve O-ring (10264), 1 Drain Valve O-ring (11385), 4 Large L-shaped O-rings (11228), 1 Small L-shaped O-ring (11412), 1 Tank O-ring (11824), 1 Tank O-ring (11232), 1 Drain Valve O-ring (11457)
Material	Heavy Duty Premium Materials
Package Dimensions	6.65 x 5.91 x 1.5 inches
Item Weight	1.6 ounces
Manufacturer	Shuisen
Country of Origin	China

8. WARRANTY AND SUPPORT

For any questions regarding the installation, quantity, quality, or other aspects of the Shuisen sand filter replacement parts, please contact our customer service team. We are committed to providing support and will respond to inquiries within 24 hours.

Please retain your purchase receipt for any warranty claims or support requests.

