



Manuals.plus /

- › **Betife** /
- › Betife F410 Projector User Manual: Native 1080P, 4K Support, WiFi, Bluetooth

Betife F410

Betife F410 Projector User Manual

Native 1080P, 4K Support, WiFi, Bluetooth

1. INTRODUCTION

This manual provides detailed instructions for the setup, operation, and maintenance of your Betife F410 Projector. Please read this manual thoroughly before using the product to ensure proper function and to maximize your viewing experience. Keep this manual for future reference.



Image 1.1: Betife F410 Projector overview, highlighting 4K support, 1080P native resolution, 500 ANSI lumens, and 5G WiFi capabilities.

2. PRODUCT OVERVIEW

2.1 Key Features

- **Native 1080P Resolution:** Delivers clear, high-definition images.
- **4K Video Support:** Compatible with 4K video input for enhanced detail.
- **500 ANSI Lumens Brightness:** Provides a bright display for various environments.
- **12000:1 Contrast Ratio:** Offers deep blacks and bright whites for vivid images.
- **Dual-Band WiFi (5G/2.4G):** Ensures stable and fast wireless connectivity for streaming and screen mirroring.
- **Wireless Screen Mirroring:** Supports iOS, Android, and Windows devices.
- **Bluetooth 5.1:** Bidirectional connectivity for external speakers or using the projector as a Bluetooth speaker.
- **Dual 3W HiFi Stereo Speakers:** Integrated audio for a complete experience.
- **50-100% Zoom Function:** Adjust image size without moving the projector.
- **360° Flip Function:** Supports front, rear, and ceiling projection.

- **Sleep Timer:** Automatic shutdown feature.
- **Wide Compatibility:** HDMI, USB, VGA, AV, and 3.5mm Audio ports.



Image 2.1: Visual representation of the Betife F410 Projector's core functionalities.

2.2 Components

The Betife F410 Projector package typically includes:

- Betife F410 Projector
- Remote Control (requires 2x AAA batteries, not included)
- HDMI Cable
- Power Cable
- User Manual
- Lens Cap
- Cleaning Cloth/Q-tips for lens maintenance

3. SETUP

3.1 Physical Placement

Position the projector on a stable, flat surface. Ensure adequate ventilation around the device. The projection distance affects the image size. For optimal viewing, consider the following:

- **Recommended 100" Screen Size:** Approximately 10.5 feet (3.2 meters) from the screen.
- The projector supports a visible screen diagonal up to 350 inches (889 cm).



Image 3.1: Guide for optimal projector placement and screen size based on distance.

3.2 Power Connection

1. Connect the power cable to the projector's power input port.
2. Plug the other end of the power cable into a standard electrical outlet.

3.3 Input Connections

The projector offers multiple input options:

- **HDMI:** Connect to laptops, PCs, gaming consoles (Xbox, PS5, PS4), TV sticks (Fire TV Stick, Roku), or Chromecast.
- **USB:** For USB drives to play media files directly.
- **VGA:** For older computer connections.
- **AV:** For composite video sources.
- **3.5mm Audio Out:** For connecting external wired speakers or headphones.

Connect your desired source device to the corresponding port on the projector.



Image 3.2: Focus, keystone correction, and flexible placement options for the projector.

4. OPERATING INSTRUCTIONS

4.1 Power On/Off

- **Power On:** Press the power button on the projector or the remote control.
- **Power Off:** Press the power button again. The projector will initiate a shutdown sequence.

4.2 Focus and Keystone Correction

- **Focus Adjustment:** Rotate the focus ring near the lens until the image appears sharp and clear.
- **Keystone Correction:** Use the keystone adjustment dial (typically on the top or side of the projector) to correct trapezoidal distortion, ensuring a rectangular image. The projector supports manual $\pm 15^\circ$ keystone correction.

4.3 Wireless Connectivity (WiFi & Screen Mirroring)

The Betife F410 supports dual-band 5G/2.4G WiFi for stable and fast connections.

4.3.1 iOS Wireless Mirroring

1. On the projector's main menu, select "Screen Mirroring."
2. On your iOS device, go to WiFi settings and connect to the projector's network (e.g., "F410-XXXXXX").
3. Open "Screen Mirroring" or "AirPlay" on your iOS device and select the projector (e.g., "F410-XXXXXX").
4. The connection should be established successfully.

Apple Wireless Mirroring with WiFi for IOS

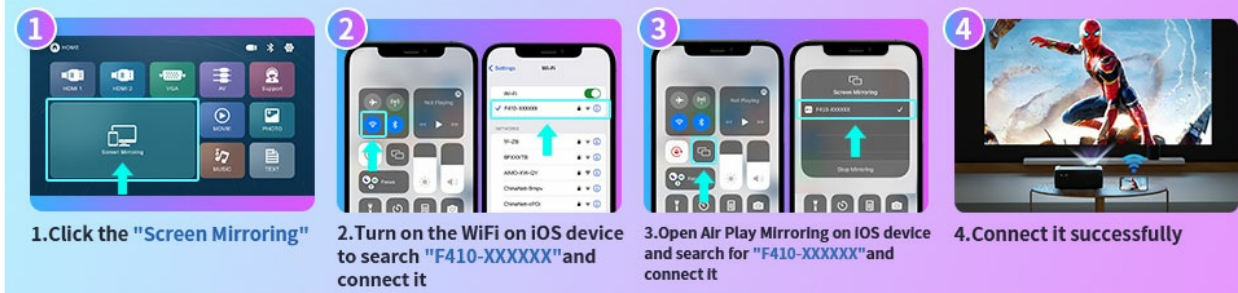

Android Wireless Mirroring with WiFi for Android

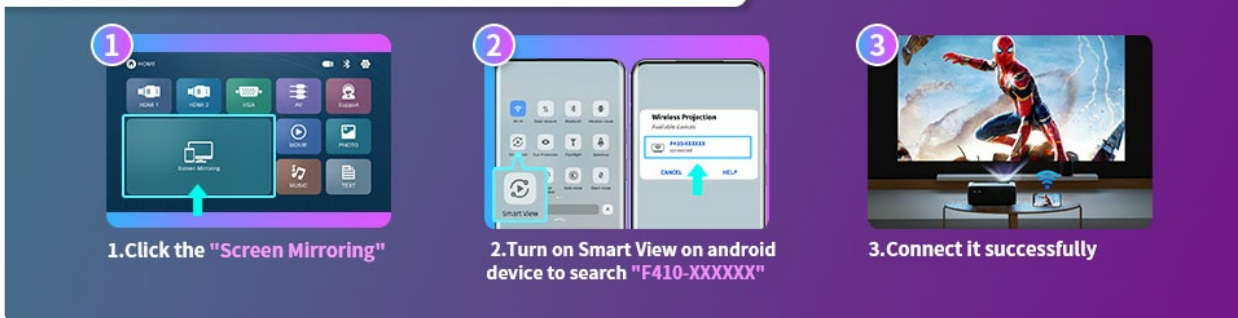

Image 4.1: iOS Wireless Mirroring setup guide.

4.3.2 Android Wireless Mirroring

1. On the projector's main menu, select "Screen Mirroring."
2. On your Android device, enable "Smart View," "Wireless Projection," or a similar screen mirroring feature. Search for the projector's network (e.g., "F410-XXXXXX").
3. Select the projector to connect.

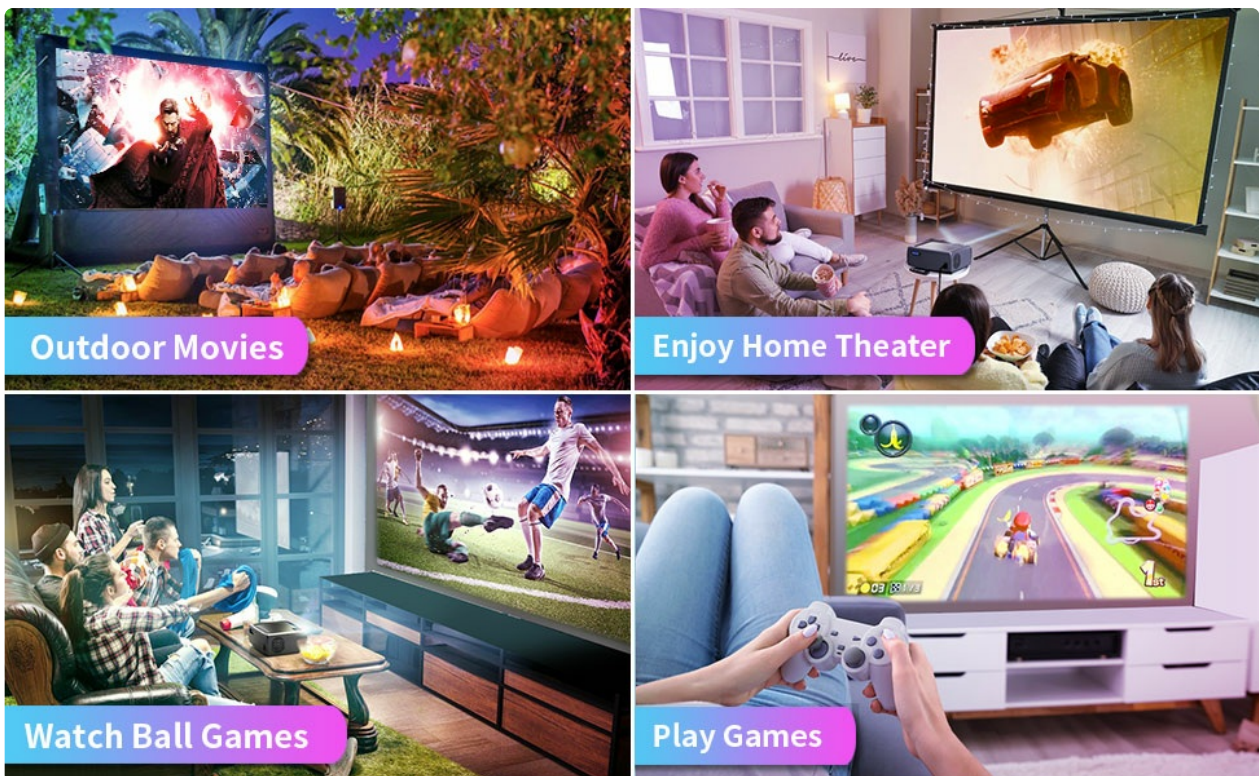

Image 4.2: Android Wireless Mirroring setup guide.

Note: Due to copyright restrictions, streaming services like Netflix, Amazon Prime Video, Disney+, and Hulu do not support screen mirroring directly from mobile devices. To view content from these services, connect an HDMI device such as a Fire TV Stick, Roku, or Chromecast.

4.4 Bluetooth Audio

The projector features Bluetooth 5.1 for audio connectivity.

- **Connecting to External Bluetooth Speakers:** Enable Bluetooth on the projector and your external speaker. Pair the devices from the projector's Bluetooth settings.
- **Using Projector as a Bluetooth Speaker:** The bidirectional Bluetooth allows you to connect your phone to the projector and use its built-in speakers for audio playback.



Image 4.3: The projector's integrated dual HiFi stereo speakers.

4.5 Zoom Function

Adjust the projected image size from 100% down to 50% using the zoom function in the projector's menu, without physically moving the projector.

4.6 360° Flip Function

The projector supports various installation orientations:

- Front Projection
- Rear Projection
- Ceiling Projection (front or rear)

Adjust the projection mode in the settings menu to match your installation.

4.7 Sleep Timer

Set a sleep timer through the projector's menu to automatically power off the device after a specified period.

5. MAINTENANCE

5.1 Cleaning the Lens

Regularly clean the projector lens to maintain image clarity.

- Use a soft, lint-free cloth or the provided cleaning cloth.
- For stubborn smudges, use a lens cleaning solution specifically designed for optical surfaces.
- Avoid abrasive materials or harsh chemicals.

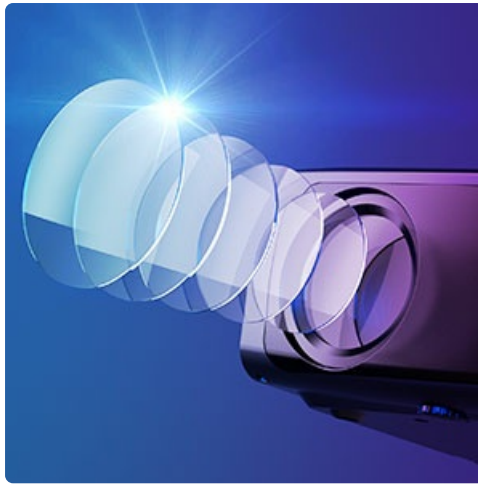

Image 5.1: The projector's precision optical lens.

5.2 General Care

- Keep the projector in a clean, dust-free environment.
- Ensure proper ventilation to prevent overheating. The projector features dual fan cooling.
- When not in use, cover the lens with the provided cap to protect it from dust and scratches.
- Store the projector in a cool, dry place.



Image 5.2: Illustration of the projector's internal cooling fan.

6. TROUBLESHOOTING

If you encounter issues with your Betife F410 Projector, refer to the following common problems and solutions:

Problem	Possible Cause	Solution
No Power	Power cable loose; Power outlet faulty	Check power cable connection; Try a different outlet.
No Image	Input source not selected; Cable connection loose; Source device off	Select correct input source; Check HDMI/VGA/AV cable connections; Ensure source device is powered on.
Blurry Image	Focus not adjusted; Keystone not adjusted	Adjust the focus ring; Adjust the keystone correction dial.
No Sound	Volume too low; Muted; External speaker not connected/paired	Increase volume; Unmute; Connect/pair Bluetooth speaker or wired speaker.
Screen Mirroring Fails	Incorrect WiFi connection; Copyright restrictions	Ensure correct WiFi network is selected; Use an HDMI streaming device for copyrighted content.
Remote Control Not Working	Batteries low/incorrectly inserted; Obstruction	Replace batteries (2x AAA); Ensure no obstruction between remote and projector.

7. SPECIFICATIONS

Feature	Specification
Brand	Betife
Model Number	F410
Display Resolution	Native 1920 x 1080P (4K Supported)
Brightness	500 ANSI Lumens
Contrast Ratio	12000:1
Connectivity Technology	Bluetooth 5.1, Dual-Band WiFi (5G/2.4G), HDMI, USB, VGA, AV
Speaker Type	Dual 3W HiFi Stereo Speakers
Visible Screen Diagonal	Up to 350 inches (889 cm)
Zoom Function	50-100%
Keystone Correction	Manual $\pm 15^\circ$
Product Dimensions	7.51 x 8.7 x 3.58 inches (19.08 x 22.1 x 9.09 cm)
Item Weight	4.29 pounds (1.95 kg)
Date First Available	May 10, 2022

8. WARRANTY AND SUPPORT

For warranty information and technical support, please refer to the contact details provided with your purchase documentation or visit the official Betife website. Keep your proof of purchase for warranty claims.