

## Manuals+

[Q & A](#) | [Deep Search](#) | [Upload](#)

Manuals.plus /

› [Ashwanth](#) /

› Ashwanth 8-Inch Rain Shower Head with Handheld Spray Combo and Adjustable Extension Arm - Instruction Manual

## Ashwanth QY-HST-1

# Ashwanth 8-Inch Rain Shower Head with Handheld Spray Combo and Adjustable Extension Arm

Model: QY-HST-1

## INTRODUCTION

---

Thank you for choosing the Ashwanth 8-Inch Rain Shower Head with Handheld Spray Combo. This manual provides detailed instructions for installation, operation, maintenance, and troubleshooting to ensure optimal performance and longevity of your shower system. Please read this manual thoroughly before installation and retain it for future reference.



Image: The Ashwath 8-inch rain shower head and handheld spray combo installed, with water flowing, demonstrating its dual functionality.

## SAFETY INFORMATION

---

- Always turn off the main water supply before beginning any installation or maintenance.
- Use appropriate tools and avoid overtightening connections to prevent damage to components or plumbing.
- Ensure all connections are sealed properly to prevent leaks.
- Do not use abrasive cleaners or harsh chemicals on the finish, as this may cause damage.

## PACKAGE CONTENTS

---

Please verify that all components are present before beginning installation:

- 8-Inch Square Rain Shower Head (Matt Black)
- Handheld Spray (Matt Black)
- Adjustable Extension Arm (11-inch, Matt Black)
- 3-Way Flow Regulator/Diverter (Matt Black)
- 5-Foot Shower Hose (Matt Black)
- Wall Mount Bracket for Handheld Spray

- Washers and Seals



Image: Detailed view of the solid brass connector, 1/2-inch universal fitting, and the soft silicone nozzles of the shower head.

## SETUP AND INSTALLATION

---

Follow these steps for a quick and easy installation. A wrench tool is recommended for tightening the 3-way connector.

# INSTALLS IN MINUTES

includes everything you need

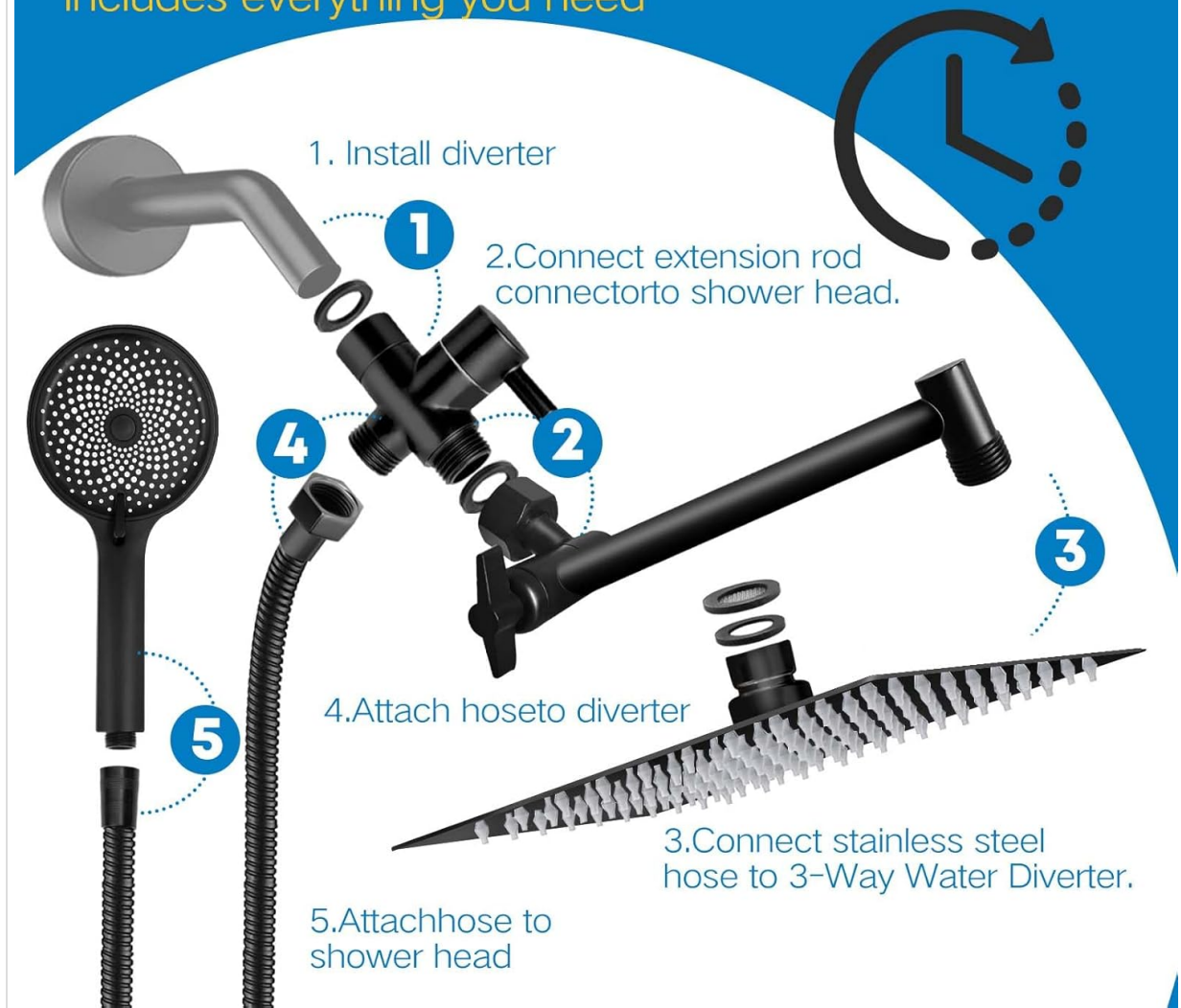

Image: An exploded diagram illustrating the components and their assembly sequence for the shower system.

1. **Prepare the Shower Arm:** Remove your existing shower head. Clean any old sealant or debris from the shower arm threads.
2. **Install the Diverter:** Screw the 3-way water diverter onto the shower arm. Ensure a washer is in place and hand-tighten, then use a wrench to tighten securely.
3. **Attach the Extension Arm:** Connect the adjustable extension arm to the diverter. Ensure a washer is in place and tighten.
4. **Connect Rain Shower Head:** Screw the 8-inch rain shower head onto the extension arm. Ensure a washer is in place and tighten.
5. **Attach Shower Hose to Diverter:** Connect one end of the 5-foot shower hose to the designated outlet on the 3-way diverter. Ensure a washer is in place and tighten.
6. **Connect Handheld Spray:** Attach the handheld spray to the other end of the shower hose. Ensure a washer is in place and tighten.
7. **Mount Handheld Bracket:** Secure the handheld spray wall mount bracket to a desired location on your shower wall.
8. **Test for Leaks:** Turn on the main water supply and check all connections for leaks. If leaks occur, tighten the connections further.

**ASHWANTH**

# Shower Head Combo

## Enjoy the natural SPat home



High Pressure



8" Full Coverage



Self-clean Nozzles



Height & Angle Adjustable



Leak-free



Built-in Flushing Water Mode



Image: A step-by-step visual guide for installing the shower system, from diverter to shower heads and hose connections.

## OPERATING INSTRUCTIONS

### Adjusting Water Flow

The 3-way flow regulator allows you to easily switch between the rain shower head, handheld spray, or a combination of both.

- Turn the knob on the 3-way diverter to select your desired water output.
- Positions typically include: Rain Shower Head Only, Handheld Spray Only, or Both Simultaneously.

# Water Pressure Adjustment

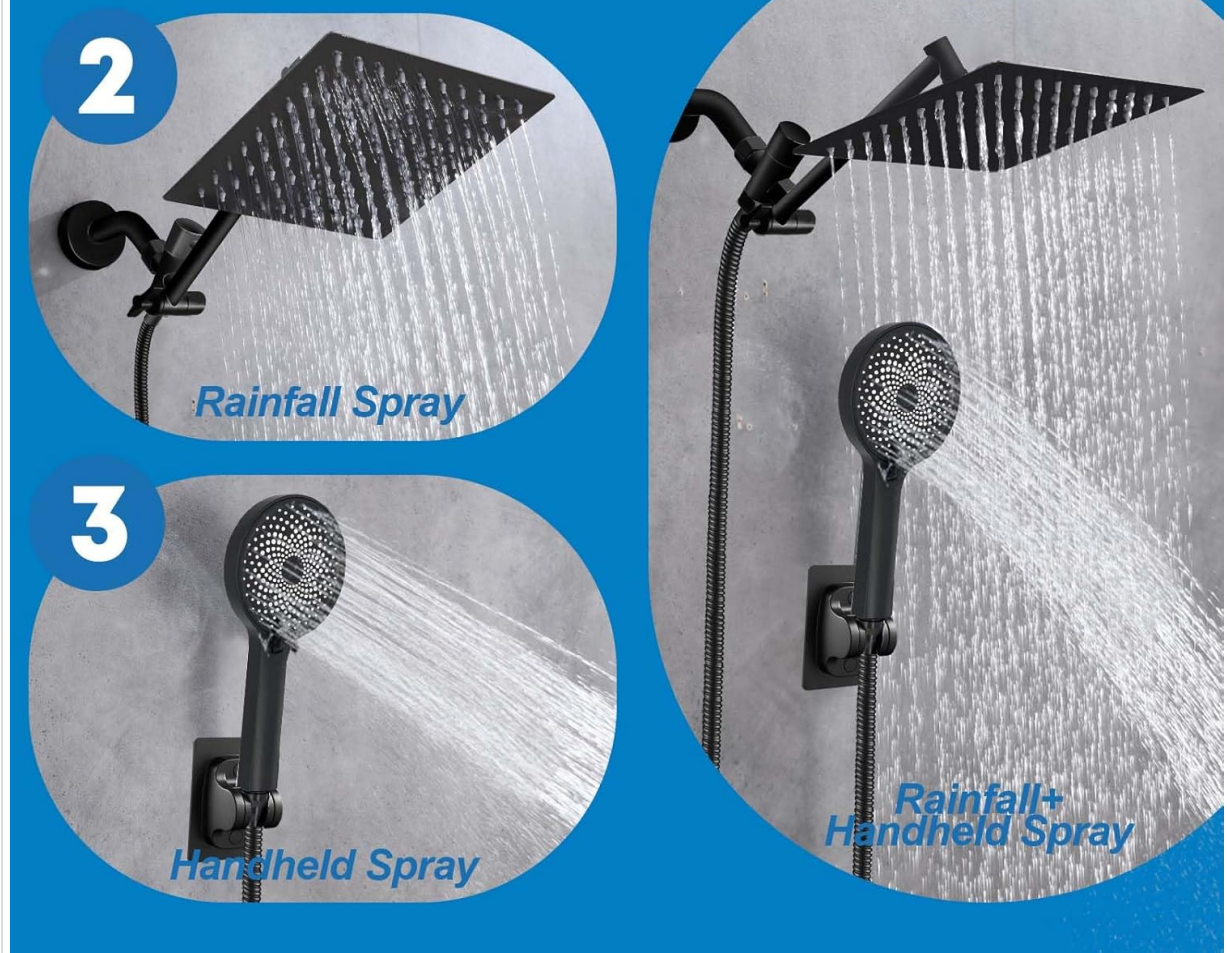

Image: Visual representation of the three available water flow settings: rainfall, handheld, and combined spray.

## Handheld Spray Modes

The handheld spray features multiple spray patterns for varied showering experiences. Rotate the spray face or a selector on the handheld unit to change modes.



Image: A graphic displaying five distinct spray patterns for the handheld shower, including jet, rain, and mixed options.

## Adjusting the Extension Arm

The 11-inch adjustable extension arm allows you to position the rain shower head to your preferred height and angle.

- Loosen the adjustment knobs on the extension arm.
- Adjust the arm to raise or lower the shower head, and pivot it to achieve the desired angle.
- Tighten the adjustment knobs firmly to secure the shower head in place.

# EXTRA DURABLE EXTENSION ARM



Image: A visual guide demonstrating the 180-degree adjustability of the extension arm, enabling users to customize shower head height and angle.

## MAINTENANCE

### Cleaning the Nozzles

The shower heads feature soft silicone nozzles designed for easy cleaning and to prevent mineral buildup.

- Periodically rub the silicone nozzles with your finger or a soft cloth to dislodge any mineral deposits.
- This helps maintain consistent water flow and prevents clogging.

### General Cleaning

- Clean the shower system regularly with a soft cloth and mild soap and water.
- Rinse thoroughly and dry with a soft cloth to prevent water spots.
- Avoid using abrasive cleaners, ammonia-based products, or harsh chemicals, as these can damage the Matt Black finish.

## TROUBLESHOOTING

Problem	Possible Cause	Solution
Low Water Pressure	Clogged nozzles; water restrictor; low household water pressure.	Clean nozzles by rubbing them. Check if a water restrictor is installed (if applicable, consult local regulations for removal). Verify household water pressure.
Leaks at Connections	Loose connections; missing or damaged washers.	Ensure all connections are tightened securely. Check that all washers are properly seated and undamaged. Replace if necessary.
Diverter Not Switching Properly	Internal debris; worn mechanism.	Flush the system by running water through all outlets. If the issue persists, contact customer support.

If you encounter any issues not listed here or require further assistance, please do not hesitate to reach out to us via Amazon. We are here to assist you.

## SPECIFICATIONS

---

- **Brand:** Ashwanth
- **Model:** QY-HST-1
- **Shower Head Size:** 8 Inch (Square Rain Shower)
- **Material:** Stainless Steel (Shower Head), Brass (Extension Arm, Handle)
- **Finish Type:** Matt Black
- **Installation Type:** Wall Mounted
- **Hose Length:** 5 Feet
- **Number of Handheld Spray Settings:** 5
- **Product Dimensions:** 59"L x 8"W (Overall system length and shower head width)
- **Item Weight:** 2.99 pounds
- **UPC:** 732781217147

# RECTANGULAR SHOWER HEAD PROVIDES FULL BODY COVERAGE

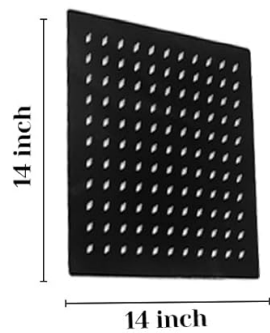

**14 inch**

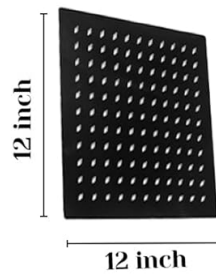

**12 inch**

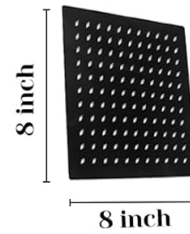

**8 inch**

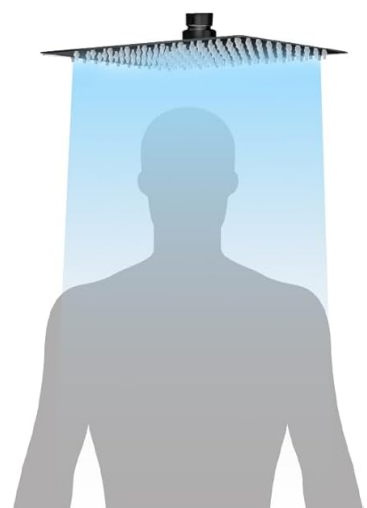
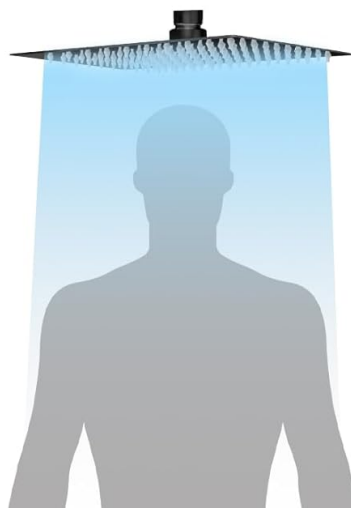
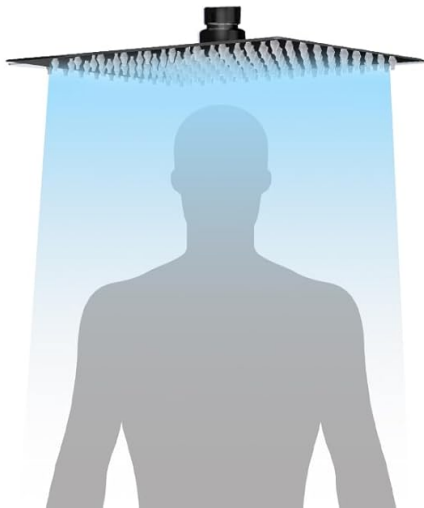

Image: A comparison of different rectangular shower head sizes, illustrating how an 8-inch head provides ample body coverage.

## WARRANTY AND SUPPORT

For any questions, concerns, or warranty claims regarding your Ashwanth shower system, please contact the seller directly through your Amazon order page. Our customer service team is dedicated to providing prompt and helpful support.