

## Kwikset Pismo 99910-070

# Kwikset Pismo 991 Keyed Entry Knob and Single Cylinder Deadbolt Combo Pack User Manual

Model: Pismo 99910-070

## 1. PRODUCT OVERVIEW

The Kwikset Pismo 991 Keyed Entry Knob and Single Cylinder Deadbolt Combo Pack offers a modern design with robust security features. This combo pack is suitable for exterior-facing doors or interior rooms requiring key access for enhanced privacy and security. It features a matte black finish and incorporates Kwikset's SmartKey Security technology for easy re-keying and Microban antimicrobial protection for a cleaner surface.



Image: Kwikset Pismo 991 Keyed Entry Knob and Single Cylinder Deadbolt Combo Pack, showcasing the matte black finish on a wooden door.



Image: Exterior view of the Kwikset Pismo 991 Keyed Entry Knob and Single Cylinder Deadbolt Combo Pack installed on a door, showing the sleek design from the outside.

---

## 2. INSTALLATION

The Kwikset Pismo 991 combo pack is designed for easy DIY installation with minimal tools. A screwdriver is typically the only tool required.

### 2.1. Door Preparation

Ensure your door meets the standard specifications for installation. This lock fits standard doors 1-3/8" to 1-3/4" thick. The latch backset is adjustable to either 2-3/8" or 2-3/4".

# EASY 3-STEP INSTALL

Designed with exposed screws for easy screwdriver access.



One-Tool  
Installation  
with a  
Screwdriver

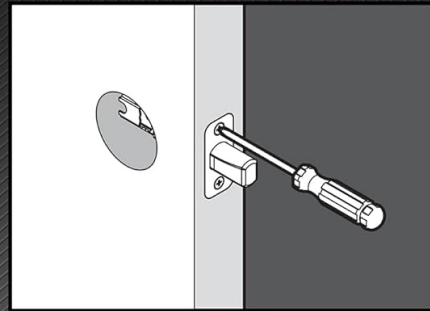

**1** Screw in Adjustable Latch

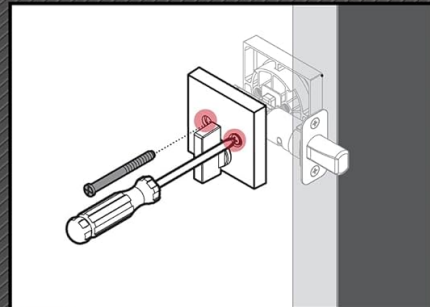

**2** Place Deadbolt on Door and Secure with Screws

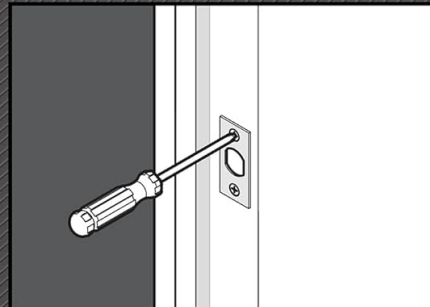

**3** Screw in Strike

Image: Visual guide for the easy 3-step installation process, showing how to screw in the adjustable latch, place the deadbolt, and screw in the strike plate.

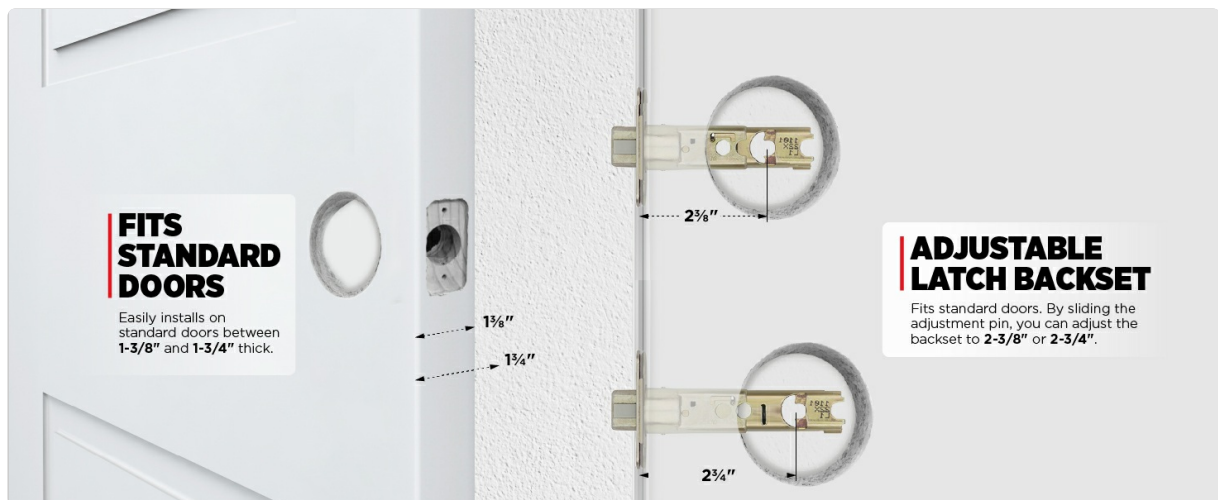

Image: Diagram illustrating standard door fit and adjustable latch backset for Kwikset door locks.

## 2.2. Step-by-Step Installation

1. **Install Latch:** Insert the latch into the door edge and secure it with screws. Ensure the backset is

correctly adjusted.

2. **Install Deadbolt:** Place the deadbolt mechanism into the upper bore hole on the door and secure it with the provided screws.
3. **Install Knob:** Assemble the keyed entry knob components, ensuring the spindle passes through the latch. Secure the knob to the door.
4. **Install Strike Plates:** Attach the strike plates to the door frame for both the deadbolt and the knob latch.

All necessary hardware and detailed directions are included in the box. For visual assistance, refer to the installation guide provided with your product.

---

## 3. OPERATION

### 3.1. Keyed Entry Knob

The keyed entry knob allows locking and unlocking from the exterior using a key, and from the interior using a turn-button or push-button mechanism. To lock from the interior, rotate or push the button. To unlock, turn the knob or use the key from the exterior.

### 3.2. Single Cylinder Deadbolt

The single cylinder deadbolt is operated by a key from the exterior and a thumb-turn from the interior. To lock, turn the key from the outside or the thumb-turn from the inside. To unlock, reverse the action.

### 3.3. SmartKey Security Re-keying

Kwikset's SmartKey Security technology allows you to re-key your lock yourself in seconds, providing convenience and enhanced security. This is useful if you've recently moved, lost a key, or want all your Kwikset locks to operate with a single key.



# SMARTKEY SECURITY®

## ONE KEY FOR ALL YOUR LOCKS™



WITH PROTECTION AGAINST  
ADVANCED BREAK-IN TECHNIQUES

The lock you can  
re-key yourself in  
seconds for any  
situation, including:



**Recently  
Moved**



**Lost  
Keys**



**Multiple  
Doors**



**Carry  
Less Keys**

Image: Illustration of the SmartKey Security feature, showing the reset tool insertion point and how one key can be used for multiple locks.

Your browser does not support the video tag.

Video: Official Kwikset video demonstrating the SmartKey Security re-keying process.

### 3.4. Universal Design

The knob features a universal design, allowing it to be installed on both right-handed and left-handed doors without special adjustments.

# UNIVERSAL DESIGN

Knob can be installed on both right-handed and left-handed doors.

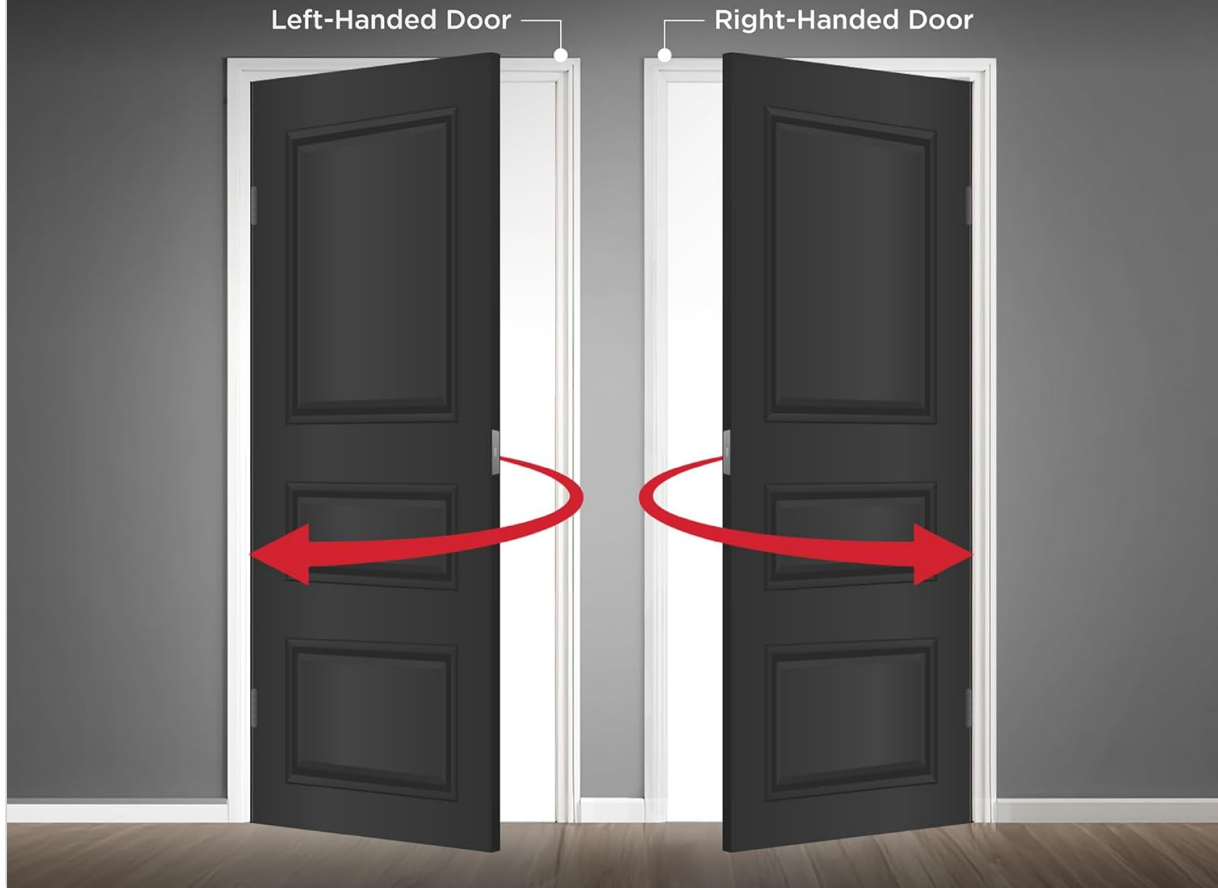

Image: Diagram illustrating the universal design of the knob, showing its compatibility with both left-handed and right-handed door installations.

## 4. MAINTENANCE

### 4.1. Cleaning

To maintain the finish and functionality of your lockset, clean it regularly with a soft, damp cloth. Avoid abrasive cleaners, solvents, or harsh chemicals, as these can damage the finish and internal mechanisms.

### 4.2. Microban Protection

Kwikset door hardware is treated with Microban antimicrobial technology. This protection inhibits the growth of damaging bacteria on the product surface, contributing to a cleaner home environment. The Microban protection is 99.9% cleaner than an unprotected surface.

Kwikset<sup>®</sup> with Microban<sup>®</sup> inhibits growth of damaging bacteria, providing you with a **cleaner home**.

**99.9% CLEANER**  
**THAN UNPROTECTED SURFACE\***

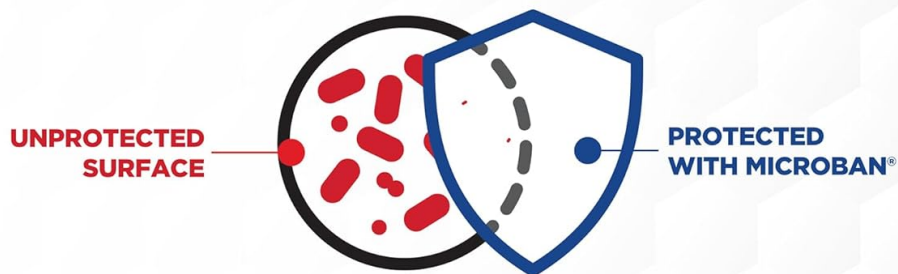

Treated with Microban<sup>®</sup> Technology, bacteria cell growth is disrupted and unable to reproduce. \*Limited to the bacteria it is effective on.

Image: Explanation of Microban Antimicrobial Technology, showing how it protects surfaces from bacterial growth compared to unprotected surfaces.

## 5. TROUBLESHOOTING

If you encounter any issues with your Kwikset Pismo 991 lockset, please refer to the detailed troubleshooting guide included in your product packaging. Common issues may include:

- Difficulty turning the key or knob.
- Latch not retracting or extending properly.
- Loose components.

For persistent problems, contact Kwikset customer support for assistance.

## 6. SPECIFICATIONS

Feature	Specification
---------	---------------

Brand	Kwikset
Model Name	Pismo
Model Number	99910-070
UPC	883351871808
Color	Matte Black
Material	Metal
Lock Type	Key Lock
Special Feature	SmartKey Security, Microban Protection
Item Dimensions (L x W x H)	2.94 x 7.81 x 9.06 inches
Item Weight	3.09 Pounds
Door Thickness Compatibility	1-3/8" to 1-3/4"
Latch Backset	Adjustable to 2-3/8" or 2-3/4"
Certifications	Grade 1 BHMA Certified (Security, Durability, Finish)

---

## 7. WARRANTY AND SUPPORT

### 7.1. Warranty Information

The Kwikset Pismo 991 Keyed Entry Knob and Single Cylinder Deadbolt Combo Pack is backed by a **Lifetime Mechanical and Finish Warranty**. This warranty covers defects in material and workmanship for the lifetime of the original residential user. Please refer to the warranty documentation included with your product for full details and terms.

### 7.2. Customer Support

For technical assistance, warranty claims, or any questions regarding your Kwikset product, please visit the official Kwikset website or contact their customer service department. Contact information can typically be found in the product packaging or on the Kwikset website.