

OttLite CS3QB009-SHPR

OttLite Charge Up LED Desk Lamp User Manual

Model: CS3QB009-SHPR

Brand: OttLite

INTRODUCTION

Thank you for choosing the OttLite Charge Up LED Desk Lamp. This innovative lamp combines OttLite's exclusive ClearSun LED Technology, designed to reduce eyestrain, with modern convenience features like wireless Qi charging and a USB charging port. Its adjustable design and multiple light settings make it a versatile addition to any workspace, bedroom, or study area.

Please read this manual thoroughly before use to ensure proper operation and to maximize the benefits of your new OttLite lamp.

KEY FEATURES

- **ClearSun LED Technology:** Reduces eyestrain by up to 51% by matching the spectral output of the sun, providing smooth, uniform light with a 95+ Color Rendering Index (CRI) for exceptional color accuracy.
- **Wireless Qi Charging Pad:** Conveniently charge Qi-compatible devices by simply placing them on the lamp base.
- **USB Charging Port:** Integrated 5V, 2.1A USB port allows charging of an additional device, such as headphones, smartwatches, or tablets.
- **Adjustable Neck:** The lamp's neck extends in height from 11 to 19 inches with two points of articulation, allowing you to position light precisely where needed.
- **3 Color Temperature Modes:** Easily switch between Warm Light, Bright White, and ClearSun Natural Daylight modes using touch-sensitive controls.
- **3 Brightness Settings:** Each color mode offers three adjustable brightness levels to suit your task and preference.

Visual Overview of Features



This image highlights the key features of the OttLite Charge Up LED Desk Lamp, including its adjustable neck, USB and wireless charging capabilities, and touch-sensitive controls for light settings.

ClearSun LED Technology Explained

OttLite's ClearSun LED technology is engineered to provide light that closely mimics natural daylight, reducing the harsh peaks and valleys found in typical LED light spectra. This results in a balanced, smooth illumination that is gentler on your eyes and helps reduce eyestrain.

ClearSun Technology

The spectral output of most LED light sources looks like a roller coaster — full of big peaks and deep valleys that leave your eye muscles strained.

ClearSun LEDs are different. Our revolutionary technology creates a comparable experience to natural daylight, with no gaps for your eyes to fill in. ClearSun creates balanced, smooth lighting that **reduces eyestrain up to 51%.**

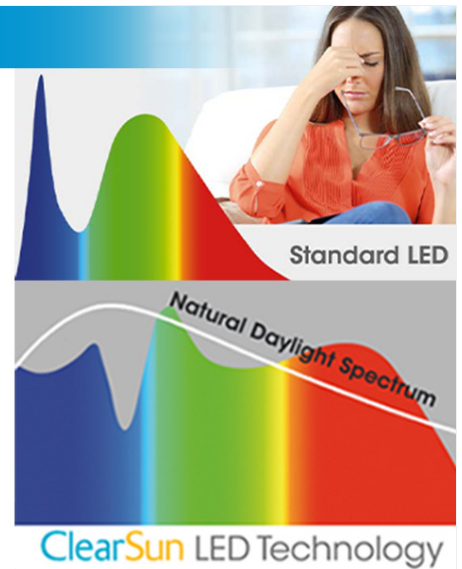

The graph illustrates how ClearSun LED technology provides a more consistent and balanced light spectrum compared to typical LEDs, which can cause eyestrain.

Incredible Color Accuracy

The Color Rendering Index (CRI) is used to measure how accurately a light shows color on a scale of 1-100. With a **CRI score of 95+**, OttLite ClearSun LEDs show colors more vividly and true to life.

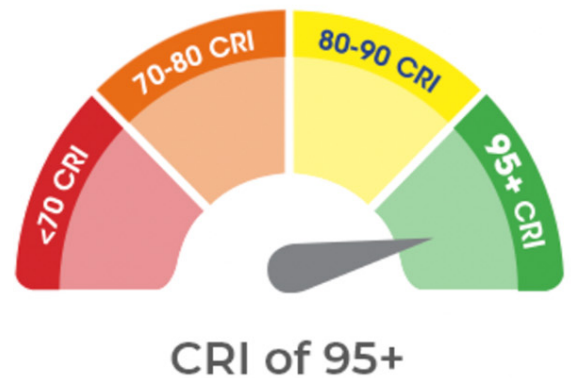

With a CRI of 95+, OttLite ClearSun LEDs ensure colors are seen vividly and true to life, similar to natural daylight.

Official Product Videos

OttLite: ClearSun (Collection Wide)

This video provides an overview of OttLite's ClearSun LED Technology and its benefits across their product line, emphasizing eye health and visual clarity.

OttLite: ClearSun Charge

This video demonstrates the charging capabilities of the OttLite Charge Up lamp, showcasing both the wireless Qi charging pad and the USB port in action.

SETUP INSTRUCTIONS

1. **Unpack:** Carefully remove all components from the packaging. Ensure you have the OttLite Charge Up LED Desk Lamp and the included power adapter.
2. **Connect Power:** Insert the small end of the power adapter into the power input port located at the back of the lamp base. Plug the other end of the adapter into a standard electrical outlet.

3. **Position Lamp:** Place the lamp on a stable, flat surface. Adjust the lamp head and arm to your desired position. The lamp's neck can extend from 11 to 19 inches in height.



The lamp is designed for easy setup, simply connect the adapter and place it on your desired surface.

OPERATING INSTRUCTIONS

Light Control

The lamp features touch-sensitive controls located on the base.

- **Power On/Off:** Touch the **Power button** (circle icon) to turn the lamp on or off.
- **Adjust Brightness:** Use the '+' and '-' buttons to cycle through the three brightness levels for the current light mode.
- **Change Color Mode:** Touch the **Mode button** (sun icon) to switch between the three color temperature modes: Warm Light, Bright White, and ClearSun Natural Daylight.

Charging Devices

The lamp allows you to charge up to two devices simultaneously.

- **Wireless Qi Charging:** Place your Qi-compatible smartphone or other device directly onto the wireless charging pad located on the lamp base. Ensure the device is centered for optimal charging. A charging indicator may appear on your device screen.
- **USB Charging:** Connect your device's USB charging cable to the 5V, 2.1A USB port located on the back of the lamp base.



The lamp provides convenient charging options for your devices, both wirelessly and via USB.

CARE AND MAINTENANCE

- **Cleaning:** To clean the lamp, ensure it is unplugged from the power outlet. Use a soft, dry cloth to wipe down the surfaces. Do not use abrasive cleaners, waxes, or solvents as they may damage the finish.
- **Storage:** If storing the lamp for an extended period, unplug it and gently fold the adjustable arm to its most compact position. Store in a cool, dry place.
- **LEDs:** The LEDs in this lamp are designed to last for many years and are not replaceable.

TROUBLESHOOTING

Problem	Possible Cause	Solution
Lamp does not turn on.	Not plugged in or power adapter issue.	Ensure the power adapter is securely plugged into both the lamp and the wall outlet. Try a different outlet.
Wireless charging is not working.	Device not Qi-compatible, not positioned correctly, or phone case is too thick.	Verify your device supports Qi wireless charging. Reposition the device on the charging pad. Remove thick phone cases.
USB charging is not working.	Cable issue or device not compatible.	Ensure the USB cable is fully inserted into both the lamp and your device. Try a different USB cable.
Light flickers or is dim.	Power supply issue or lamp malfunction.	Check power connection. If the problem persists, contact customer support.

PRODUCT SPECIFICATIONS

Feature	Detail
Model Number	CS3QB009-SHPR
Dimensions (D x W x H)	6.63" x 4.75" x 20.25"
Item Weight	2.01 pounds (0.91 kg)
Material	Plastic
Light Source Type	LED (ClearSun Technology)
Wattage	8 watts
Brightness	650 Lumen
Color Temperature	5000 Kelvin (ClearSun mode)
Color Rendering Index (CRI)	95.00
USB Port Output	5V, 2.1A
Included Components	Adapter

WARRANTY AND SUPPORT

For warranty information or technical support, please refer to the warranty card included with your product or visit the official OttLite website. You can also contact OttLite customer service directly for assistance with any issues or questions regarding your lamp.



OttLite Technologies, Inc.

Website: www.ottlite.com

© 2024 OttLite Technologies, Inc. All rights reserved.

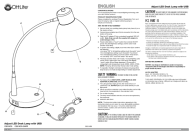
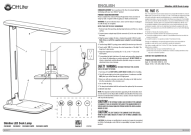
Related Documents - CS3QB009-SHPR

	<p>OttLite LED Desk Lamp with Color Changing Base - User Manual and Instructions</p> <p>Detailed instructions and safety information for the OttLite LED Desk Lamp with Color Changing Base (Model MCC00Z). Learn how to set up, operate, and maintain your lamp, including brightness and color mode adjustments, and safety precautions.</p>
	<p>OttLite LED Desk Lamp with USB - Adjustable Brightness & Color Modes</p> <p>Discover the OttLite LED Desk Lamp with USB, offering adjustable brightness, three color modes (5000K, 4000K, 2700K), and a convenient 5V-2.1A USB charging port. Ideal for home or office use, providing natural lighting.</p>
	<p>OttLite Slimline LED Desk Lamp: User Manual and Setup Guide</p> <p>Get detailed setup instructions, operation guidance, safety warnings, and FCC compliance information for the OttLite Slimline LED Desk Lamp (models CS33600C, CS336G5C). Learn how to adjust brightness and color temperature.</p>

	<p>OttLite Creative Curves LED Desk Lamp User Manual and Safety Information</p> <p>User manual and safety guide for the OttLite Creative Curves LED Desk Lamp, covering assembly, operation, safety warnings, FCC compliance, and AC/DC adapter specifications. Includes model numbers CSA30WGC, CSA30WTC, and more.</p>
	<p>OttLite 13W Magnifier Task Lamp: Assembly, Use, and Safety Instructions</p> <p>Learn how to assemble, use, and maintain your OttLite 13W Magnifier Task Lamp. This guide includes important safety instructions, tube replacement steps, and FCC compliance information for models like OTL13MAGWT and OTL13MAGTU.</p>
	<p>OttLite Flexible Soft Touch LED Desk Lamp - User Manual and Instructions</p> <p>Comprehensive guide for the OttLite Flexible Soft Touch LED Desk Lamp, including setup, operation, safety warnings, and FCC compliance information. Features model numbers and specifications.</p>

Documents - OttLite – CS3QB009-SHPR

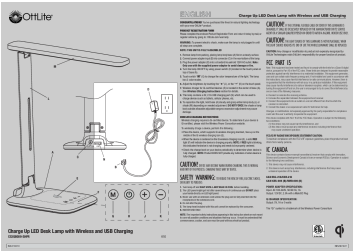

[\[pdf\]](#) Instructions Warranty

Product Instructions View Download OttLite Wellness Series Charge Up LED Desk Lamp with Wireless Charging CS3QB009 SHPR and USB K10 v 13107032998642004388 ottlite cdn shop files ||| M D L DC 12V 2.5A USB A C N DC 12V 2.5A USB B E F G H J K Charge Up LED Desk Lamp with Wireless and USB Charging **CS3QB009-SHPR** K10 INS210670 ENGLISH Charge Up LED Desk Lamp with Wireless and USB Charging CONGRATULATIONS You ve purchased the finest in natural lighting technolo... lang:en score:62 filesize: 342.02 K page_count: 1 document date: 2021-08-18