

## EVERCROSS EV08E

# EVERCROSS EV08E Electric Scooter User Manual

Model: EV08E | Brand: EVERCROSS

## 1. INTRODUCTION

Welcome to the EVERCROSS EV08E Electric Scooter user manual. This guide provides essential information for the safe operation, maintenance, and troubleshooting of your new electric scooter. Please read this manual thoroughly before your first ride to ensure optimal performance and safety.

The EVERCROSS EV08E is designed for urban commuting and recreational use, offering a blend of power, portability, and safety features. It is equipped with a 350W motor, 8-inch solid tires, and multiple speed modes to adapt to various riding conditions.

### Safety Guidelines

- Always wear a helmet and appropriate safety gear (knee pads, elbow pads) when riding.
- Ensure the scooter is fully charged and all components are securely fastened before each use.
- Adhere to local traffic laws and regulations.
- Avoid riding in wet conditions, on slippery surfaces, or over obstacles.
- Do not exceed the maximum weight limit of 265 pounds.
- This product is UL2272 certified for electrical safety.

## 2. PRODUCT OVERVIEW

The EVERCROSS EV08E Electric Scooter features a robust design with user-friendly controls and integrated safety components.



Figure 2.1: Overview of the EVERCROSS EV08E Electric Scooter, showcasing its sleek design and portability with a carrying bag.

## Key Components

- **Handlebars:** Equipped with non-slip grips, brake lever, and accelerator.
- **LCD Display:** Provides real-time information including speed, battery level, and speed mode.
- **Headlight & Taillight:** For enhanced visibility during night riding.
- **350W Motor:** Powerful brushless motor for efficient propulsion.
- **8-inch Solid Tires:** Durable and puncture-resistant for various road surfaces.
- **Folding Mechanism:** One-step foot-actuated folding for easy storage and transport.
- **Front Shock Absorber:** Improves ride comfort by absorbing impacts.
- **E-braking System:** Ensures quick and smooth stopping.

# YOUR SAFETY FIRST



Headlight



Damping Spring



Brake Light

Figure 2.2: Illustration of the scooter's safety features, including the bright headlight, damping spring for shock absorption, and responsive brake light.



Figure 2.3: Close-up view of the 350W brushless motor, highlighting its low operating heat and deep anti-slip tire pattern.

## 3. SETUP

### 3.1 Unboxing and Initial Assembly

Your EVERCROSS EV08E Electric Scooter comes largely pre-assembled. Carefully remove all packaging materials. The main components are already connected, requiring minimal setup.

### 3.2 Initial Charging

Before your first ride, fully charge the scooter's battery. Locate the charging port on the side of the scooter. Connect the provided charger to the port and then to a power outlet. The charging indicator on the charger will change (e.g.,

from red to green) when fully charged. Charging time is approximately 5 hours.

### 3.3 Handlebar Adjustment

The handlebar height can be adjusted for rider comfort. Loosen the quick-release clamp on the stem, adjust the handlebar to your desired height, and securely tighten the clamp. Ensure the handlebar is firmly locked in place before riding.



Figure 3.1: The scooter features two adjustable handlebar heights (1030mm and 1100mm) for optimal rider comfort.

## 4. OPERATING INSTRUCTIONS

### 4.1 Powering On/Off

To power on the scooter, press and hold the power button on the LCD display for a few seconds. The display will illuminate. To power off, press and hold the power button again until the display turns off.

### 4.2 Speed Modes

The EV08E offers three speed modes: 8 mph, 12 mph, and 15 mph. The maximum speed can be increased to 19 mph by releasing the speed limit. To switch between modes, short press the "Mode" button on the display. The current speed mode will be indicated on the LCD.

#### Releasing the Speed Limit (Up to 19 mph)

To unlock the full speed potential of 19 mph, follow these steps:

1. Press and hold the [Speaker] and [Mode] keys for 3 seconds to enter the parameter setting.
2. Press the [Mode] key to switch to '5'.
3. Press the [Headlight] key to switch from 0 to 1.
4. Press and hold the [MODE] button for 3 seconds to save the parameters and return.

# RELEASED SPEED LIMIT



Step 1: Press and hold the [Speaker] and [Mode] keys for 3 seconds to enter the parameter setting



Step 2: Press the [Mode] key to switch to 5



Step 3: Press the [Headlight] key to switch from 0 to 1



Step 4: Press and hold the [MODE] button for 3 seconds to save the parameters and return

Figure 4.1: Step-by-step guide to releasing the scooter's speed limit for a maximum speed of 19 mph.

## 4.3 Accelerating and Braking

To accelerate, gently press the accelerator lever located on the right handlebar. To brake, press the brake lever on the left handlebar. The E-braking system provides quick and secure stopping power. The rear brake light will illuminate when braking.

## 4.4 Folding and Carrying

The scooter features a convenient one-step folding design for easy portability. To fold, step on the foot-actuated folding mechanism while applying pressure, hold both handles with your hands, and push forwards until the stem locks into the folded position. The scooter can then be carried with one hand.





## EASY TO FOLD & CARRY

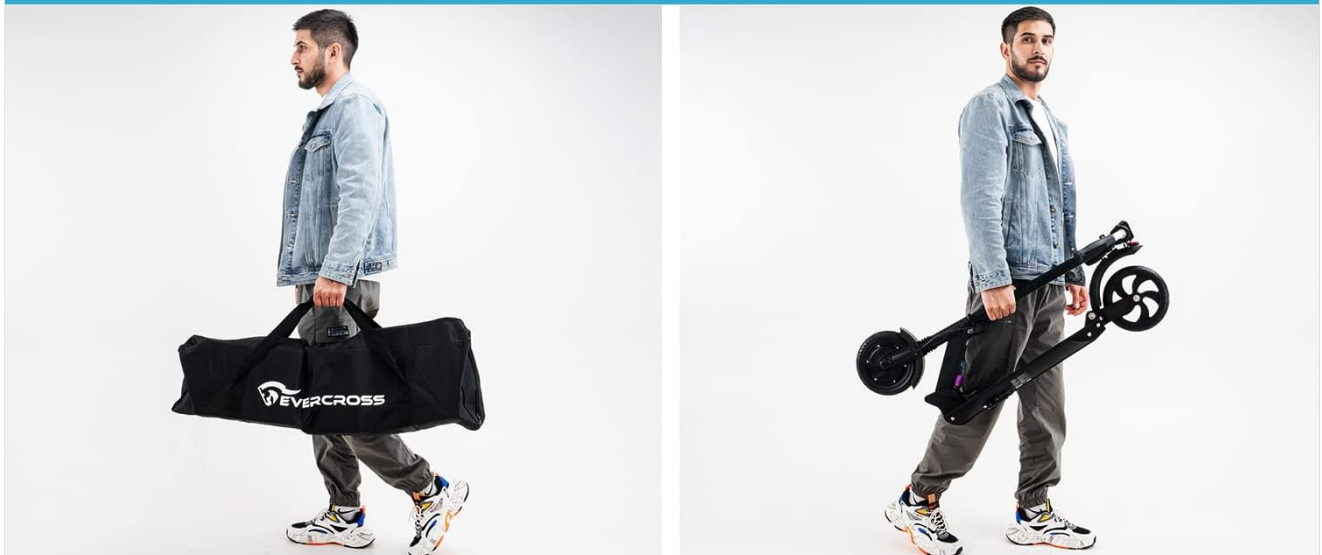

Figure 4.2: Visual guide demonstrating the easy folding mechanism and how the scooter can be carried.



Figure 4.3: The upgraded folding pedals make the folding process even easier and more secure.

## 5. MAINTENANCE

### 5.1 Cleaning

Regularly clean your scooter with a damp cloth. Avoid using high-pressure water or harsh chemicals, as this can damage electronic components. Ensure the scooter is dry before storing or charging.



Figure 5.1: The scooter's fender effectively blocks mud and debris, keeping the rider and scooter cleaner.

### 5.2 Battery Care

To prolong battery life, avoid completely draining the battery. Charge it regularly, even if not in frequent use. Store the scooter in a cool, dry place away from direct sunlight and extreme temperatures.

### 5.3 Tire Care

The EV08E features solid rubber tires, eliminating the need for inflation. Regularly inspect tires for any signs of wear or damage. While solid, avoid riding over sharp objects that could cause cuts or punctures.

## 6. TROUBLESHOOTING

| Problem                                 | Possible Cause  | Solution   |
|---|---|--|
| Scooter does not power on.              | Low battery; loose connections.                       | Charge the battery fully; check all visible cable connections.                                   |
| Reduced range or speed.                 | Low battery; heavy load; uphill riding; cold weather. | Ensure full charge; reduce load; avoid steep inclines; battery performance may decrease in cold. |
| Folding mechanism not working smoothly. | Debris in mechanism; improper technique.              | Clean the folding area; ensure correct foot-actuated pressure and push direction.                |
| LCD display not clear or unresponsive.  | Protective film still on; moisture; internal error.   | Remove protective film; ensure display is dry; contact support if issue persists.                |

For issues not listed here or if troubleshooting steps do not resolve the problem, please contact EVERCROSS customer support.



7. SPECIFICATIONS



Figure 7.1: Visual representation of key performance specifications for the EVERCROSS EV08E.

| Feature            | Detail  |
|--------------------|---|
| Brand              | EVERCROSS                                       |
| Model Name         | EV08E   |
| Motor Power        | 350W  |
| Battery            | 36V 7.8Ah                                       |
| Max Speed          | 15 mph (Up to 19 mph after speed limit release) |
| Max Distance Range | 20 Miles  |



| Feature              | Detail                 |
|----------------------|------------------------|
| Weight Limit         | 265 Pounds             |
| Item Weight          | 26 Pounds              |
| Wheel Size           | 8 Inches               |
| Wheel Type           | Solid Rubber           |
| Frame Material       | Aluminum               |
| Charging Time        | 5 Hours                |
| Product Dimensions   | 41"L x 13.3"W x 42.5"H |
| Safety Certification | UL2272 Certified       |

## 8. WARRANTY AND SUPPORT

EVERCROSS is committed to providing high-quality products and excellent customer service. The EV08E Electric Scooter comes with an extended warranty. For specific warranty terms and conditions, please refer to the warranty card included with your product or contact EVERCROSS customer support.

Should you require assistance with accessories, after-sales support, or have any questions regarding your scooter, please reach out to our dedicated support team. Contact information can typically be found on the product packaging or the official EVERCROSS website.

### Related Documents - EV08E

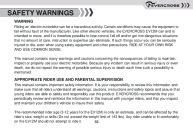
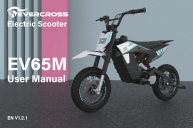
|   |   |
|---|---|
|  | <p><a href="#">EVERCROSS A1 Electric Scooter User Manual</a></p> <p>Comprehensive user manual for the EVERCROSS A1 electric scooter, covering assembly, charging, operation, safety guidelines, troubleshooting, maintenance, and specifications. Learn how to safely operate and maintain your A1 scooter.</p> |
|  | <p><a href="#">EVERCROSS EV12M Electric Motorbike User Manual and Safety Guide</a></p> <p>Comprehensive guide for the EVERCROSS EV12M electric motorbike, covering safety warnings, package contents, assembly, riding instructions, charging, specifications, maintenance, and warranty information.</p>       |
|  | <p><a href="#">EVERCROSS EV65M Electric Scooter User Manual</a></p> <p>Comprehensive user manual for the EVERCROSS EV65M Electric Scooter, covering safety warnings, package contents, assembly, riding instructions, charging, specifications, maintenance, and warranty information.</p>                      |

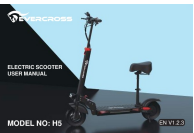
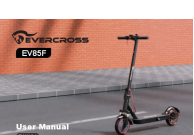
|   |  |
|---|--|
|   | <a href="#">EVERCROSS EV10K PRO Electric Scooter User Manual</a><br>Official user manual for the EVERCROSS EV10K PRO electric scooter. Find detailed instructions on assembly, charging, riding, safety precautions, app connectivity, maintenance, specifications, and troubleshooting. Essential guide for EV10K PRO owners. |
|  | <a href="#">EVERCROSS H5 Electric Scooter User Manual</a><br>User manual for the EVERCROSS H5 electric scooter, covering package contents, tool kit usage, product overview, charging, riding instructions, folding, specifications, warranty, troubleshooting, and safety guidelines.   |
|  | <a href="#">EVERCROSS EV85F Electric Scooter User Manual</a><br>Comprehensive user manual for the EVERCROSS EV85F electric scooter, covering product overview, assembly, charging, riding instructions, app connectivity, safety guidelines, maintenance, specifications, and warranty information.                            |

Documents - EVERCROSS – EV08E



[Manuale Utente Scooter Elettrico EVERCROSS EV08E](#)

Guida completa per l'utente dello scooter elettrico EVERCROSS EV08E, che copre l'assemblaggio, le istruzioni per l'uso, la manutenzione, la risoluzione dei problemi e le specifiche.

lang:it score:31 filesize: 2.22 M page\_count: 19 document date: 2023-04-14



[Manual de Usuario Scooter Eléctrico EVERCROSS EV08E](#)

Este manual proporciona instrucciones detalladas sobre el uso, montaje, mantenimiento y seguridad del scooter eléctrico EVERCROSS EV08E, incluyendo especificaciones técnicas y solución de problemas.

lang:es score:30 filesize: 2.22 M page\_count: 18 document date: 2023-05-03

[\[pdf\]](#)

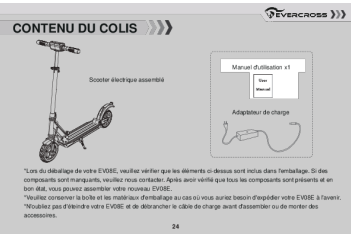

CONTENU DU COLISVotre EV08E est complètement chargée lorsque la LED du chargeur passe rouge en charge au vert Mise Port de rechargement Étape rechargeB1sNylGbZ8Lm media amazon images I B1sNylGbZ8L |||

CONTENU DU COLIS Scooter lectrique assembl Manuel d utilisation x1 Adaptateur de charge \*Lors du dballage de votre **EV08E**, veuillez vrifier que les lments ci-dessus sont inclus dans l emballage. Si des composants sont manquants, veuillez nous contacter. Aprs avoir vrifi que tous les composants sont...

lang:fr score:24 filesize: 2.02 M page\_count: 18 document date: 2023-04-14