

Manuals+

[Q & A](#) | [Deep Search](#) | [Upload](#)

Manuals.plus /

- › [aghi](#) /
- › Bluetooth Controller User Manual

aghi Black

Bluetooth Controller User Manual

Brand: aghi | Model: Black Wireless Game Controller

INTRODUCTION

This manual provides comprehensive instructions for setting up, operating, and maintaining your aghi Bluetooth Wireless Game Controller. Designed for multi-platform compatibility, this controller offers advanced features such as Hall Effect Joysticks, programmable buttons, and dual vibration for an enhanced gaming experience across Nintendo Switch, PC, iPhone, Android, Apple Arcade MFi Games, TV, and Steam.



Figure 1: Aghi Bluetooth Controller with a smartphone mounted, showcasing its mobile gaming capability.

SETUP

Package Contents

- 1 x aghi Wireless Bluetooth Controller
- 1 x Mobile Phone Clip
- 1 x 3.2ft Type-C USB Data Cable
- 1 x User Manual (this document)



Figure 2: Included accessories: controller, phone clip, and USB-C cable.

Charging the Controller

Before first use, fully charge the controller. Connect the provided USB-C cable to the controller's charging port and the other end to a USB power source (e.g., computer USB port, USB wall adapter). The LED indicators will show charging status and turn off when fully charged.

Support IOS/Android Phone



Support Direct Power Supply



Handle NON-Slip and
Wear-Resistant
Accurate Triggering of Keys



Colorful Lighting Mode

Figure 3: Controller connected to a power source for charging.

A full charge takes approximately 2-3 hours and provides 10-15 hours of gameplay.

Play Anywhere Any Time!



15 Hours
Playing Time



2-3 Hours
Charging Time



5 Minutes
Auto Sleep



650 mAh
Large capacity



Phone Clip Length:
4.5cm - 7.5cm

Phone Clip Included
Design for **3.6-6.5 inch** smartphones

Figure 4: Battery life and charging specifications.

Connecting to Devices

The controller supports both Bluetooth 4.0 wireless connection and wired USB connection.

Bluetooth Connection (General)

To enter pairing mode, press and hold the specific button combination for your device type until the LED light flashes rapidly.



FOR IOS / MAC / APPLE TV / ANDROID / SWITCH / PC

Phone Bluetooth Connection Quick Start

The image contains three panels illustrating Bluetooth connection steps:

- Panel 1 (iOS/Mac/Apple TV):** Shows the controller with the A and HOME buttons highlighted in red. A hand icon indicates a long press. The LED light is purple. The connection screen shows "Xbox Wireless Controller Connected" with three avatars.
- Panel 2 (Android - Xbox Mode):** Shows the controller with the A and HOME buttons highlighted in red. A hand icon indicates a long press. The LED light is purple. The connection screen shows "Xbox Wireless Controller Connected" with two avatars.
- Panel 3 (Android - Gamepad Mode):** Shows the controller with the B and HOME buttons highlighted in red. A hand icon indicates a long press. The LED light is green. The connection screen shows "Gamepad Connected" with three game icons.

Note: Free Fire, Pubg and eFootball games are not compatible

Figure 5: Bluetooth connection quick start guide for various platforms.

For iOS/Mac/Apple TV (MFi Games): Press and hold **A + HOME** button for 3 seconds until the LED flashes purple. Then, on your device, go to Bluetooth settings and select "Xbox Wireless Controller" to connect.

For Android (Xbox Wireless Controller Mode - for games like Call of Duty, Apex Legends): Press and hold **A + HOME** button for 3 seconds until the LED flashes purple. Then, on your Android device, go to Bluetooth settings and select "Xbox Wireless Controller" to connect.

For Android (Gamepad Mode - for most common games and emulator apps like Minecraft): Press and hold **B + HOME** button for 3 seconds until the LED flashes green. Then, on your Android device, go to Bluetooth settings and select "Gamepad" to connect.

For Nintendo Switch/PC: Press and hold **Y + HOME** button for 3 seconds until the LED flashes blue. Then, on your Switch (Controllers -> Change Grip/Order) or PC (Bluetooth settings), select the controller to connect.

Once successfully connected, the LED light will remain solid in the corresponding color.

Wired Connection (PC)

Connect the USB-C cable from the controller to a USB port on your PC. The controller will automatically be recognized and ready for use.

Attaching the Phone Clip

The included phone clip can be attached to the controller to hold your smartphone. It is suitable for phones with widths ranging from 45mm to 75mm (approximately 3.6-6.5 inches).



Figure 6: Controller with phone clip attached.

OPERATING INSTRUCTIONS

Key Features

Hall Effect Joysticks: Experience precise, drift-free control with advanced Hall Effect joysticks. This technology uses magnets and electrical conductors to detect joystick position, eliminating wear and tear common in traditional joysticks.

Lock Joystick Speed: Adjust joystick sensitivity for faster and more accurate movements, ideal for competitive gaming.

Programmable Buttons: Record and store up to 30 seconds of button operations for playback, allowing for complex macros and automated actions.

Dual Vibration & 6-Axis Gyroscope: Enjoy immersive feedback with dual haptic feedback motors (4-level adjustable intensity) and sensitive six-axis gyroscopic sensors for motion control in compatible games.

Customized TURBO: Set buttons to auto or manual turbo mode for rapid-fire actions. Turbo speed is adjustable.

Switch ABXY Key Habit: Easily switch between Nintendo Switch layout and Xbox layout for ABXY buttons to match your preference.

Screenshot Function: Capture in-game moments with a dedicated screenshot button.

Adjustable LED Light: Customize the controller's LED lighting with 7 available colors to enhance your gaming atmosphere.

Home Wake-Up: Short press the Home button to wake up the controller and connected device.



Figure 7: Key features of the aghi controller.

 For Playing COD Game,
Use [**A+Home**] to Connect your Android/iPhone Device

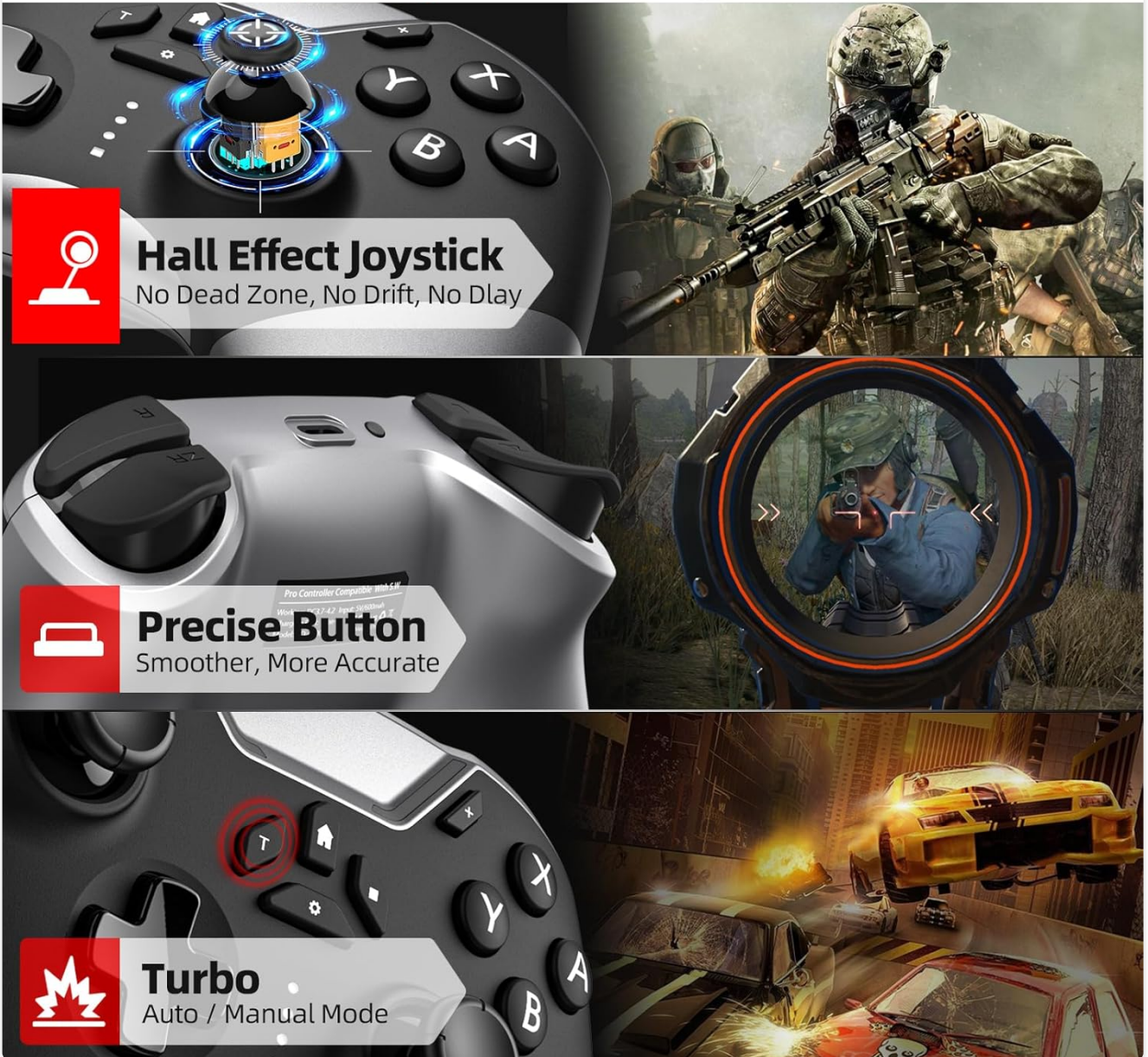

Figure 8: Hall Effect Joystick, Precise Button, and Turbo features.

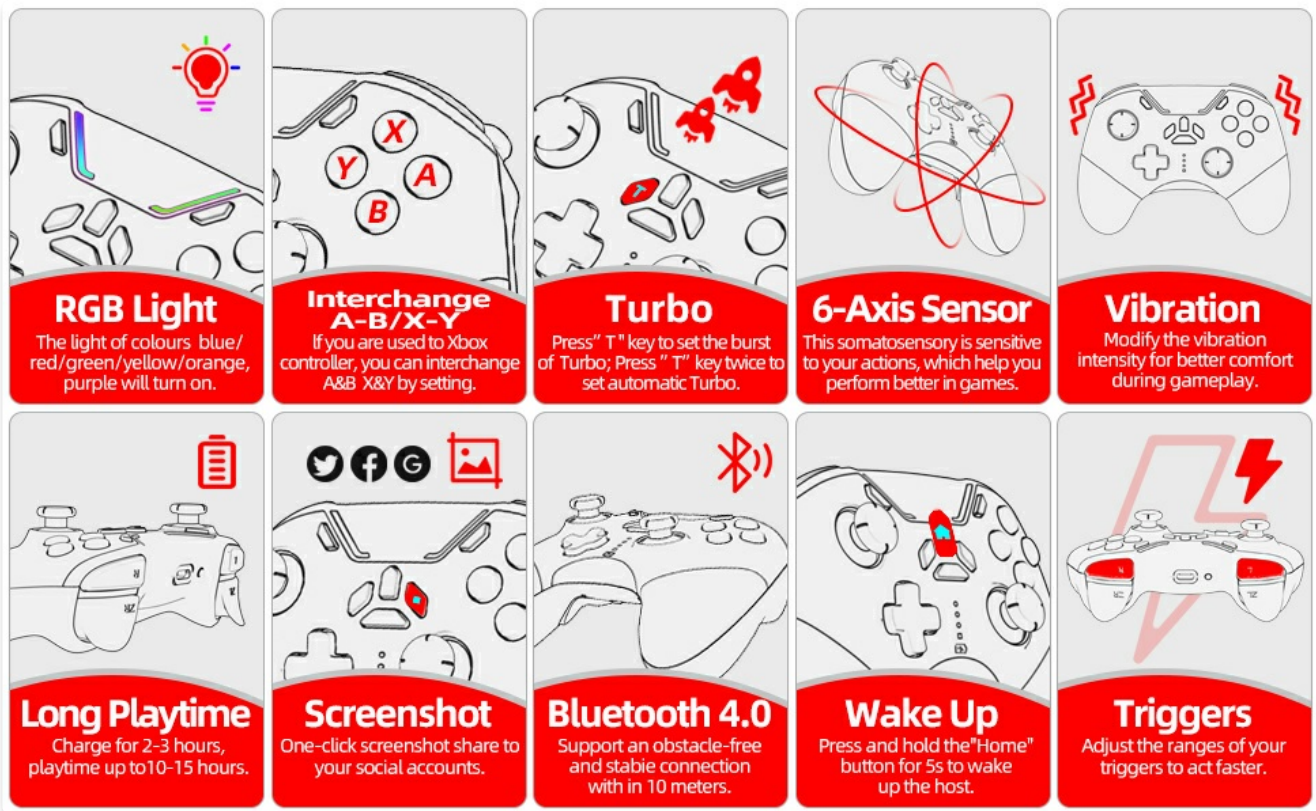

Figure 9: Comprehensive overview of controller functions.

MAINTENANCE

Cleaning

Wipe the controller with a soft, dry cloth. Avoid using harsh chemicals or abrasive materials that could damage the surface.

Storage

Store the controller in a cool, dry place away from direct sunlight and extreme temperatures. If storing for an extended period, ensure the battery is partially charged (around 50%) to prolong its lifespan.

Battery Care

To maximize battery life, avoid fully discharging the controller frequently. Recharge when the battery low indicator appears. The controller features an auto-sleep function after 5 minutes of inactivity to conserve power.

TROUBLESHOOTING

Problem	Possible Cause	Solution
Controller does not turn on.	Low battery.	Charge the controller fully.

Problem	Possible Cause	Solution
Cannot connect via Bluetooth.	Incorrect pairing mode; device Bluetooth off; interference.	Ensure correct button combination for pairing mode. Turn on Bluetooth on your device. Move closer to the device. Unpair previous connections if necessary.
Joystick drift or inaccurate input.	Software glitch; calibration needed.	Restart the controller and device. If issues persist, check for firmware updates or recalibrate the controller via PC settings (if applicable).
Buttons unresponsive.	Low battery; connection issue.	Charge the controller. Re-establish Bluetooth connection or try wired connection.

SPECIFICATIONS

Connectivity: Bluetooth 4.0, Wired (USB-C)

Compatibility: Nintendo Switch/Lite/OLED, PC (Windows 7/8/10/11), Android, iOS/Mac/iPad/Tablet, Apple Arcade MFi Games, TV, Steam, Tesla

Battery Capacity: 650 mAh Lithium Ion

Playtime: 10-15 hours (approx.)

Charging Time: 2-3 hours (approx.)

Auto Sleep: 5 minutes of inactivity

Joysticks: Hall Effect

Sensors: 6-Axis Gyroscope

Vibration: Dual Motors, 4-level adjustable intensity

Weight: 10.7 ounces

Dimensions: 6.38 x 5.47 x 2.95 inches

WARRANTY & SUPPORT

Warranty Information

Please refer to the product packaging or the official aghi website for the most up-to-date warranty information. Typically, aghi products come with a limited warranty covering manufacturing defects.

Customer Support

For technical assistance, troubleshooting, or warranty claims, please contact aghi customer support through their official website or the contact information provided on the product packaging. You may also find additional resources and FAQs on the aghi brand store on Amazon.

Visit the aghi Store: [aghi Amazon Store](#)

