

## Manuals+

[Q & A](#) | [Deep Search](#) | [Upload](#)

manuals.plus /

- › [Onforu](#) /
- › [Onforu 60W Flood Light Outdoor Instruction Manual](#)

## Onforu BDB60-3

# Onforu 60W Flood Light Outdoor Instruction Manual

Model: BDB60-3

Brand: Onforu

## PRODUCT OVERVIEW

The Onforu 60W Flood Light is a high-brightness, energy-efficient outdoor security light designed for various exterior applications. It features three adjustable heads, providing wide illumination, and is built to withstand outdoor conditions with its IP65 waterproof rating.



Image: Front view of the Onforu 60W Flood Light, showcasing its three adjustable LED light heads and central mounting base.

## Key Features

- **60W Brightness & Energy Saving:** Delivers 6000 lumens of brightness from 112 LED units, comparable to a 400W traditional bulb, saving over 85% on electricity costs.

- **Switch Controlled Operation:** Designed for control via a standard wall switch. This model does *not* include motion sensing, solar power, or dusk-to-dawn functionality.
- **Wide Area Illumination:** Features three independently adjustable light heads, allowing for a broad 270° illumination angle to cover large areas.
- **IP65 Waterproof Rating:** Constructed to withstand various weather conditions, including rain, sleet, and snow, making it suitable for entryways, yards, and other outdoor locations.
- **Durable Construction & Efficient Cooling:** Made from die-cast aluminum for superior heat dissipation, ensuring a longer product lifespan.

## SPECIFICATIONS

| Attribute               | Detail                                 |
|-------------------------|--|
| Brand                   | Onforu                                 |
| Model Name              | BDB60-3                                |
| Color                   | Brown                                  |
| Material                | Aluminum, PC + Aluminum                |
| Light Fixture Form      | Floodlight                             |
| Product Dimensions      | 10.7"L x 5.8"W x 4.7"H                 |
| Indoor/Outdoor Usage    | Outdoor                                |
| Power Source            | Corded Electric                        |
| Installation Type       | Wall Mount, Eave Mount, Soffit Mounted |
| Light Source Type       | LED                                    |
| Number of Light Sources | 112                                    |
| Voltage                 | 120 Volts                              |
| Wattage                 | 60 watts                               |
| Brightness              | 6000 Lumen                             |
| Light Color             | 6500K Daylight White                   |
| Water Resistance Level  | Waterproof (IP65)                      |
| Coverage                | 1150 ft²                               |
| Item Weight             | 1.92 Pounds                            |
| Special Feature         | Not Dimmable                           |



Image: Detailed diagram illustrating the dimensions and adjustable angles (90°, 110°, 335°) of the flood light's three heads.

## SETUP AND INSTALLATION

The Onforu 60W Flood Light is designed for hardwired installation and can be mounted on walls or under eaves (soffit mounted). Installation should be performed by a qualified individual following local electrical codes.

### Installation Steps (General Guidance):

1. **Safety First:** Before beginning installation, ensure the power supply to the installation area is turned OFF at the circuit breaker.
2. **Prepare Mounting Surface:** Identify a suitable wall or eave location for mounting. The light is designed to attach to a standard junction box.
3. **Mount the Fixture:** Secure the flood light's base to the junction box using appropriate hardware. Ensure a tight and stable connection.
4. **Wire Connections:** Connect the electrical wires from the fixture to the corresponding wires in the junction box (Live to Live, Neutral to Neutral, Ground to Ground). Use wire nuts to secure connections.
5. **Seal and Secure:** Ensure all connections are properly insulated and the fixture is securely fastened to prevent water ingress.
6. **Adjust Light Heads:** Once installed, adjust the three light heads to direct illumination to your desired areas. The

heads are independently adjustable.

7. **Restore Power:** Turn the power supply back ON at the circuit breaker.



Image: Illustration detailing the hardwired installation process, showing connections to a junction box and emphasizing that the light is not solar-powered, motion-sensored, or dusk-to-dawn.



Image: Visual representation of the flood light installed in both soffit-mounted and wall-mounted configurations.

## OPERATING INSTRUCTIONS

---

The Onforu 60W Flood Light is designed for simple operation via a standard wall switch. It does not feature integrated motion sensors, solar charging, or automatic dusk-to-dawn functionality.

### Basic Operation:

- To turn the flood light ON, activate the connected wall switch to the 'ON' position.
- To turn the flood light OFF, deactivate the connected wall switch to the 'OFF' position.



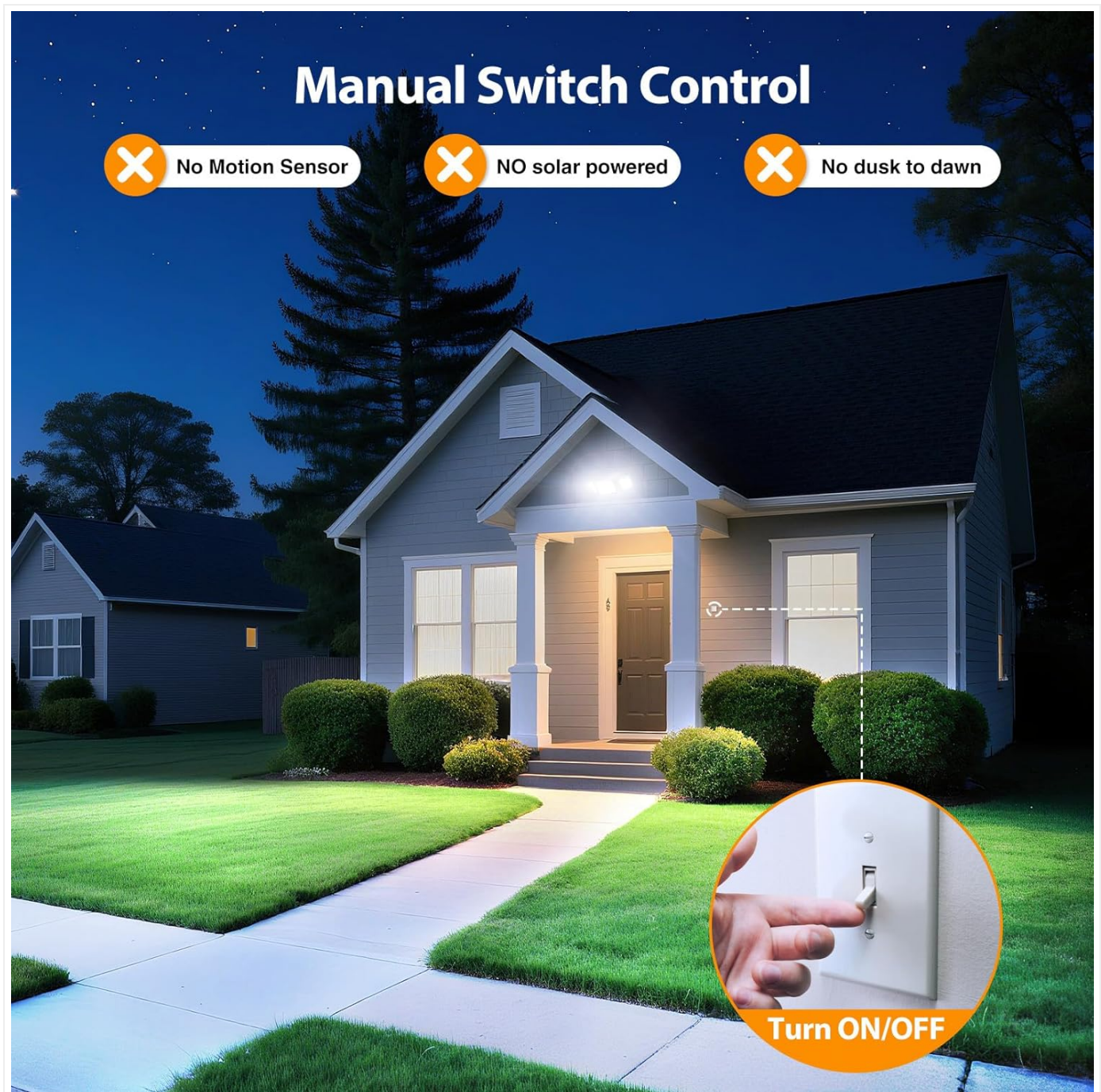
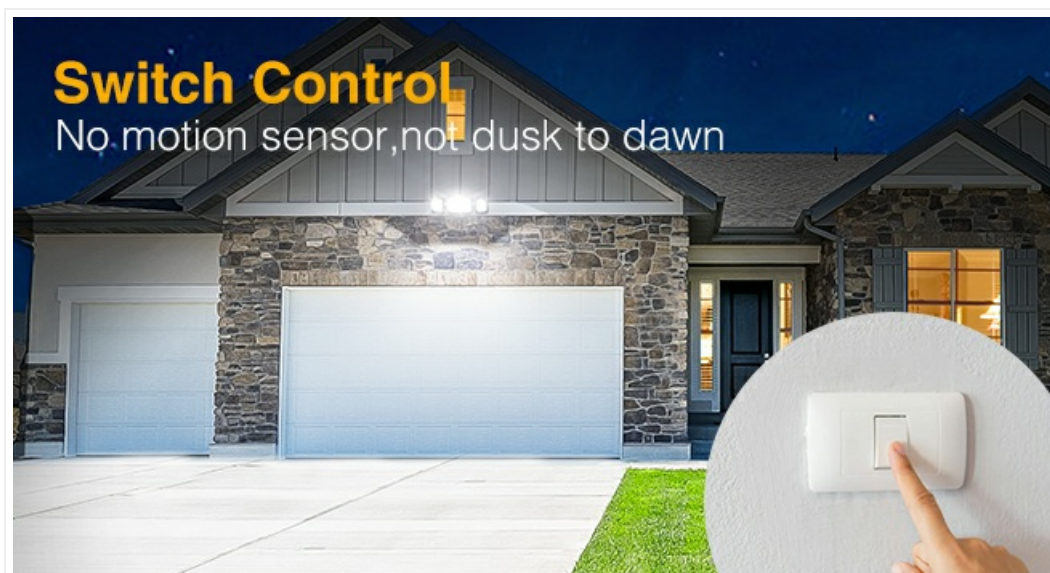

Image: A hand flipping a wall switch, demonstrating the manual control method for the flood light.





## MAINTENANCE

---

The Onforu 60W Flood Light is designed for durability and minimal maintenance. Its IP65 waterproof rating protects it from environmental elements, and the die-cast aluminum construction aids in efficient heat dissipation, contributing to a long lifespan.

### General Maintenance Tips:

- **Cleaning:** Periodically clean the surface of the light fixture with a soft, damp cloth to remove dirt, dust, or debris that may accumulate and affect light output. Do not use abrasive cleaners or solvents.
- **Inspection:** Annually inspect the mounting hardware and electrical connections for any signs of wear, corrosion, or loosening. Ensure the fixture remains securely attached.
- **Environmental Protection:** While IP65 rated, avoid directing high-pressure water jets directly at the fixture, especially at seals or electrical entry points.



Image: The flood light installed outdoors, with simulated rain, highlighting its IP65 waterproof capability.

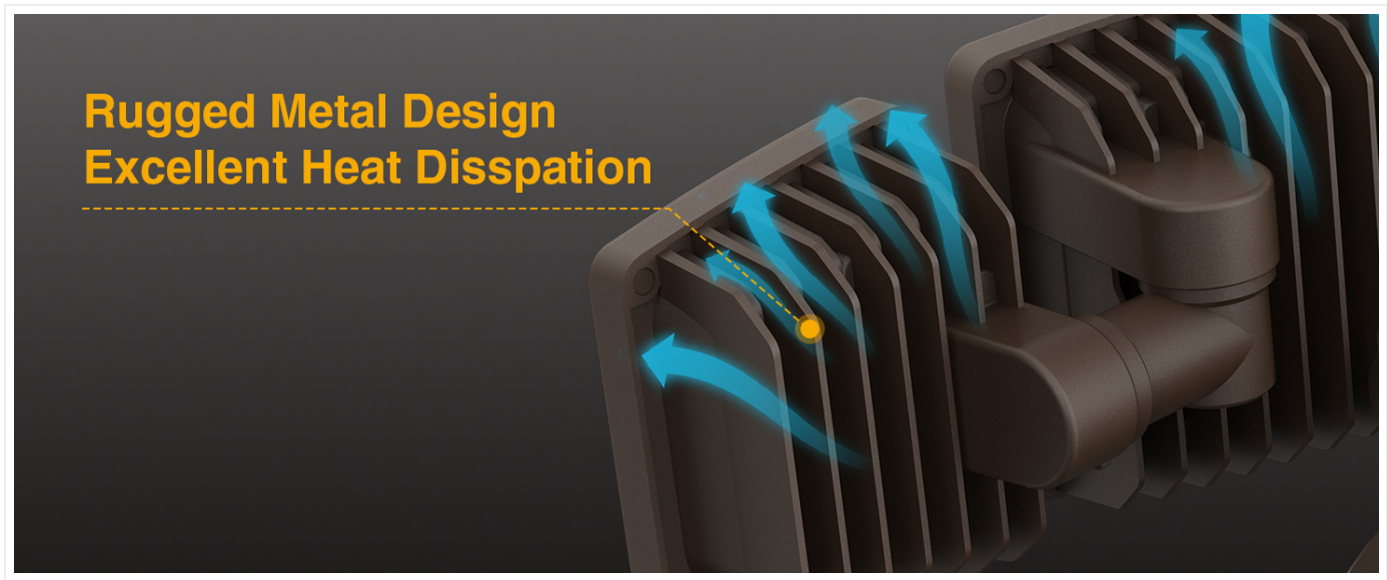

Image: Close-up diagram illustrating the rugged metal design and heat dissipation fins, which contribute to the light's longevity.

## TROUBLESHOOTING

If you encounter issues with your Onforu 60W Flood Light, please refer to the following common troubleshooting steps before contacting support.

| Problem                 | Possible Cause  | Solution   |
|-------------------------|---|--|
| Light does not turn ON. | No power to the fixture.<br>Loose wiring connection.<br>Faulty wall switch.                         | Check the circuit breaker and ensure it is ON.<br>Verify all wire connections are secure (ensure power is OFF before checking).<br>Test the wall switch with another device or consult an electrician. |
| Light flickers or dims. | Unstable power supply.<br>Loose wiring.<br>Incompatible dimmer switch (this light is not dimmable). | Ensure stable power supply.<br>Check and secure all wiring connections.<br>If a dimmer switch is installed, replace it with a standard ON/OFF switch.  |
| Reduced brightness.     | Accumulation of dirt or debris on the lens.   | Clean the light's lens and housing with a soft, damp cloth.  |

If the problem persists after attempting these solutions, please contact Onforu customer support.

## WARRANTY AND SUPPORT

### Warranty Information:

This Onforu 60W Flood Light comes with a **2-year warranty** from the date of purchase. Please retain your proof of purchase for warranty claims.

### Customer Support:

For technical assistance, warranty claims, or any other inquiries, please visit the official Onforu store or contact their





customer service directly.  
[Visit the Onforu Store on Amazon](#)

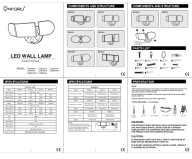
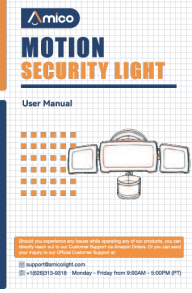

© 2024 Onforu. All rights reserved.  
This manual is for informational purposes only. Specifications are subject to change without notice.

Related Documents - BDB60-3

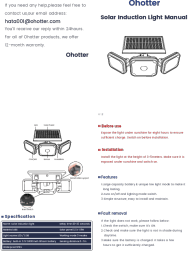
|   |  |
|---|--|
|    | <p><a href="#">Solar Motion Sensor Light Manual - TG-TY07301</a></p> <p>Comprehensive manual for the TG-TY07301 Solar Motion Sensor Light, detailing specifications, installation, features, light modes, and troubleshooting for optimal outdoor lighting. Features 218 LEDs, 3 modes, IP65 waterproof rating, and adjustable wide angle.</p>   |
|    | <p><a href="#">Onforu LED Wall Lamp Product Manual - Specifications, Components, and Installation Guide</a></p> <p>Comprehensive product manual for Onforu LED Wall Lamps, detailing specifications, components, parts list, dimensions, preparation, and installation steps for various models including BDB60-3, BDC80-3, and BDB100-3. Includes safety warnings and manufacturer information.</p> |
|  | <p><a href="#">Amico 3-Head LED Security Light Installation Manual</a></p> <p>Installation guide for the Amico 3-Head LED Security Light with Motion Sensor, featuring adjustable flood light, 40W, 4000LM, 5000K, and IP65 waterproof rating for outdoor use.</p>   |
|  | <p><a href="#">ONFORU PIR LED Wall Lights with Motion Sensor - BDB55G-3, BDB100G-3</a></p> <p>Detailed specifications, parts list, installation guide, and troubleshooting for ONFORU PIR LED Wall Lights with Motion Sensor, models BDB55G-3 and BDB100G-3. Features include motion sensing, adjustable settings, and wet location suitability.</p>   |
|  | <p><a href="#">Solar Powered Security Light User Manual</a></p> <p>This document provides instructions and information for the solar-powered security light, including installation, mode selection, care, and warranty details.</p>   |
|  | <p><a href="#">Ohotter Solar Induction Light Manual V1.2 - Outdoor Motion Sensor Security Light</a></p> <p>User manual for the Ohotter Solar Induction Light (V1.2), detailing features, specifications, installation, and troubleshooting for this IP65 waterproof motion-activated outdoor security light.</p>   |

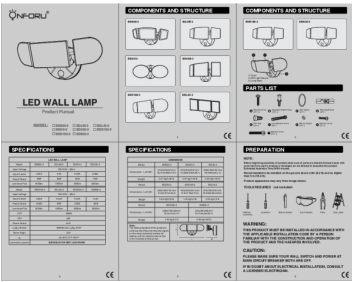

[Onforu LED Wall Lamp Product Manual - Specifications, Components, and Installation Guide](#)

Comprehensive product manual for Onforu LED Wall Lamps, detailing specifications, components, parts list, dimensions, preparation, and installation steps for various models including BDB60-3, BDC80-3, and BDB100-3. Includes safety warnings and manufacturer information.

lang:en score:19 filesize: 4.36 M page\_count: 2 document date: 2024-09-09