

Manuals+

[Q & A](#) | [Deep Search](#) | [Upload](#)

[manuals.plus](#) /

- › [lesolar](#) /
- › [lesolar Outdoor Retractable Car Side Awning User Manual](#)

lesolar GM132

lesolar Outdoor Retractable Car Side Awning User Manual

Model: GM132

INTRODUCTION

Thank you for choosing the lesolar Outdoor Retractable Car Side Awning. This manual provides essential information for the safe and effective use, installation, and maintenance of your awning. Please read it thoroughly before initial use and retain it for future reference.



Image: The lesolar car side awning providing shade for users by a vehicle on a sandy beach.

SAFETY INFORMATION

WARNING: Failure to follow these safety instructions may result in injury or damage to the product.

- Always check weather conditions before using the awning. Do not deploy in strong winds, heavy rain, or thunderstorms.
- Ensure the awning is properly secured to the vehicle and ground to prevent it from becoming a hazard in windy conditions. Use all provided tie-downs and stakes.
- Be cautious when setting up and taking down the awning to avoid injury from moving parts.
- Be aware of the awning's weight, especially when fully extended. Avoid placing excessive weight on the awning structure.
- Keep children and pets away from the awning during setup and takedown.
- Do not use the awning near open flames or heat sources.
- Inspect all components for damage before each use. Do not use if any parts are damaged or missing.

PRODUCT FEATURES

- **Heavy-Duty Structure:** Constructed from durable metal and 420D waterproof Oxford cloth, designed for outdoor camping and overlanding.
- **Extended Coverage:** Measures 8.2 ft (L) x 6.6 ft (W), with included 6.6 ft front wall extensions and 8.2 ft side wall extensions for additional wind and rain protection.
- **Easy Installation:** Designed for quick setup on most roof racks. Features horizontal and vertical bars for space-saving and versatile wall creation.
- **Versatile Application:** Suitable for various vehicles including SUVs, cars, trucks, and vans, providing shade and shelter for campers and outdoor enthusiasts.
- **Waterproof and UV Protection:** Features PU2000mm waterproof rating and UV30+ protection to keep you dry and shielded from the sun.



Image: Detail of the waterproof Oxford cloth material, showing water resistance.



Image: Detail of the strong Velcro fixing points for attaching walls and securing the awning.



Image: Close-up view of the widened metal base plate, enhancing wind resistance and overall stability.

PACKAGE CONTENTS

Please check the package carefully upon receipt to ensure all components are present. The accessory parts are scattered in the package to reduce volume.

- Awning Unit (Main Fabric and Frame)
- Mounting Brackets
- Covers
- Nuts / Bolts
- Tie-downs (Ropes)
- Stakes (Ground Pegs)
- Wrenches (for assembly)
- Waterproof Handbag (Storage Bag)
- Front Wall Extension (6.6 ft)
- Side Wall Extension (8.2 ft)

SETUP AND INSTALLATION

The lesolar car side awning is designed for easy installation on most vehicle roof racks. It is recommended to have two people for initial setup.

Mounting to Vehicle Roof Rack

1. Identify suitable mounting points on your vehicle's roof rack. Ensure the rack is sturdy enough to support the awning's weight.
2. Attach the mounting brackets to the awning's frame using the provided nuts and bolts. Refer to diagram A and B in the installation guide image.
3. Position the awning on the roof rack. Align the brackets with the roof rack bars.
4. Secure the awning to the roof rack using the remaining nuts and bolts. Ensure all connections are tight and secure. Refer to diagram C, D, and E in the installation guide image.
5. Once mounted, ensure the awning is stable and does not wobble.

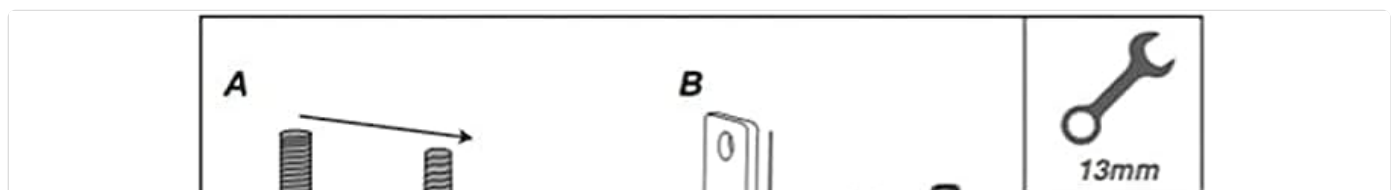

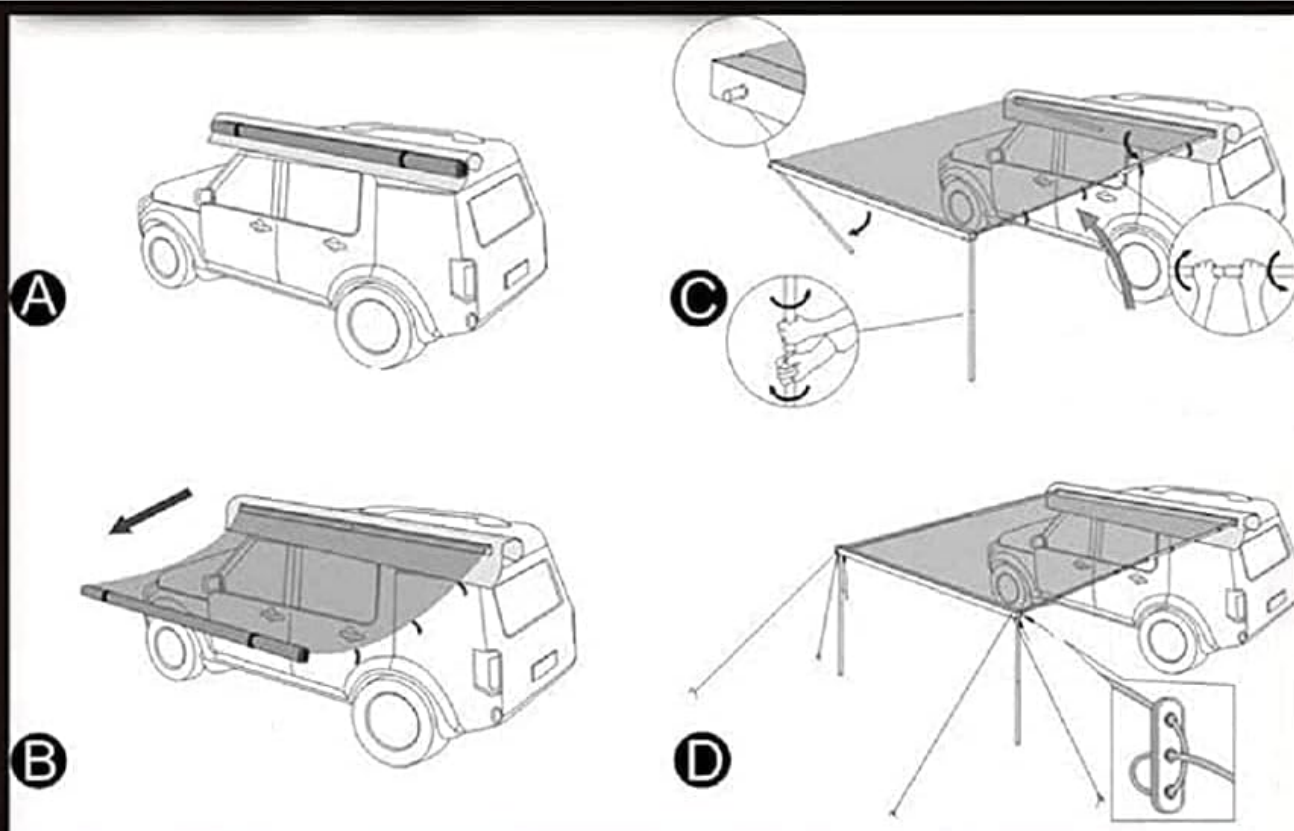
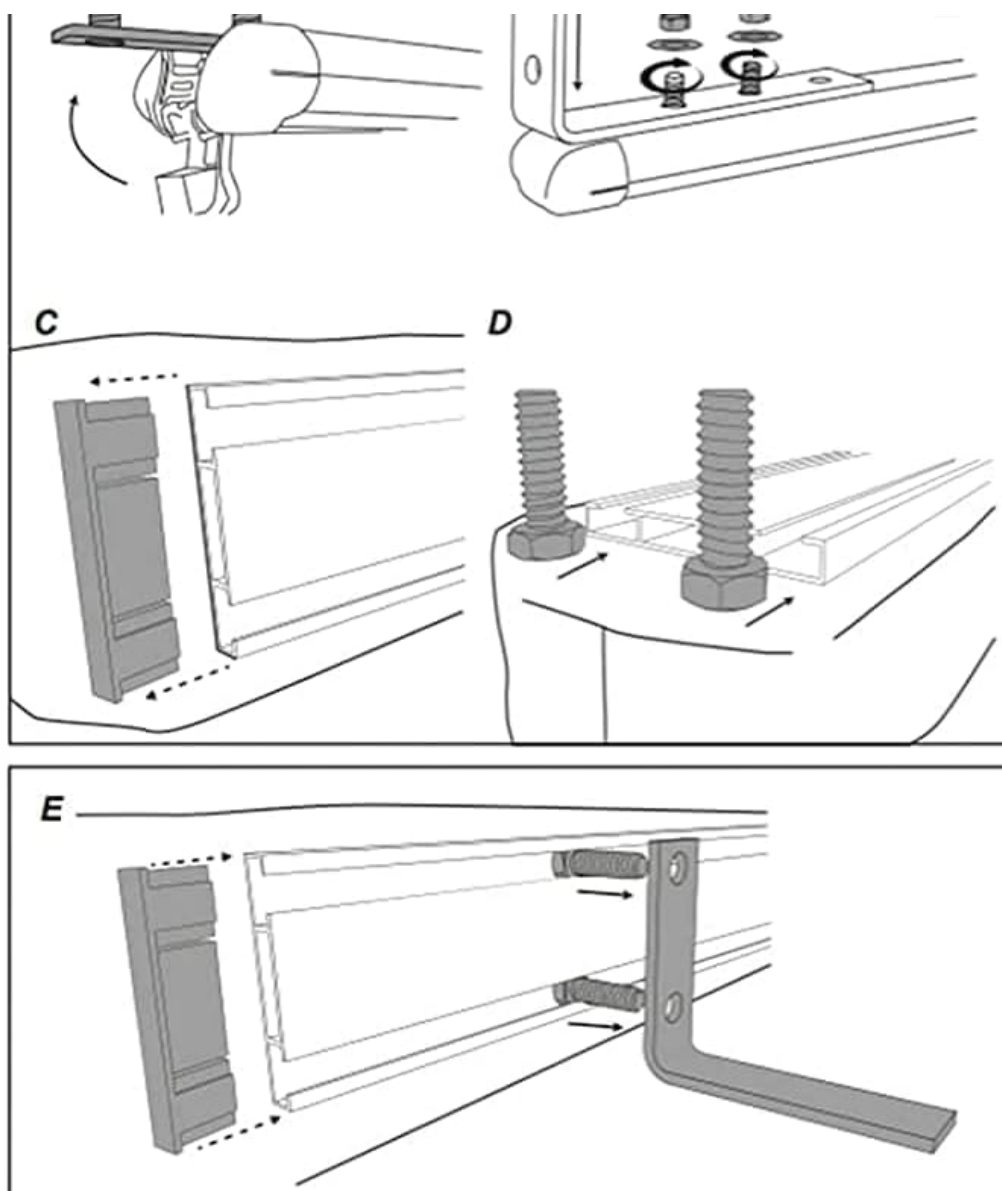

Image: Detailed diagrams illustrating the process of attaching the awning to a vehicle's roof rack.

Deploying the Awning

1. Unzip the awning cover.
2. Pull the awning fabric outwards from its casing. The support poles will extend as you pull.
3. Extend the vertical support poles to the desired height. Ensure they are securely locked in place.
4. Extend the horizontal support bars to create the canopy structure.
5. Secure the awning to the ground using the provided tie-downs and stakes. Attach ropes to the designated eyelets on the awning fabric and secure them to the ground with stakes.
6. If using, attach the front and side wall extensions using the Velcro fixings.

Your browser does not support the video tag.

Video: A demonstration of the lesolar car side awning setup process, showing how to extend the awning and secure it with poles and tie-downs.



Image: The lesolar awning fully deployed, providing a shaded area for outdoor activities next to a vehicle.

OPERATING INSTRUCTIONS

Once installed and deployed, the lesolar car side awning provides a versatile shelter. Here are some operational guidelines:

- **Adjusting Height:** The vertical support poles are adjustable. Loosen the locking mechanism, extend or retract the pole to the desired height, and then securely lock it in place.

- **Attaching Walls:** The front and side wall extensions can be attached using the integrated Velcro strips. This allows for increased privacy and protection from wind or sun.
- **Securing in Wind:** Always use all tie-downs and stakes, even in light breezes. For stronger winds, consider additional guy ropes and heavier stakes (not included). Never use in severe weather.
- **Retracting the Awning:** Reverse the deployment steps. Collapse the poles, detach tie-downs, and carefully retract the fabric back into its casing. Ensure the fabric is clean and dry before storage to prevent mold.

MAINTENANCE

Proper maintenance will extend the life of your lesolar car side awning.

- **Cleaning:** Clean the fabric with mild soap and water. Do not use harsh chemicals or abrasive cleaners. Rinse thoroughly and allow to air dry completely before packing away.
- **Drying:** Always ensure the awning fabric is completely dry before retracting and storing it. Storing a damp awning can lead to mold, mildew, and fabric degradation.
- **Frame Inspection:** Regularly inspect the metal frame, poles, and joints for any signs of damage, corrosion, or loose connections. Tighten any loose bolts.
- **Storage:** Store the awning in its waterproof handbag in a cool, dry place away from direct sunlight when not in use.
- **Fabric Care:** Avoid prolonged exposure to extreme weather conditions when not in use. While durable, continuous exposure to harsh UV rays or heavy precipitation can shorten its lifespan.

TROUBLESHOOTING

| Problem | Possible Cause | Solution |
|--|---|--|
| Awning is unstable or wobbly. | Loose mounting, insufficient ground securing, strong winds. | Ensure all mounting bolts are tightened. Use all tie-downs and stakes. Add extra guy ropes if needed. Retract in strong winds. |
| Poles do not extend or retract smoothly. | Dirt or debris in pole mechanisms, bent poles. | Clean poles and mechanisms. Check for bends; replace if severely damaged. |
| Fabric is difficult to retract. | Fabric not aligned, poles not fully collapsed. | Ensure fabric is guided evenly into the casing. Confirm all poles are fully collapsed before attempting to retract. |
| Water pooling on awning fabric. | Insufficient slope, heavy rain. | Adjust pole heights to create a sufficient slope for water runoff. Retract in very heavy rain. |

SPECIFICATIONS

| Attribute | Detail |
|--------------------|--|
| Model Number | GM132 |
| Product Dimensions | 7"D x 98"W x 4"H (Packed) |
| Awning Shade Area | 8.2 ft (L) x 6.6 ft (W) |
| Material | Metal, 420D Oxford Cloth (PU2000mm waterproof) |

| Attribute | Detail |
|-------------------|-------------------------------------|
| Color | Black (Frame), Beige/Brown (Fabric) |
| UV Protection | UV30+ |
| Item Weight | 28.4 pounds |
| Assembly Required | Yes |
| Operation Mode | Manual |



Quality Oxford cloth

Fine workmanship, water resistance, no heat absorption, strong and durable

Velcro fixing

Strong adhesion and durability

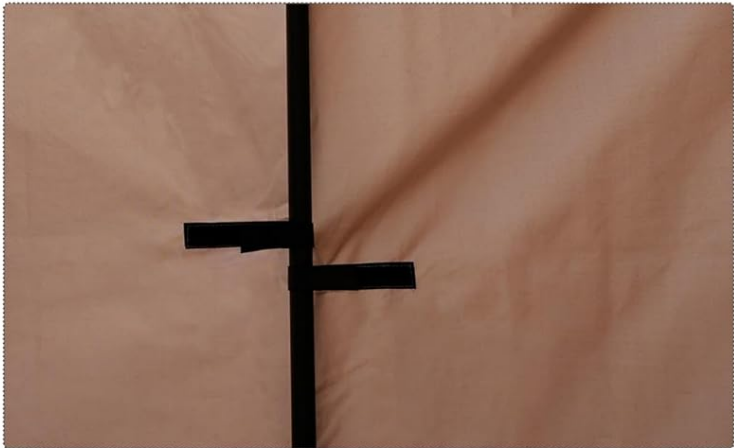

Solid Structure

The base metal plate is widened, which greatly increases the wind resistance

Image: Visual representation of the awning's dimensions, including length, width, and adjustable height range.

WARRANTY AND SUPPORT

For warranty information, product support, or to purchase replacement parts, please visit the official lesolar store or

contact customer service.

[Visit the lesolar Store on Amazon](#)

Lesolar is committed to developing simple and practical products, creating a relaxed and comfortable living atmosphere, and enhancing customer happiness. We adhere to the customer-oriented concept, continuously innovate products, and improve product quality and performance. We always listen to customers' voices and provide reliable after-sales service.

Related Documents - GM132

RO Membrane Housing User Manual

1 Form parameters and process parameters

The diagram shows two long, thin, dark-colored membrane housings. Below them is a table with columns for Model, A, SA, SA, A, and A. The table contains data for Model 4040, with values 100%, 100%, 100%, 100%, and 100% respectively. To the right of the table is a list of notes: Note 1: For more information, please refer to the RO Membrane Housing User Manual. Note 2: RO Membrane Housing is a registered trademark of Lesolar.

| Model | A | SA | SA | A | A |
|-------|------|------|------|------|------|
| 4040 | 100% | 100% | 100% | 100% | 100% |

Notes:

1. For more information, please refer to the RO Membrane Housing User Manual.

2. RO Membrane Housing is a registered trademark of Lesolar.

2 RO Membrane Housing use method and precautions

[RO Membrane Housing User Manual - Specifications and Usage Guide](#)

User manual for lesolar RO Membrane Housing, detailing form parameters, process parameters, material specifications, and usage methods. Includes model 4040 specifications and safety precautions for reverse osmosis systems.

RO Membrane Housing User Manual

1 Form parameters and process parameters

The diagram shows two long, thin, dark-colored membrane housings. Below them is a table with columns for Model, A, SA, SA, A, and A. The table contains data for Model 4040, with values 100%, 100%, 100%, 100%, and 100% respectively. To the right of the table is a list of notes: Note 1: For more information, please refer to the RO Membrane Housing User Manual. Note 2: RO Membrane Housing is a registered trademark of Lesolar.

| Model | A | SA | SA | A | A |
|-------|------|------|------|------|------|
| 4040 | 100% | 100% | 100% | 100% | 100% |

Notes:

1. For more information, please refer to the RO Membrane Housing User Manual.

2. RO Membrane Housing is a registered trademark of Lesolar.

2 RO Membrane Housing use method and precautions

[RO Membrane Housing User Manual - Specifications and Usage Guide](#)

User manual for lesolar RO Membrane Housing, detailing form parameters, process parameters, material specifications, and usage methods. Includes model 4040 specifications and safety precautions for reverse osmosis systems.