

VOVO TCB-8100W

VOVO STYLEMENT TCB-8100W Smart Bidet Toilet User Manual

Model: TCB-8100W

INTRODUCTION

This user manual provides detailed instructions for the installation, operation, and maintenance of your VOVO STYLEMENT TCB-8100W Smart Bidet Toilet. Please read this manual thoroughly before installation and use to ensure proper function and safety. This smart bidet toilet features an automatic dual flush system, wireless remote control, heated seat, warm water wash, air dryer, and an automatic deodorization system, all designed for enhanced hygiene and comfort.



Figure 1: VOVO STYLEMENT TCB-8100W Smart Bidet Toilet, an elongated one-piece toilet with a sleek design.

SAFETY INFORMATION

Always adhere to the following safety precautions to prevent injury or damage to the product:

- Ensure the toilet is installed by a qualified professional in accordance with local plumbing and electrical codes.
- Do not expose the electrical components to water or excessive moisture.
- Unplug the unit from the power outlet before performing any maintenance or cleaning.
- Do not attempt to repair or disassemble the unit yourself. Contact qualified service personnel for assistance.
- Keep children and individuals with reduced physical, sensory, or mental capabilities away from the unit unless supervised.
- Ensure the power outlet meets the specified voltage and current requirements.

PRODUCT OVERVIEW

The VOVO STYLEMENT TCB-8100W is designed with advanced features for optimal comfort and hygiene.

Key Features:

- **Automatic Dual Flush:** A smart seat sensor detects user presence and duration to automatically select between a small or full flush (1.12 GPF / For 35 PSI), providing hands-free operation.
- **Wireless Remote Controller:** Manage all functions including posterior, feminine, and turbo wash, as well as automatic deodorization, from a convenient wireless remote.
- **Tankless Flushing System:** The Tornado wash system powerfully cleans the inner bowl using a direct water supply, eliminating stale water.
- **Heated Seat:** The seat is optimized for comfort with adjustable temperature settings.
- **Warm Dryer & Water:** Features a water heating system for warm water wash and a built-in air dryer with 3 adjustable temperatures.
- **Automatic Deodorization:** An integrated system provides automatic deodorization to remove unpleasant odors.
- **Night Light:** A subtle night light illuminates the bowl for convenience in low-light conditions.
- **3-in-1 Full Stainless Steel Nozzle:** Offers posterior, feminine, and turbo wash functions.
- **Self-Cleaning Nozzle:** The nozzle automatically cleans itself before and after each use.

AUTO FLUSHING

Differentiates large and small flushes through detecting the time the user has been seated. (1.12 GPF / For 35 PSI)



Figure 2: Illustration of the automatic dual flush system, which differentiates between large and small flushes based on user detection.

SOFT CLOSE

No Slam !

Seat and Seat cover with
soft close function for safety



Figure 3: The soft-close function of the seat and seat cover, preventing slamming and ensuring safety.



Figure 4: Visual representation of the heated seat, warm air dryer, and automatic deodorization features.



Figure 5: Diagram showing the 3-in-1 full stainless steel nozzle for posterior, feminine, and turbo wash, along with its self-cleaning mechanism.

SETUP AND INSTALLATION

Proper installation is crucial for the optimal performance and longevity of your smart bidet toilet. It is highly recommended to have this unit installed by a licensed plumber and electrician.

Pre-Installation Checklist:

- Verify that the product dimensions (25.9"D x 15.5"W x 21.4"H) are suitable for your bathroom space.
- Ensure a standard 120V AC electrical outlet is available near the toilet location.
- Confirm water supply pressure is adequate (minimum 35 PSI recommended for optimal flush).
- Gather necessary tools: adjustable wrench, screwdriver, measuring tape.

Installation Steps:

1. **Prepare the Area:** Turn off the water supply to the existing toilet and flush to empty the tank. Disconnect the water supply line and remove the old toilet. Clean the flange area thoroughly.



Figure 6: Diagram illustrating the standard installation process, including water valve connection.

2. **Install the Mounting Hardware:** Place the new wax ring and secure the mounting bolts to the floor flange.
3. **Position the Toilet:** Carefully lower the VOVO STYLEMENT TCB-8100W onto the mounting bolts, ensuring it is level and stable. Tighten the nuts securely.



Figure 7: An exploded view showing the internal components and how they connect during installation.

4. **Connect Water Supply:** Connect the flexible water supply hose from the toilet to the water shut-off valve. Ensure all connections are tight to prevent leaks.



Figure 8: Close-up of connecting the water supply line to the toilet's water valve.

5. **Connect Power:** Plug the power cord into a grounded 120V AC electrical outlet.



Figure 9: Illustration of plugging the toilet's power cord into a standard electrical outlet.

6. **Test Functionality:** Turn on the water supply. Check for leaks. Allow the toilet to fill and perform a test flush. Verify all smart features are operational.

GETTING READY TO INSTALL

Please check if the product is within the dimensions below.



**OUTLET
REQUIRED**

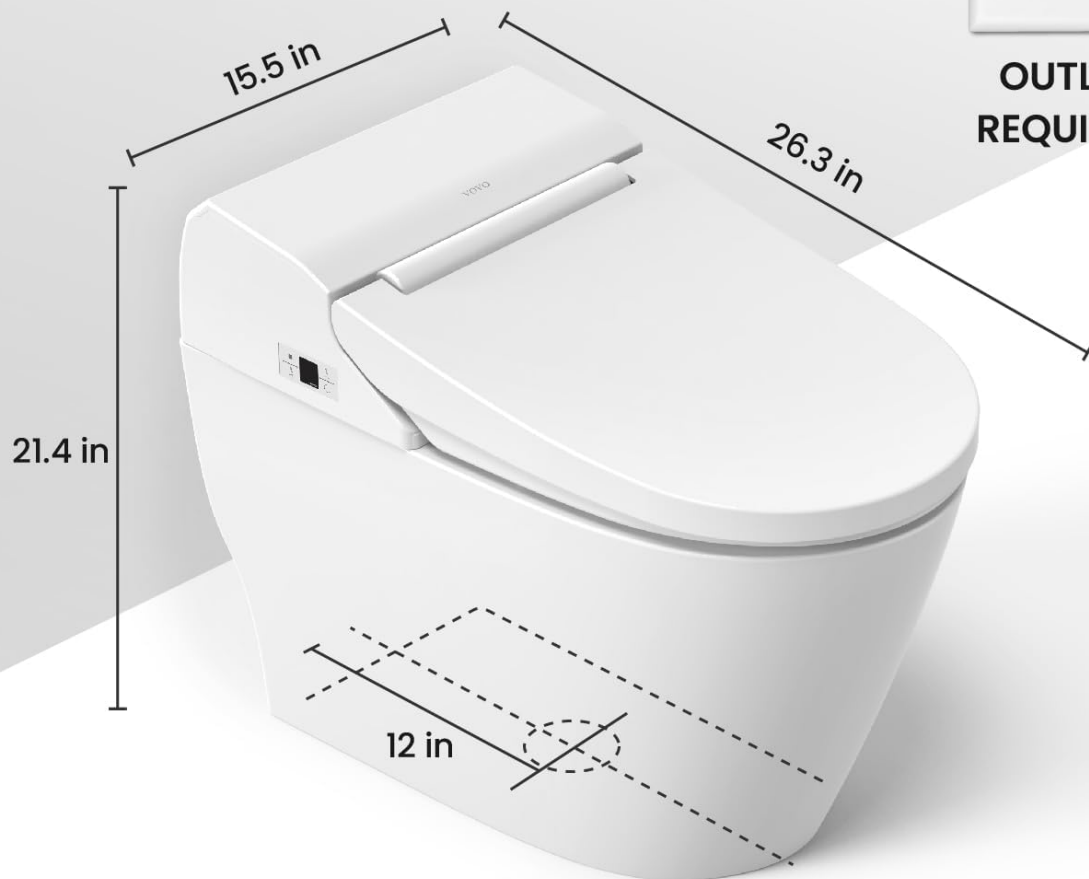

Figure 10: Important dimensions for installation and a reminder that an electrical outlet is required.

OPERATING INSTRUCTIONS

Your VOVO STYLEMENT TCB-8100W Smart Bidet Toilet offers intuitive controls for a personalized experience.

Automatic Lid Opening:

The lid automatically opens when a user approaches the toilet, thanks to the integrated sensor at the base.

Wireless Remote Control:

The primary control for all advanced functions is the wireless remote. Familiarize yourself with the button layout for optimal use.

REMOTE CONTROLLER

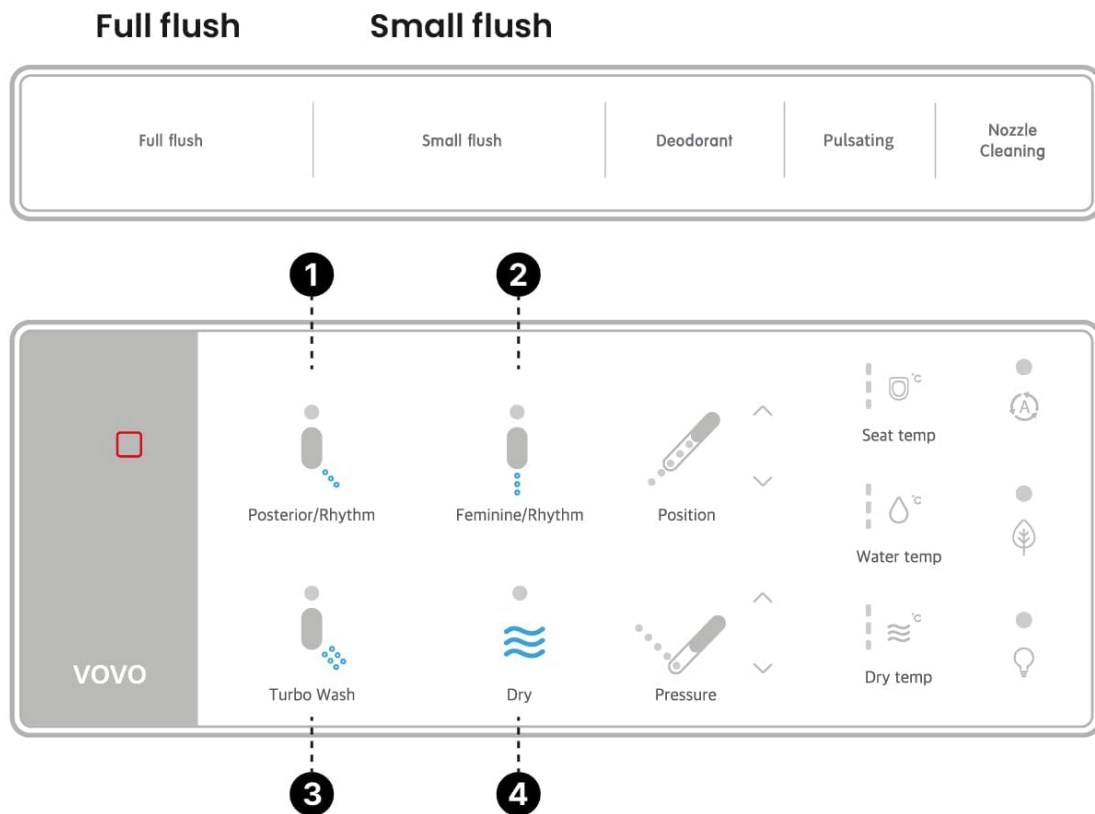

1 Posterior

Press the Feminine button to operate.

2 Feminine

Press the Feminine button to operate.

3 TURBO WASH Technology

Water pressure can be adjusted while the function is under operation.

4 Dryer

Use the dry function after using the posterior.

Figure 11: Detailed layout of the wireless remote controller, showing buttons for various functions like flush, wash modes, temperature, and pressure adjustments.

Wash Functions:

- **Posterior Wash:** Press the "Posterior/Rhythm" button for a thorough posterior cleanse.
- **Feminine Wash:** Press the "Feminine/Rhythm" button for a gentle feminine wash.
- **Turbo Wash:** Activate the "Turbo Wash" function for a stronger, more focused spray.
- **Water Pressure Adjustment:** Use the "Pressure" up/down arrows on the remote to adjust the water intensity.
- **Nozzle Position Adjustment:** Adjust the nozzle's position using the "Position" up/down arrows for precise cleaning.
- **Water Temperature Adjustment:** Select your preferred water temperature using the "Water temp" controls.

Drying and Deodorization:

- **Warm Air Dryer:** After washing, press the "Dry" button to activate the warm air dryer. Adjust the air temperature using the "Dry temp" controls.
- **Automatic Deodorization:** The deodorization system activates automatically to neutralize odors.

Other Functions:

- **Heated Seat:** The seat temperature can be adjusted using the "Seat temp" controls on the remote.
- **Night Light:** The integrated night light provides soft illumination.
- **Automatic Flush:** The toilet automatically flushes after use, with dual flush options based on usage duration.

MAINTENANCE

Regular cleaning and maintenance will ensure the longevity and hygienic operation of your smart bidet toilet.

General Cleaning:

- Always unplug the toilet from the power outlet before cleaning.
- Use a soft, damp cloth and a mild, non-abrasive cleaner to wipe down the exterior surfaces.
- Do not use harsh chemicals, abrasive cleaners, or scrub brushes, as these can damage the finish.

Nozzle Cleaning:

- The nozzle has a self-cleaning function that activates before and after each use.
- For manual cleaning, extend the nozzle using the remote control (refer to operating instructions) and gently wipe it with a soft cloth and mild soap. Do not force the nozzle.

Filter Maintenance:

- Periodically check the water inlet filter for any debris. Clean if necessary by turning off the water supply, disconnecting the hose, and rinsing the filter under running water.

TROUBLESHOOTING

If you encounter issues with your VOVO STYLEMENT TCB-8100W, refer to the following common problems and solutions:

Problem	Possible Cause	Solution
No power / Unit not turning on	Power cord unplugged; Circuit breaker tripped; Power outage.	Check power connection; Reset circuit breaker; Verify power supply.
No water spray / Weak spray	Water supply valve closed; Water inlet filter clogged; Low water pressure.	Open water supply valve; Clean water inlet filter; Ensure adequate water pressure (35 PSI minimum).
Heated seat not warming	Heated seat function off; Temperature setting too low.	Activate heated seat via remote; Increase temperature setting.
Deodorizer not working	Deodorizer function off.	Ensure deodorizer is enabled via remote.
Lid not opening automatically	Sensor obstructed or dirty; Sensor malfunction.	Clean sensor area; If problem persists, contact customer support.

If the problem persists after attempting these solutions, please contact customer support.

SPECIFICATIONS



Attribute	Detail
Brand	VOVO
Model Number	TCB-8100W
Color	White
Product Dimensions (D x W x H)	25.9" x 15.5" x 21.4"
Material	Stainless Steel (Nozzle), Polypropylene (Seat)
Item Weight	81.57 Pounds
Installation Type	Floor Mounted
Shape	Elongated
Flush Volume	1.12 GPF (Gallons Per Flush)
Minimum Water Pressure	35 PSI
Power Source	120V AC
Batteries Required	Yes (for remote control, included)



WARRANTY AND SUPPORT

For warranty information, product registration, or technical support, please contact VOVO customer service. Keep your purchase receipt as proof of purchase for warranty claims.

- **Manufacturer:** VOVO Corporation
- **Seller:** VOVO USA (via Amazon)
- **Contact Information:** Refer to the product packaging or the official VOVO website for the most current customer service contact details.
- **Protection Plans:** Extended protection plans may be available for purchase separately.

Related Documents - TCB-8100W

	<p>VOVO Bidet Checklist für externe Faktoren</p> <p>Checkliste zur Fehlerbehebung für VOVO Bidet-Modelle zur Überprüfung externer Faktoren, um Probleme zu identifizieren, bevor weitere Schritte unternommen werden.</p>
	<p>VOVO External Factor Checklist for Power Issues</p> <p>Troubleshooting guide for VOVO smart bidet toilets, covering common power-on issues, LED indicators, and reset procedures.</p>
	<p>VOVO Bidet External Factors Checklist for Power and Reset Issues</p> <p>A comprehensive checklist from VOVO to verify external factors and troubleshoot power or reset issues for VOVO bidet models including TCB 090SA, TCB 090S, TCB 8100B, TCB 8100W, TCB 8100N, PB-707S, and PB-101S.</p>

<div><div><div><div>VOVO</div><div>Model no. TCB-8200SA</div><div>For use in the US market only</div></div></div><div><div>Features</div><div><ul style="list-style-type: none">Auto Bidet Spray JetAuto Wash, Rinse & DryAuto Dry Warm AirAuto Bidet Spray JetAuto Wash, Rinse & DryAuto Dry Warm AirAuto Bidet Spray JetAuto Wash, Rinse & DryAuto Dry Warm Air</div></div><div><div>Technical Information</div><div><ul style="list-style-type: none">Auto Bidet Spray JetAuto Wash, Rinse & DryAuto Dry Warm AirAuto Bidet Spray JetAuto Wash, Rinse & DryAuto Dry Warm AirAuto Bidet Spray JetAuto Wash, Rinse & DryAuto Dry Warm Air</div></div><div><div>Notes</div><div><p>This product is designed for installation in the following locations:</p><ul style="list-style-type: none">Indoor use onlyIndoor use onlyIndoor use onlyIndoor use onlyIndoor use onlyIndoor use onlyIndoor use onlyIndoor use onlyIndoor use only</div></div><div><div>Included Components</div><div><ul style="list-style-type: none">Auto Bidet Spray JetAuto Wash, Rinse & DryAuto Dry Warm AirAuto Bidet Spray JetAuto Wash, Rinse & DryAuto Dry Warm AirAuto Bidet Spray JetAuto Wash, Rinse & DryAuto Dry Warm Air</div></div><div><div>Required Electrical Service</div><div><ul style="list-style-type: none">Auto Bidet Spray JetAuto Wash, Rinse & DryAuto Dry Warm AirAuto Bidet Spray JetAuto Wash, Rinse & DryAuto Dry Warm AirAuto Bidet Spray JetAuto Wash, Rinse & DryAuto Dry Warm Air</div></div></div>	<div><h3>VOVO TCB-8200SA Smart Bidet Toilet: Features & Specifications</h3><p>Explore the VOVO TCB-8200SA, a one-piece floor-mount smart bidet toilet. Discover its features, technical specifications, included components, and installation notes.</p></div>
<div><div><div><div>VOVO</div><div>Model no. TCB-090SA</div><div>For use in the US market only</div></div></div><div><div>Checklist for external factors</div><div><ul style="list-style-type: none">Auto Bidet Spray JetAuto Wash, Rinse & DryAuto Dry Warm AirAuto Bidet Spray JetAuto Wash, Rinse & DryAuto Dry Warm AirAuto Bidet Spray JetAuto Wash, Rinse & DryAuto Dry Warm Air</div></div><div><div>Checklist for external factors</div><div><ul style="list-style-type: none">Auto Bidet Spray JetAuto Wash, Rinse & DryAuto Dry Warm AirAuto Bidet Spray JetAuto Wash, Rinse & DryAuto Dry Warm AirAuto Bidet Spray JetAuto Wash, Rinse & DryAuto Dry Warm Air</div></div></div>	<div><h3>VOVO Smart Bidet Toilettensitz Fehlerbehebung: Externe Faktoren und Geruchsneutralisierer</h3><p>Ein prägnanter Leitfaden zur Fehlerbehebung bei gängigen Problemen mit VOVO Smart Bidet Toilettensitzen, der sich auf externe Faktoren, Strom-Neustarts und Geruchsneutralisierer-Einstellungen für Modelle wie TCB-090SA und TCB-9100GA konzentriert.</p></div>
<div><div><div><div>VOVO</div><div>Model no. TCB-9100GA</div><div>For use in the US market only</div></div></div><div><div>Checklist for external factors</div><div><ul style="list-style-type: none">Auto Bidet Spray JetAuto Wash, Rinse & DryAuto Dry Warm AirAuto Bidet Spray JetAuto Wash, Rinse & DryAuto Dry Warm AirAuto Bidet Spray JetAuto Wash, Rinse & DryAuto Dry Warm Air</div></div><div><div>Checklist for external factors</div><div><ul style="list-style-type: none">Auto Bidet Spray JetAuto Wash, Rinse & DryAuto Dry Warm AirAuto Bidet Spray JetAuto Wash, Rinse & DryAuto Dry Warm AirAuto Bidet Spray JetAuto Wash, Rinse & DryAuto Dry Warm Air</div></div></div>	<div><h3>VOVO Bidet Toilet Nozzle Replacement and Maintenance Guide</h3><p>Detailed instructions for VOVO bidet toilet nozzle replacement, internal checks, and assembly procedures. Learn how to maintain your VOVO bidet.</p></div>