

## Wuloo S600-P3

# Wuloo Wireless Intercom System User Manual

Model: S600-P3

Hands-Free Two Way Intercoms for Home and Business

## 1. PRODUCT OVERVIEW

The Wuloo Wireless Intercom System (Model S600-P3) is an upgraded, full-duplex, hands-free communication solution designed for homes and businesses. This system offers clear voice quality, an extended signal range of up to 1 mile, and low power consumption. It is engineered for ease of use and reliable performance, providing seamless room-to-room communication without the need for Wi-Fi.

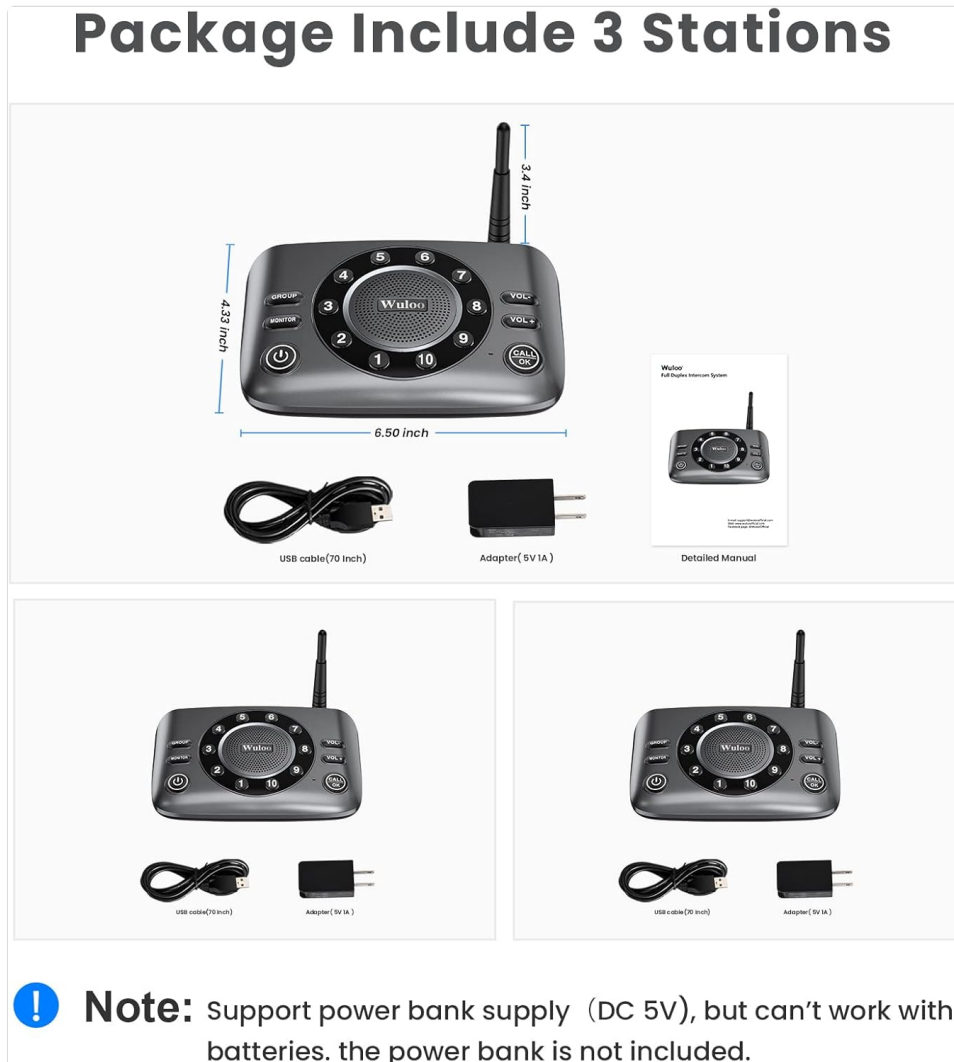

Image: Three Wuloo wireless intercom units, showcasing their compact design and user interface.

## 2. PACKAGE CONTENTS

Upon opening the package, please verify that all the following items are included:

- Wuloo Hands-Free Wireless Intercom System Units: 3 units
- Power Cables: 3 cables
- Power Supplies (Input AC100-240V; Output DC5V): 3 units
- Detailed User Manual: 1 copy
- Quick Start Guide: 1 copy



*Image: Contents of the Wuloo intercom system package, illustrating the included units, cables, adapters, and manuals.*

## 3. KEY FEATURES

The Wuloo Wireless Intercom System incorporates several advanced features for enhanced communication:

- **Full Duplex Communication:** Allows for simultaneous two-way conversation, similar to a phone call.
- **Hands-Free Operation:** Enables communication without needing to press and hold a button during conversation.
- **Extended Range:** Offers a signal range of up to 1 mile (5280 ft) in open areas.
- **Superior Voice Quality:** Provides clear and crisp audio transmission.
- **Anti-Interference Technology:** Utilizes new technology to prevent eavesdropping and ensure private

conversations.

- **Expandable System:** Supports up to 10 intercom units within a single system.
- **Monitor Function:** Allows continuous monitoring of a specific unit with no time limit.
- **Adjustable Chimes & Volume:** Features 10 distinct chime types with adjustable chime and call volumes.
- **Flexible Installation:** Designed with wall mounts on the back for easy installation or can be placed on a desk.
- **Low Power Consumption:** Energy-efficient design.



*Image: Visual representation of the system's upgraded features, including improved voice quality and range.*

## 4. SETUP GUIDE

Follow these steps to quickly set up your Wuloo intercom system:

1. **Connect to AC Power:** Plug each intercom unit into a standard AC power outlet using the provided power cables and adapters.
2. **Set Code Number:** For each unit, press and hold the "CALL OK" button to enter the code setting mode. Use the "VOL+" or "VOL-" buttons to select a unique code number (1-10) for each unit. Press "CALL OK" again to confirm. Ensure each unit has a distinct code.
3. **Distribute Units:** Place the intercom units in desired locations throughout your home or business. Assign different units to different members or rooms as needed.
4. **Begin Communication:** Once powered and coded, the units are ready for hands-free communication.

### Note:

To ensure optimal voice clarity and avoid low volume, please keep the microphone 20-30 cm (8-12 inches) away from your mouth when speaking.

The intercom can also operate outdoors with a suitable power bank (not included).

## How to set intercom system quickly

Connect with AC power



Code Setting



**1st Step:**

Connect with AC power and Set the different code number for each unit. press&hold the code number button to set the code number for each unit.



**2nd Step:**

Distribute different unit to different member.



**3rd Step:**

Use this intercom system to communicate with each other hands free.

**Note:**  
To avoid the volume is too low to hear, please keep 20-30cm away from the microphone when you speaking.

Image: Quick setup guide for the Wuloo intercom system, detailing power connection and code assignment.

## 5. OPERATING INSTRUCTIONS

Familiarize yourself with the functions of each button on your Wuloo intercom unit:

## More Details



Image: Diagram illustrating the various buttons and their functions on the Wuloo intercom unit.

### • VOL+/- Buttons:

- When the intercom is ON, press VOL+/- to adjust the call volume.
- To set the chime type: Press and hold the VOL+ button for 3 seconds to enter "chimes setting" mode. Then, press VOL+/- to select the desired chime. Press "CALL OK" to confirm your choice.
- To set the chime volume: Press and hold the VOL- button for 3 seconds to enter "chime volume setting" mode. Then, press VOL+/- to adjust the chime volume. Press "CALL OK" to confirm your choice.

### • CALL OK Button:

- Press to initiate or end a call.
- In setting functions, press to confirm your selection.

### • GROUP Button:

- Press to broadcast a message to all other units in the system simultaneously.

### • MONITOR Button:

- Activates the monitoring function, allowing you to listen to another unit's environment. This function has no time limit.

### • Power Button:

- Press and hold to turn the unit ON or OFF.
- To restore factory settings (Channel 1, middle volume): When the intercom is OFF, press and hold the Power button and CALL button simultaneously. When the intercom is ON, press and hold the Power button and VOL- button simultaneously.

## 6. MAINTENANCE

To ensure the longevity and optimal performance of your Wuloo Wireless Intercom System, please follow these maintenance guidelines:

- **Cleaning:** Use a soft, dry cloth to clean the exterior of the units. Do not use abrasive cleaners, solvents, or strong chemicals, as these may damage the surface.
- **Power Supply:** Always use the original power adapters provided with the system. Ensure power cables are not bent, pinched, or placed under heavy objects.
- **Environment:** Avoid exposing the units to extreme temperatures, direct sunlight, high humidity, or dusty environments. Keep them away from water and other liquids.
- **Storage:** If storing the units for an extended period, disconnect them from power and store them in a cool, dry place.

## 7. TROUBLESHOOTING

If you encounter any issues with your Wuloo Wireless Intercom System, please refer to the following common troubleshooting steps:

Problem	Possible Cause	Solution
No power/Unit not turning on	Power cable not connected properly; Power outlet not working; Faulty adapter.	Check power cable connection. Try a different power outlet. Test with another adapter if available.
Poor voice quality/Static	Units too far apart; Obstructions between units; Interference from other devices.	Reduce distance between units. Relocate units to minimize obstructions. Move away from other electronic devices.
Cannot communicate with another unit	Incorrect code number set; Unit is off or out of range.	Verify that both units have the correct code number set. Ensure the target unit is powered on and within range.
Chime/Call volume too low/high	Volume settings are not adjusted correctly.	Use the VOL+/- buttons to adjust the chime and call volumes as described in the Operating Instructions.
Receiving random conversations	Interference from other wireless devices or systems.	The system has strong anti-interference capabilities. If this occurs, try changing the unit's code number or relocating the unit.

If the problem persists after trying these steps, please contact Wuloo customer support for further assistance.

## 8. SPECIFICATIONS

Attribute	Detail
Brand	Wuloo
Model Number	S600-P3
Color	3 units set

Attribute	Detail
Power Source	AC
Item Dimensions (L x W x H)	6.5 x 4.3 x 1.5 inches
Connectivity Technology	Wireless
Installation Type	Wall-Mounted or Desk Placement
Alert Type	Motion (Chime)
Item Weight	2.38 pounds (1.08 Kilograms)
Voltage	5 Volts
Control Method	Voice
Maximum Range	1 Mile (5280 ft)
Recommended Uses	Home Security, Home/Business Communication
Unit Count	3.0 Count
Batteries Included?	No
Batteries Required?	No

## 9. WARRANTY AND SUPPORT

Wuloo provides comprehensive support for its products:

- **Warranty:** This product comes with a 2-year warranty from the date of purchase.
- **Lifetime Service:** Wuloo offers lifetime service for the intercom system, ensuring ongoing support for any issues or questions you may have.
- **Contact Support:** For technical assistance, troubleshooting, or warranty claims, please refer to the contact information provided in your detailed user manual or visit the official Wuloo website.

© 2024 Wuloo. All rights reserved.

### Related Documents - S600-P3

	<p><a href="#">Wuloo Full Duplex Intercom System: Quick Start Guide</a></p> <p>This guide provides essential information for setting up and using the Wuloo Full Duplex Intercom System, including product overview, function details, and step-by-step instructions for wireless communication.</p>
---	--

 <p>Wuloo Full Duplex Intercom System</p> <p>Model: WL-666 Frequency: 450.000MHz Power: 5W</p>	<p><a href="#">Wuloo Full Duplex Intercom System User Manual</a></p> <p>This user manual provides comprehensive instructions for setting up, operating, and troubleshooting the Wuloo Full Duplex Intercom System. Learn about its features, advanced settings, and warranty information.</p>
	<p><a href="#">Wuloo Full Duplex Intercom System Quick Start Guide</a></p> <p>Quick start guide for the Wuloo Full Duplex Intercom System, covering product overview, function introduction, setup steps, and best service contact information.</p>
	<p><a href="#">Wuloo Wireless Intercom System Quick Start Guide</a></p> <p>This Quick Start Guide provides essential information for setting up and using the Wuloo Wireless Intercom System. It covers product overview, step-by-step setup instructions, channel and code configuration, multi-function usage, important notes, and feature introductions, ensuring efficient communication for home and business.</p>
	<p><a href="#">Wuloo Wireless Intercom System Quick Start Guide</a></p> <p>A quick start guide for the Wuloo Wireless Intercom System, detailing setup, channel and code setting, usage, and features for effective room-to-room communication.</p>
 <p>Wuloo Wireless Intercom System</p> <p>Model: WL-666 Frequency: 450.000MHz Power: 5W</p>	<p><a href="#">Wuloo WL-666 Wireless Intercom System User Manual</a></p> <p>A comprehensive user manual for the Wuloo WL-666 Wireless Intercom System. This guide covers setup, features like TALK, GROUP, MONITOR, VOX, and CALL, troubleshooting common issues, and warranty information.</p>

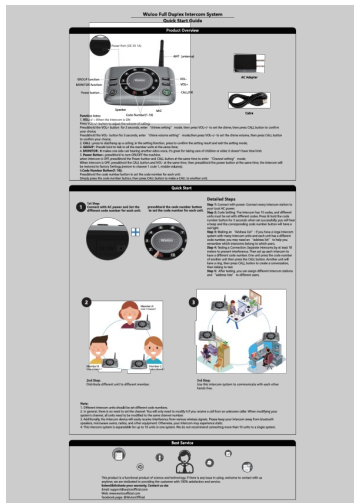

### [Wuloo Full Duplex Intercom System: Quick Start Guide](#)

This guide provides essential information for setting up and using the Wuloo Full Duplex Intercom System, including product overview, function details, and step-by-step instructions for wireless communication.

lang: score:27 filesize: 589.27 K page\_count: 1 document date: 2022-04-24