

Wuloo S600-P4

Wuloo S600 Wireless Intercom System User Manual

Model: S600-P4

1. INTRODUCTION

The Wuloo S600 Hands-Free Wireless Intercom System provides reliable two-way audio communication for homes and businesses. Designed for ease of use, this full-duplex system offers clear sound, an extended signal range, and anti-interference technology, making it ideal for communicating across rooms or between buildings.



This image displays four Wuloo S600 wireless intercom units, highlighting the multi-unit capability of the system.

2. PRODUCT FEATURES

- **New Upgraded Full Duplex System:** Offers true hands-free, two-way communication with improved voice quality.
- **Extended Signal Range:** Provides a long signal range of up to 1 mile (5280 ft), suitable for large homes or business properties.
- **Universal Power Adapter:** Equipped with a universal adapter supporting 100-240V AC power, allowing use in various regions.
- **Power Bank Compatibility:** Can be powered by a DC 5V 1A power bank (not included) for portable use.
- **Expandable System:** Supports up to 10 intercom units in a single system.
- **Anti-Interference Technology:** Utilizes new technology to prevent interference and ensure private conversations.
- **Adjustable Settings:** Features 10 types of chimes with adjustable volume, and adjustable call volume.
- **Monitor Function:** The MONITOR function has no time limit, allowing continuous monitoring.
- **Thoughtful Design:** Includes wall mounts for flexible installation and is designed for low power consumption.

NEW UPGRADE TWO WAY HANDS FREE INTERCOM



Simpler operation



Better voice quality



Longer signal range



Lower power
consumption



The Wuloo S600 intercom unit is shown, emphasizing its upgraded features such as simpler operation, improved voice quality, extended signal range, and reduced power consumption.

Friendly Communication



- Clear voice quality
- 10 kinds of chimes available
- Volume of chime is adjustable
- Call volume is adjustable

This image illustrates the ease of communication using the Wuloo intercom system, suitable for all ages, with features like clear voice quality, 10 chime options, and adjustable volume for both chimes and calls.

Elder&Children Friendly

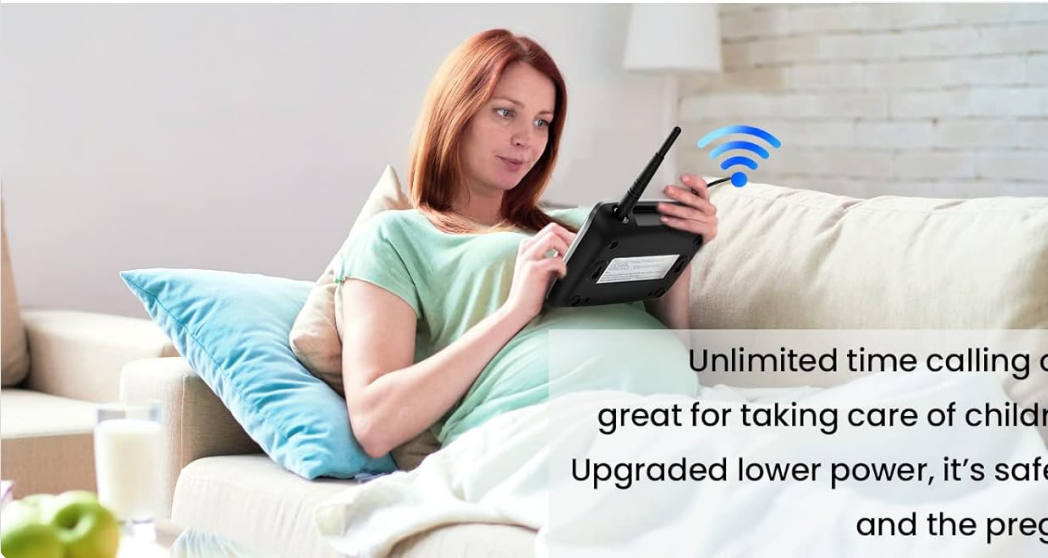

Unlimited time calling or monitoring,
great for taking care of children and elder;
Upgraded lower power, it's safe for the baby
and the pregnant woman

The Wuloo intercom system is designed to be user-friendly for both the elderly and children, offering unlimited calling and monitoring time, and is safe for pregnant women due to its upgraded lower power consumption.

Expandable & Anti interference

With up to 10 units in one system for 1 mile range;
New technology make it safer that you will not get
any conversation from other strangers and no
strangers can get your conversation

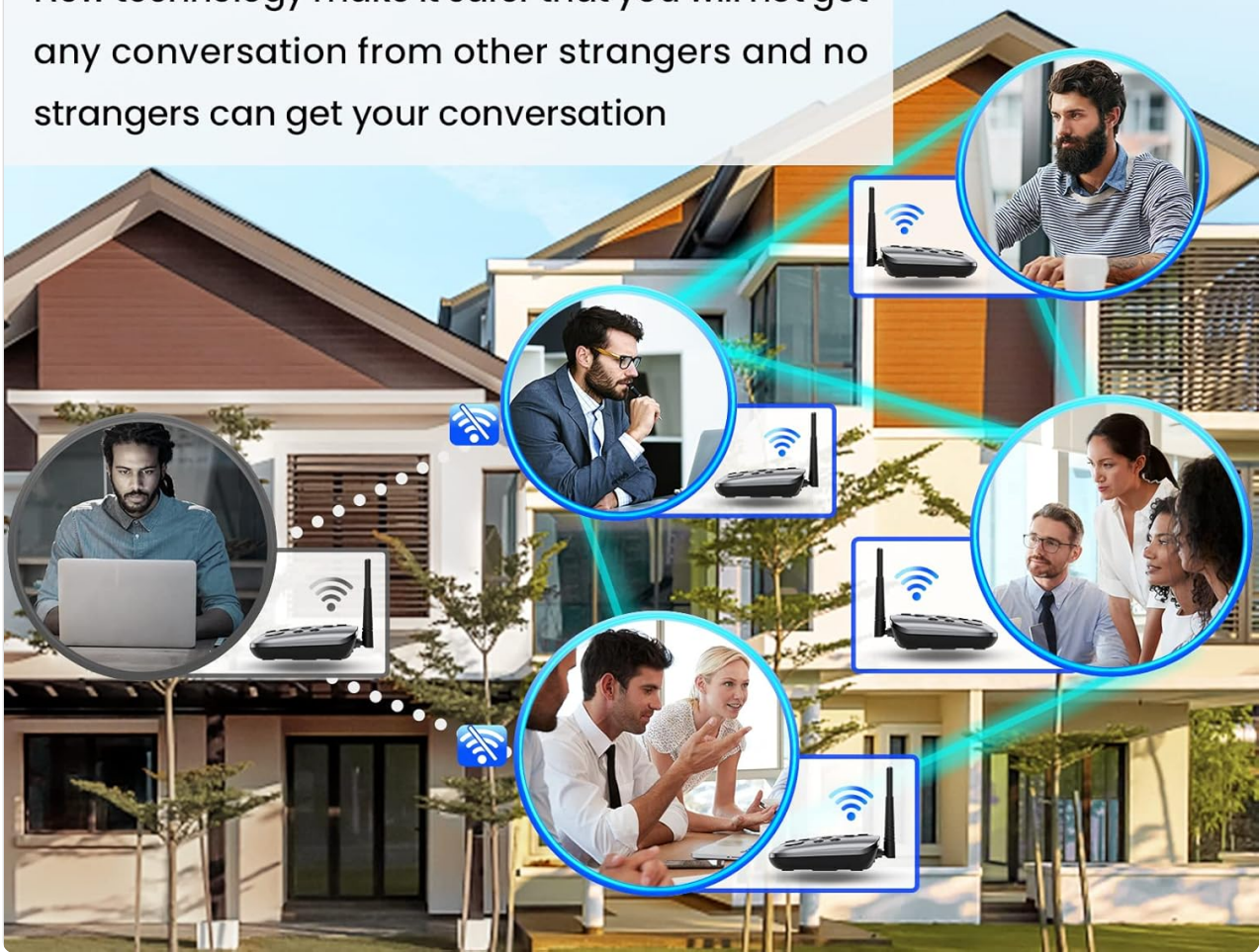

This diagram demonstrates the system's expandability, allowing up to 10 units to connect within a 1-mile range. It also highlights the anti-interference technology that ensures private conversations.

This video provides an overview of the key features of the Wuloo S600 two-way intercom system, including its hands-free operation and signal range.

3. PACKAGE CONTENTS

The Wuloo S600 Wireless Intercom System package typically includes the following items:

- Wuloo Hands-Free Wireless Intercom System: 4 units
- Power cable for Wuloo intercom system: 4 units
- Power supply (Input AC100-240V; output DC5V): 4 units
- Quick start guide for full duplex intercom: 1 unit
- Detailed Manual For Wuloo 2 way intercom system: 1 unit

Note: Support power bank supply (DC 5V), but cannot work with batteries. The power bank is not included.

More Details



Function Intro:

01 VOL+/-

When the Intercom is ON
Press VOL+/- button to adjust the volume of calling; Press&hold the VOL+ button for 3 seconds, enter "chimes setting" mode, then press VOL+/- to set the chime, then press CALL button to confirm your choice;
Press&hold the VOL- button for 3 seconds, enter "chime volume setting" mode, then press VOL+/- to set the chime volume, then press CALL button to confirm your choice

02 CALL

press to dial/hang up a calling; in the setting function, press to confirm the setting result and exit the setting mode

03 GROUP

Press& hold to talk to all the member units at the same time

04 MONITOR

It makes one side can hear another side's voice, it's great for taking care of children or elder, it doesn't have time limit

05 Power Button

press&hold to turn ON/OFF the machine.
when intercom is OFF, press&hold the Power button and CALL button at the same time to enter "Channel setting" mode;
When intercom is OFF, press&hold the CALL button and VOL- at the same time, then press&hold the power button at the same time, the intercom will be restored to factory Settings,(restore to channel 1 code 1, middle volume)

This image shows the complete contents of the Wuloo S600 4-unit package, which includes four intercom units, four USB cables, four power adapters, a quick start guide, and a detailed user manual. It also notes that a power bank is not included but can be used for portable operation.

4. SETUP GUIDE

Follow these steps to quickly set up your Wuloo S600 Intercom System:

- 1. Connect to AC Power & Set Code:** Connect each intercom unit to an AC power outlet using the provided power cable and adapter. Set a unique code number (1-10) for each unit by pressing and holding the code number button.
- 2. Distribute Units:** Place different units in desired locations or distribute them among family members or staff.
- 3. Begin Communication:** The system is now ready for hands-free communication. For optimal voice clarity, keep the microphone 20-30 cm away from your mouth when speaking.

How to set intercom system quickly

Connect with AC power



Code Setting



1st Step:

Connect with AC power and Set the different code number for each unit. press&hold the code number button to set the code number for each unit.

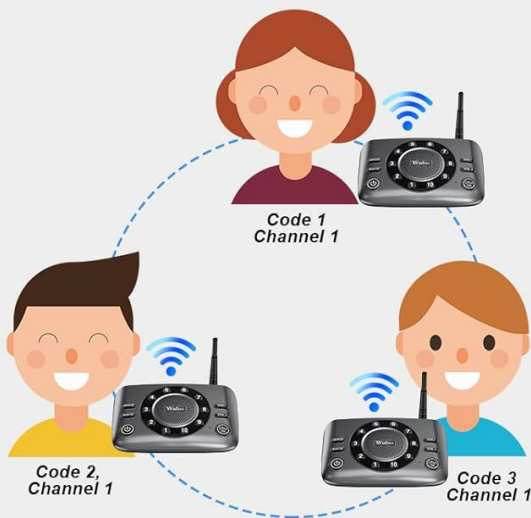

2nd Step:

Distribute different unit to different member.



3rd Step:

Use this intercom system to communicate with each other hands free.

Note:

To avoid the volume is too low to hear, please keep 20-30cm away from the microphone when you speaking.

This visual guide outlines the quick setup process for the Wuloo intercom system. Step 1 involves connecting to AC power and setting a unique code for each unit. Step 2 suggests distributing different units to different members or locations. Step 3 explains how to use the system for hands-free communication, advising users to keep the microphone 20-30cm away for optimal volume.

5. OPERATING INSTRUCTIONS

Familiarize yourself with the functions of the Wuloo S600 intercom unit:

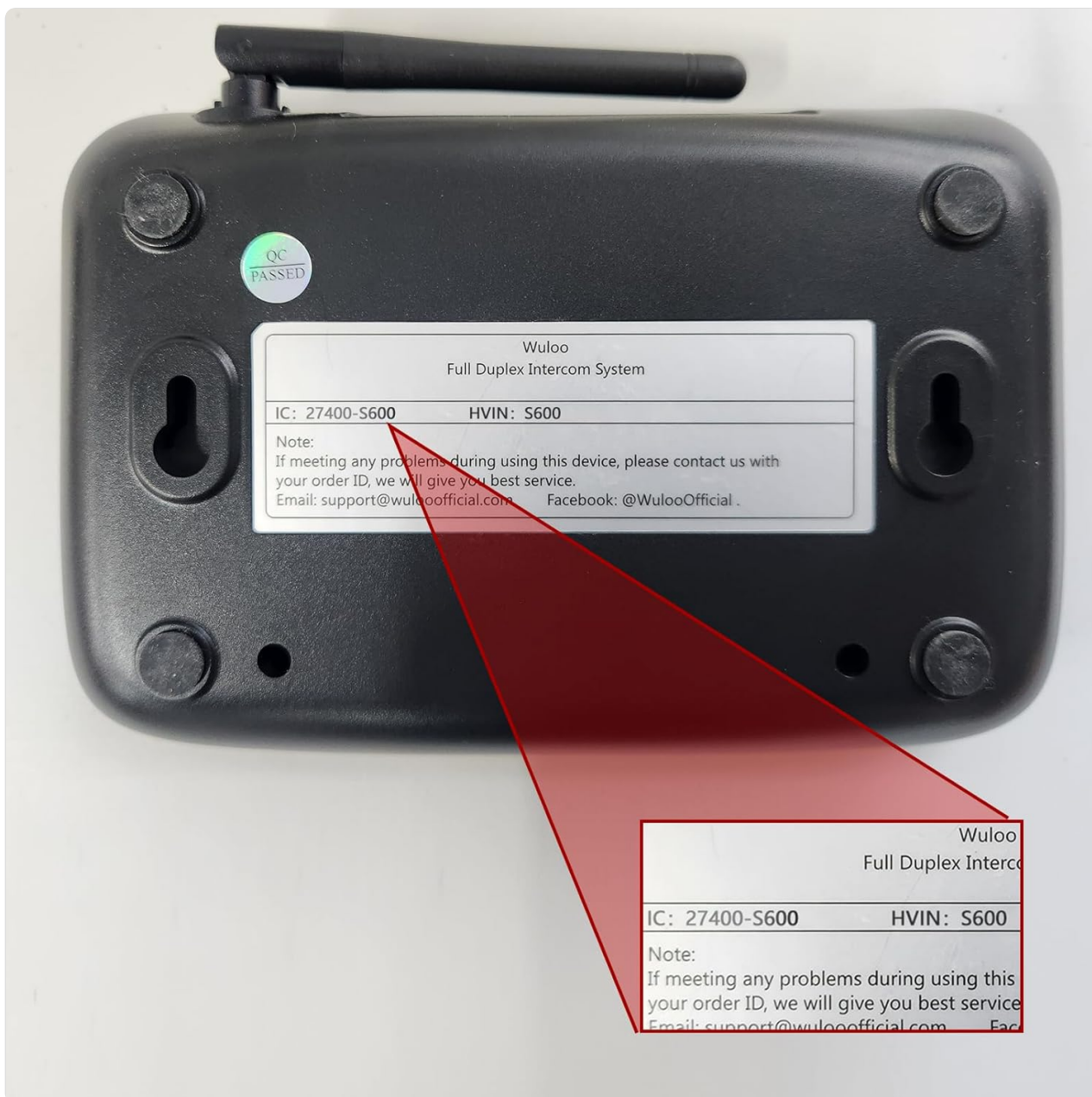

This detailed diagram labels all the key components and controls of the Wuloo S600 intercom unit. It provides a function introduction for each button: VOL+/- for adjusting call volume and setting chimes, CALL/OK for initiating/ending calls and confirming settings, GROUP for broadcasting to all units, MONITOR for continuous listening, and the Power Button for turning the unit on/off and resetting to factory settings.

- **VOL+/- Button:**

- When the intercom is ON, press VOL+/- to adjust the volume of calling.
- Press & hold the VOL+ button for 3 seconds to enter "chimes setting" mode, then press VOL+/- to set the chime, then press CALL button to confirm your choice.
- Press & hold the VOL- button for 3 seconds to enter "chime volume setting" mode, then press VOL+/- to set the chime volume, then press CALL button to confirm your choice.

- **CALL/OK Button:**

- Press to dial/hang up a calling.
- In the setting function, press to confirm the setting result and exit the setting mode.

- **GROUP Button:** Press & hold to talk to all the member units at the same time.

- **MONITOR Function:** Allows one side to hear another side's voice. This function does not have a time limit.

- **Power Button:**

- Press & hold to turn ON/OFF the machine.
- When intercom is OFF, press & hold the Power button and CALL button at the same time to enter "Channel setting" mode.
- When intercom is OFF, press & hold the Power button and VOL- at the same time, then press & hold the power button at the same time, the intercom will be restored to factory settings (1 code, middle volume).

6. MAINTENANCE

To ensure the longevity and optimal performance of your Wuloo S600 Intercom System, follow these maintenance guidelines:

- **Cleaning:** Use a soft, dry cloth to clean the exterior of the units. Avoid using abrasive cleaners or solvents.
- **Placement:** Place units on a stable surface or mount them securely on a wall. Avoid placing them near strong electromagnetic fields or direct sunlight.
- **Power Supply:** Always use the original power adapters provided with the system.
- **Storage:** If storing the units for an extended period, disconnect them from power and store them in a cool, dry place.

7. TROUBLESHOOTING

If you encounter issues with your Wuloo S600 Intercom System, consider the following common troubleshooting steps:

- **No Power:** Ensure the power adapter is securely plugged into both the intercom unit and a working electrical outlet. Check if the outlet is receiving power.
- **No Sound or Poor Sound Quality:**
 - Adjust the volume using the VOL+/- buttons.
 - Ensure units are within the specified 1-mile range. Obstacles like thick walls or large metal objects can reduce range.
 - Verify that units are set to the correct code for communication.
 - Ensure the microphone is not obstructed and you are speaking within 20-30 cm of it.
- **Interference:** While the system has anti-interference technology, strong local radio signals or other wireless devices might cause minor issues. Try relocating the units if persistent interference occurs.
- **Units Not Communicating:** Confirm that all units are powered on and set to the same channel/code if you are trying to communicate directly between specific units. For group calls, ensure all units are within range.

For more detailed troubleshooting or issues not covered here, please refer to the detailed manual included in your package or contact Wuloo customer support.

8. SPECIFICATIONS

Specification	Detail
Brand	Wuloo
Model Number	S600-P4
Color	4 units set
Power Source	AC
Voltage	5 Volts
Connectivity Technology	Wireless
Maximum Range	5280 Feet (approx. 1 mile)
Item Dimensions (L x W x H)	6.5 x 4.3 x 1.5 inches
Item Weight	1.43 Kilograms (3.14 pounds)
Installation Type	Wall-Mounted or Desk
Control Method	Voice

9. WARRANTY AND SUPPORT

Wuloo is committed to providing high-quality products and excellent customer service. Your Wuloo S600 Intercom System comes with a **2-year warranty** and lifetime service.

For any problems or inquiries during the use of this device, please contact Wuloo customer support with your order ID. The Wuloo team is dedicated to providing the best possible service.

Email: support@wulooofficial.com

Facebook: [@WulooOfficial](https://www.facebook.com/WulooOfficial)

Package Include 4 Stations



USB cable(70 inch)



Adapter(5V 1A)



Detailed Manual



USB cable(70 inch)



Adapter(5V 1A)



USB cable(70 inch)



Adapter(5V 1A)



USB cable(70 inch)



Adapter(5V 1A)





Note: Support power bank supply (DC 5V), but can't work with batteries. the power bank is not included.

The back of the Wuloo S600 intercom unit displays important identification details such as the IC: 27400-S600 and HVIN: S600. It also provides customer support contact information, including an email address (support@wulooofficial.com) and Facebook page (@WulooOfficial) for any issues or inquiries.

© 2024 Wuloo. All rights reserved.

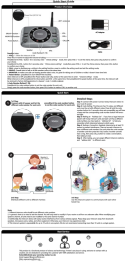
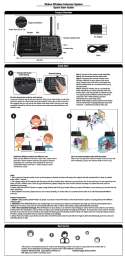
Related Documents - S600-P4

	<p>Wuloo Full Duplex Intercom System: Quick Start Guide</p> <p>This guide provides essential information for setting up and using the Wuloo Full Duplex Intercom System, including product overview, function details, and step-by-step instructions for wireless communication.</p>
	<p>Wuloo Full Duplex Intercom System User Manual</p> <p>This user manual provides comprehensive instructions for setting up, operating, and troubleshooting the Wuloo Full Duplex Intercom System. Learn about its features, advanced settings, and warranty information.</p>
	<p>Wuloo Full Duplex Intercom System Quick Start Guide</p> <p>Quick start guide for the Wuloo Full Duplex Intercom System, covering product overview, function introduction, setup steps, and best service contact information.</p>
	<p>Wuloo Wireless Intercom System Quick Start Guide</p> <p>This Quick Start Guide provides essential information for setting up and using the Wuloo Wireless Intercom System. It covers product overview, step-by-step setup instructions, channel and code configuration, multi-function usage, important notes, and feature introductions, ensuring efficient communication for home and business.</p>
	<p>Wuloo WL-666 Wireless Intercom System User Manual</p> <p>A comprehensive user manual for the Wuloo WL-666 Wireless Intercom System. This guide covers setup, features like TALK, GROUP, MONITOR, VOX, and CALL, troubleshooting common issues, and warranty information.</p>
	<p>Wuloo Wireless Intercom System Quick Start Guide</p> <p>A quick start guide for the Wuloo Wireless Intercom System, detailing setup, channel and code setting, usage, and features for effective room-to-room communication.</p>

