

Manuals+

[Q & A](#) | [Deep Search](#) | [Upload](#)

[manuals.plus](#) /

> [Techwood](#) /

> [Techwood 1600W Electric Indoor/Outdoor BBQ Grill Instruction Manual](#)

Techwood 1600W

Techwood 1600W Electric Indoor/Outdoor BBQ Grill Instruction Manual

Model: 1600W

[Overview](#) [Setup](#) [Operation](#) [Safety Instructions](#) [Product](#)
[Maintenance](#) [Troubleshooting](#) [Specifications](#) [Warranty & Support](#)

1. SAFETY INSTRUCTIONS

Please read all instructions carefully before using the Techwood 1600W Electric BBQ Grill. Retain this manual for future reference.

- This electric grill operates without charcoal or propane, eliminating flare-ups and making it suitable for apartments, patios, and other areas where traditional grills are restricted.
- Ensure the grill is plugged into a suitable electrical outlet (120V 60Hz). Use a heavy-duty extension cord if necessary, ensuring it is rated for outdoor use if grilling outdoors.
- Always use the grill on a stable, heat-resistant surface.
- The grill features heat-proof Bakelite handles for safe handling.
- The venting system is designed to dissipate heat effectively. Do not obstruct vents during operation.
- Keep children and pets away from the hot grill.
- Do not immerse the electrical components in water.
- Always unplug the grill when not in use and before cleaning.

2. PRODUCT OVERVIEW

The Techwood 1600W Electric BBQ Grill is designed for versatile indoor and outdoor grilling. It features a double-layer design for even heating and a spacious cooking surface.

Components:

- Grill Bowl
- Lid with Adjustable Air Vent

- Heating Element
- Main Grilling Grate
- Foldable Warming Rack
- Temperature Control Unit (Power Plug with Adjustable Thermostat)
- Removable Drip Tray
- Stand (for stand models) / Stable Base (for countertop models)
- Heat-Proof Handles

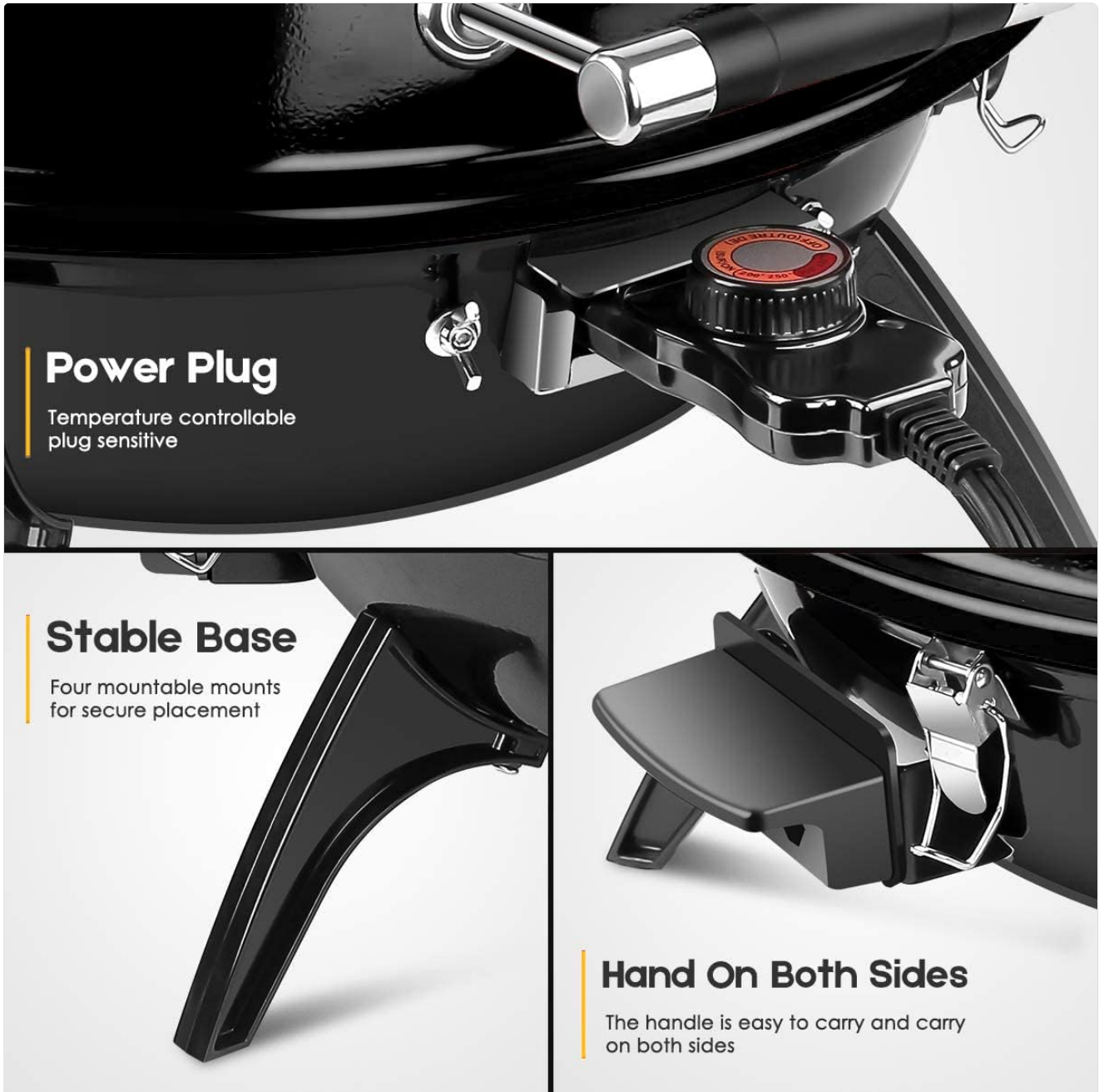

Figure 2.1: Key components of the Techwood Electric BBQ Grill, showing the temperature control unit, stable base, and heat-proof handles.

3. SETUP

Assembly is required for your Techwood Electric BBQ Grill. The process is designed to be straightforward, with most hardware pre-started to minimize guesswork.

Assembly Steps:

1. Unpack all components from the box. Verify all parts are present against the packing list in your user manual.
2. Attach the stand or base to the main grill bowl. Most screws, washers, and nuts are pre-positioned. Carefully remove them, align the parts, and re-secure them. Ensure all connections are tightened securely, especially those with lock washers, to prevent loosening over time.
3. Install the heating element into the grill bowl.
4. Place the main grilling grate over the heating element.
5. Attach the foldable warming rack to the lid.
6. Secure the lid to the grill bowl using the provided hinges and hardware.
7. Insert the removable drip tray into its designated slot beneath the heating element.
8. Connect the temperature control unit (power plug) to the grill.

Your browser does not support the video tag.

Video 3.1: This video demonstrates the assembly process for the Techwood Electric BBQ Grill, showing how components fit together and highlighting the ease of setup.



Figure 3.1: The fully assembled Techwood Electric BBQ Grill, ready for use. This image shows the countertop configuration with its compact dimensions.

4. OPERATING INSTRUCTIONS

The Techwood Electric BBQ Grill offers a convenient and efficient way to cook your favorite foods.

Pre-heating:

1. Ensure the grill is properly assembled and placed on a stable surface.
2. Plug the temperature control unit into a 120V 60Hz electrical outlet.
3. Turn the adjustable temperature control knob to your desired heat setting. The grill features a temperature range from 428°F to 590°F. An indicator light on the control unit will illuminate when heating.
4. Close the lid to allow for rapid cycle heating and even temperature distribution. Allow the grill to pre-heat for approximately 10-15 minutes, or until the desired temperature is reached.

Grilling:

- Carefully place food onto the main grilling grate. The 240 square inch circular grilling surface can accommodate up to 15 servings.
- Use the foldable warming rack to keep cooked food warm while other items are grilling.
- Monitor cooking progress and adjust the temperature as needed using the control knob. The lid's adjustable air vent can also be used to fine-tune heat retention.
- The double-layer design and interlocking hood and bowl promote even cooking, ensuring tender and juicy results.



EVEN HEAT ACROSS THE COOKING SURFACE

No need for complicated procedures, perfectly preserve the deliciousness of gravy.

Figure 4.1: The grill's design ensures even heat distribution across the cooking surface, contributing to perfectly cooked meals.



Adjustable **Temperature Control**

Figure 4.2: The adjustable temperature control allows for precise heat management for various cooking needs.

5. MAINTENANCE AND CLEANING

Regular cleaning and maintenance will ensure the longevity and optimal performance of your Techwood Electric BBQ Grill.

After Each Use:

1. Unplug the grill from the power outlet and allow it to cool completely before cleaning.
2. Remove the main grilling grate and warming rack. These stainless steel components are easy to clean.
3. Carefully slide out the removable drip tray. Dispose of any accumulated grease and food particles. The drip tray can be easily scraped and washed.
4. The double-sided non-stick cold rolled steel cooking grating is designed for easy cleaning. Wipe down the interior of the grill bowl and heating element area with a damp cloth. For stubborn residue, the heating element can be disassembled from the pan for thorough cleaning.
5. Clean the exterior surfaces with a damp cloth.

6. Ensure all parts are dry before reassembling and storing the grill.

6. TROUBLESHOOTING

If you encounter any issues with your Techwood Electric BBQ Grill, please refer to the following common troubleshooting steps:

- **Grill not heating:** Ensure the power cord is securely plugged into a functioning electrical outlet and the temperature control knob is set to an active heating level. Check your circuit breaker if the outlet is not providing power.
- **Uneven heating:** Ensure the lid is properly closed during pre-heating and cooking. The double-layer design is optimized for even heat when the lid is in place. Adjust the air vent on the lid to control heat retention.
- **Excessive smoke:** Ensure the drip tray is clean and properly installed. Excessive grease buildup can cause smoke. If grilling indoors, ensure adequate ventilation.
- **Food sticking:** Ensure the grilling grate is clean before use. Lightly oiling the grate before placing food can help prevent sticking.

For further assistance, please contact Techwood customer support.

7. SPECIFICATIONS

Feature	Detail
Brand	Techwood
Model Number	1600W
Product Dimensions	11"D x 17.9"W x 14.8"H
Item Weight	13.71 Pounds
Voltage	120 Volts
Wattage	1600 watts
Heating Power	1.6 Kilowatts
Fuel Type	Electric
Recommended Uses	Indoor, Outdoor
Cooking Surface Area	240 Square Inches
Number of Servings	Up to 15
Number of Racks	1 (plus warming rack)
Number of Power Levels	7
Temperature Range	428°F to 590°F

Material	Metal (Stainless Steel or Cast Iron frame)
Handle Material	Plastic (Bakelite)
Finish Type	Non-Stick
Assembly Required	Yes

8. WARRANTY AND SUPPORT

Techwood products are covered by Product Liability Insurance of the United States. For specific warranty details and to register your product, please refer to the documentation included in your product packaging or visit the official Techwood website.

For customer support, technical assistance, or to inquire about replacement parts, please contact Techwood directly through their official channels.