

MOBILLA MBUDS 101

MOBILLA MBUDS 101 User Manual

Model: MBUDS 101 (Matte - Black)

Quick Links: [Overview](#) | [Setup](#) | [Operating](#) | [Maintenance](#) | [Troubleshooting](#) | [Specifications](#) | [Warranty & Support](#)

1. PRODUCT OVERVIEW

The MOBILLA MBUDS 101 are true wireless stereo earbuds designed to deliver a superior audio experience with convenience and style. Featuring multi-function buttons, these earbuds allow you to take control of your music and calls for a hands-free experience. Their aesthetic and ergonomic design ensures comfort and elegance.

Key Features:

- **Extended Playback:** Up to 21 hours of total playback time with the charging case, and 5 hours of non-stop playtime per charge.
- **Superior Sound:** Powered by a 10mm Dynamic Driver for balanced and powerful audio.
- **Water Resistant:** IPX4 rating makes them resistant to splashes and sweat.
- **One-Touch Control:** Easily manage music playback and calls with simple touch gestures.
- **Voice Assistance:** Compatible with voice assistants for convenient command execution.
- **Clear Calls:** Passive Voice Cancellation helps mute surrounding disturbances for clearer conversations.
- **Comfortable Fit:** Craftily designed to fit securely in your ear for a non-jerky music experience.



Figure 1: MOBILLA MBUDS 101 Matte Black Earbuds in their charging case.

2. GETTING STARTED

2.1 Unboxing

Upon opening your MOBILLA MBUDS 101 package, ensure all components are present:

- MOBILLA MBUDS 101 Earbuds
- Charging Case
- Charging Cable
- Ear Cushions (various sizes)
- User Manual

2.2 Charging Your Earbuds

Before first use, fully charge your MBUDS 101. Place the earbuds into the charging case and connect the charging cable to the case and a power source. The indicator lights on the case will show the charging status. A full charge provides up to 5 hours of playtime, with the charging case extending total playback to 21 hours.

Tireless
21hrs



Figure 2: The MOBILLA MBUDS 101 offer up to 21 hours of total playback time with the charging case.

2.3 Pairing with Your Device

1. Ensure the earbuds are charged.
2. Open the charging case. The earbuds will automatically enter pairing mode (indicator lights will flash).
3. On your smartphone or audio device, go to Bluetooth settings.
4. Search for available devices and select "MOBILLA MBUDS 101".
5. Once connected, the indicator lights on the earbuds will stop flashing.
6. The earbuds will automatically reconnect to the last paired device when taken out of the case.

3. OPERATING YOUR MBUDS 101

3.1 Touch Controls

The MBUDS 101 feature intuitive touch controls on each earbud for seamless management of your audio and calls:

- **Play/Pause:** Single tap on either earbud.
- **Next Track:** Double tap on the right earbud.

- **Previous Track:** Double tap on the left earbud.
- **Answer/End Call:** Single tap on either earbud.
- **Reject Call:** Press and hold either earbud for 2 seconds.
- **Activate Voice Assistant:** Triple tap on either earbud.

3.2 Voice Assistance

The MBUDS 101 support voice assistance, allowing you to control your device with voice commands. Simply triple tap either earbud to activate your smartphone's voice assistant (e.g., Ok Google, Hey Siri) and speak your command.



Figure 3: Enjoy enhanced bass and seamless voice assistant integration with your MBUDS 101.

3.3 Call Management

With Passive Voice Cancellation, your MBUDS 101 are designed to provide clear call quality by minimizing background noise. Use the touch controls to manage incoming and ongoing calls effectively.

3.4 Water Resistance (IPX4)

The MBUDS 101 are rated IPX4 water-resistant, meaning they are protected against splashing water from

any direction. This makes them suitable for workouts and light rain, but they are not designed for submersion in water.



Figure 4: The IPX4 rating ensures your MBUDS 101 are splash-proof and suitable for active use.

4. MAINTENANCE AND CARE

4.1 Cleaning

- Regularly clean the earbuds and charging case with a soft, dry, lint-free cloth.
- Do not use abrasive cleaners, alcohol, or chemical solvents.
- Gently remove any earwax or debris from the ear tips and speaker mesh using a small, soft brush or cotton swab.

4.2 Storage

- When not in use, always store the earbuds in their charging case to protect them and keep them charged.
- Store in a cool, dry place away from extreme temperatures and direct sunlight.

5. TROUBLESHOOTING

5.1 No Power / Not Charging

- Ensure the charging cable is securely connected to both the case and the power source.
- Check if the power source is active.
- Clean the charging contacts on both the earbuds and the case.

5.2 Pairing Problems

- Make sure Bluetooth is enabled on your device.
- Ensure the earbuds are in pairing mode (indicator lights flashing).
- Move the earbuds closer to your device.
- Forget/delete "MOBILLA MBUDS 101" from your device's Bluetooth list and try pairing again.
- Restart your device and the earbuds.

5.3 Audio Quality Issues

- Ensure the earbuds are properly seated in your ears. Try different ear tip sizes for a better seal.
- Check the audio source volume and the device volume.
- Move away from potential sources of interference (e.g., Wi-Fi routers, other Bluetooth devices).
- Clean the speaker mesh of the earbuds.

6. SPECIFICATIONS

Feature	Detail
Model Name	MBUDS 101
Connectivity Technology	Wireless
Headphones Jack	3.5 mm Jack (for charging cable)
Playback Time	21 Hours (with charging case) 5 Hours (per charge)
Audio Driver Type	10mm Dynamic Driver
Water Resistance Level	IPX4 Water Resistant
Control Method	Touch, Voice
Microphone Format	With microphone
Special Features	Fast Charging, Microphone Included, Sweatproof
Form Factor	Earbuds, In ear
Material	Plastic
Color	Black
Item Weight	200 g

Product Dimensions

10 x 10 x 10 cm

7. WARRANTY AND SUPPORT

7.1 Warranty Information

Your MOBILLA MBUDS 101 comes with a **365 Day Warranty** from the date of purchase. This warranty covers manufacturing defects and ensures your product is free from material and workmanship flaws under normal use. Please retain your proof of purchase for warranty claims.

7.2 Customer Support

For further assistance, technical support, or warranty claims, please visit the official [MOBILLA Store on Amazon](#) or contact MOBILLA customer service through their official channels.

© 2025 MOBILLA. All rights reserved.

Related Documents



[Mobilla MBuds 104 Wireless Earbuds User Manual](#)

User manual for Mobilla MBuds 104 Wireless Earbuds, covering appearance, charging, pairing, smart touch controls, and specifications. Learn how to connect and use your earbuds.

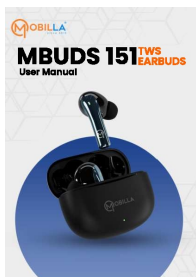

[Mobilla MBuds 151 TWS Earbuds User Manual](#)

User manual for Mobilla MBuds 151 TWS Earbuds, detailing appearance, charging, pairing, smart touch controls, call management, and technical specifications.



[Mobilla MBUDS 511 Wireless Earbuds User Manual](#)

User manual for Mobilla MBUDS 511 wireless earbuds, detailing appearance, charging, pairing, smart touch controls, and specifications.

	<p>Mobilla MBuds 106 TWS Earbuds User Manual & Specifications</p> <p>User manual and specifications for Mobilla MBuds 106 True Wireless Stereo (TWS) Earbuds, detailing appearance, charging, pairing, smart touch controls, power management, and technical features like Bluetooth 5.3 and 25-hour playtime.</p>
--	--

Documents - MOBILLA – MBUDS 101

[\[pdf\]](#) User Manual

MBuds 101 User Manuual MBUDS MANUAL Mobilla v 1635422301 cdn shopify s files 1 0592 2740 6513

|||

50*95 EARPODS M Buds 101 USER MANUAL **MBUDS 101** - TWS EAR BUDS A Warm Welcome from Mobilla and many thanks for purchasing our **MBUDS 101** - TWS EARBUDS. To get the most of these dynamic sound buds, please go through this manual thoroughly. Each pack will include: 1. A pair of Buds 2. A Charging case 3...

lang:en score:52 filesize: 5.6 M page_count: 2 document date: 2021-08-10

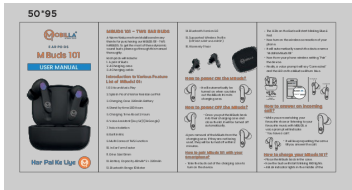

[\[pdf\]](#) Accessories Catalog

Exhibit 2 catalogue Mag World Expo Mobilla v 1652263404 cdn shopify s files 1 0592 2740 6513 |||

We are a company with a team of young aggressive minds and passion for creating products that would ... I Warranty : 180 Days Colors : MRP : 1,299 MBUDS WIRELESS EARBUDS MBUDS WIRELESS EARBUDS **MBUDS 101** Play Back Time : 21 hours Battery Capacity : 320mAh Range : 10M Voice Assistance : O...

lang:en score:14 filesize: 3.13 M page_count: 61 document date: 2022-05-11



[\[pdf\]](#) Accessories Catalog

Exhibit catalogue DOWNLOAD CATALOGUE Digital Catalogue Mobilla v 1646914059 cdn shopify s files 1 0592 2740 6513 |||

We are a company with a team of young aggressive minds and passion for creating products that would ... oogle, Hey SIRI Warranty : 180 Days Colors : MBUDS WIRELESS EARBUDS MBUDS WIRELESS EARBUDS **MBUDS 101** Play Back Time : 21 hours Battery Capacity : 320mAh Range : 10M Voice Assistance : O...

lang:en score:14 filesize: 3.2 M page_count: 64 document date: 2022-03-08



[\[pdf\]](#) Accessories Catalog

Catalogue V2 2022 Mobilla 45127913 77fd 4213 905e 04977ee8ad38 v 1671866917 cdn shopify s files 1 0592 2740 6513 |||

We are a company with a team of young aggressive minds and passion for creating products that would ... 0M Battery Capacity : 150mA Modes : Bluetooth MBUDS WIRELESS EARBUDS MBUDS WIRELESS EARBUDS **MBUDS 101** Play Back Time : 21 hours Battery Capacity : 320mAh Range : 10M Voice Assistance : O...

lang:en score:14 filesize: 5.73 M page_count: 78 document date: 2022-12-24



