

## Manuals+

[Q & A](#) | [Deep Search](#) | [Upload](#)

manuals.plus /

› [gmusre](#) /

› [Gmusre Outdoor Shower Fixtures Oil Rubbed Bronze Shower System Instruction Manual](#)

## gmusre Oil Rubbed Bronze-01

# Gmusre Outdoor Shower Fixtures Oil Rubbed Bronze Shower System Instruction Manual

Model: Oil Rubbed Bronze-01 | Brand: gmusre

[Introduction](#)   [Features](#)   [Package Contents](#)   [Setup & Installation](#)   [Operating Instructions](#)   [Maintenance](#)   [Troubleshooting](#)   [Specifications](#)   [Warranty & Support](#)

## 1. INTRODUCTION

This manual provides comprehensive instructions for the installation, operation, and maintenance of your Gmusre Outdoor Shower Fixtures Oil Rubbed Bronze Shower System. Please read this manual thoroughly before installation and use to ensure proper function and longevity of your product.



Image: The Gmusre Outdoor Shower Fixtures Oil Rubbed Bronze Shower System, showcasing the rainfall head, handheld spray, and tub spout.

## 2. PRODUCT FEATURES

- **Three Functions:** Features an 8-inch rainfall shower head for full body coverage, a handheld shower with a 59-inch hose, and a waterfall tub spout for quick tub filling.
- **Durable Material:** Constructed from premium brass with an oil rubbed bronze finish, designed to resist corrosion in humid environments, ensuring durability and reliability.
- **Adjustable Height:** The shower height is adjustable between 35.5 inches and 53.5 inches. The handheld shower bracket is also adjustable to accommodate various user heights.
- **Convenient Controls:** A diverter allows easy switching between the rainfall shower head and handheld shower. The central handle controls the tub spout, while two cross handles manage hot and cold water independently.

- **Easy Installation:** Designed for two-hole installation. Includes NPT 1/2 adapter to adjust installation hole distance between 5 inches and 6.6 inches. All necessary mounting hardware and an installation manual are provided.



Image: Diagram illustrating the three water outlet modes: rainfall shower head, handheld spray, and bathtub spout.

### 3. PACKAGE CONTENTS

Verify that all components listed below are present and undamaged before proceeding with installation.

1. Rain Shower Head
2. 59-Inch Shower Hose
3. Upper Shower Connection Pipe
4. Middle Shower Connection Pipe
5. Lower Shower Connection Pipe

- 6. Handheld Shower
- 7. Hand Shower Holder
- 8. Diverter (brass)
- 9. Mounting Base (Match with No.3)
- 10. Faucet Body
- 11. Decoration Cover
- 12. 304 Stainless Steel Adapter X 2
- 13. Washers X 4 (for connections)



Image: Exploded view diagram showing all included parts of the Gmusre shower system with corresponding labels.

## 4. SETUP & INSTALLATION

This section guides you through the installation process. Professional installation is recommended if you are unfamiliar with plumbing work.

## 4.1 Pre-Installation Checklist

- Ensure water supply is turned off.
- Gather necessary tools (e.g., wrench, screwdriver, drill, Teflon tape).
- Confirm all package contents are present.
- Verify your wall's installation hole distance is between 5 and 6.6 inches.

## 4.2 Installation Steps

1. Connect the brass adapters to your water supply lines. Ensure washers are placed at each connection to prevent leakage.
2. Adjust the adapters to match the installation hole distance of the faucet body (between 5 and 6.6 inches).
3. Turn on the water valve for a short period to flush out any dust or impurities from the pipes.
4. Assemble the shower set components as per the diagram, ensuring all connections are secure.
5. Place the pre-assembled shower in the desired position on the wall and mark the mounting hole locations.
6. Drill holes for the upper part of the shower bar bracket and secure it.
7. Install the decoration covers over the brass adapters.
8. Connect the shower hose, handheld shower, and rain shower head to their respective connections on the faucet body and diverter.
9. Tighten all connections, being careful not to overtighten.

Your browser does not support the video tag.

Video: Step-by-step guide for installing the Gmusre Antique Outdoor Shower Fixture.

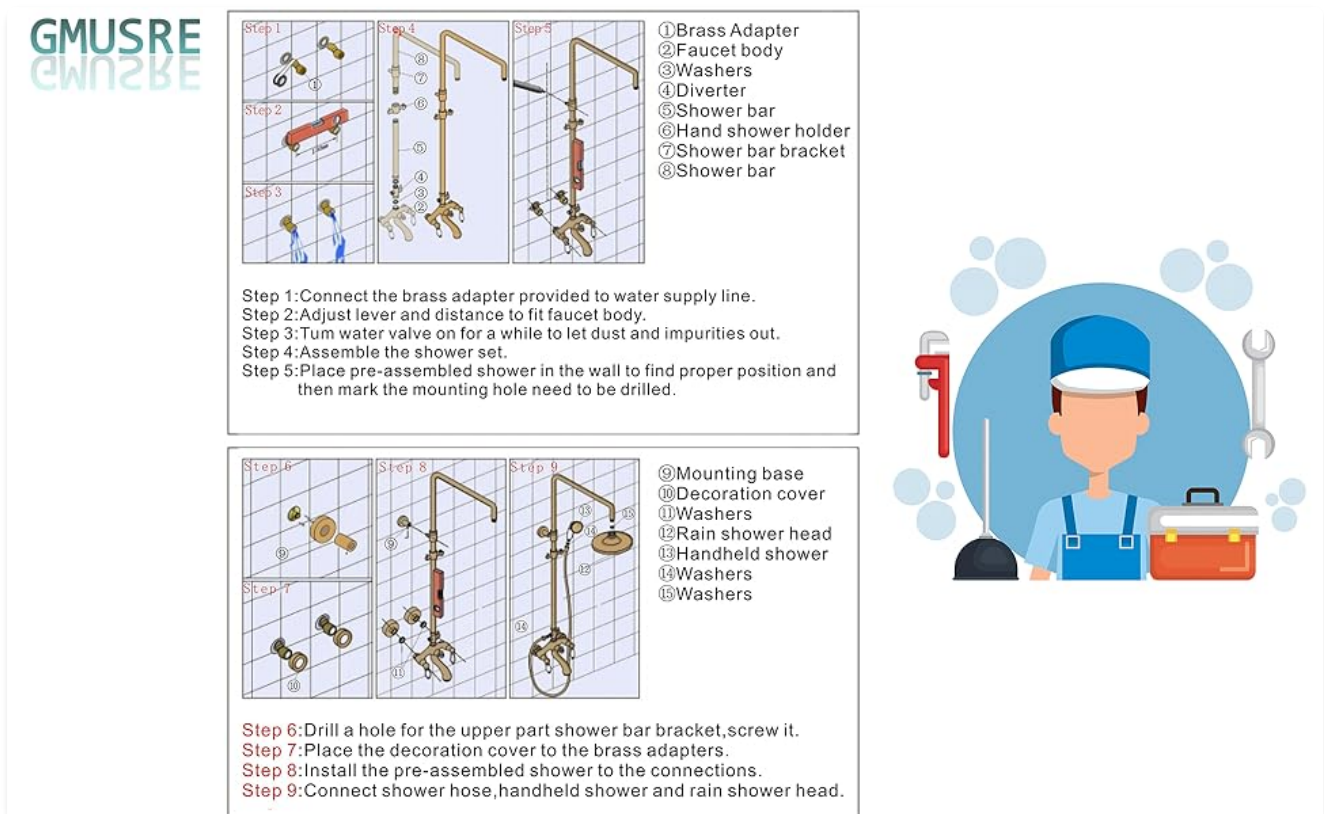

Image: Detailed diagram illustrating the installation steps and components for the Gmusre shower system.

## 5. OPERATING INSTRUCTIONS

Your Gmusre shower system offers multiple functions for a customized showering experience.

### 5.1 Water Flow Control

- The two cross handles on the faucet body control the hot and cold water supply. Turn them to adjust water temperature and flow intensity.
- The central handle on the faucet body controls the tub spout. Pull it to activate the tub spout.
- The diverter valve, located above the faucet body, allows you to switch between the rainfall shower head and the handheld shower. Rotate the diverter to select your desired water outlet.

Your browser does not support the video tag.

Video: Demonstration of the Gmusre outdoor shower fixtures and faucet set in operation.

### 5.2 Adjusting Shower Height

- **Rainfall Shower Head:** The main shower pipe can be adjusted in height from 35.5 inches to 53.5 inches. To adjust, unscrew the knobs on the shower pipe, slide the pipe to the desired height, and then re-tighten the knobs. A slight force may be needed to pull out the pipe.
- **Handheld Shower:** The bracket for the handheld shower is also adjustable along the main pipe. Loosen the bracket, slide it to your preferred height, and secure it.

GMUSRE  
GMUSRE



Max Pull-out Height  
17.8 Inch (45 cm)



Unscrew the knobs  
Release the shower pipe inside  
Heighten the outdoor shower fixture.

**Tips:**

You will need to use a little force to pull it out, this is normal, please don't worry about damaging it.

**Humanized Design**

The purpose of this design is to allow our consumers to freely adjust the height of the product according to their needs (bathroom height, height, personal preference).

# Easily Adjust Shower Height

Image: Visual guide on how to easily adjust the height of the main shower pipe for the rainfall shower head.



Image: Illustration demonstrating the adjustable shower bar bracket for the handheld shower.

Your browser does not support the video tag.

Video: Overview of the Gmure Outdoor Shower Fixtures, highlighting the adjustable shower head feature.

## 6. MAINTENANCE

Regular cleaning and maintenance will help preserve the finish and functionality of your shower system.

- **Cleaning the Finish:** Clean the oil rubbed bronze finish with a soft, damp cloth. Avoid abrasive cleaners, harsh chemicals, or scouring pads, as these can damage the finish.
- **Cleaning Shower Head Nozzles:** If water flow from the rainfall head or handheld shower becomes uneven, gently rub the silicone nozzles to dislodge any mineral deposits.
- **Winterization (for Outdoor Use):** If used outdoors in freezing climates, ensure the water supply to the shower is completely shut off and the system is drained to prevent freezing and damage.

## 7. TROUBLESHOOTING

This section addresses common issues you might encounter with your shower system.

### Issue: Water Leakage at Connections

**Solution:** Ensure all washers are correctly seated and connections are tightened. Do not overtighten. If leakage persists, check for damaged washers or improper threading.

### Issue: Low Water Pressure

**Solution:** Check if the main water supply valve is fully open. Inspect shower head nozzles for mineral buildup and clean them as described in the Maintenance section. Ensure no kinks in the shower hose.

### Issue: Difficulty Adjusting Shower Height

**Solution:** Ensure the adjustment knobs are sufficiently loosened before attempting to slide the shower pipe or handheld bracket. Apply gentle, even pressure. If stiff, a small amount of silicone lubricant might help, but avoid getting it on the water path.

## 8. SPECIFICATIONS

Attribute	Detail
Brand	gmusre
Model Number	Oil Rubbed Bronze-01
Color	Oil Rubbed Bronze
Material	Brass
Finish Type	Oil Rubbed
Number of Handles	3
Mounting Type	Wall Mount
Rainfall Head Size	8 inches
Shower Height Adjustment	35.5 - 53.5 inches (90 - 135 cm)
Spout Reach	4.72 Inches
Flow Rate (Max)	2.5 GPM (Handheld, Shower Head, Tub Spout)
Product Dimensions	32.8 x 12.8 x 5.2 inches
Item Weight	8.98 pounds

# Product Dimensions



Image: Diagram detailing the product dimensions of the Gmusre shower system.

## 9. WARRANTY & SUPPORT

### 9.1 Warranty Information

Gmusre provides a warranty for 5 years from the date of purchase. Please retain your proof of purchase for warranty claims.

### 9.2 Technical Support

For any technical assistance or further inquiries, please contact Gmusre customer support. Refer to the product packaging or the official Gmusre website for contact details.

