



[Manuals.plus](#) /

> [KISKIZ](#) /

> KISKIZ 42-Inch Extra Tall Retractable Baby Gate Instruction Manual

KISKIZ SH20.007

KISKIZ 42-Inch Extra Tall Retractable Baby Gate Instruction Manual

Model: SH20.007

1. IMPORTANT SAFETY INFORMATION

Please read and understand all instructions before installing and using the KISKIZ 42-Inch Extra Tall Retractable Baby Gate. Failure to follow these instructions could result in serious injury or death.

- Always ensure the gate is securely latched and locked when in use.
- Never leave children or pets unattended near the gate.
- This gate is designed for use with children from 6 to 24 months of age and for pets.
- Do not use this gate at the top of stairs without proper installation and ensuring it is securely mounted.
- Regularly check all parts for wear, damage, or loose components. Discontinue use if any part is damaged or missing.
- Keep small parts away from children during assembly.



BE CAREFUL

Incorrect installation can be dangerous!



Do not install the gate between stair steps

Do not install the gate on the steps less than 12inch

Do not install the gate above the baseboard directly

Please retract the gate slowly

Warning: Incorrect installation can be dangerous. This image illustrates critical installation errors to avoid, such as installing the gate between stair steps, on steps less than 12 inches, or directly above a baseboard. It also advises to retract the gate slowly.

2. PRODUCT OVERVIEW

The KISKIZ 42-Inch Extra Tall Retractable Baby Gate is designed to provide a safe barrier for children and pets in various areas of your home. Its retractable design allows for easy opening and closing, saving space when not in use.

- **Extra Tall Design:** At 42 inches high, this gate provides enhanced security for taller children and active pets.
- **Adjustable Width:** Extends up to 56 inches wide, suitable for various openings.
- **Retractable Mesh:** The gate retracts completely when not needed, eliminating trip hazards and maximizing space.
- **One-Handed Operation:** Designed for convenient use by adults, even while holding a child.
- **Durable Mesh:** Made from a durable and scratch-resistant mesh material that is baby-friendly.
- **Adjustable Lower Bracket:** Features an adjustable lower bracket to accommodate skirting or baseboards without requiring additional wall spacers.
- **Versatile Use:** Ideal for use in doorways, hallways, stairs, kitchens, bathrooms, living rooms, and laundry areas, both indoors and outdoors.



The KISKIZ retractable gate in a kitchen doorway, demonstrating its use as a barrier.

42-Inch Tall

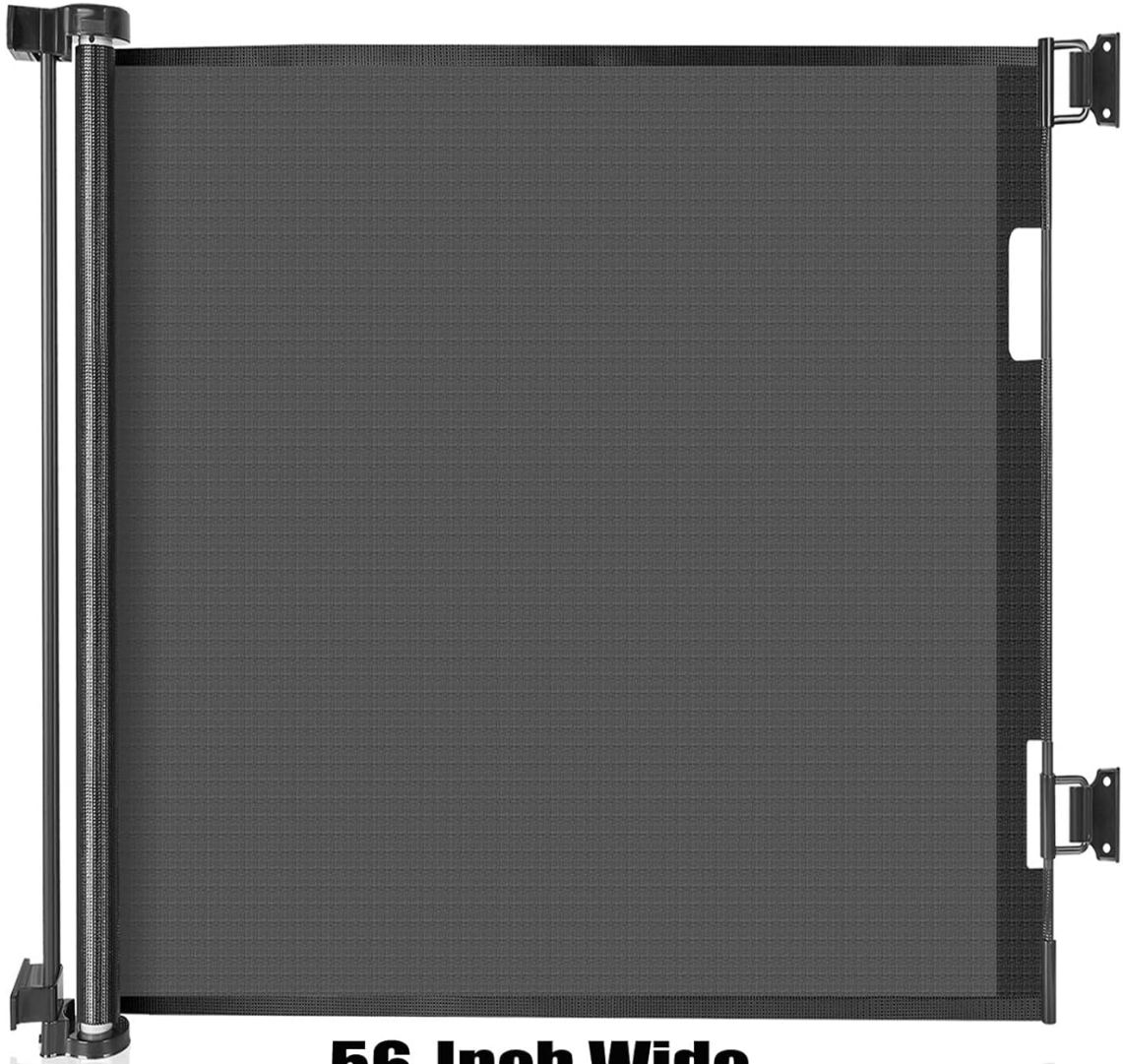

56-Inch Wide

Visual representation of the gate's dimensions: 42 inches tall and 56 inches wide.

RETRACTABLE DESIGN

Easy Retraction & No Trip Hazard



The retractable design of the gate, allowing for easy retraction and no trip hazard.

APPLICABLE SCENES



Examples of applicable scenes where the gate can be installed, including stairs, doorways, and various rooms.

Suitable for Babies and Pets

- 100% rust-proof
- Ideal for indoor + outdoor



The gate is suitable for both babies and pets, and is designed for both indoor and outdoor environments with 100% rust-proof materials.



Close-up of the durable and scratch-resistant baby-friendly mesh material.

3. SETUP AND INSTALLATION

The KISKIZ Retractable Baby Gate comes with all necessary installation accessories. Follow these steps carefully for secure mounting.

3.1. Before You Begin

- Identify your mounting surface (wood, drywall, concrete). Ensure it is strong enough to support the gate.
- Gather tools: drill, screwdriver, pencil, measuring tape.
- Unpack all components and verify against the parts list.



Included installation accessories: mounting brackets, screws, and wall anchors.

3.2. Installation Steps

1. **Determine Mounting Location:** Choose a flat, stable surface. Ensure the gate will cover the entire opening when extended.
2. **Mount the Main Gate Unit:** Position the main gate unit (where the mesh retracts) on one side of the opening. Mark the screw holes for the top and bottom brackets. Drill pilot holes and secure the brackets with screws. Use wall anchors if installing into drywall.
3. **Mount the Catch Brackets:** Extend the gate across the opening to the desired width. Position the catch brackets on the opposite side, ensuring they are level with the main unit's attachment points. Mark and drill holes, then secure the catch brackets.
4. **Adjust Lower Bracket:** The adjustable lower bracket allows for installation over baseboards. Adjust its position to ensure the gate sits flush and securely against the wall, preventing gaps.

ADJUSTABLE BRACKET

- Fit any skirting



The adjustable lower bracket allows for a secure fit over any skirting or baseboard.



Detailed view of the adjustable bracket for precise fitting.

3.3. Installation Orientation

The gate can be installed for both inside and outside opening/doorway configurations. Ensure the main gate unit is on the side from which you intend to pull the gate across.



Guidance on correct catch positions for inside and outside opening installations to ensure secure latching.

4. OPERATING INSTRUCTIONS

The KISKIZ Retractable Baby Gate is designed for easy, one-handed operation.

4.1. Opening the Gate

1. **Unlock:** Turn the knob on the top of the main gate unit to the unlock position.
2. **Pull Out:** Gently pull the gate handle across the opening.
3. **Hook On:** Hook the gate handle onto the catch brackets on the opposite side.
4. **Lock:** Turn the knob on the top of the main gate unit to the lock position to secure the gate.

4.2. Closing the Gate

1. **Unlock:** Turn the knob on the top of the main gate unit to the unlock position.
2. **Release:** Unhook the gate handle from the catch brackets.
3. **Retract:** Guide the gate handle back towards the main unit. The mesh will automatically retract. Ensure it retracts slowly and smoothly to prevent damage.

ONE-HANDED OPERATION



Visual guide for one-handed operation: unlock, pull out, buckle on, and lock.

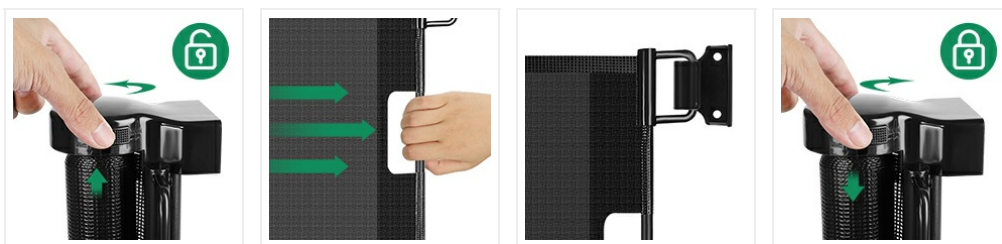

Detailed steps for unlocking, pulling out, buckling, and locking the gate.

Your browser does not support the video tag.

Official KISKIZ video demonstrating the operation and features of the 42-Inch Extra Tall Baby Gate.

5. MAINTENANCE

Proper maintenance will ensure the longevity and safe operation of your KISKIZ gate.

- **Cleaning:** Wipe the mesh and plastic components with a damp cloth and mild soap. Do not use abrasive cleaners or harsh chemicals.
- **Inspection:** Periodically check all mounting hardware, screws, and the mesh fabric for any signs of wear, damage, or loosening. Ensure the retraction mechanism operates smoothly.
- **Lubrication:** If the retraction mechanism becomes stiff, a small amount of silicone-based lubricant can be applied to the internal moving parts, avoiding contact with the mesh.

6. TROUBLESHOOTING

If you encounter issues with your KISKIZ gate, refer to the following common problems and solutions:

Problem	Possible Cause	Solution
Gate does not retract smoothly or jams.	Mesh is not aligned properly; internal mechanism is dirty or dry.	Ensure the mesh is guided back straight. Clean the mechanism and apply a small amount of silicone lubricant if needed.
Gate does not lock securely.	Knob not fully turned; gate not fully extended or hooked.	Ensure the knob is turned completely to the lock position. Verify the gate is fully extended and properly hooked onto both catch brackets.
Gaps at the bottom of the gate, allowing small pets/children to pass.	Lower bracket not adjusted correctly; uneven floor surface.	Adjust the lower bracket to sit flush with the floor or baseboard. If the floor is very uneven, consider shimming the lower bracket or finding a more suitable installation location.
Gate feels wobbly or loose after installation.	Mounting screws are loose; brackets are not securely fastened.	Tighten all mounting screws. Ensure wall anchors (if used) are properly installed and holding firmly. Re-evaluate the mounting surface for stability.

7. SPECIFICATIONS

Feature	Detail
Model Number	SH20.007
UPC	793869435297
Dimensions (Extended)	Up to 56" Wide x 42" High
Material	Mesh
Color	Black
Mounting Type	Door Mount
Target Species	Dog, Baby
Closure Type	Retractable
Item Weight	6.19 pounds

8. WARRANTY AND SUPPORT

KISKIZ products are manufactured to high-quality standards. For specific warranty information or technical support, please refer to the product packaging or contact KISKIZ customer service directly. Keep your purchase receipt for warranty claims.

For further assistance, please visit the official KISKIZ store or contact their customer support channels.

KISKIZ Store: <https://www.amazon.com/stores/ExtraWideBabyPetGates/page/25803FC5-20F3-4251-A4C2-ECF637331AD0>