

PERLESMITH PSMTK1, PSML1

PERLESMITH TV Wall Mount Instruction Manual

Models: **PSMTK1 (Tilting)** & **PSML1 (Fixed)**
For Most 23-60 inch TVs up to 115 lbs

1. INTRODUCTION

This manual provides detailed instructions for the safe and proper installation and use of your PERLESMITH Tilting TV Wall Mount (PSMTK1) and Fixed TV Wall Mount (PSML1). Please read all instructions carefully before installation to ensure correct assembly and to prevent injury or damage.

2. SAFETY INFORMATION

- **Weight Capacity:** Do not exceed the maximum weight capacity of 115 lbs (52 kg). Exceeding this limit may result in serious injury or property damage.
- **TV Size:** Ensure your TV size is within the specified range for the mount (PSMTK1: 23-60 inches; PSML1: 26-60 inches).
- **Wall Type:** This mount is designed for installation on 16-inch wood studs, solid concrete, or brick walls. **DO NOT install on drywall alone.**
- **Professional Installation:** If you are unsure about the installation process or the suitability of your wall, consult a qualified professional installer.
- **Check VESA:** Verify your TV's VESA mounting hole pattern is compatible with the mount before proceeding.
- **Cable Management:** Ensure all cables are routed safely and do not interfere with the mount's operation or TV's stability.

3. PACKAGE CONTENTS

Please verify that all components are present and undamaged before installation. If any parts are missing or defective, contact PERLESMITH customer service.

The package includes the wall plate, TV brackets, and various hardware for mounting to different wall types and TV models. A small level and cable ties are also typically included.

4. SPECIFICATIONS

| Feature | PSMTK1 (Tilting) | PSML1 (Fixed) |
|-----------------------|------------------|---------------|
| TV Size Compatibility | 23" - 60" | 26" - 60" |

| Feature | PSMTK1 (Tilting) | PSML1 (Fixed) |
|--------------------|---|---|
| Weight Capacity | Up to 115 lbs (52 kg) | Up to 115 lbs (52 kg) |
| VESA Compatibility | 75x75mm to 400x400mm | 75x75mm to 400x400mm |
| Tilt Angle | Up to 15 degrees | N/A (Fixed) |
| Profile from Wall | Approx. 1.2 inches | Approx. 1.18 inches |
| Material | Alloy Steel | Alloy Steel |
| Wall Types | 16-inch Wood Studs, Solid Concrete, Brick | 16-inch Wood Studs, Solid Concrete, Brick |

VESA Compatible

400x400mm | 400x300mm | 400x200mm | 300x300mm
 300x200mm | 200x200mm | 200x100mm | 100x100mm | 75x75mm

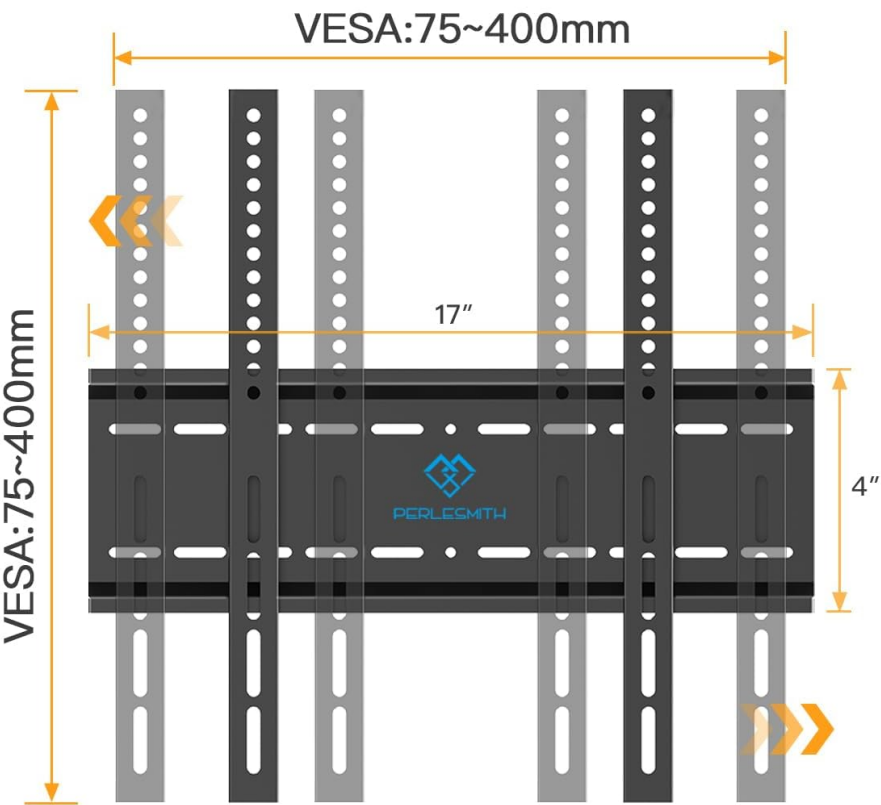

Please note: Only fit the mounting hole 400mm/16" or less.
 Can't fit VESA 600x200mm and 600x400mm.

Image: VESA compatibility diagram showing various patterns from 75x75mm to 400x400mm, with a note that it fits mounting holes 400mm/16 inches or less, and does not fit VESA 600x200mm and 600x400mm.

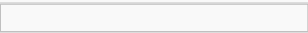

Image: Diagram illustrating compatible VESA patterns, showing horizontal and vertical measurements on the back of a TV, with maximum 400x400mm and minimum 75x75mm.

5. SETUP AND INSTALLATION

5.1 Pre-Installation Checks

- **Verify TV Compatibility:** Check your TV's VESA mounting hole pattern, weight, and screen size against the specifications.
- **Check Wall Type:** Identify your wall type (wood studs, concrete, or brick) to use the appropriate hardware.
- **Locate Studs:** For wood stud installation, use a stud finder to accurately locate the center of the wood studs.
- **Clearance:** Ensure the TV ports will not be blocked by the mount once installed.

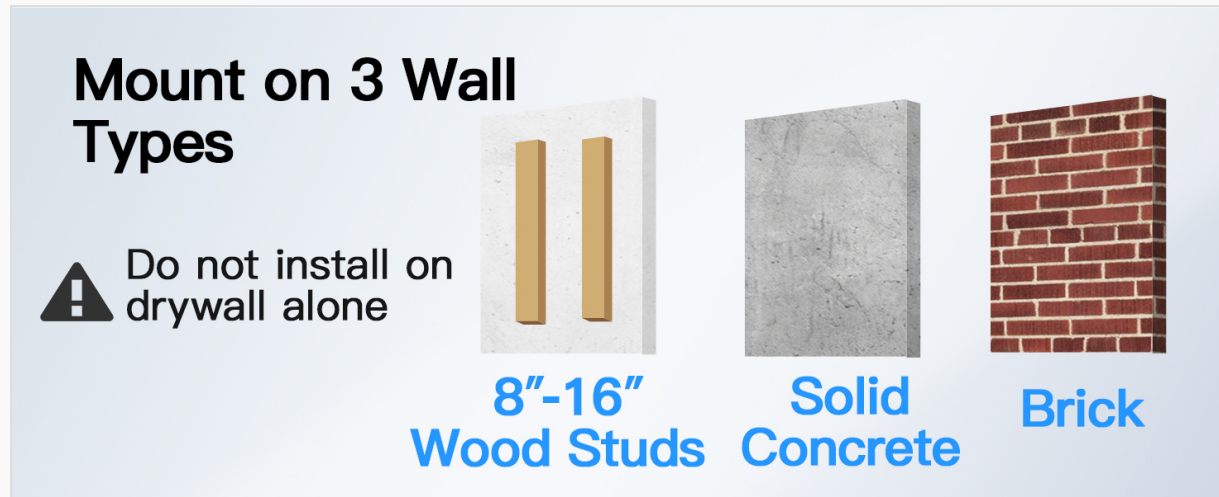

Image: Illustration showing the three compatible wall types: 8"-16" Wood Studs, Solid Concrete, and Brick. A warning states: "Do not install on drywall alone."

5.2 Installation Steps

1. **Attach TV Brackets to TV:** Secure the vertical TV brackets to the back of your television using the appropriate screws, washers, and spacers from the hardware kit. Ensure the brackets are centered and level.
2. **Mount Wall Plate to Wall:** Mark the desired height for your TV. For wood studs, drill pilot holes into the center of the studs and secure the wall plate using lag bolts. For concrete/brick, use a masonry drill bit, insert anchors, and then secure the wall plate with lag bolts. Use the included level to ensure the wall plate is perfectly horizontal.
3. **Hang TV on Wall Plate:** Carefully lift the TV with the attached brackets and hook them onto the wall plate. Ensure the TV is securely seated on the wall plate.
4. **Secure TV to Mount:** For PSMTK1, pull down the quick-release straps to engage the locking mechanism, securing the TV to the wall plate. For PSML1, ensure the safety screws are tightened to prevent accidental dislodgement.

No Sweat – It's One Piece of Cake To Install

12
min

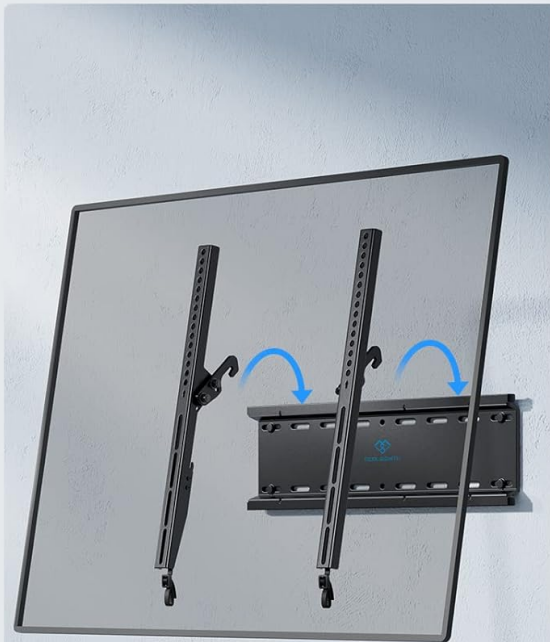

Installation simplified like 1-2-3

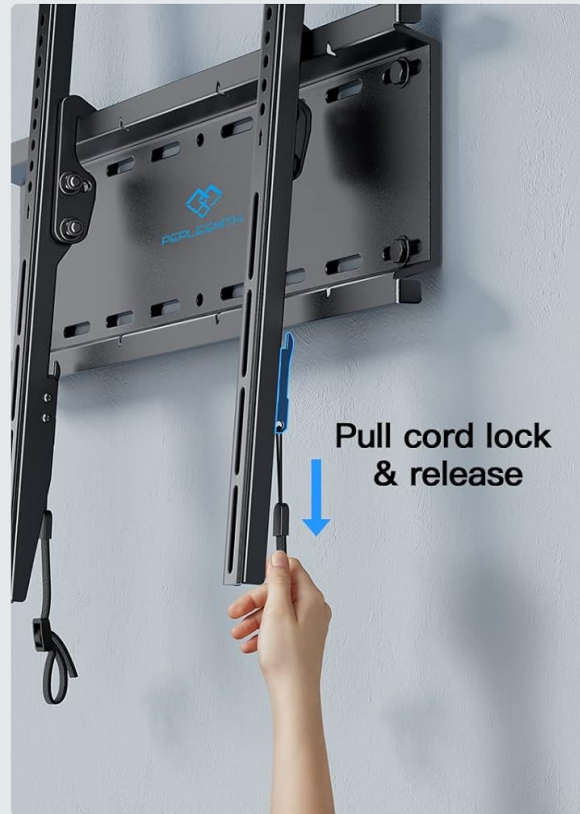

Image: Visual representation of simplified installation, showing TV brackets being attached to the TV, and then the TV being hung onto the wall plate, followed by using the pull cord for locking/release.

Stronger Support

1.5x Taller Plate | 115 lbs Max Weight

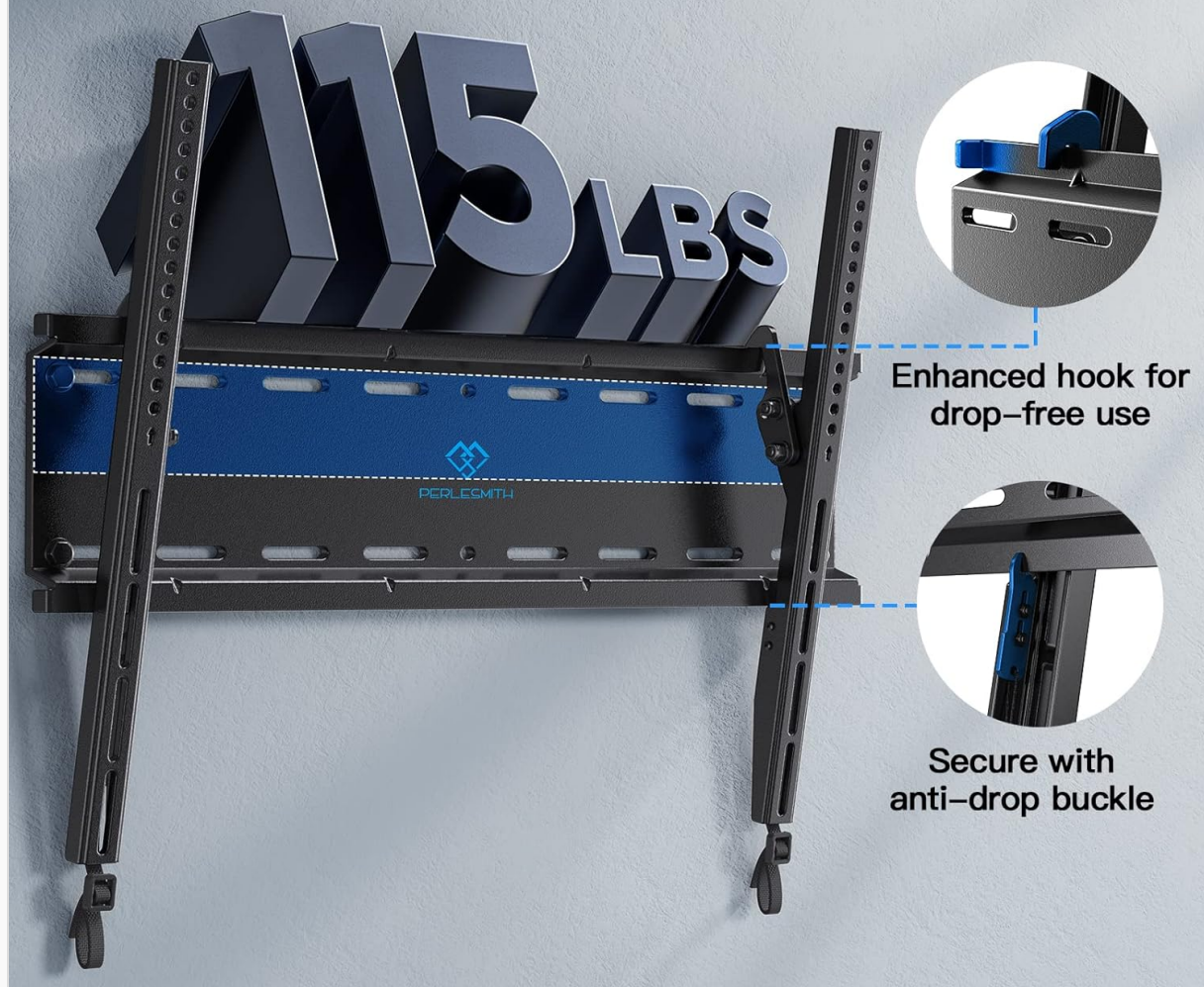

Image: Close-up view of the tilting mount highlighting 'Stronger Support' with 115 lbs max weight, an 'Enhanced hook for drop-free use', and a 'Secure with anti-drop buckle' mechanism.

SAFE & DURABLE



Image: Detailed views of the mount's safety features, including a 'Safety Lock', 'Sturdy Hook', and 'Anti-drop Design'.

6. OPERATING INSTRUCTIONS (PSMTK1 TILTING MOUNT)

The PSMTK1 model allows for tilting your TV to achieve optimal viewing angles and reduce glare.

- **Adjusting Tilt:** Gently push or pull the bottom of your TV to adjust the tilt angle. The mount allows for up to 15 degrees of tilt.
- **Locking/Unlocking:** The pull-down straps on the TV brackets are used to engage or disengage the locking mechanism. Pulling them down releases the TV from the wall plate for removal or adjustment. Ensure they are securely engaged after positioning the TV.



Image: A TV mounted on the wall, demonstrating a -7 degree tilt to reduce glare, with text indicating compatibility for 23"-60" TVs and listing various VESA patterns.

7. MAINTENANCE

- **Cleaning:** Clean the mount with a soft, dry cloth. Avoid abrasive cleaners or solvents.
- **Periodic Checks:** Periodically check all screws and connections to ensure they remain tight and secure.
- **Inspect for Damage:** Regularly inspect the mount for any signs of wear or damage. If any damage is observed, discontinue use and contact customer support.

8. TROUBLESHOOTING



- **TV Not Level:** If the TV is not level after installation, carefully adjust the wall plate or TV brackets as needed. Some mounts offer post-installation leveling adjustments.
- **Difficulty Hanging TV:** Ensure the TV brackets are correctly aligned with the wall plate hooks. Check for any obstructions.
- **Mount Feels Loose:** Re-check all wall mounting screws and TV bracket screws to ensure they are tightened according to the instructions. Do not overtighten.

9. CUSTOMER SUPPORT

For any questions, missing parts, or technical assistance, please contact PERLESMITH customer service. Refer to the product packaging or the PERLESMITH website for contact information.

© 2025 PERLESMITH. All rights reserved.

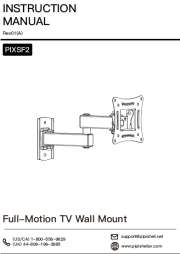
Related Documents

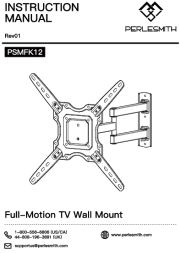
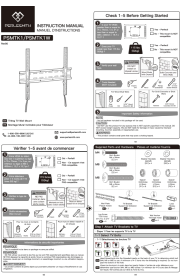
| | |
|---|---|
|  | <p>PIXSF2 Full-Motion TV Wall Mount Installation Manual</p> <p>This manual provides instructions for installing the PIXSF2 Full-Motion TV Wall Mount. It covers safety information, compatibility checks, and step-by-step assembly for various wall types, including wood studs and solid concrete.</p> |
|  | <p>PERLESMITH PSXLF01 Full-Motion TV Wall Mount Installation Manual</p> <p>Comprehensive instruction manual for the PERLESMITH PSXLF01 Full-Motion TV Wall Mount. Covers compatibility checks, parts list, and detailed step-by-step installation instructions for mounting on wood studs and solid concrete walls. Includes safety warnings and adjustment guides.</p> |
|  | <p>PERLESMITH PSMFK12 Full-Motion TV Wall Mount Instruction Manual</p> <p>Comprehensive instruction manual for the PERLESMITH PSMFK12 Full-Motion TV Wall Mount, covering installation, safety, and adjustment for TVs up to 77lbs with VESA patterns up to 400x400mm.</p> |
|  | <p>Perlesmith PSMTK1/PSMTK1W Tilting TV Wall Mount: Installation Guide</p> <p>Comprehensive instruction manual for the Perlesmith PSMTK1/PSMTK1W tilting TV wall mount. Learn how to safely install your TV, check compatibility, and adjust tilt angles. Includes parts list and step-by-step assembly instructions.</p> |

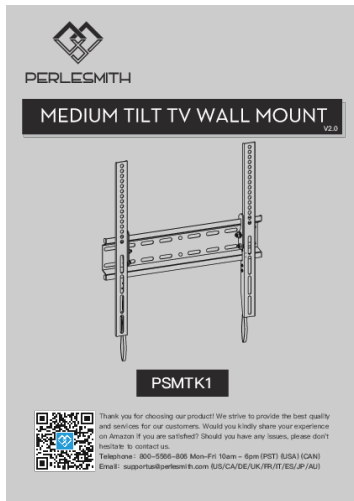

[\[pdf\]](#) User Manual

PSMTK1 V2 0 Administrator PERLESMITH PSMTK1 Tilt TV Wall Mount Manual Shopify No information is available for this page cdn shopify s files 1 0023 5949 2723 |||

V2.0 **PSMTK1** Thank you for choosing our product We strive to provide the best quality and services for our customers. Would you kindly share your experience on Amazon if you are satisfied Should you have any issues, please don t hesitate to contact us. Telephone800-5566-806 Mon-Fri 10am - 6pm PST ...
lang:en score:35 filesize: 6.31 M page_count: 8 document date: 2019-03-22

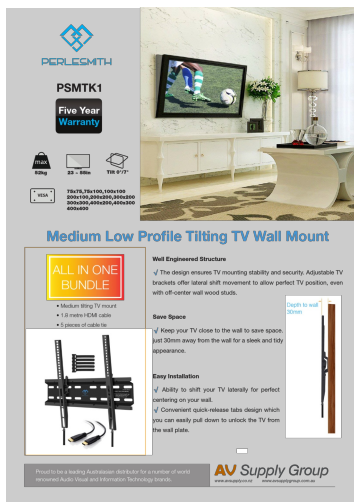

[\[pdf\]](#) Warranty

PSMTK1 SS avsupply co nz site files Perlesmith |||

PSMTK1 Five Year Warranty max 52kg VESA 23 - 55in Tilt 0/7
75x75,75x100,100x100 200x100,200x200,300x200 300x300,400x200,400x300
400x400 Medium Low Profile Tilting TV Wall Mount ALL IN ONE BUNDLE Medium
tilting TV mount 1.8 metre HDMI cable 5 pieces of cable tie Well Engineered Structure
T...
lang:en score:30 filesize: 3.4 M page_count: 1 document date: 2018-11-05

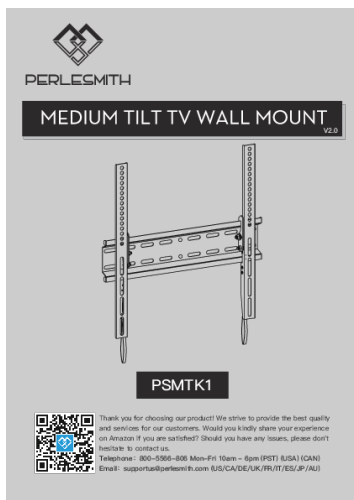

[\[pdf\]](#) User Manual

var www html sideloads perlesmith psmtk1 medium tilt tv wall mount installation manual original
Installation Assembly Furnimics Single Screen Wall Mount ghnj1016 HN T0018Furnimics
T0018installation assemblysecure img1 ag wfcdn dm document 7ced6970 3319 4012 a511
e6b41469d349 assembly |||

V2.0 **PSMTK1** Thank you for choosing our product We strive to provide the best quality and services for our customers. Would you kindly share your experience on Amazon if you are satisfied Should you have any issues, please don t hesitate to contact us. Telephone800-5566-806 Mon-Fri 10am - 6pm PST ...
lang:en score:29 filesize: 6.31 M page_count: document date:

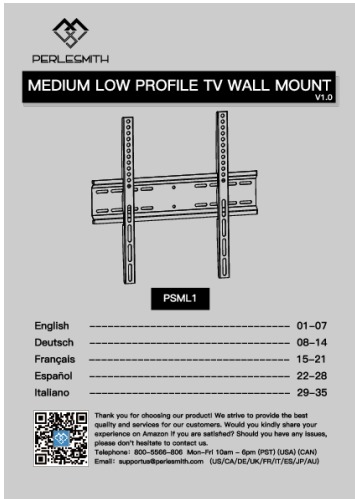

[\[pdf\]](#) User Manual

PSML1 V1 0 2019 6 00 Administrator INSTALLATION MANUAL PERLESMITH Fixed TV Wall Mount Bracket for 26 55 Inch TVs perlesmith C1pP PmNnuS images na ssl amazon I |||

...

lang:en score:20 filesize: 6.04 M page_count: 36 document date: 2019-06-12

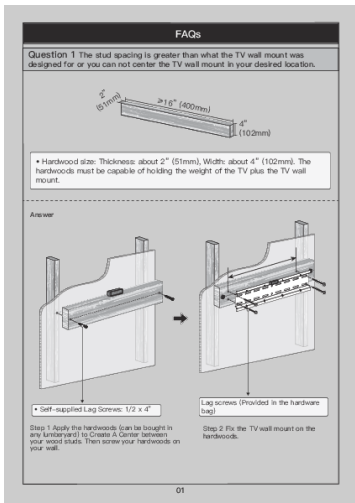

[\[pdf\]](#) Installation Guide Frequently Asked Questions Troubleshooting Guide Guide

PSMTK1 C PSMTK1D PSMTK1P PSMTK1G FAQs Troubleshooting Guide Amazon PERLESMITH Tilting TV Wall Mount Bracket Low Profile for Most 23 60 inch LED LCD OLED Plasma Flat Screen TVs with VESA 400x400mm Weight up to 115lbs Fits 16 Wood Stud Electronics D1 pAwSryhL m media amazon images I |||

FAQs Question 1 The stud spacing is greater than what the TV wall mount was designed for or you can not center the TV wall mount in your desired location. 521 mm 16 400mm 4 102mm Hardwood size: Thickness: about 2 51mm , Width: about 4 102mm . The hardwoods must be capable of holding...

lang:fr score:19 filesize: 8.92 M page_count: 4 document date: 2023-08-25



[\[pdf\]](#) Installation Guide Warranty

PSMTK1 SS PSLT9 avsupply co nz site files Perlesmith |||

PSLT9 Five Year Warranty Extra Large Tilting TV Wall Mount max 75kg 42 - 85in Tilt -12/5 VESA 200x100,200x200,300x200 300x300,400x200,400x300 400x400,600x300,600x400 Post Install level and horizontal adjustment Conveniently adjust level by adjust the screws after mounting. You can have your ...

lang:en score:18 filesize: 747.71 K page_count: 1 document date: 2020-08-27

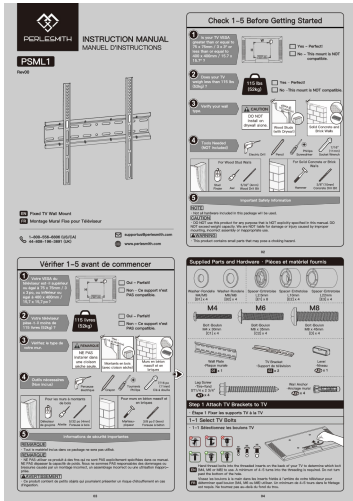

[pdf] User Manual

860 02264 00 Rev00 PSML1 C Manual YZ 2023 09 20 listing zq PERLESMITH Fixed TV Wall Mount Bracket Low Profile Design for Most 26 60 inch LED LCD OLED 4K Flat Screen TVs up to 115lb Ultra Slim with Max VESA 400x400mm Fits 16 Wood Stud PSML1 User PERLESMITH B1DYxRcmz L m media amazon images I |||

...

lang:en score:17 filesize: 3.15 M page_count: 2 document date: 2024-01-31

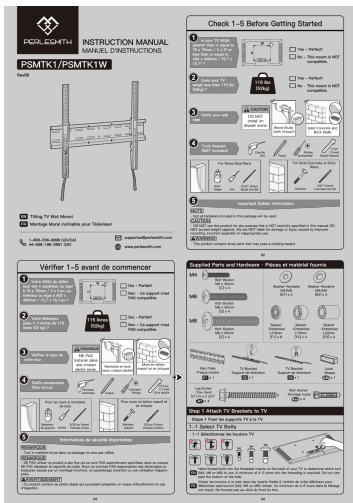

Perlesmith PSMTK1/PSMTK1W Tilting TV Wall Mount: Installation Guide

Comprehensive instruction manual for the Perlesmith PSMTK1/PSMTK1W tilting TV wall mount. Learn how to safely install your TV, check compatibility, and adjust tilt angles. Includes parts list and step-by-step assembly instructions.

lang:en score:14 filesize: 3.26 M page_count: 2 document date: 2024-01-09



[pdf] User Manual

860 00182 06 Rev02 B PSMTK1 C Manual YN 2023 03 31 zq User Amazon PERLESMITH Tilting TV Wall Mount Bracket Low Profile for Most 23 60 inch LED LCD OLED Plasma Flat Screen TVs with VESA 400x400mm Weight up to 115lbs Fits 16 Wood Stud Electronics B15rXmiGj5L m media amazon images I |||

...

lang:en score:14 filesize: 3.57 M page_count: 12 document date: 2023-08-21