

## UrbanX KBM030

# UrbanX KBM030 Rechargeable Bluetooth Keyboard and Mouse Combo Instruction Manual

## INTRODUCTION

This manual provides detailed instructions for the setup, operation, and maintenance of your UrbanX KBM030 Rechargeable Bluetooth Keyboard and Mouse Combo. This combo is designed for broad compatibility across various operating systems and devices, offering a cable-free experience with ergonomic design and long-lasting rechargeable batteries.

## PACKAGE CONTENTS

Please verify that all items are present in your package:

- UrbanX KB030 Bluetooth Keyboard
- UrbanX M030 Bluetooth Mouse
- USB Charging Cable
- Welcome Guide

## SETUP INSTRUCTIONS

### 1. Keyboard Setup

- Charge the Keyboard:** Connect the provided USB charging cable to the keyboard's charging port and a USB power source. The 'Charge Power' indicator light will illuminate during charging.
- Power On:** Locate the ON/OFF switch on the top right side of the keyboard and slide it to the 'ON' position. The 'Power' indicator light will briefly turn on.
- Enter Pairing Mode:** Press the 'Connect' button, usually located near the ON/OFF switch. The 'Connect' indicator light will start blinking, indicating the keyboard is ready for pairing.
- Pair with Your Device:** On your device (computer, tablet, smartphone), enable Bluetooth and search for available devices. Select 'UrbanX Keyboard' or a similar name from the list. Follow any on-screen prompts to complete the pairing process.
- Select Operating System Mode:** The keyboard supports multiple operating systems. After pairing, press the appropriate function key combination for your device's OS:

- For iOS: Press **Fn + E**
- For Android: Press **Fn + Q**
- For Windows: Press **Fn + W**



*Image: UrbanX Bluetooth Keyboard showing the ON/OFF switch, Connect button, and indicator lights (CAPS, Charge Power). The image also illustrates the keyboard's dimensions.*

# Supports 3 Operating Systems

IOS / Android / Windows



*Image: UrbanX Bluetooth Keyboard highlighting its compatibility with iOS, Android, and Windows operating systems, indicated by respective logos.*

## 2. Mouse Setup

1. **Charge the Mouse:** Connect the provided USB charging cable to the mouse's charging port and a USB power source.
2. **Power On:** Locate the ON/OFF switch on the bottom of the mouse and slide it to the 'ON' position.
3. **Enter Pairing Mode:** The mouse typically enters pairing mode automatically when powered on for the first time or if it loses connection. If not, press the pairing button (often located near the ON/OFF switch on the bottom) until the indicator light blinks.
4. **Pair with Your Device:** On your device, enable Bluetooth and search for available devices. Select 'UrbanX Mouse' or a similar name from the list. Follow any on-screen prompts to complete the pairing process.

## OPERATING INSTRUCTIONS

### Keyboard Functions

- **Quiet Typing:** The low-profile keys are designed for comfortable and quiet typing.
- **Function Keys:** The keyboard features system-specific function keys for quick access to common functions such as volume control, media playback, and copy/paste operations. These functions are typically accessed by pressing the **Fn** key in combination with the corresponding F-key.
- **Operating Range:** The keyboard operates wirelessly via Bluetooth up to a distance of 30 feet (approximately 10 meters) from your paired device.



## Comfortable Keystrokes

X structure, exert equal pressure and lower keystrokes in comparison with the clickety keyboard.

*Image: Close-up view of the UrbanX Bluetooth Keyboard, illustrating the X-structure key mechanism designed for comfortable keystrokes.*

### Mouse Functions

- **Ergonomic Design:** The mouse is designed to reduce stress during prolonged use.
- **Adjustable DPI:** The mouse features a DPI switch button, allowing you to cycle through three sensitivity levels: 800 DPI, 1200 DPI, and 1600 DPI. Press the button to adjust the cursor speed to your preference.





The diagram features a teal-colored computer mouse on the right. To its left is a circular graphic divided into three segments, each representing a different DPI level: 800 DPI at the bottom, 1200 DPI on the left, and 1600 DPI at the top. A line points from the text 'PRESS TO SWITCH 3 GRADE DPI' to a small circular button on the side of the mouse.

## High Sensitivity

Easily switch between 3 DPI levels and adjust the speed of the mouse

*Image: Diagram illustrating the DPI switch on the UrbanX Bluetooth Mouse and the three adjustable sensitivity levels: 800, 1200, and 1600 DPI.*

### CHARGING INSTRUCTIONS

Both the keyboard and mouse are equipped with built-in rechargeable Li-polymer batteries.

- **Charging Process:** Use the provided USB charging cable to connect the keyboard or mouse to a standard USB power source (e.g., computer USB port, USB wall adapter).
- **Charging Indicators:** For the keyboard, the 'Charge Power' indicator light will be on during charging and turn off when fully charged. For the mouse, an indicator light (often red) will show charging status and turn off when complete.
- **Battery Life:** A single full charge provides approximately 6 months of use for the keyboard and 4 months for the mouse (based on 2 hours of non-stop use per day).

# Rechargeable Wireless Mouse

Built-in rechargeable battery, easy to charge by micro usb cable  
no more need for extra AAA battery.

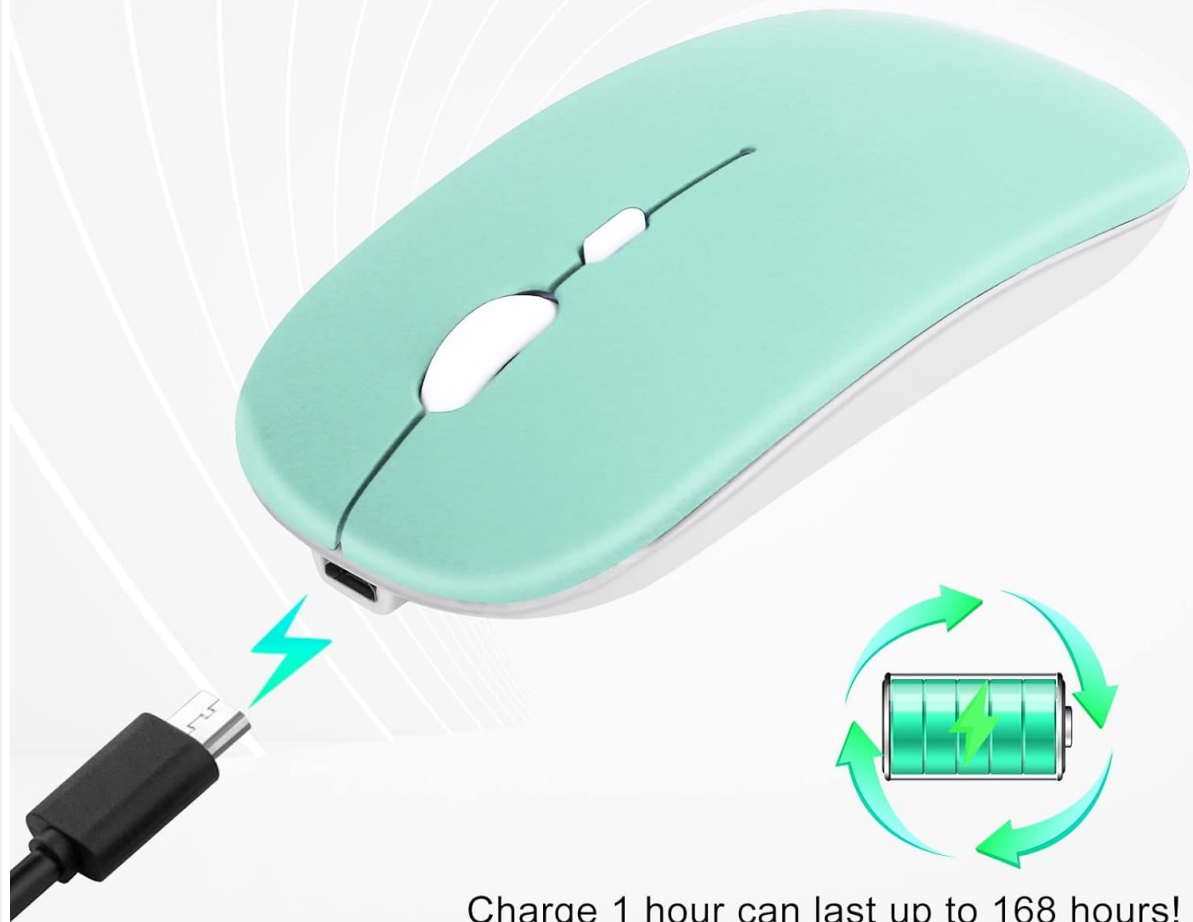

Charge 1 hour can last up to 168 hours!

*Image: UrbanX Bluetooth Mouse being charged via a Micro USB cable, with an illustration of a rechargeable battery indicating long-lasting power.*

## MAINTENANCE

- **Cleaning:** Use a soft, dry cloth to clean the surfaces of the keyboard and mouse. For stubborn dirt, a slightly damp cloth can be used, ensuring no moisture enters the device. Avoid harsh chemicals or abrasive cleaners.
- **Battery Care:** To prolong battery life, avoid exposing the devices to extreme temperatures. Charge the devices regularly, even if not in constant use, to prevent deep discharge.
- **Storage:** When not in use for extended periods, store the keyboard and mouse in a cool, dry place.

## TROUBLESHOOTING

- **Device Not Connecting:**
  - Ensure both the keyboard and mouse are powered on and fully charged.
  - Verify that Bluetooth is enabled on your host device.
  - Make sure the devices are within the 30-foot (10-meter) operating range.
  - Try re-entering pairing mode on the keyboard/mouse and re-pairing with your device.

- Remove previous pairings from your device's Bluetooth settings and try pairing again.
- **Keyboard Not Typing:**
  - Check if the keyboard is connected via Bluetooth.
  - Ensure the correct operating system mode (Fn+E/Q/W) is selected.
  - Verify the battery level.
- **Mouse Cursor Not Moving:**
  - Check if the mouse is connected via Bluetooth.
  - Verify the battery level.
  - Ensure the mouse sensor is clean and unobstructed.
  - Try adjusting the DPI setting.

## SPECIFICATIONS

Feature	Detail
Model Number	KBM030
Product Dimensions (Keyboard)	15.16 x 5.47 x 1.3 inches
Item Weight (Combo)	10 ounces
Batteries	2 Lithium Ion batteries (included)
Brand	UrbanX
Connectivity Technology	Bluetooth
Special Features	Ergonomic, Rechargeable
Compatible Devices	Laptop, Mobile Phone, Smartphone, T-Mobile REVVL V+ 5G, Tablet

## WARRANTY AND SUPPORT

Your UrbanX KBM030 Rechargeable Bluetooth Keyboard and Mouse Combo comes with a**90-day warranty**. For any product inquiries, technical support, or warranty claims, please contact UrbanX customer service. Refer to the included Welcome Guide for specific contact information or visit the official UrbanX website.