

Dripex NEL-02

Dripex Electric Standing Desk User Manual

Model: NEL-02

1. INTRODUCTION

Thank you for choosing the Dripex Electric Height Adjustable Standing Desk. This manual provides essential information for the safe assembly, operation, and maintenance of your new desk. Please read it thoroughly before use and keep it for future reference.



Figure 1.1: Dripex Electric Standing Desk (Walnut, 160x75 cm)

This image shows the complete Dripex Electric Standing Desk setup, featuring a spacious walnut-colored tabletop, sturdy black legs, and an integrated control panel. It is equipped to hold multiple monitors, a laptop, and various office accessories, demonstrating its ample workspace.

2. SAFETY INFORMATION

To ensure safe operation and prevent injury, please adhere to the following safety guidelines:

- Do not exceed the recommended weight limit of **80 kg (176 lbs)** on the desktop. Overloading can cause damage or instability.
- Avoid touching moving parts (e.g., lifting columns) during operation. Keep hands, hair, and clothing clear of all

moving mechanisms.

- Ensure the desk is stable and level before placing heavy items on it or adjusting its height.
- Keep children and pets away from the desk during height adjustments to prevent accidents.
- Do not sit or stand on the desk.
- Only use the provided power adapter and components.
- If the desk makes unusual noises, stops moving, or shows signs of damage, disconnect it from the power supply immediately and contact customer support.
- The desk features an **anti-collision system** to prevent damage if it encounters an obstacle during movement. However, always be aware of your surroundings.
- The motor includes **overload protection** to prevent damage from excessive weight or prolonged use.



Figure 2.1: Safety Features Overview

This diagram highlights key safety features: anti-collision technology that stops movement upon encountering an obstacle, overload protection for the motor, and a low noise operation (under 45dB) ensuring a quiet working environment.

3. PRODUCT COMPONENTS

Before assembly, ensure all components are present and undamaged. Refer to the packing list for a complete inventory.

- Desktop (Walnut, 160 x 75 cm)
- Lifting Columns (Legs)
- Foot Supports
- Control Panel
- Motor
- Power Adapter & Cable
- Assembly Hardware (Screws, Allen wrenches)
- Optional Accessories: Cup Holder, Headphone Hook, Cable Management Clips, Adjustable Feet

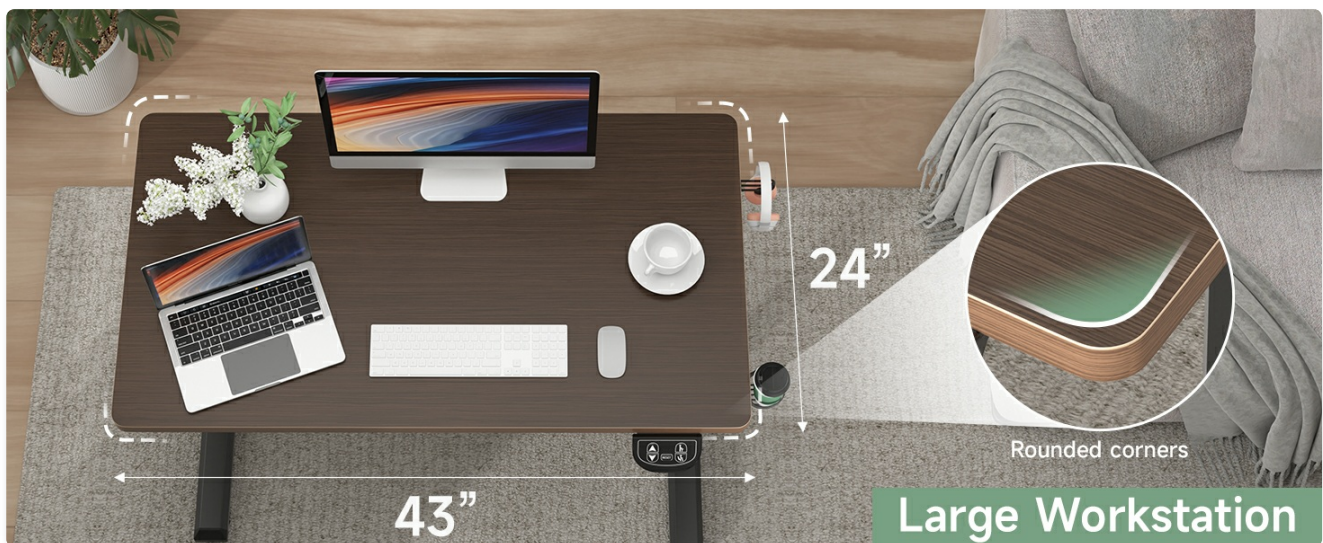

Figure 3.1: Included Accessories

This image displays additional accessories that may be included with your desk, such as a desk mat, a convenient cup holder, a headphone hook for organization, and adjustable feet for leveling the desk on uneven surfaces.

4. ASSEMBLY INSTRUCTIONS

Follow these steps carefully for proper assembly. All necessary tools are typically included.

1. Step 1: Install the Motor

Attach the motor to the crossbar frame according to the diagrams. Ensure all connections are secure.

2. Step 2: Install the Frame

Assemble the main frame structure, connecting the crossbar with the motor to the leg columns.

3. Step 3: Install the Table Legs

Securely attach the foot supports to the bottom of the lifting columns.

4. Step 4: Install the Tabletop

Carefully place the desktop onto the assembled frame and secure it using the provided screws. Attach the control panel to the underside of the desktop in your preferred location.

Extra Giveaways



Figure 4.1: Simple 4-Step Assembly

This visual guide illustrates the straightforward four-step assembly process: first, install the motor; second, assemble the main frame; third, attach the table legs; and finally, secure the tabletop to the frame.

5. OPERATION GUIDE

Your Dripex Electric Standing Desk features an intuitive control panel for easy height adjustment and memory functions.

Control Panel Functions:

Dripex



Intelligent Control Lifter



UP/Down function



Sedentary



Reset



Sitting/standing



Time setting



Others



Only raise/lower function

No digital display function (you will not know the exact lift height) No memory function (you will spend a long time on each adjustment)



Figure 5.1: Intelligent Control Panel

This image provides a detailed view of the desk's intelligent control panel, highlighting its various buttons: Up/Down for height adjustment, Sedentary reminder, Reset, and Sitting/Standing preset buttons.

- **Up/Down Arrows (▲ / ▼):** Press and hold to raise or lower the desk to your desired height.
- **Memory Presets (1, 2, 3, 4):** To save a height, adjust the desk to the desired position, then press the 'M' button followed by the desired number (e.g., M + 1). To recall a saved height, simply press the corresponding number button.
- **Sedentary Reminder (T):** Activates a timer to remind you to change positions (e.g., from sitting to standing). Refer to the full manual for setting specific intervals.
- **Reset (RESET):** If the desk encounters an error or does not move smoothly, press and hold the RESET button until the desk moves to its lowest position and then slightly up, indicating a successful reset.
- **Sitting/Standing Presets (Person Sitting/Person Standing icons):** Quickly switch between pre-programmed sitting and standing heights.

Ergonomic Benefits:

Utilizing the height adjustment feature allows you to alternate between sitting and standing throughout your workday, promoting better posture and reducing discomfort associated with prolonged sitting.

Height adjustable electric desk

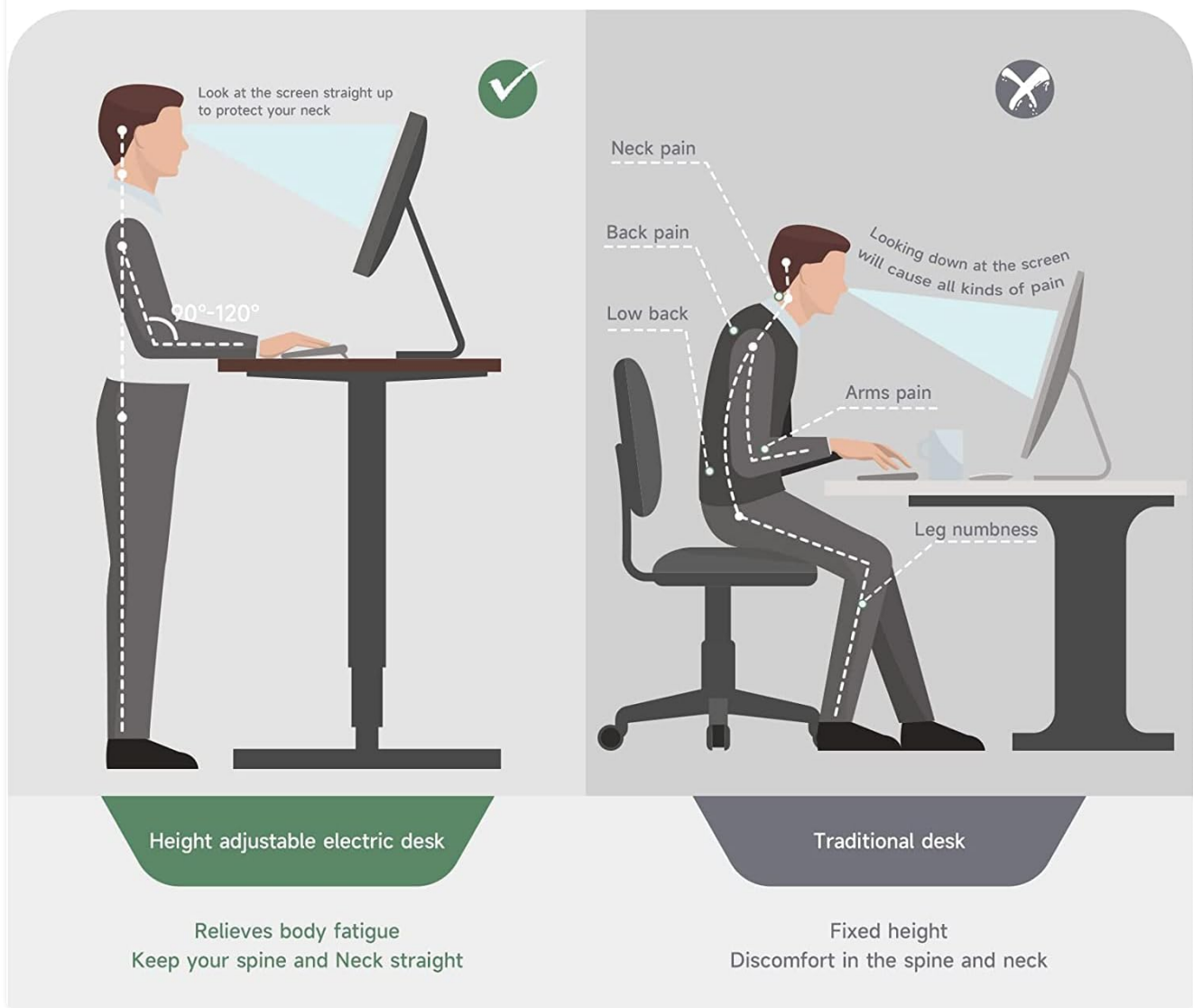

Figure 5.2: Ergonomic Posture Comparison

This illustration compares the ergonomic advantages of a height-adjustable electric desk to a traditional fixed-height desk. It demonstrates how an adjustable desk helps maintain a straight spine and neck, alleviating common issues like neck pain, back pain, and leg numbness often experienced with static sitting postures.

6. MAINTENANCE AND CARE

Regular maintenance will ensure the longevity and optimal performance of your desk.

- **Cleaning:** Wipe the desktop and legs with a soft, damp cloth. Avoid abrasive cleaners or harsh chemicals that may damage the finish.
- **Inspections:** Periodically check all screws and connections to ensure they are tight. Retighten if necessary.
- **Cable Management:** Keep cables organized and clear of moving parts to prevent entanglement or damage.
- **Motor Care:** The motor is designed for durability. Avoid continuous operation for extended periods without rest to prevent overheating.

7. TROUBLESHOOTING

If you encounter any issues with your desk, refer to the following common problems and solutions:

Problem	Possible Cause	Solution
Desk does not move or respond to controls.	Power cable disconnected, motor error, overload.	Check power connections. Perform a RESET (see Operation Guide). Reduce weight on desk.
Desk moves unevenly or makes unusual noises.	Loose connections, obstruction, uneven weight distribution.	Check all assembly screws. Ensure no obstructions. Redistribute weight evenly. Perform a RESET .
Anti-collision system frequently activates.	Obstruction in path, sensitive setting.	Clear any obstacles. If issues persist, consult the full manual for sensitivity adjustment (if available).
Memory function not working.	Incorrect saving procedure.	Ensure you press 'M' then the number button to save. Perform a RESET if needed.

If the problem persists after attempting these solutions, please contact Dripex customer support.

8. SPECIFICATIONS

Feature	Detail
Brand	Dripex
Model Number	NEL-02
Desktop Dimensions	160 cm (Width) x 75 cm (Depth)
Height Adjustment Range	71 cm - 117 cm (28 inches - 46 inches)
Color	Walnut
Material	Wood (Desktop), Steel (Frame)
Weight Capacity	80 kg (176 lbs)
Noise Level	<45 dB
Special Features	Electric Height Adjustment, Memory Function, Anti-Collision, Overload Protection, Ergonomic Design
Product Weight	Approx. 23 kg (50.7 lbs)



Figure 8.1: Desk Dimensions (Centimeters)

This diagram provides the key dimensions of the desk in centimeters, including the tabletop width (160cm), depth (75cm), and the adjustable height range from 71cm to 116cm.



Figure 8.2: Desk Dimensions (Inches)

This diagram provides the key dimensions of the desk in inches, including the tabletop width (63 inches), depth (28 inches), and the adjustable height range from 28 inches to 46 inches.

STURDY AND STABLE

80kg. load capacity

80KG



Figure 8.3: Maximum Load Capacity

This image visually represents the desk's robust 80kg (176 lbs) load capacity, demonstrating its ability to support a significant amount of equipment and materials.

9. WARRANTY AND SUPPORT





For warranty information, please refer to the documentation included with your purchase or visit the official Dripex website. Warranty terms and conditions may vary by region and retailer.

If you require technical assistance, have questions about assembly, or need to report a defect, please contact Dripex customer support through the retailer where you purchased the product or via the contact information provided on the official Dripex website.

Online Resources:

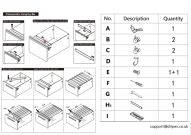
- Dripex Official Website: [Visit Dripex Store on Amazon](#)

Related Documents - NEL-02

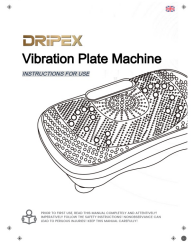
	<p>Driplex Basketball Hoop Installation and Safety Guide</p> <p>Comprehensive instructions for assembling and safely using the Driplex Basketball Hoop, including parts list, safety warnings, and height adjustment guidance.</p>																														
 <table><tr><th>No.</th><th>Description</th><th>Quantity</th></tr><tr><td>A</td><td>Top</td><td>1</td></tr><tr><td>B</td><td>Drawer</td><td>2</td></tr><tr><td>C</td><td>Drawer</td><td>2</td></tr><tr><td>D</td><td>Drawer</td><td>1</td></tr><tr><td>E</td><td>Top</td><td>1+1</td></tr><tr><td>F</td><td>Drawer</td><td>1</td></tr><tr><td>G</td><td>Drawer</td><td>1</td></tr><tr><td>H</td><td>Drawer</td><td>1</td></tr><tr><td>I</td><td>Drawer</td><td>1</td></tr></table>	No.	Description	Quantity	A	Top	1	B	Drawer	2	C	Drawer	2	D	Drawer	1	E	Top	1+1	F	Drawer	1	G	Drawer	1	H	Drawer	1	I	Drawer	1	<p>Driplex 3 Drawer File Cabinet Assembly and Disassembly Guide</p> <p>Comprehensive instructions for assembling and disassembling the Driplex 3 Drawer File Cabinet, including details on attaching casters, drawer slides, and managing the hanging bar.</p>
No.	Description	Quantity																													
A	Top	1																													
B	Drawer	2																													
C	Drawer	2																													
D	Drawer	1																													
E	Top	1+1																													
F	Drawer	1																													
G	Drawer	1																													
H	Drawer	1																													
I	Drawer	1																													
	<p>Driplex X Rowing Machine User Manual</p> <p>Comprehensive user manual for the Driplex X Rowing Machine, covering safety information, assembly instructions, parts list, monitor operation, fitness guide, and suggested stretches for home use.</p>																														
	<p>Magnetic Elliptical Machine User's Manual</p> <p>Comprehensive user's manual for the Magnetic Elliptical Machine, covering safety information, parts list, assembly instructions, monitor usage, and maintenance tips.</p>																														
	<p>Driplex Vibration Plate Machine: User Manual and Safety Guide</p> <p>Comprehensive instructions for the Driplex Vibration Plate Machine, covering technical data, safety guidelines, care, maintenance, functional description, and exercise postures for effective home workouts.</p>																														
	<p>Driplex Vibration Plate Machine: User Manual and Safety Guide</p> <p>Comprehensive user manual for the Driplex Vibration Plate Machine, covering technical specifications, safety instructions, care and maintenance, functional description, and various exercise postures for effective full-body workouts.</p>																														