

## PALOVUE iSound

# PALOVUE Wireless Earbuds User Manual

## MODEL: ISOUND

Your guide to setting up, operating, and maintaining your PALOVUE iSound Wireless Earbuds.

### 1. Introduction

The PALOVUE iSound Wireless Earbuds are designed to provide a superior audio experience with advanced features for daily use. Equipped with Qualcomm CSR and Bluetooth 5.0 technology, these earbuds offer a stable and crystal-clear connection, supporting aptX HD sound quality. The CVC 8.0 Noise Cancelling technology with 4 built-in microphones ensures clear calls by effectively reducing ambient noise. Their ergonomic design and multiple ear-tip sizes provide a comfortable and secure fit for extended wear.

The iSound earbuds feature convenient one-step reconnection and intuitive one-touch operation. With up to 24 hours of playtime using the compact charging case, they are ideal for on-the-go listening. Further customization and control are available through the PALOVUE iSound APP.



Image: PALOVUE iSound Wireless Earbuds resting in their open charging case, showcasing their sleek black design.

## 2. What's in the Box

Upon opening your PALOVUE iSound package, you will find the following components:

- Wireless Charging Case
- PALOVUE iSound Earbuds (Left and Right)
- Ear Tips (multiple sizes for a customizable fit)
- Charging Cable (USB-C)
- Lanyard
- Packing Box



## What you Get

- Packing Box
- Headset
- Lanyard
- Charging Case
- Charging Cable
- Spare Earplugs\*5

Image: A flat lay showing all items included in the PALOVUE iSound package: the packing box, charging case, earbuds, charging cable, lanyard, and five pairs of spare ear tips.

## 3. Setup Guide

### 3.1 Initial Charging

Before first use, ensure both the earbuds and the charging case are fully charged. Place the earbuds into the charging case. Connect the provided USB-C cable to the charging case and a power source. The indicator lights on the case will show charging status. A full charge typically takes approximately 2 hours for the case.

### 3.2 Pairing with Your Device

The PALOVUE iSound earbuds feature one-step reconnection for convenience.

1. Open the charging case. The earbuds will automatically power on and enter pairing mode.
2. On your smartphone or Bluetooth-enabled device, go to the Bluetooth settings.

3. Search for "PALOVUE iSound" in the list of available devices and select it to connect.
4. Once connected, you will hear an audible confirmation, and the earbuds will be ready for use.
5. For subsequent uses, simply open the charging case, and the earbuds will automatically connect to the last paired device.

Your browser does not support the video tag.

Video: A detailed guide demonstrating the connection and operation of the PALOVUE iSound earbuds, including initial pairing steps and touch control functions.

## 4. Operating Your Earbuds

### 4.1 Touch Controls

The PALOVUE iSound earbuds feature intuitive touch controls on each earbud. The specific functions can be customized via the PALOVUE iSound APP.

#### Default Touch Control Functions

Action	Left Earbud	Right Earbud
Single Tap	Volume Down	Volume Up
Double Tap	Play/Pause Music, Answer/End Call	Play/Pause Music, Answer/End Call
Long Press	Previous Song, Reject Call	Next Song, Reject Call

Your browser does not support the video tag.

Video: A short demonstration of the touch controls for the PALOVUE iSound earbuds, showing how to adjust volume, skip tracks, and manage calls.

### 4.2 Using the PALOVUE iSound APP

Enhance your experience by downloading the PALOVUE iSound APP. The app allows you to:

- Customize touch control functions (e.g., volume, track control, call management).
- Adjust equalizer (EQ) settings for personalized sound profiles (Male Vocals, Electronic, Jazz, Rock, Classical, Female Vocals, Original, Customize).
- Check battery levels of each earbud.
- Access device information and firmware updates.

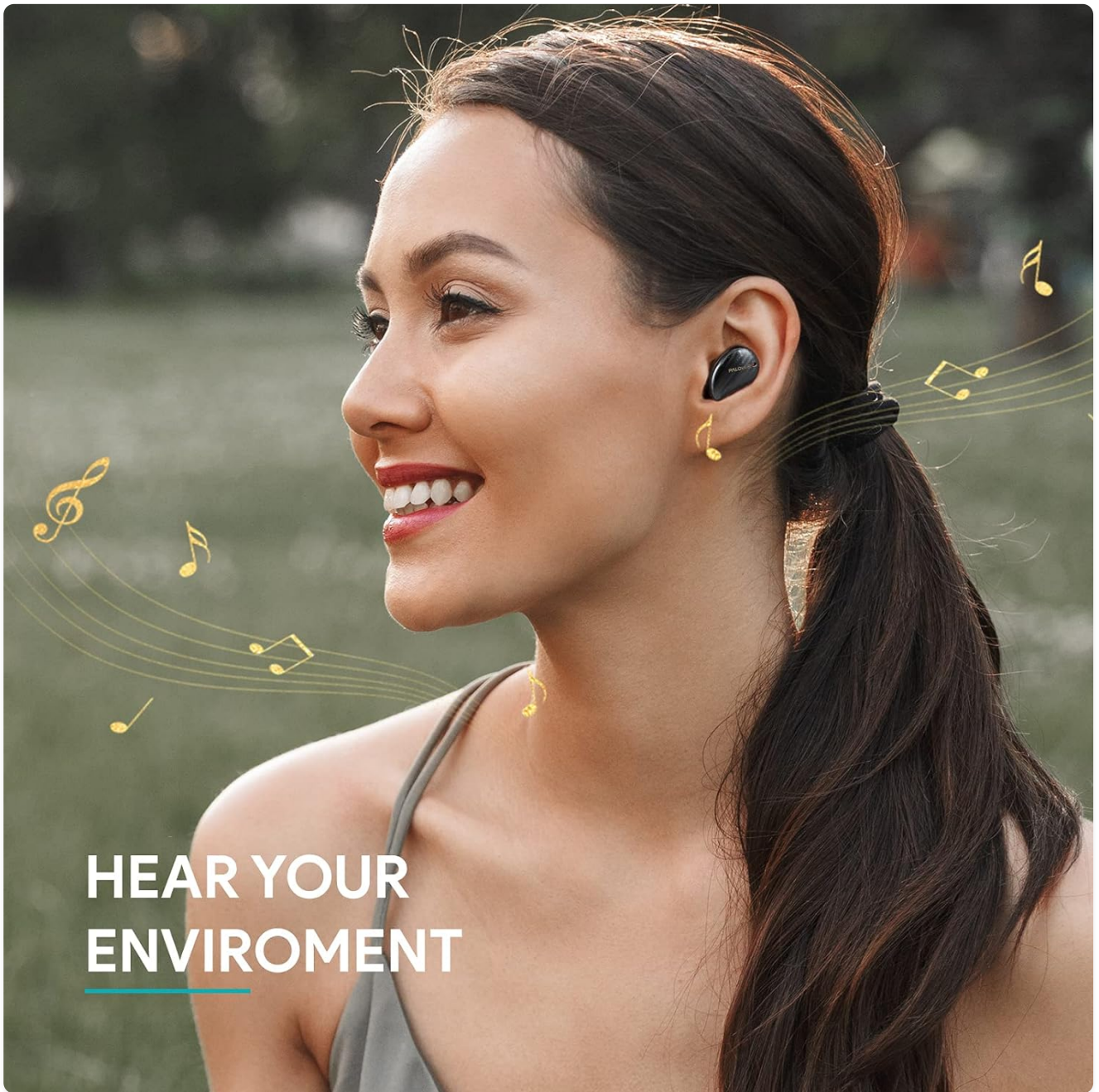

## HEAR YOUR ENVIROMENT

---

Image: A woman wearing PALOVUE iSound earbuds, illustrating their comfortable fit and suitability for daily use.

# TURE WIRELESS EARBUDS

## HiFi STEREO SOUND QUALITY



Image: An exploded view diagram of the PALOVUE iSound earbud, detailing its internal structure and emphasizing Qualcomm AptX and Deep Bass sound capabilities.

## 5. Maintenance

To ensure the longevity and optimal performance of your PALOVUE iSound Wireless Earbuds, follow these maintenance guidelines:

- **Cleaning:** Regularly clean the earbuds and charging case with a soft, dry, lint-free cloth. Do not use abrasive cleaners or solvents. Gently remove any earwax or debris from the ear tips and speaker mesh using a small, soft brush or cotton swab.
- **Storage:** When not in use, store the earbuds in their charging case to protect them from dust, dirt, and physical damage.
- **Battery Care:** Avoid fully depleting the battery frequently. For long-term storage, charge the earbuds and case to about 50% to preserve battery health.
- **Water Resistance:** The earbuds are rated IPX4 for water resistance, meaning they are protected against

splashing water from any direction. They are designed for sports and can withstand sweat and light rain, but they are not suitable for swimming or submersion in water. Ensure the earbuds are dry before placing them back in the charging case.

Your browser does not support the video tag.

Video: A short promotional video highlighting the compact size and powerful features of the iSound True Wireless Earbuds, including their IPX4 water resistance.

## 6. Troubleshooting

If you encounter issues with your PALOVUE iSound Wireless Earbuds, try the following solutions:

### 6.1 Pairing Issues

- **Earbuds not connecting:** Ensure Bluetooth is enabled on your device. Place earbuds back in the case, close it, wait a few seconds, then open it again to re-initiate pairing mode.
- **Only one earbud working:** Try placing both earbuds back in the charging case, closing the lid, and then reopening it. Ensure both earbuds have sufficient charge.
- **Earbuds not appearing in Bluetooth list:** Turn off Bluetooth on your device, then turn it back on. Restart your device if necessary.

### 6.2 Sound Quality Issues

- **Low volume:** Increase the volume on both your earbuds (via touch control) and your connected device.
- **Distorted sound:** Ensure the earbuds are within Bluetooth range of your device. Check for obstructions between the earbuds and your device.
- **Poor call quality:** Ensure the microphones are not obstructed. CVC 8.0 Noise Cancelling technology helps, but extreme noise environments can still affect clarity.

### 6.3 Battery and Charging Issues

- **Earbuds not charging:** Ensure the charging contacts on the earbuds and inside the case are clean and dry. Try a different charging cable or power adapter.
- **Case not charging:** Verify the charging cable and power source are working correctly.

### 6.4 How to Reset Your Earbuds

If you experience persistent issues, a factory reset may resolve them:

1. Place both earbuds into the charging case.
2. Press and hold the reset button on the charging case (usually located inside or near the charging port) until the indicator lights on the earbuds flash red and green alternately.
3. Release the button and wait until only the green light flashes, indicating the reset is complete.
4. Remove the earbuds from the case and attempt to re-pair them with your device.

Refer to the "PALOVUE iSound Connection operation guide" video in the Setup section for a visual demonstration of the reset process.

## 7. Specifications

Feature	Detail
Brand	PALOVUE
Model Name	iSound
Connectivity Technology	Wireless (Bluetooth 5.0)
Wireless Communication Technology	Bluetooth
Chipset	Qualcomm CSR QCC3020
Noise Control	CVC 8.0 Noise Cancellation (for calls)
Microphones	4 Mics
Control Type	Touch Control
Ear Placement	In Ear
Form Factor	In Ear
Battery Life (Earbuds)	Up to 6 hours (approx.)
Total Playtime (with case)	Up to 24 Hours
Charging Time (Case)	2 Hours
Bluetooth Range	Up to 10 Meters (32.8 feet)
Water Resistance Level	IPX4 (Splashproof)
Material	Silicone (Ear Tips)
Item Weight	1.76 ounces
Compatible Devices	Smartphones, Tablets, Laptops, Desktops, Smart TVs, Car Audio Systems



## 8. Warranty and Support

PALOVUE products typically come with a manufacturer's warranty. Please refer to the warranty card included in your product packaging for specific terms and conditions, including warranty period and coverage details. For technical support, troubleshooting assistance, or warranty claims, please contact PALOVUE customer service through their official website or the contact information provided in your product documentation.

You can also visit the official PALOVUE store on Amazon for more information and support: [PALOVUE Amazon Store](#).



## Related Documents

 <p><b>PALOVUE</b> <b>SportSound</b> User Manual</p>	<p><a href="#">PALOVUE SportSound User Manual</a></p> <p>This user manual provides comprehensive instructions for the PALOVUE SportSound wireless earbuds, covering product overview, pairing, wearing, charging, app usage, troubleshooting, and FCC warnings. Available in multiple languages.</p>
 <p><b>iSOUND</b> Bluetooth <b>HIGH PERFORMANCE SOUNDBAR</b> WIRELESS PORTABLE SPEAKER</p>	<p><a href="#">iSOUND High Performance Portable Soundbar - Wireless Speaker</a></p> <p>Discover the iSOUND High Performance Portable Soundbar. Enjoy wireless music via Bluetooth, USB, or microSD, and listen to FM radio. Features dual magnet speakers, rechargeable battery, and a microphone for calls. Includes audio cable for wired connections.</p>
 <p><b>Palovue Bluetooth 5.0 Audio Adapter</b></p>	<p><a href="#">Palovue Bluetooth 5.0 Audio Adapter User Manual</a></p> <p>User manual for the Palovue Bluetooth 5.0 Audio Adapter, providing details on product introduction, specifications, installation, connection, troubleshooting, package contents, and FCC compliance.</p>

## Documents - PALOVUE – iSound



### [\[pdf\] User Manual](#)

516000247 6852 20210121 PALOVUE iSound True Wireless Earbuds Qualcomm CSR Bluetooth 5.0 Headphones with 4 Mic and Noise Cancelling for Stereo Sound Deep Bass IPX5 Waterproof Touch Control Ear Buds User Manual B1y6xYnsWdS m media amazon images I

...

lang: score:16 filesize: 2.47 M page\_count: 1 document date: 2021-06-18

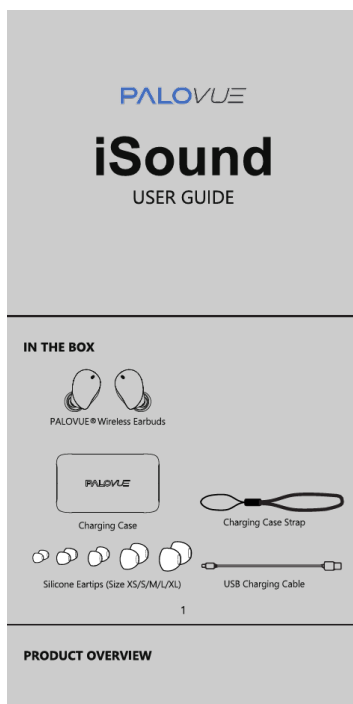

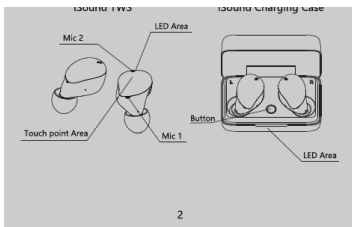

2

**PAIRING**

**To pair to a Bluetooth audio device**

1. Start with the iSound TWS inside the charging case with the lid closed.



2. Open the charging case, press and hold the case button until the Charging case LED blinks blue and green. The TWS LED will also blink green at the same time.



3

3. On your Bluetooth audio device, go to Bluetooth settings and select "Palovue iSound". Once connected, the TWS LED will turn off.



4

**FIT**

- Your Palovue iSound TWS comes with five sizes of earbuds (XS/S/M/L/XL).
- Fit the TWS snugly within your ears so that they are completely sealed.
- To achieve the most comfortable fit and sound for your TWS, take time to test out the various tip sizes to find the best fitting size. It is normal to use differently sized tips in each ear.



Silicone Earbuds (Size XS/S/M/L/XL)

5

**CHARGING - TWS**

- The Palovue iSound TWS is capable of 5 hours of playback when fully charged. The charging case gives you 4 additional recharge cycles or 20 hours additional playback.\*
- The TWS will start charging once they are placed into the charging case and the lid closed. The charging case LED will indicate the charging status:
  - Charging: Solid red light on case
  - Fully charged: Solid green light on case
- Quick-charge feature: A 15 minute charge will provide up to 1 hour of playback\*. A full charge of the earbuds can take up to 2 hours when charging from a discharged state.

\* The specifications are acquired from laboratory tested data. Playback time is tested under laboratory condition of AAC file format at 50% volume. Actual playback time may vary with different device settings, environment, usage and other factors.

6

**CHARGING - CASE**

- Close the lid and attach the USB-C charging cable to the charging case.
- The case LED will indicate the charging status:
  - LED is solid red = Charging
  - LED is solid green = Fully charged



7

**PALOVUE® TWS APP**

- The Palovue® TWS App lets you do the following:
  - Customize the sound profile of your iSound TWS.
  - Update your earbuds when new features and improvements are available.



8

[\[pdf\]](#) User Manual

6852 PALOVUE Wireless Earbuds Bluetooth Headphones Earphones CVC8 0 Noise Cancelling with Touch Control and 4 Mic for Clearer Call Deep Bass Stereo in Ear Qualcomm CSR Chip iSound User Manual Open the charging case press hold button until LED starts blinking green about 8 12 seconds Release close wait C1 EJtDlgn S m media amazon images | |||

15 ...

lang: score:13 filesize: 7.01 M page\_count: 1 document date: 2021-10-14

## DETAILS

### TURNING ON / OFF

#### AUTO POWER ON/OFF

- Turn OFF - Placing your iSound TWS into the charging case will automatically turn them off.
- Turn ON - Opening the charging case will automatically turn them on.
- The TWS will automatically power off after 15 minutes when not in use.

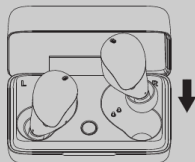

9

### TAP CONTROLS- MUSIC & CALLS

	MUSIC PLAYBACK	CALLS
Tap	RIGHT TWS: Increase volume LEFT TWS: Decrease volume	-
Double tap	Play / Pause music	Answer / End call
Triple tap	RIGHT TWS: Voice assistant	-
Long press	RIGHT TWS: Next track LEFT TWS: Previous track	Reject call

10

### TROUBLESHOOTING

• Soft reset: If your iSound TWS are not responding or connecting intermittently, place them in the charging case, close the lid for at least 5 seconds and plug the case into charge. This will turn the TWS off and perform a soft reset.

• Factory reset: If that does not resolve the issue, we recommend resetting the TWS to their original factory settings. Before starting this process please "FORGET" or "REMOVE" your Palovue® iSound device from the Bluetooth menu on all your connected audio devices.

- Place both TWS in the charging case and close the lid.
- Open the charging case, press & hold the case button until the case LED starts blinking green (about 8-12 seconds).
- Release the button close the case and wait for 5 seconds.
- The iSound TWS has been reset and is ready to pair.

The firmware for the iSound is updated separately for both sides. Please follow the steps accordingly to make sure both sides of the iSound are updated to the latest firmware version.

#### Left Side:

1. Open the charging case and connect to your device.
2. With the IEMs inside the case select the "Firmware Update" button and choose "Proceed" when the prompt appears.

11

3. Keep the upgrade page at the top until the upgrade is complete.
4. After completing LEFT side firmware update, close the charging case and proceed to update RIGHT side.

#### Right Side:

1. Open the charging case.
2. With the IEMs inside the case press and hold the case button for 12-15 seconds.
3. Press until the charging box indicator light is left with the blue light flashing, release the button, and the right earphone will flash green light at this time.
4. Open the bluetooth settings on your device and pair with "Palovue iSound R".
5. After successful connection to "Palovue iSound R" open the Palovue iSound app and repeat the steps for the "Firmware update".
6. Once the update for the RIGHT side is completed close the charging case. Your iSound is now fully updated to the new firmware version.

12

### SPECIFICATIONS

Bluetooth	5.0
Codect	Qualcomm® aptX™ /SBC
Driver type	Custom 7mm Dynamic Driver
Sensitivity	110 ±3 dB at 1 kHz
Frequency range	20 Hz-20 kHz
Effective range	10m (30 feet)
Water resistance	IPX4
Playtime	5h*
Charging time	2 hours
Quick charge	15 min = 1 hour play time

\* The specifications are acquired from laboratory tested data. Playback time is tested under laboratory condition of AEC the format at 50% volume. Actual playback time may vary with different device settings, environment, usage and other factors.

13

### TELEC

You can find the TELEC certificate information on the charging case.

### FCC

- This device complies with Part 15 of the FCC Rules. Operation is subject to the following two conditions:  
(1) this device may not cause harmful interference, and  
(2) this device must accept any interference received, including interference that may cause undesired operation.
- Changes or modifications not expressly approved by the party responsible for compliance could void the user's authority to operate the equipment.
- NOTE: This equipment has been tested and found to comply with the limits for a Class B digital device, pursuant to part 15 of the FCC Rules. These limits are designed to provide reasonable protection against harmful interference in a residential installation. This equipment generates uses and can radiate radio frequency energy and, if not installed and used in accordance with the instructions, may cause harmful interference to radio communications. However, there is no guarantee that interference will not occur in a particular installation.

14

- If this equipment does cause harmful interference to radio or television reception, which can be determined by turning the equipment off and on, the user is encouraged to try to correct the interference by one or more of the following measures:

- Reorient or relocate the receiving antenna.
- Increase the separation between the equipment and receiver.
- Connect the equipment into an outlet on a circuit different from that to which the receiver is connected.
- Consult the dealer or an experienced radio/TV technician for help.

### WATERPROOF

- The Palovue® iSound features an IPX4 waterproof rating. The iSound TWS is designed to handle sweat, rain and general forms of exercise.
- The Palovue® iSound TWS are not designed for swimming, showering or exposure to pool or ocean water.
- The charging case is not water resistant, so please ensure your earbuds are completely dry before charging.

www.paiovue.com  
Manufacturer:Fonic Electronics Co.,Ltd.  
Made in China  
support@paiovue.com  
FCC ID: ZARYG-ISOUND

