

## MARKLIFE P12

# MARKLIFE P12 Label Maker User Manual

Your comprehensive guide to operating and maintaining your MARKLIFE P12 Label Maker.

## 1. INTRODUCTION

The MARKLIFE P12 Label Maker is a portable thermal label printer designed for various labeling needs in business, home, and office environments. It connects via Bluetooth to your iOS or Android smartphone, allowing for easy creation and printing of custom labels without the need for ink or toner. Its compact design and long-lasting battery make it convenient for on-the-go use.

## 2. GETTING STARTED: SETUP

### 2.1 Unboxing and Initial Charge

Upon receiving your MARKLIFE P12 Label Maker, carefully remove all components from the packaging. It is recommended to fully charge the device before first use. Use the provided USB cable to connect the label maker to a power source.

### 2.2 App Installation and Bluetooth Connection

To operate the P12 Label Maker, you need to download the "Marklife" application on your smartphone. The app is compatible with both iOS and Android devices.

1. Download the "Marklife" app from the [Google Play Store](#) (for Android) or the [Apple App Store](#) (for iOS).
2. Ensure your phone's Bluetooth is turned on.
3. Open the "Marklife" app. **Important:** Connect to the label maker via the app, not directly through your phone's Bluetooth settings.
4. Within the app, navigate to the connection interface and select the P12 model (default name is P12) to establish a Bluetooth connection.

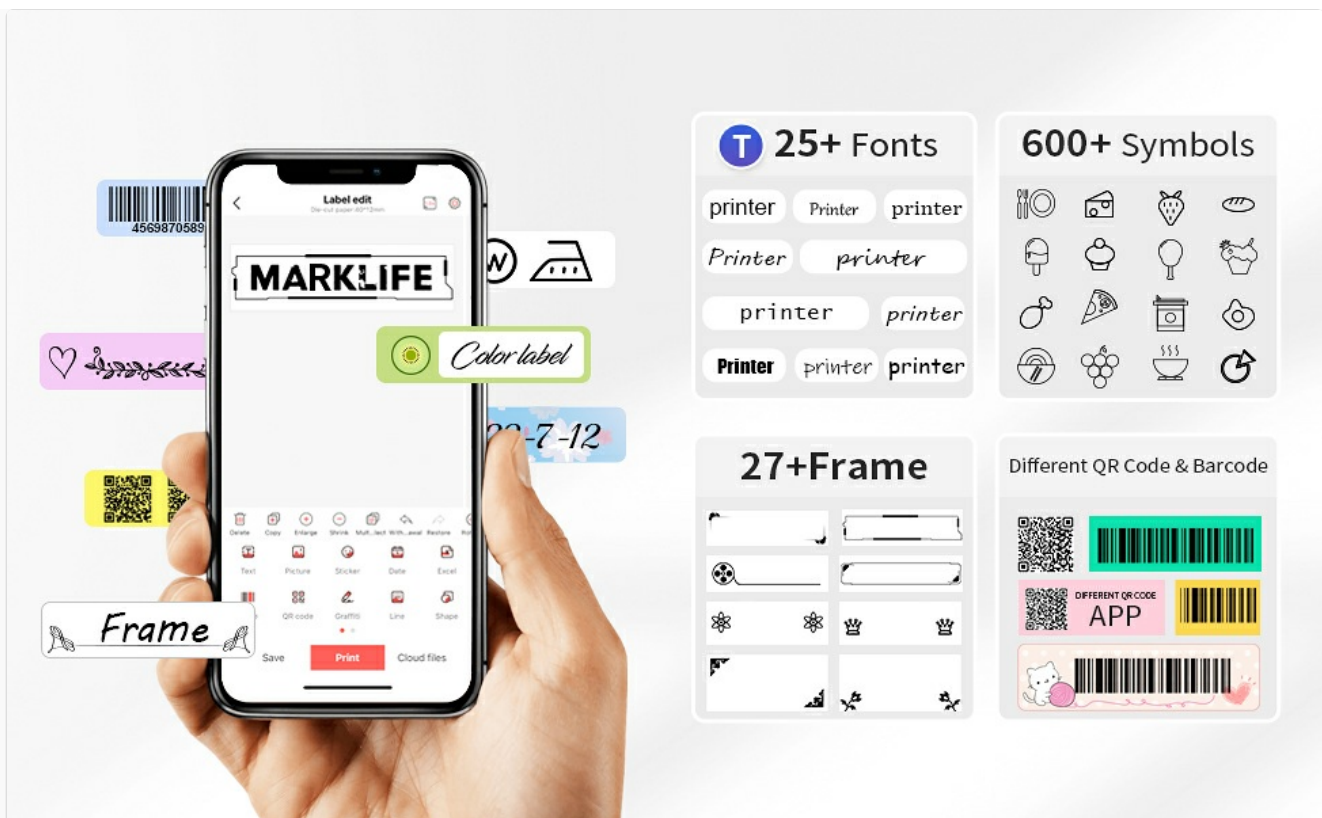

Image: Steps for connecting your device to the Marklife P12 label maker. This image shows the process of turning on phone Bluetooth, entering the Marklife app and clicking UNLINK, then choosing the printer model for Bluetooth connection.

## 3. OPERATION

### 3.1 Loading Label Paper

The P12 Label Maker supports various sizes of thermal label paper, including continuous and pre-cut labels. To load paper:

1. Open the label compartment cover.
2. Insert the label roll with the printing surface facing up, ensuring it feeds smoothly through the printer mechanism.
3. Close the cover securely.



Image: The Marklife P12 Label Maker in use, demonstrating its compact size and the label editing interface on a smartphone. Various label types are shown, including a roll of 1.57"x1.18" labels.



Image: This image illustrates the compatibility of the Marklife P12 with various label types, including white, transparent, colored, pre-cut, and continuous labels.

## 3.2 Creating and Printing Labels

The Marklife app provides extensive customization options for your labels:

- **Text:** Input various texts and numbers.
- **Graphics & Symbols:** Access a library of graphic symbols and logos.
- **Barcodes & QR Codes:** Generate and print barcodes and QR codes.
- **Images:** Insert pictures from your phone's album for printing.

- **Templates:** Utilize pre-designed templates for quick label creation.
- **Fonts & Frames:** Choose from over 25 fonts and 27 frames to personalize your labels.

## Compatible with Various Labels



Pre-cut Labels



Continuous Labels

Image: The Marklife app interface for customizing labels, showing options for text, date, stickers, lines, QR codes, barcodes, graffiti, and multiple fonts. A barcode with the number [1234567890](#) is visible.



Image: This image highlights the extensive customization options within the Marklife app, including over 25 fonts, 600+ symbols, and 27+ frames, along with different QR code and barcode styles.

### 3.3 Applications

The MARKLIFE P12 Label Maker is versatile and can be used for organizing various items:

- **Home Organization:** Classify home supplies, food storage containers, and more.
- **Office Use:** Label file folders, documents, and office supplies.
- **Cosmetics:** Organize cosmetic items and bottles.





Image: Examples of the Marklife P12 label maker's wide usage, showing labels applied to items in storage, kitchen, cosmetics, and office environments.

# Marklife P12 label maker



Image: This image demonstrates the versatility of the Marklife P12 label maker for organizing food, storage, office, kitchen, switch marks, and cosmetics.

## 4. MAINTENANCE

### 4.1 Thermal Printing Technology

The MARKLIFE P12 utilizes advanced thermal printing technology, which means it does not require ink or toner. This significantly reduces operational costs and simplifies maintenance. The print head is designed for durability and provides crisp, dark imaging.

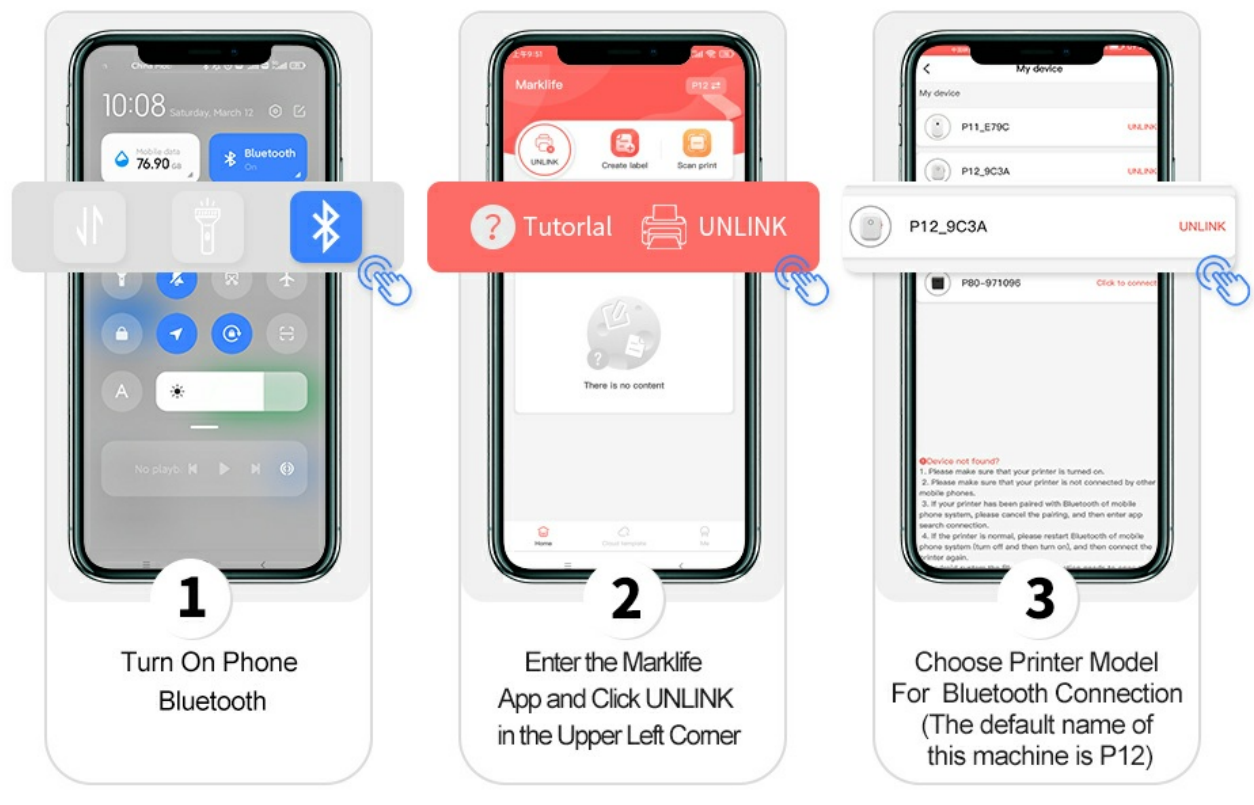

Image: This image illustrates the thermal printing technology of the Marklife P12, emphasizing that no ink is required and highlighting the print head.

## 4.2 Cleaning and Storage

To ensure optimal performance and longevity of your label maker:

- Regularly clean the print head with a soft, lint-free cloth, slightly dampened with rubbing alcohol if necessary. Ensure the device is turned off before cleaning.
- Store the label maker in a cool, dry place away from direct sunlight and extreme temperatures.
- When not in use, the P12's magnetic suction function allows it to be easily attached to metallic surfaces like refrigerators, saving space.





Image: The Marklife P12 label maker demonstrating its space-saving magnetic suction feature, attached to a refrigerator.

## 5. TROUBLESHOOTING

Problem	Possible Cause	Solution
Device won't connect via Bluetooth.	<ul style="list-style-type: none"> <li>Not connected through the app.</li> <li>Bluetooth not enabled on phone.</li> <li>Printer is off or low battery.</li> <li>Interference from other devices.</li> </ul>	<ul style="list-style-type: none"> <li>Ensure you connect within the "Marklife" app, not phone settings.</li> <li>Verify phone Bluetooth is on.</li> <li>Charge the label maker and turn it on.</li> <li>Restart both the label maker and your phone. Try connecting in a different location.</li> </ul>
Labels are blank or faded.	<ul style="list-style-type: none"> <li>Label paper loaded incorrectly.</li> <li>Print head is dirty.</li> <li>Using non-thermal paper.</li> </ul>	<ul style="list-style-type: none"> <li>Ensure the thermal side of the paper is facing the print head.</li> <li>Clean the print head as described in the Maintenance section.</li> <li>Use only thermal label paper designed for the P12.</li> </ul>
Label paper jams frequently.	<ul style="list-style-type: none"> <li>Paper not loaded correctly.</li> <li>Debris in the paper path.</li> </ul>	<ul style="list-style-type: none"> <li>Re-load the label paper, ensuring it is aligned properly and not creased.</li> <li>Inspect the paper path for any obstructions and carefully remove them.</li> </ul>

## 6. SPECIFICATIONS





Feature	Detail
Brand	MARKLIFE
Model	P12
Printing Technology	Thermal
Connectivity	Bluetooth 4.0
Compatible Devices	Smartphones (Android, iOS)
Product Dimensions	6.9D x 8.9W x 3.1H Centimetres
Item Weight	4.4 Ounces (approx. 125 grams)
Battery Capacity	1200mAh (Built-in)
Continuous Working Time	Up to 5 hours
Standby Time	Up to 1 week
Max Print Speed (Monochrome)	20 mm/s
Scanner Resolution	300 x 300 DPI
Special Features	Portable, Magnetic Suction

## 7. WARRANTY AND SUPPORT

MARKLIFE is committed to providing excellent after-sales service. If you encounter any questions or issues regarding the use of your P12 Label Maker, please do not hesitate to contact the MARKLIFE after-sales team. They are dedicated to resolving all your problems and ensuring your satisfaction.

For support, please refer to the contact information provided with your product packaging or visit the official MARKLIFE website.

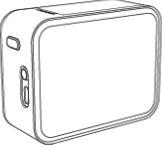

<p><b>M1 Label Printer User Manual</b></p> 	<p><a href="#">Marklife M1 Label Printer User Manual</a></p> <p>Comprehensive user manual for the Marklife M1 portable label printer, detailing setup, connection via Bluetooth, label loading, indicator light meanings, and app operation for creating and printing custom labels.</p>
	<p><a href="#">Marklife P50 Label Printer User Manual</a></p> <p>Comprehensive user manual for the Marklife P50 Label Printer, covering setup, app installation, label creation, features, troubleshooting, and maintenance.</p>
	<p><a href="#">P15 Label Printer User Manual</a></p> <p>User manual for the P15 Label Printer, covering initial setup, wireless connection via the Marklife app, label creation methods, replacing consumables, and safety precautions.</p>
	<p><a href="#">Marklife P12 Label Maker User Manual</a></p> <p>Comprehensive user manual for the Marklife P12 Label Maker, covering setup, operation, troubleshooting, and warranty information. Learn how to use the Marklife APP for label customization.</p>
<p><b>P15 Label Printer User Manual</b></p> 	<p><a href="#">Marklife P15 Label Printer User Manual</a></p> <p>User manual for the Marklife P15 portable label printer, covering quick connection, label loading, indicator lights, and app operation.</p>
<p><b>P15 Label Printer User Manual</b></p> 	<p><a href="#">P15 Label Printer User Manual - Marklife</a></p> <p>User manual for the Marklife P15 portable label printer. Learn how to connect, load labels, use the mobile app, and understand indicator lights for efficient label printing.</p>