

FIRElood LH30

FIRElood LH30 Wood Burning Kit Instruction Manual

Model: LH30

Brand: FIRElood

1. INTRODUCTION

Thank you for choosing the FIRElood LH30 Wood Burning Kit. This professional pyrography tool is designed for both adults and beginners, offering precise temperature control and a wide range of tips for various artistic effects. Please read this manual thoroughly before use to ensure safe and optimal operation.

2. SAFETY INFORMATION

- Always operate the wood burning kit in a well-ventilated area to avoid inhaling fumes.
- The pen tips become extremely hot. Avoid direct contact with skin or flammable materials.
- Use heat-resistant gloves to protect your hands during operation and tip changes.
- Ensure the power is off and the unit is cool before changing tips or performing maintenance.
- Keep out of reach of children and pets.
- Do not immerse the unit or pens in water or any other liquid.
- Always place the pen in its designated holder when not actively burning.

3. PACKAGE CONTENTS

Your FIRElood LH30 Wood Burning Kit includes the following items:

- LH30 Pyrography Machine (with digital temperature display)
- 2 Insulated Pyrography Pens

- 30 Assorted Pyrography Wire Tips
- Dual-Pen Shelf
- Screwdriver
- Cleaning Sponge
- Wood Boards (for practice)
- User Manual

4. SETUP

1. **Unpack Components:** Carefully remove all items from the packaging.
2. **Place the Unit:** Position the pyrography machine on a stable, heat-resistant surface in a well-ventilated area.
3. **Connect Pens:** Insert the connectors of the pyrography pens into the designated ports on the front of the machine. Ensure a secure connection.
4. **Attach Pen Tips:** Select the desired wire tip and use the provided screwdriver to securely fasten it into the pen's terminals. Ensure the screws are tightened to prevent poor contact.
5. **Position Pen Holders:** Place the dual-pen shelf on your workspace. This provides a safe resting place for the hot pens and includes a cleaning sponge.



Figure 1: Overview of the FIRElood LH30 Wood Burning Kit components, including the main unit, two pens, various tips, and pen holders.

LH30-2-new

Two wood burning pens with dual port configuration
press the button to quickly change pens, fast and convenient

Wood burning pen A

When using the A-point wood burning pen, press I, and the A-point wood burning pen will be powered on and immediately generate heat

Wood burning pen B

When using the B-point wood burning pen, press II, and the B-point wood burning pen will be powered on and immediately generate heat



Figure 2: The LH30 unit with two pens connected, showing the digital temperature display and power switch. Pens A and B can be activated independently.

5. OPERATING INSTRUCTIONS

5.1 Powering On and Temperature Adjustment

1. **Power On:** Plug the unit into a 110V power outlet. Turn on the main power switch.
2. **Activate Pen:** Press the switch corresponding to the pen you wish to use (Pen A or Pen B). The digital display will show the current temperature.
3. **Adjust Temperature:** Rotate the temperature control knob to set the desired heat level. The highest temperature can reach 700°C, but it is recommended to operate within 200-500°C for most applications. For quick heating, set the temperature to maximum initially, then slowly lower it once the tip is hot (typically within a minute).

Accurate temperature control

The digital display screen displays the pen tip temperature in a timely manner, and the electronic temperature control accurately controls the appropriate temperature for wood combustion. By accurately adjusting and controlling the temperature, it can create rich color tones and delicate images in wood combustion painting.

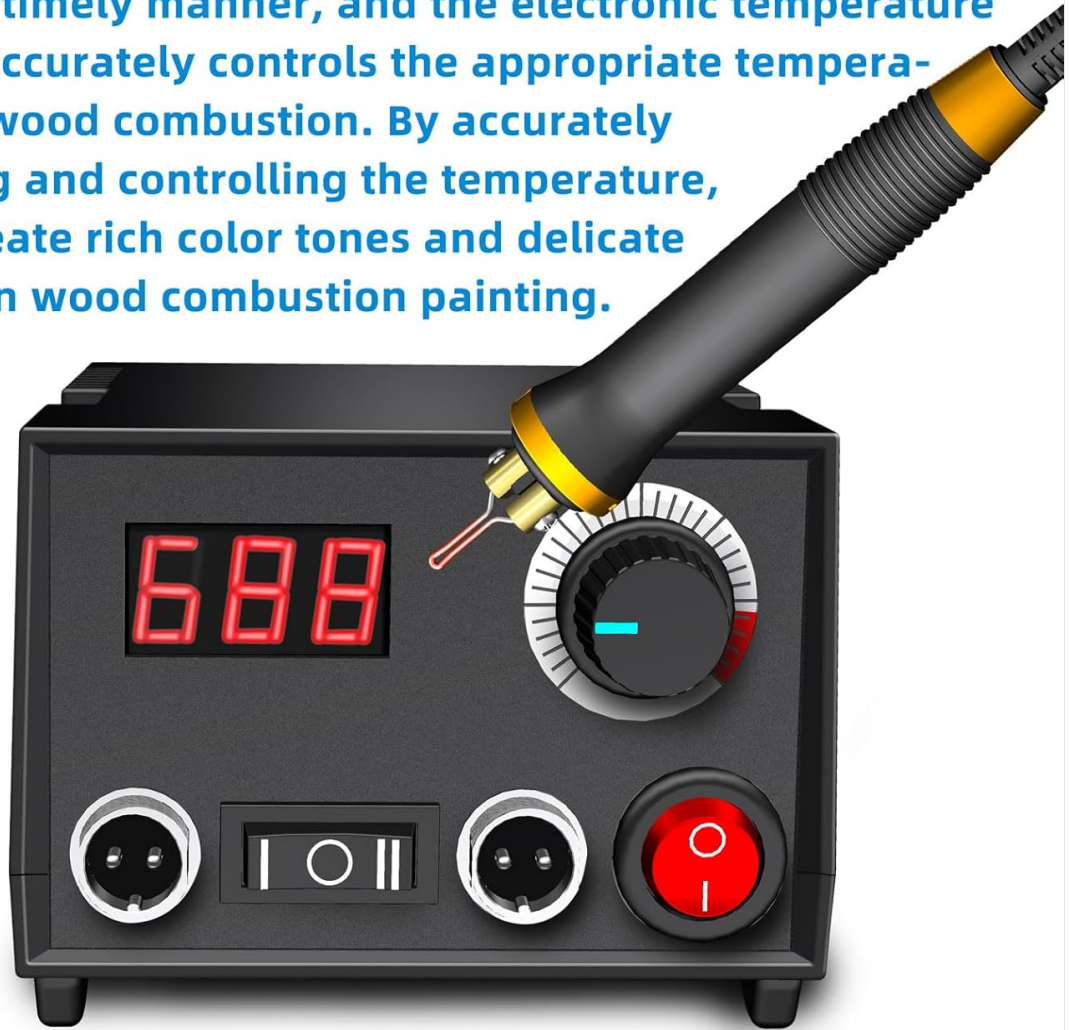

Figure 3: The digital display provides accurate temperature readings, allowing for precise control over the burning process to achieve various color tones and effects.

5.2 Pen Usage and Tip Selection

- The pen handle is made of heat-insulating material and features an ergonomic design for comfortable holding and precise control.
- The kit includes 30 different pyrography wire tips, suitable for various techniques such as outlining, drawing, dotting, dyeing, rubbing, and tracing. Experiment with different tips to achieve rich layers and tones in your artwork.
- The closer the pen nib is to your hand, the easier it is to precisely control its movement.

30 kinds of metal heating tips of various shapes can draw a variety of strokes with different artistic effects, improving the painting efficiency and better artistic effects of the picture.



Figure 4: A selection of the 30 high-impedance heating wire tips included, designed for various pyrography techniques from fine lines to broad shading.

Double structure pen holder double protection
good heat insulation

It is soft and comfortable to hold the pen



Figure 5: The pyrography pen features a double-structure, insulated handle for comfortable and safe use, demonstrated here with a gourd artwork.



Figure 6: An artist using the wood burning pen to create detailed artwork on a wooden surface, highlighting the precision possible with the tool.

5.3 Pyrography Techniques (Video Demonstrations)

The following videos demonstrate various techniques and applications of the FIRElood LH30 Wood Burning Kit:

Your browser does not support the video tag.

Video 1: This video provides an overview of the wood burning kit, demonstrating the heating process, how to change tips, and general application on various materials like wood and gourds.

Your browser does not support the video tag.

Video 2: A detailed demonstration of advanced pyrography techniques, including line drawing, shading, and rendering fine details on portraits, floral designs, and animal subjects. This video highlights the versatility of different pen tips and temperature settings.

6. MAINTENANCE

- **Tip Replacement:** When replacing pen tips, always use the provided screwdriver to tighten the screws.

This ensures proper electrical contact and prevents inconsistent heating.

- **Cleaning:** Use the included sponge to clean the pen tips regularly during and after use. The dual-pen shelf features a dedicated cleaning box for convenience.
- **Storage:** When not in use, store the pens in the pen holder to protect the tips and prevent accidental burns. The pen holder also serves as an accessory storage box.

Multi functional pen holder

①When the pen is working, it is convenient to place and use in this way

②Pen tip dirt cleaning box

③Pen tip accessory storage box

④When not working, the pen storage box

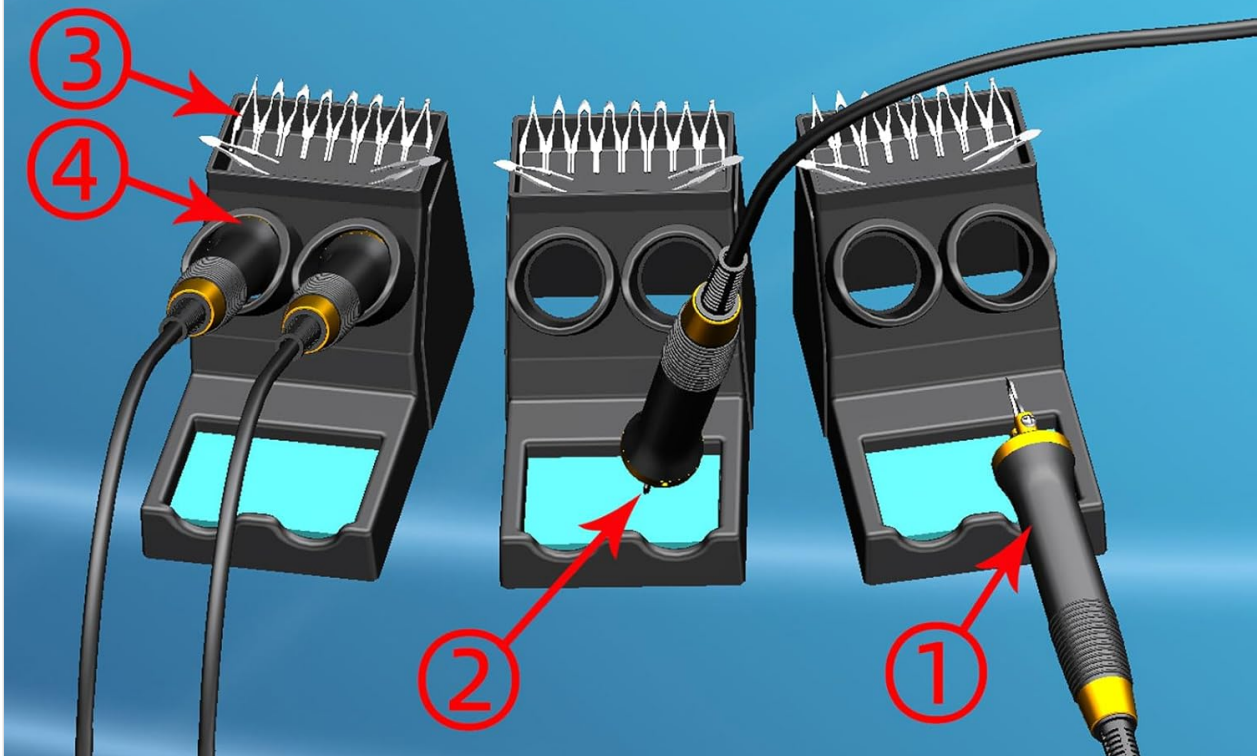

Figure 7: The multi-functional pen holder provides a safe resting place for working pens, a cleaning box for tips, and storage for accessories when not in use.

7. TROUBLESHOOTING

If you encounter any issues with your FIRElood LH30 Wood Burning Kit, please consider the following:

- **Pen not heating:** Ensure the pen is securely connected to the unit and the corresponding pen switch is activated. Check that the wire tip screws are tightly fastened.
- **Inconsistent heating:** This may be due to loose pen tip screws. Turn off the unit, allow it to cool, and re-tighten the screws with the provided screwdriver.
- **Unit not powering on:** Verify that the power cord is securely plugged into a working 110V outlet and the main power switch is in the 'ON' position.

For further assistance, please contact customer service.

8. SPECIFICATIONS

Feature	Specification
Brand	FIRElood
Power Source	Corded Electric
Special Feature	Heat Resistance Handles
Included Components	Soldering Iron Tips
Upper Temperature Rating	700 Degrees Celsius

9. WARRANTY AND SUPPORT

The FIRElood LH30 Wood Burning Kit is designed for durability and performance. If you have any questions, needs, or require customer service, please feel free to contact us. We are committed to providing good customer service and support for your pyrography journey.