

HOTO HOTO Cordless Hot Glue Gun

HOTO Cordless Hot Glue Gun and Glue Sticks User Manual

Model: HOTO Cordless Hot Glue Gun

1. PRODUCT OVERVIEW

The HOTO Cordless Hot Glue Gun is a versatile tool designed for various applications including crafting, artwork, home repairs, and decorating. It offers a cordless design for enhanced portability and ease of use. The accompanying HOTO hot glue sticks are made from safe, eco-friendly resin and are available in multiple colors.



Image 1.1: HOTO Cordless Hot Glue Gun with a selection of colored glue sticks.



Image 1.2: The HOTO Cordless Hot Glue Gun, recognized for its design.

2. SAFETY INSTRUCTIONS

- Always keep the hot glue gun away from children.
- Do not touch the nozzle or melted glue directly as they can cause burns.
- Ensure the work area is well-ventilated.
- Do not use the glue gun near flammable materials.
- Unplug or turn off the device when not in use or before cleaning.
- Only use HOTO-approved glue sticks to ensure optimal performance and safety.

3. SETUP

3.1 Charging the Device

The HOTO Cordless Hot Glue Gun features a high-capacity 2000mAh lithium battery and a universal Type-C charging interface. To charge, connect a compatible USB-C cable to the charging port located at the base of the handle. The device can provide continuous glue flow for up to 328 feet when fully charged.



Image 3.1: Charging port and battery specifications.

3.2 Inserting Glue Sticks

1. Ensure the glue gun is turned off.
2. Insert a HOTO mini-sized glue stick (0.27-inch diameter x 5-inch length) into the circular opening at

the rear of the glue gun.

3. Push the glue stick gently until it is seated properly.



Image 3.2: Inserting a mini-sized glue stick and compatible materials.

4. OPERATING INSTRUCTIONS

4.1 Powering On and Preheating

1. Press and hold the power button located on the top of the glue gun.
2. The indicator light will begin flashing white, signifying that the device is preheating.
3. The glue gun warms up quickly, typically within 30 seconds. Once the light stops flashing and

remains solid white, the device is ready for use.

4.2 Applying Glue

To dispense glue, gently press the fan-shaped trigger. The highly thermally conductive brass nozzle ensures a stable and continuous flow of glue, making it suitable for precise applications.

Compact in Size, All in One Hand

A light press on the fan-shaped trigger bring the continuous glue-flow.

■ ■ ■

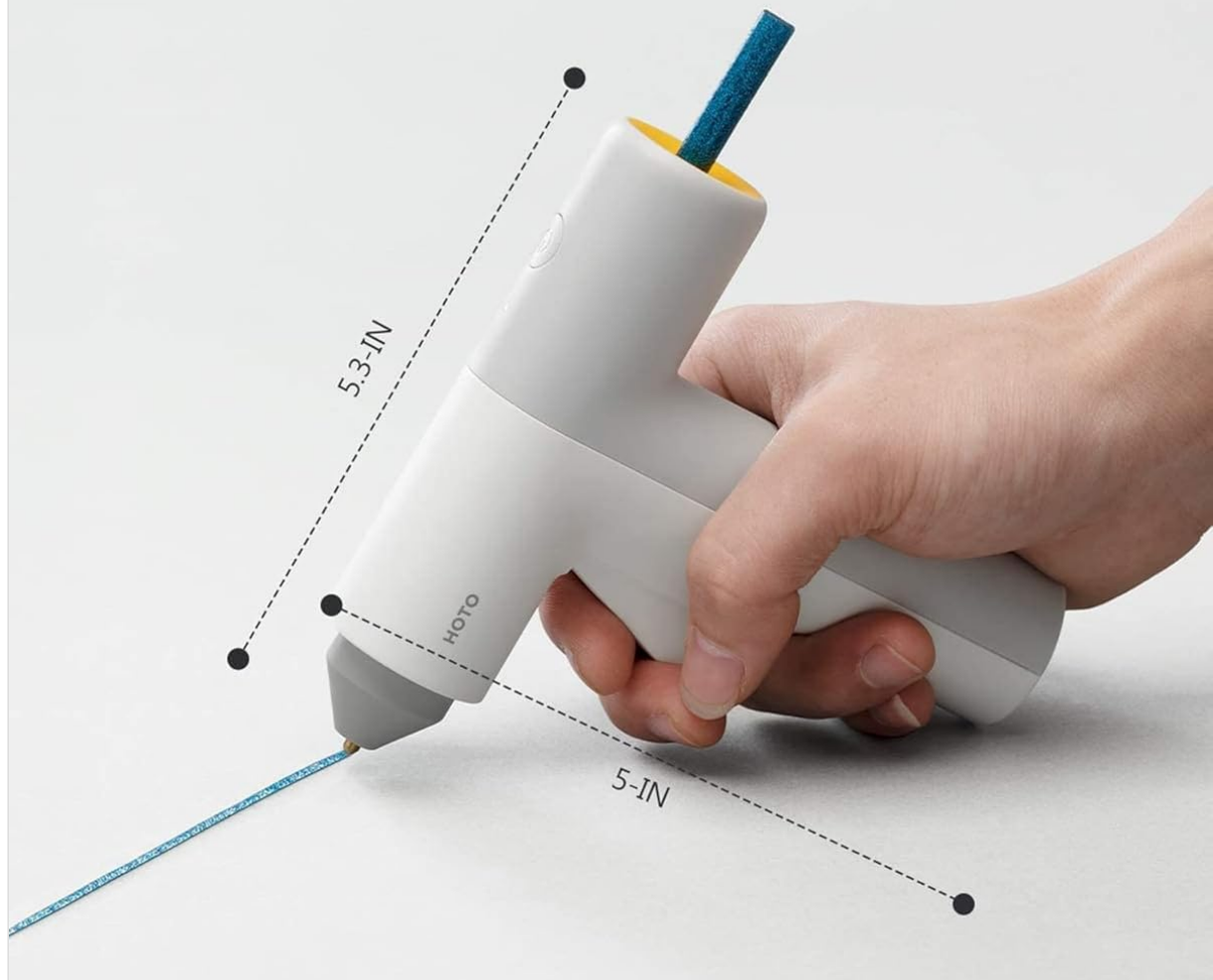

Image 4.1: Compact design and trigger for glue application.

4.3 Intelligent Temperature Control and Auto Shut-off

The glue gun is equipped with an intelligent control chip and MCH system to maintain optimal heating temperature, preventing overheating and excessive glue melting. For safety and energy conservation, the device will automatically power off if it remains inactive for more than 5 minutes.

Double Protection

With Intelligent Chip

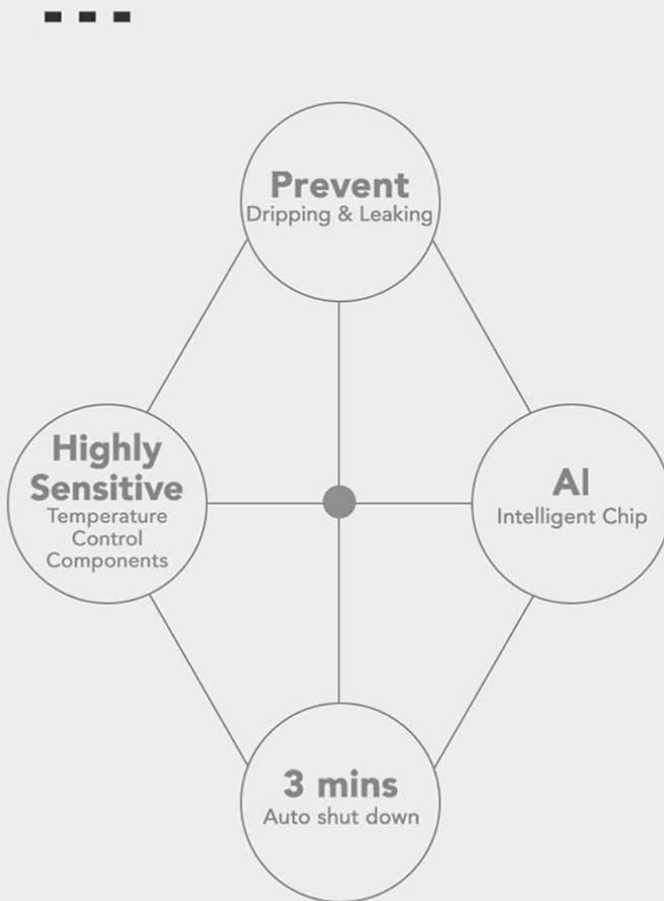

Image 4.2: Internal intelligent temperature control system.

4.4 Versatile Applications

The HOTO Cordless Hot Glue Gun is suitable for a wide range of materials including plastic, glass, paper, cotton, and cloth, making it ideal for various DIY projects and repairs.



Image 4.3: Examples of product usage for repairs and DIY creation.

4.5 Using Colored Glue Sticks

The bundle includes 20 hot melt glue sticks in 6 colors: blue, red, yellow, green, silver (2 pieces each), and transparent (10 pieces). These allow for creative and decorative applications.

Multi-Color

20 pcs hot melt glue sticks in 6 colors

blue, red, yellow, green, silver (each color 2pcs);
Transparency (10pcs)

■ ■ ■

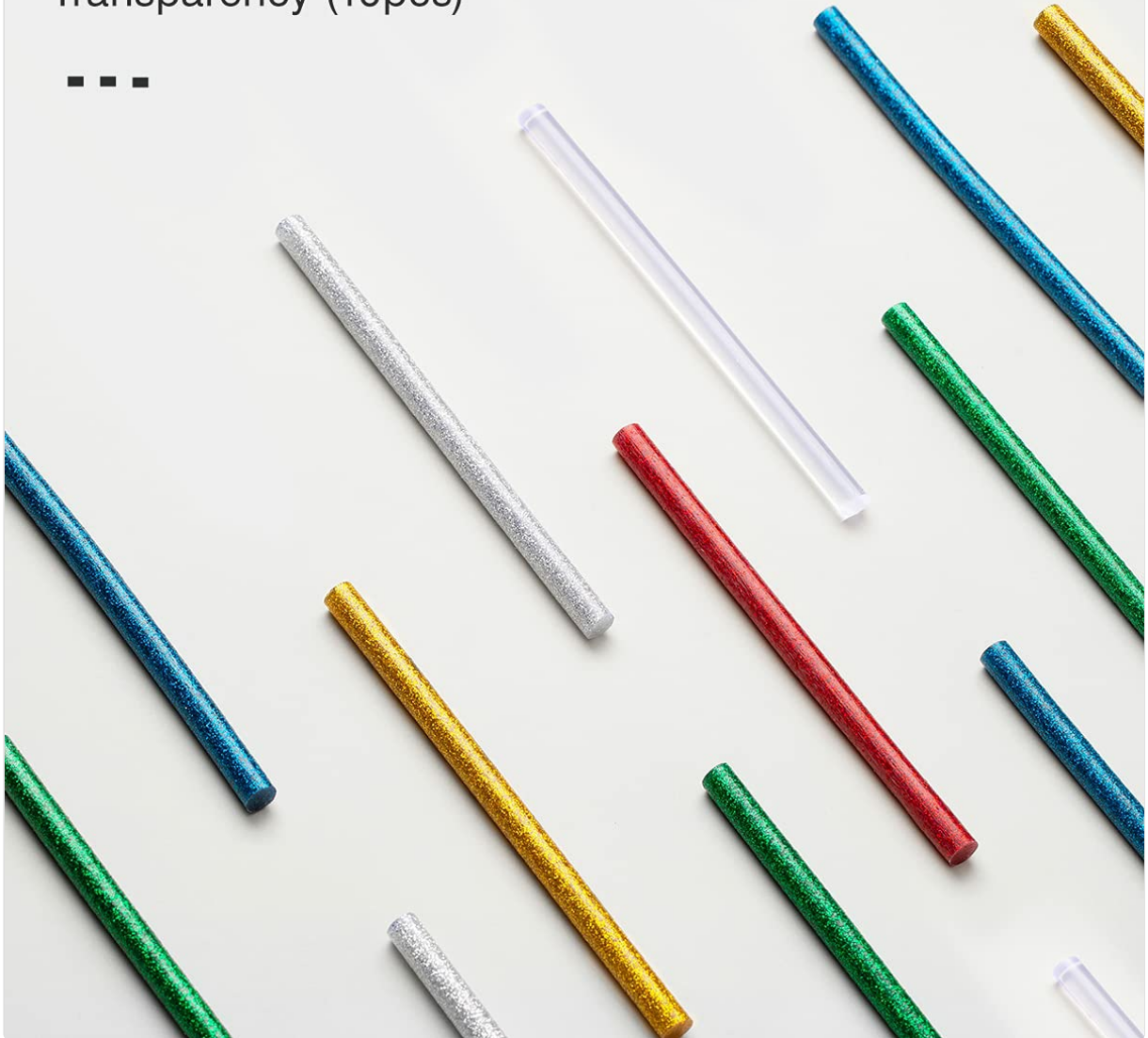

Image 4.4: Multi-color hot glue sticks for diverse projects.

5. MAINTENANCE

- **Cleaning:** Ensure the glue gun is turned off and completely cooled before cleaning. Gently wipe the exterior with a soft, dry cloth. Do not use abrasive cleaners or solvents.
- **Nozzle Care:** Avoid picking at dried glue on the nozzle when it is hot. Allow it to cool, then carefully remove any excess glue.
- **Storage:** Store the glue gun in a dry, cool place, away from direct sunlight and extreme temperatures. Always place the protective cap over the nozzle when storing to prevent accidental damage or drips.

6. TROUBLESHOOTING

- **Glue Gun Not Heating:**
 - Ensure the device is fully charged.
 - Verify the power button has been pressed and held until the indicator light is solid white.
 - **Glue Not Flowing:**
 - Check if a glue stick is properly inserted and fully advanced into the heating chamber.
 - Allow sufficient preheating time (approx. 30 seconds).
 - Ensure the trigger is being pressed firmly.
 - **Glue Dripping Excessively:**
 - The intelligent temperature control system is designed to minimize dripping. If dripping occurs, ensure the device is not left on for extended periods without use.
 - Always use the protective cap when the gun is not actively dispensing glue.
 - **Device Shuts Off Unexpectedly:**
 - This is a safety feature. The glue gun automatically powers off after 5 minutes of inactivity. Simply press the power button to restart.
-







7. SPECIFICATIONS

- **Model:** HOTO Cordless Hot Glue Gun
 - **Manufacturer:** HOTO
 - **Battery:** 2000mAh Lithium-ion
 - **Charging Interface:** USB Type-C
 - **Preheating Time:** Approximately 30 seconds
 - **Glue Stick Diameter:** 0.27 inches (7mm)
 - **Automatic Shut-off:** After 5 minutes of inactivity
 - **Glue Stick Material:** Eco-friendly resin
-

8. WARRANTY AND SUPPORT

For warranty information, technical support, or further assistance, please refer to the official HOTO website or contact HOTO customer service directly. Keep your purchase receipt as proof of purchase for any warranty claims.

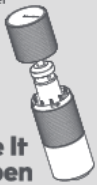
© 2025 HOTO. All rights reserved.

 <p>Stay tuned to our social media (@hoto_official)</p>	<p>HOTO Lithium Glue Gun User Manual</p> <p>This manual provides instructions, specifications, and troubleshooting for the HOTO Lithium Glue Gun. Learn how to operate, charge, and maintain your glue gun for various crafting and repair needs.</p>
 <p>Stay tuned to our social media (@hoto_official)</p>	<p>HOTO Cordless Screwdriver QWLSD008 User Manual and Specifications</p> <p>This document provides a comprehensive user manual for the HOTO Cordless Screwdriver QWLSD008, including product overview, usage instructions, safety warnings, troubleshooting guide, and technical specifications. Available in English and German.</p>
<p>Manual of HOTO 20V Cordless High Pressure Washer</p> 	<p>HOTO 20V Cordless High Pressure Washer User Manual</p> <p>User manual for the HOTO 20V Cordless High Pressure Washer, detailing product overview, operating procedures, maintenance, technical specifications, safety information, and troubleshooting. Includes multilingual support.</p>
<p>HOTO 16V Brushless Drill</p>  <p>Make It Happen</p>	<p>HOTO 16V Brushless Drill User Manual and Specifications</p> <p>Comprehensive user manual for the HOTO 16V Brushless Drill (Model QWLDZ004), covering product overview, usage instructions, safety warnings, specifications, and troubleshooting.</p>
<p>HOTO PixelDrive Cordless Screwdriver</p>  <p>Make It Happen</p>	<p>HOTO PixelDrive Cordless Screwdriver User Manual & Specifications Model QWLSD014</p> <p>Detailed user guide for the HOTO PixelDrive Cordless Screwdriver (QWLSD014). Learn about its features, operation, torque control, battery, charging, safety precautions, specifications, and declarations of conformity. Visit hototools.com for more.</p>
<p>HOTO Grip™ Cordless Spin Scrubber</p>  <p>Make It Happen</p>	<p>HOTO Grip Cordless Spin Scrubber User Manual and Specifications</p> <p>Comprehensive user guide, specifications, safety warnings, and regulatory compliance information for the HOTO Grip Cordless Spin Scrubber (Model QWQJA10).</p>