

## OHMAXX SWS10-1

# OHMAX Smart Light Switch with Remote Control (Model SWS10-1) User Manual

Comprehensive instructions for installation, operation, and troubleshooting.

## 1. INTRODUCTION

This manual provides detailed instructions for the installation, setup, and operation of your OHMAX Smart Light Switch with Remote Control, Model SWS10-1. Please read this manual thoroughly before installation and use to ensure proper functionality and safety.



Image 1.1: OHMAX Smart Light Switch and Remote Control packaging. The image shows the product box containing the smart light switch and a separate wireless remote control.

## 2. SAFETY INFORMATION

- **Electrical Safety:** Installation must be performed by a qualified electrician or a person with a thorough understanding of electrical wiring. Always turn off power at the circuit breaker before installation.
- **Neutral Wire Required:** This device requires a neutral wire for operation. If your electrical box does not have a neutral wire, consult a qualified electrician.
- **2.4GHz Wi-Fi Only:** This device operates on a 2.4GHz Wi-Fi network. It is not compatible with 5GHz Wi-Fi networks.
- **Single Pole Only:** This switch is designed for single-pole applications only. It is not compatible with 3-way or multi-way switch configurations unless used with the included remote as a virtual 3-way.
- **Maximum Load:** Do not exceed the maximum power rating of 1800W or current rating of 15A.

## 3. PACKAGE CONTENTS

The OHMAX Smart Light Switch kit includes:

- OHMAX Smart Light Switch (Model SWS10-1)
- SM04 RF Wireless Remote Control
- Wall Holder for Remote
- Face Plate
- Screws
- 3M Adhesive Tape
- User Manual (this document)

## 4. SETUP AND INSTALLATION

---

### 4.1 Electrical Installation

1. **Turn Off Power:** Locate your circuit breaker and turn off the power to the light switch you are replacing. Verify power is off using a voltage tester.
2. **Remove Old Switch:** Carefully remove the existing wall plate and unscrew the old switch from the electrical box. Disconnect the wires.
3. **Identify Wires:** Identify the following wires in your electrical box:
  - **Neutral Wire:** Often white and capped together. This is essential for the smart switch.
  - **Line Wire:** Often black, providing constant power. Use an electric pen to confirm it's live when power is on (before turning off for installation).
  - **Load Wire:** Connects to the light fixture. May be red or black.
  - **Ground Wire:** Always green or bare copper.
4. **Connect New Switch:** Connect the wires from your electrical box to the corresponding terminals on the OHMAX Smart Light Switch. Ensure connections are secure.
  - Connect the Neutral wire to the 'Neutral' terminal.
  - Connect the Line wire to the 'Line' terminal.
  - Connect the Load wire to the 'Load' terminal.
  - Connect the Ground wire to the 'Ground' terminal.

*Note: If the switch does not function after installation, try reversing the Line and Load connections.*
5. **Mount Switch:** Gently push the wired switch into the electrical box and secure it with screws. Attach the face plate.
6. **Restore Power:** Turn the power back on at the circuit breaker.

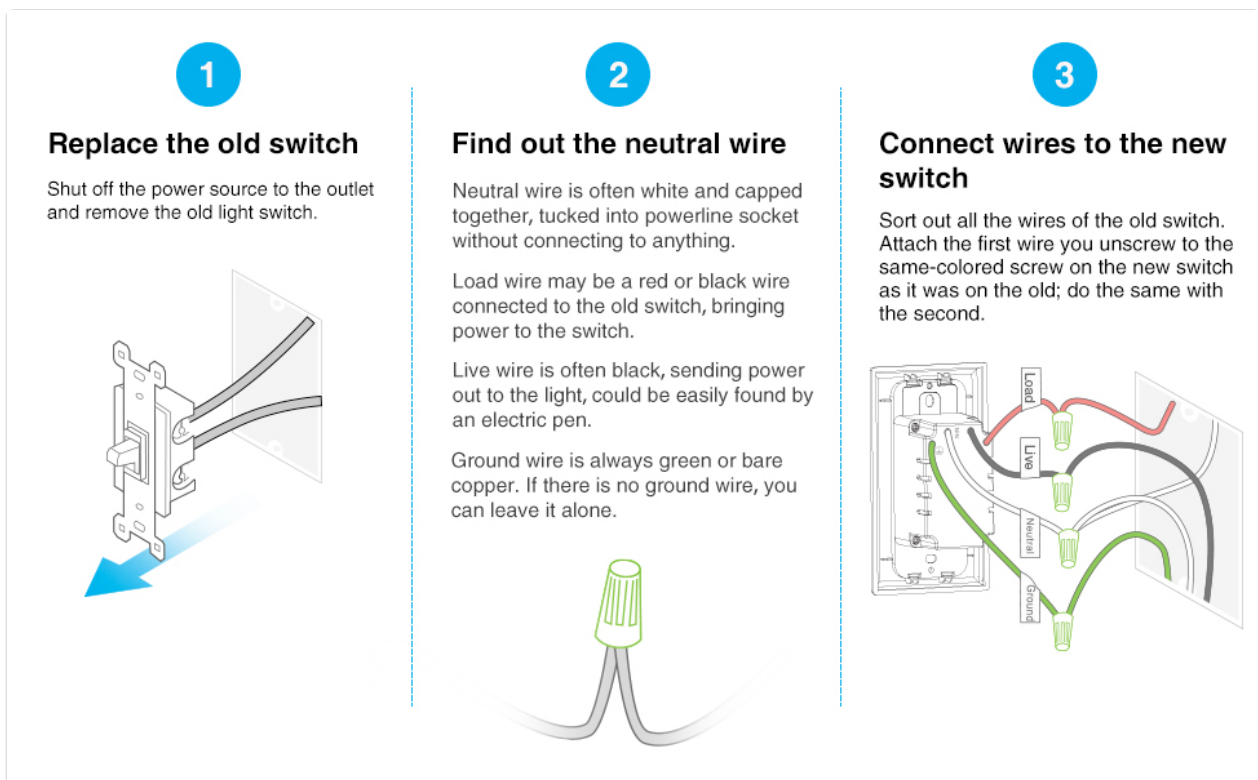

Image 4.1: Step-by-step wiring diagram. This image illustrates how to replace an old switch, identify neutral, line, load, and ground wires, and connect them to the new smart switch.

## 4.2 App Setup and Wi-Fi Connection

The OHMAX Smart Light Switch uses the Smart Life app for smart control. Ensure your Wi-Fi network is 2.4GHz.

1. **Download App:** Download the "Smart Life" app from the App Store (iOS) or Google Play Store (Android).
2. **Register/Login:** Open the app and register a new account or log in with an existing one.
3. **Add Device:** Tap "Add Device" or the "+" icon in the app.
4. **Select Device Type:** Choose "Light Switch" or the appropriate category.
5. **Connect to 2.4GHz Wi-Fi:** Select your 2.4GHz Wi-Fi network and enter the password.
6. **Reset Device:** On the smart switch, press and hold the main switch button for approximately 5 seconds until the indicator light blinks rapidly. This puts the switch into pairing mode.
7. **Confirm Blinking:** In the app, confirm that the indicator light on the switch is blinking rapidly.
8. **Connect:** The app will begin searching for and connecting to the device. Once connected, you can rename the switch.

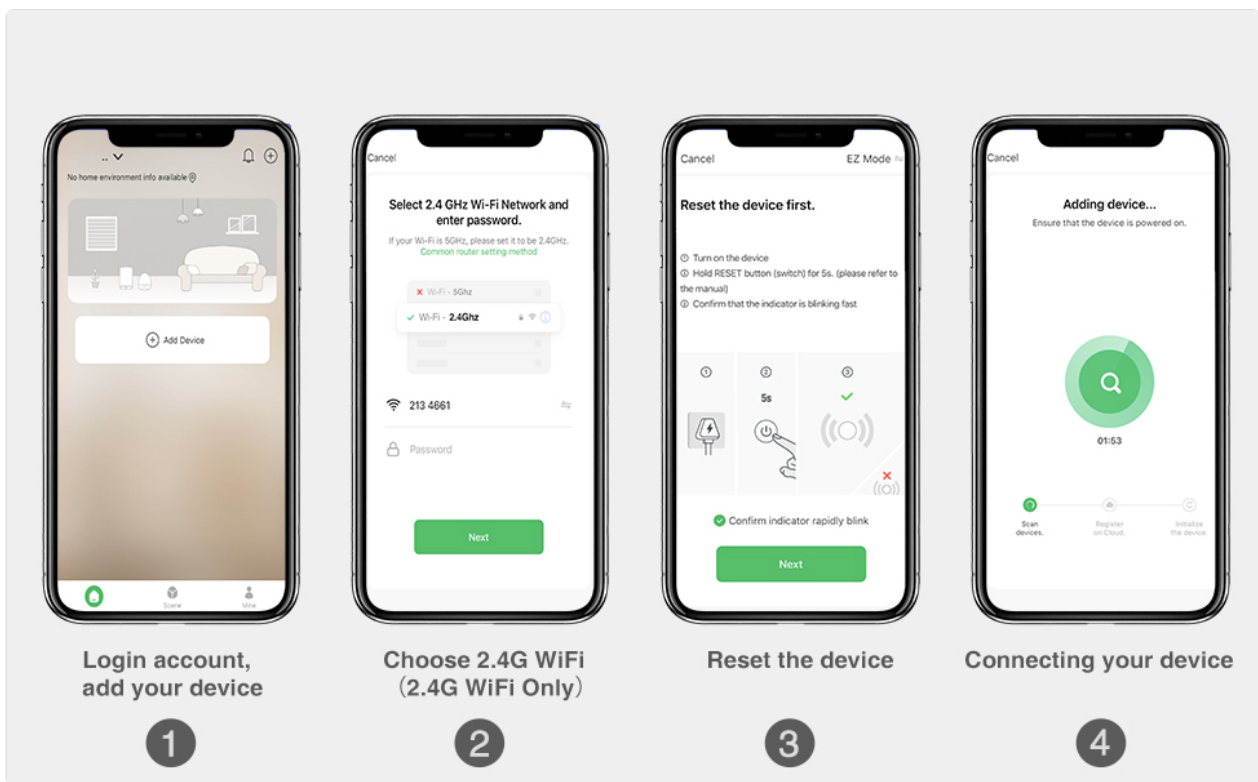

Image 4.2: Smart Life app setup steps. This image shows the four main steps: logging in and adding a device, selecting the 2.4G Wi-Fi network, resetting the device, and connecting the device.

## 4.3 Remote Control Pairing

The included SM04 RF remote control needs to be paired with the smart light switch.

1. **Enter Pairing Mode on Switch:** Quickly press the main smart switch button 3 times. The indicator light on the switch will flash green.
2. **Pair Remote:** While the switch indicator is flashing, press the "ON" button on the wireless remote control.
3. **Confirmation:** The remote will blink green, and the switch indicator light will slow down its flashing, indicating successful pairing.

*Note: The remote control can be mounted to a wall using the provided wall holder, screws, or 3M adhesive tape. It uses a replaceable CR2032 coin cell battery.*

## 5. OPERATING INSTRUCTIONS

### 5.1 Multiple Control Methods

The OHMAX Smart Light Switch offers several ways to control your lights:

- **Manual ON/OFF:** Press the physical button on the smart light switch.
- **Wireless Remote Control:** Use the included SM04 RF remote control to turn lights ON or OFF from anywhere within range (up to 260ft).
- **App Control:** Use the Smart Life app on your smartphone to control lights remotely, set schedules, and manage settings.
- **Voice Control:** Integrate with Amazon Alexa or Google Home for hands-free operation.

# Control Your Lights in Multiple Ways

## ON/OFF from remote



## Manual ON/OFF



## Voice Control



## App Control



Image 5.1: Control Your Lights in Multiple Ways. This image visually demonstrates control via the remote, manual switch, voice commands through smart speakers, and the Smart Life mobile application.

## 5.2 Voice Control Integration

To enable voice control, link your Smart Life account to Amazon Alexa or Google Home through their respective apps.

- **For Amazon Alexa:**

- a. Open the Alexa app.
- b. Go to "Skills & Games".
- c. Search for "Smart Life" and enable the skill.
- d. Link your Smart Life account.
- e. Discover devices.

- **For Google Home:**

- a. Open the Google Home app.
- b. Tap "Add" > "Set up device" > "Works with Google".
- c. Search for "Smart Life" and link your account.

Once linked, you can use commands such as: "Alexa, turn on Kitchen Light" or "Hey Google, turn off Bedroom Light."



Image 5.2: Hands-free Voice Control. A person is shown interacting with a smart speaker to control lights, demonstrating the convenience of voice commands.

### 5.3 Timer and Schedule Functions

Utilize the Smart Life app to set up schedules and timers for automated lighting control.

- **Timer:** Set a countdown timer for the light to turn ON or OFF after a specified duration.
- **Schedule:** Create daily or weekly schedules for lights to turn ON or OFF at specific times. This can simulate occupancy when you are away from home.



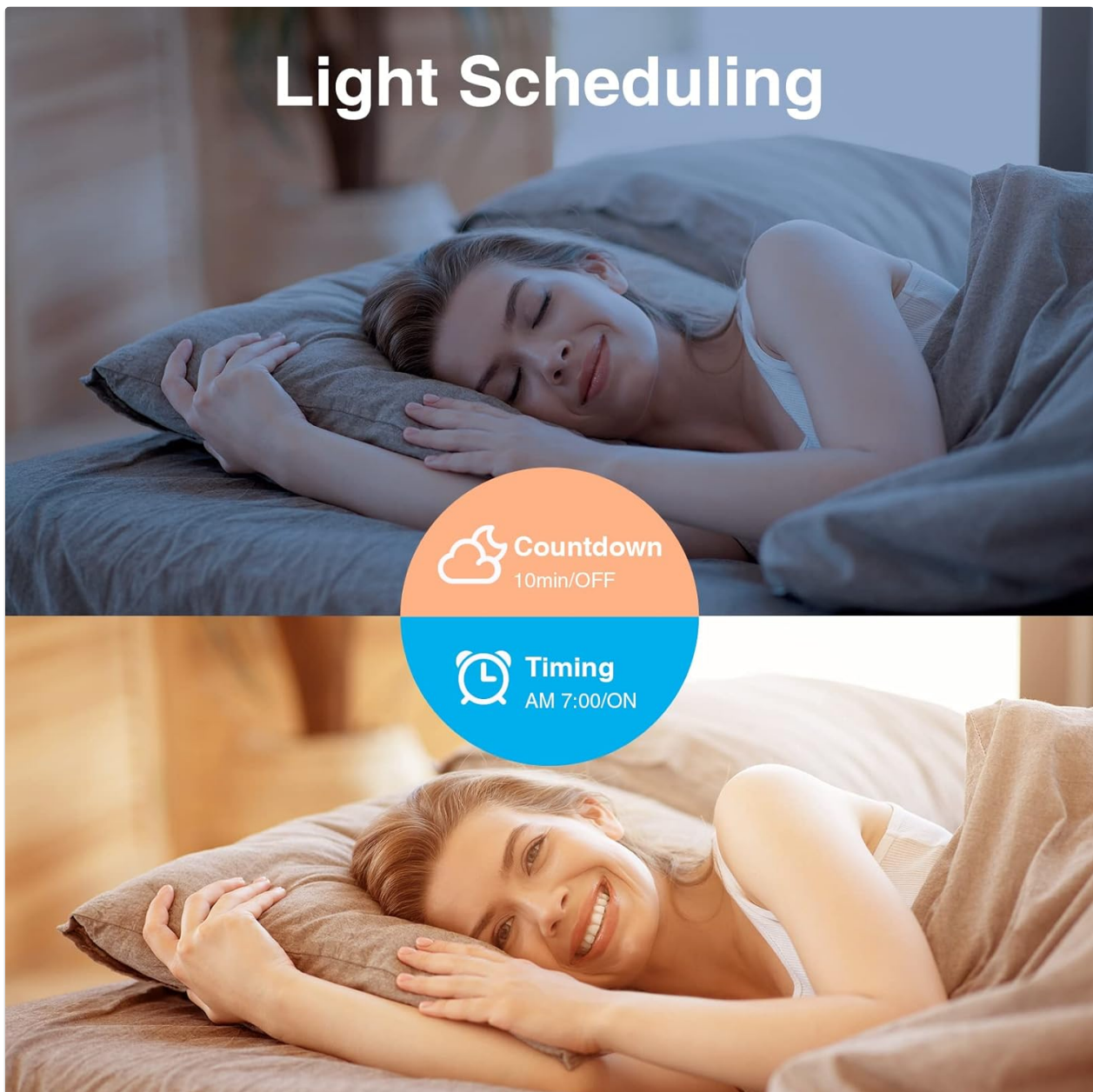

Image 5.3: Light Scheduling. This image illustrates the timer and scheduling capabilities, showing a countdown for turning off and a scheduled time for turning on.

## 6. MAINTENANCE

---

- **Cleaning:** To clean the switch and face plate, gently wipe with a soft, dry cloth. Do not use abrasive cleaners or solvents.
- **Remote Battery Replacement:** The wireless remote control is powered by a CR2032 coin cell battery. Replace the battery when the remote's indicator light no longer illuminates or its range decreases significantly.
- **Firmware Updates:** Periodically check the Smart Life app for available firmware updates for your smart switch to ensure optimal performance and security.

## 7. TROUBLESHOOTING

---

### 7.1 Common Issues and Solutions

- **Switch Not Turning On/Off Manually:**



- Ensure power is restored at the circuit breaker.
  - Verify all wires are securely connected.
  - Check if the Line and Load wires are correctly identified and connected. If unsure, try reversing them.
- **Remote Control Not Working:**
    - Ensure the remote is paired with the switch (refer to Section 4.3).
    - Check the remote's battery (CR2032). Replace if necessary.
    - Ensure the remote is within range of the smart switch.
- **Unable to Connect to Wi-Fi / App Control Not Working:**
    - Confirm your Wi-Fi network is 2.4GHz. The switch is not compatible with 5GHz networks.
    - Ensure your Wi-Fi signal is strong at the switch's location.
    - Verify the Wi-Fi password entered in the Smart Life app is correct.
    - Try resetting the smart switch to pairing mode (press and hold the main button for 5 seconds until it blinks rapidly) and attempt to connect again via the app.
    - Restart your Wi-Fi router.
- **Voice Control Not Responding:**
    - Ensure your Smart Life account is correctly linked to Alexa or Google Home (refer to Section 5.2).
    - Check if the smart speaker is online and functioning correctly.
    - Verify the device name in the Smart Life app matches the name you are using in voice commands.

## 8. SPECIFICATIONS

Model Number	SWS10-1
Brand	OHMAXX
Product Dimensions	2.3 x 1.5 x 2.1 inches
Item Weight	8.64 ounces
Operation Mode	ON-OFF-ON
Current Rating	15 Amps
Operating Voltage	120 Volts
Contact Type	Normally Open
Connector Type	Plug In
Terminal	Screw
Circuit Type	1-way (Single Pole)
Contact Material	Copper
Wi-Fi Compatibility	2.4GHz only
Max Power	1800W

## 9. WARRANTY AND SUPPORT

### 9.1 Warranty Information



OHMAX products typically come with a 12-month warranty from the date of purchase. Please refer to the product packaging or contact customer support for specific warranty terms and conditions.

### 9.2 Customer Support

If you encounter any difficulties during installation or operation, or have questions about your OHMAX Smart Light Switch, please do not hesitate to contact our customer support team. We are available to assist you. For support, please refer to the contact information provided on the product packaging or the OHMAXX brand store on Amazon: [OHMAXX Store](#)

© 2023 OHMAXX. All rights reserved.

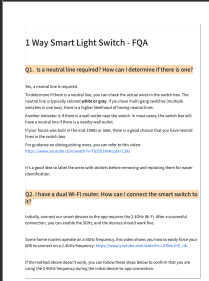
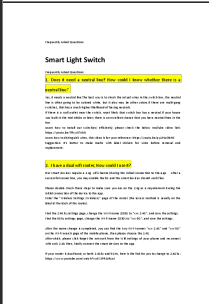
## Related Documents - SWS10-1

	<p><a href="#">1 Way Smart Light Switch - Frequently Asked Questions (FAQ)</a></p> <p>Answers to common questions about the 1 Way Smart Light Switch, covering installation, Wi-Fi connectivity, troubleshooting, and compatibility with smart home platforms like Alexa, Google Home, and Apple HomeKit.</p>
	<p><a href="#">Smart Light Switch FAQ: Setup and Troubleshooting Guide</a></p> <p>Get answers to common questions about your Smart Light Switch, including installation, Wi-Fi connection, troubleshooting offline issues, and integration with voice assistants like Alexa and Google Home.</p>
	<p><a href="#">Geeni Smart Wi-Fi Light Switch Start Guide</a></p> <p>A comprehensive start guide for the Geeni Smart Wi-Fi Light Switch, covering setup, installation, troubleshooting, and FAQs. Learn how to connect your smart switch to your home Wi-Fi and control your lights remotely.</p>

