

ABUS 148TSA/30

ABUS 148TSA/30 TSA Cable Combination Lock

User Manual

1. INTRODUCTION

The ABUS 148TSA/30 is a TSA-certified cable combination lock designed for securing luggage and other items. Its flexible cable shackle allows for versatile application on various bags, suitcases, and backpacks. This lock is particularly recommended for travel to the United States, where the Transportation Security Administration (TSA) may need to inspect luggage. The TSA can open this lock using a special key without causing damage, unlike non-TSA approved locks which may be broken during inspection.

The lock features a resettable 3-digit numerical code and an indicator that signals if the lock has been opened by TSA personnel. It also includes a built-in name tag for convenience.



Image 1: ABUS 148TSA/30 TSA Cable Combination Lock.

2. SETTING YOUR COMBINATION

The ABUS 148TSA/30 lock comes with a factory preset combination, typically 0-0-0. You can easily set your own personalized 3-digit combination.

1. Ensure the lock is open and set to the current combination (default is 0-0-0).
2. Locate the small reset lever or button on the side or bottom of the lock.
3. Using a pen or a pointed object, press and hold the reset lever/button.
4. While holding the reset lever/button, rotate the three number wheels to your desired 3-digit combination. Choose a memorable but secure combination.
5. Release the reset lever/button. Your new combination is now set.
6. Scramble the dials to lock the cable. Test your new combination to ensure it opens the lock correctly before securing any valuables.



Image 2: ABUS 148TSA/30 lock showing combination dials and side release lever, used for setting the combination.

3. OPERATING THE LOCK

3.1 Locking and Unlocking

1. To unlock: Rotate the number wheels to your set 3-digit combination. Press the side lever to release the cable shackle.
2. To lock: Insert the cable shackle back into the lock body until it clicks into place. Scramble the number wheels to secure the lock.

3.2 TSA Indicator

The lock features a TSA indicator to inform you if your luggage has been inspected by the Transportation Security Administration.

- If a **red ring** is visible around the cable entry point or on the lock body, it indicates that the lock has been opened by a TSA agent using their master key.
- If no red ring is visible, the lock has not been opened by TSA.
- To reset the indicator for a new journey, turn the cable shackle 360 degrees after opening the lock.



Image 3: ABUS 148TSA/30 lock securing a backpack zipper, demonstrating a typical application.

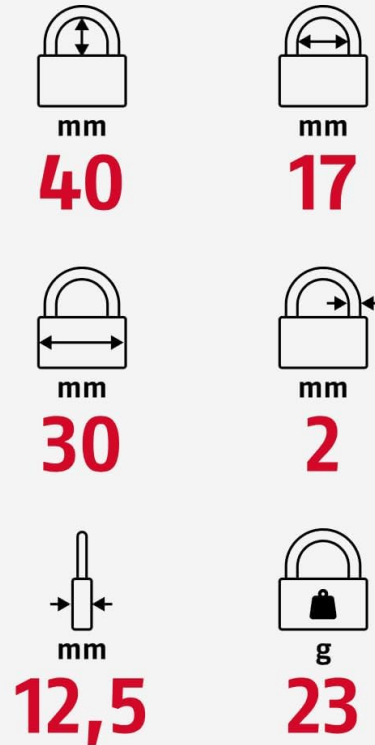

Image 4: ABUS 148TSA/30 lock with integrated name tag for easy identification of luggage.

4. MAINTENANCE

The ABUS 148TSA/30 lock is designed for durability. To ensure its longevity and smooth operation:

- Keep the lock clean and free from dirt or debris, especially around the number wheels and cable mechanism.
- Avoid exposing the lock to extreme temperatures or harsh chemicals.
- If the number wheels become stiff, a small amount of graphite lubricant can be applied. Avoid oil-based lubricants as they can attract dust.
- Regularly check the cable for any signs of wear or damage.

5. TROUBLESHOOTING

5.1 Lock Will Not Open with Correct Combination

- Ensure each number wheel is precisely aligned with the indicator marks.
- Try rotating the wheels slightly back and forth to ensure they are not stuck between numbers.

- Verify that you are using the correct combination. If you have multiple locks, ensure you are using the combination for this specific lock.

5.2 Cable Shackle is Stiff or Difficult to Insert/Remove

- Check for any foreign objects or debris obstructing the cable entry point.
- Ensure the lock is fully open (combination set, side lever pressed) before attempting to insert or remove the cable.
- Apply a small amount of graphite lubricant to the cable and the entry point if stiffness persists.

5.3 Forgot Combination

Unfortunately, if you forget your combination and do not have it recorded, there is no master key or backdoor to open the lock without knowing the combination. You may need to try all 1000 possible combinations (000-999) or replace the lock.

6. SPECIFICATIONS

Feature	Detail
Model Name	148TSA/30
Lock Type	Combination Lock
Combination	3-digit, resettable
Cable Thickness	2 mm (0.08 inches)
Material	Stainless Steel cable, durable body
Color	Black
Lock Width	30 mm (1.18 inches)
Height	96 mm (3.78 inches)
Depth	12.5 mm (0.49 inches)
Horizontal Clearance	17 mm (0.67 inches)
Vertical Clearance	40 mm (1.58 inches)
Item Weight	1.44 ounces (approx. 41 grams)
Special Features	TSA Approved, Resettable Combination, Name Tag, TSA Indicator

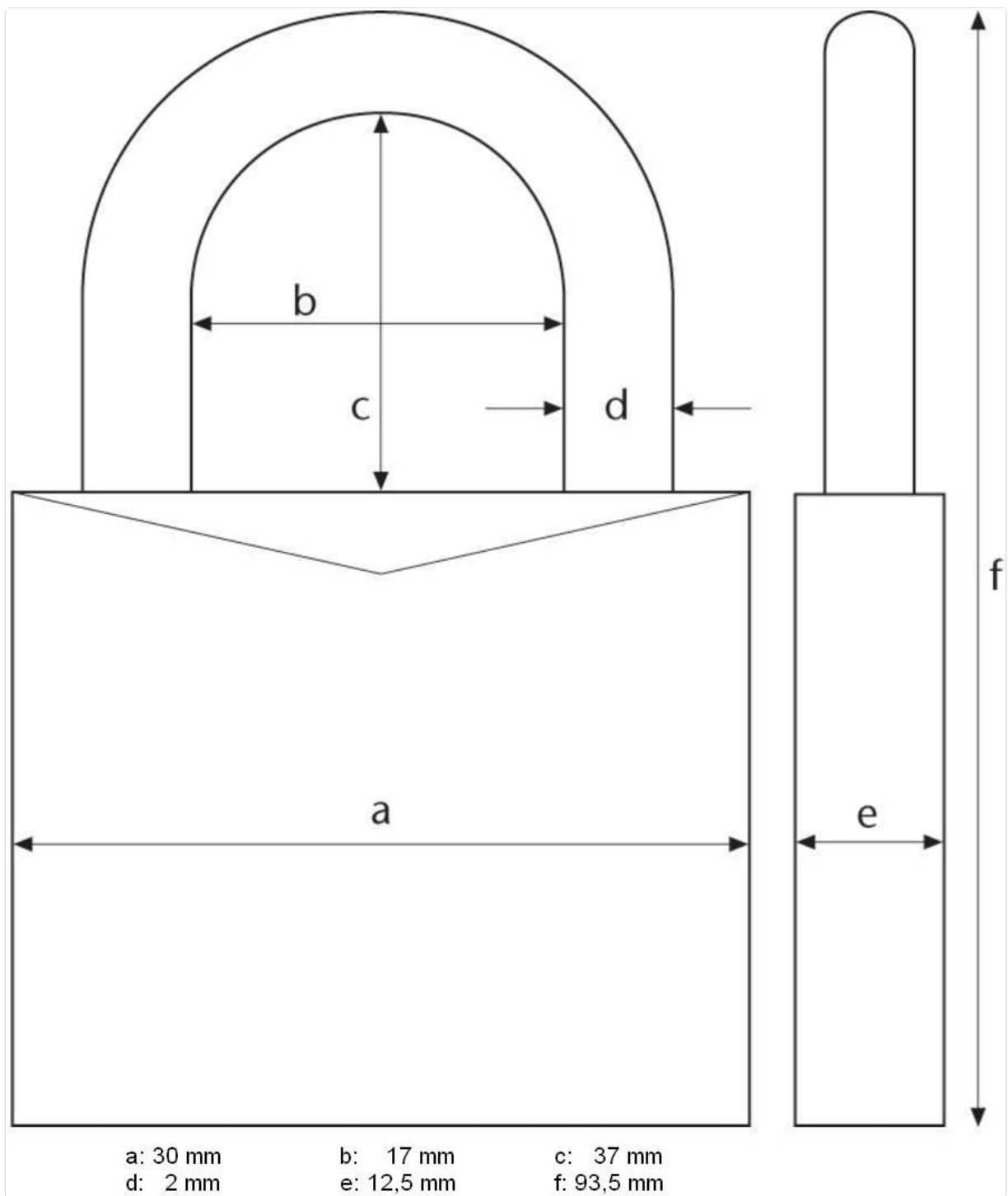

Image 5: Technical drawing illustrating the dimensions of the ABUS 148TSA/30 lock.

7. WARRANTY AND SUPPORT

For warranty information, technical support, or further assistance with your ABUS 148TSA/30 lock, please refer to the official ABUS website or contact ABUS customer service directly. Keep your purchase receipt as proof of purchase for any warranty claims.

You can find more information and contact details on the official ABUS website: www.abus.com

